

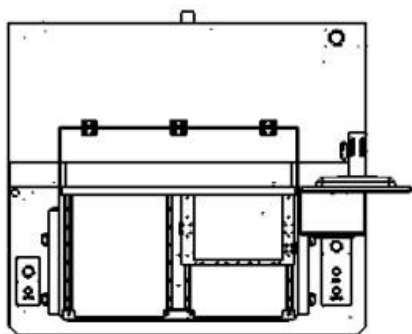

Model	RS-500
Effective Cutting Size	X350*Y400mm
Cutting function	Line, circle and arc.
Processing surface	Double worktable
Machine repeated accuracy	±0.01mm
Cutting precision	±0.03mm
Maximum moving speed	XY 1000mm/s · Z 800mm/s
Maximum Move Trip	X:750 Y:500 Z:100mm
Main speed	RASEM 40,000rpm adjustable
Cutting speed	0~100mm/s
Operation Interface	Windows operating system
Programmatic teaching methods	Color CCD image instruction input
Program Backup	USB
Control mode	PC Visual Precision 4-Axis Control System
XYZ demotion method	AC Servo motor
Size of appropriate knife	Ø0.8~3.0mm
Electricity	AC220V/380V 50/60HZ three-phase
Cutting host size	1200(W)*1050(D)*1700(H)mm
Cutting host weight	560Kg
Set machine power	2.2KW/3HP
Set Machine Size	860(W)*470(D)*730(H)mm
Collector weight	50Kg
Collection method	Upper Collection

Specifications are subject to change without notice. Special orders are welcome.

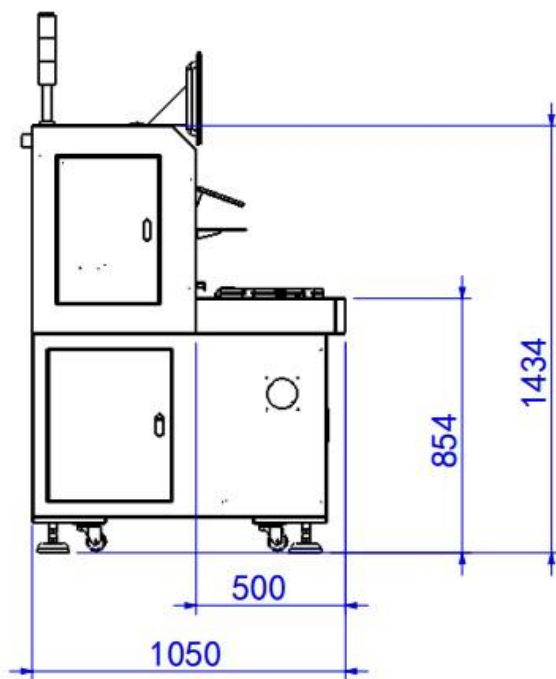
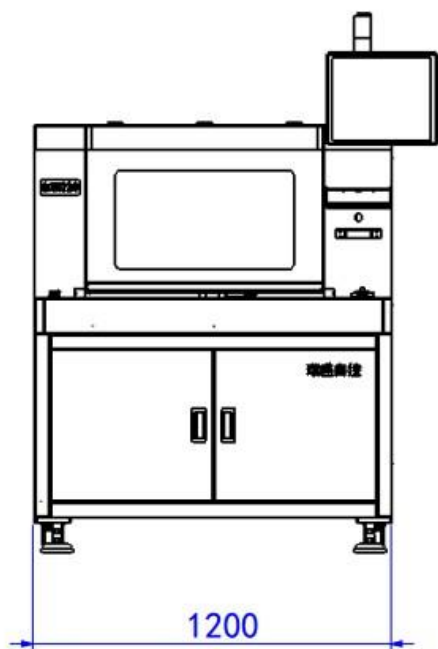

## 4-2 handling method

### 1. before handling:

(1) check the power off state of the machine and the demolition of the air source pipeline.

(2) the tricolor indicator lamp (as shown in figure 4-2-1-A) lies flat on the machine platform.

(4) disassemble the display (as shown in figure 4-2-1-B) for additional packaging.

(5) the keyboard seat (such as figure 4-2-1-C) is fixed on the machine.

(6) the machine can hold the four doors open in the plastic wrap.



图 4-2-1

2. it is the only way to lift a machine that uses 1.5 tons or more of the pile up machine from behind the chassis. (for example, figure 4-2-2)

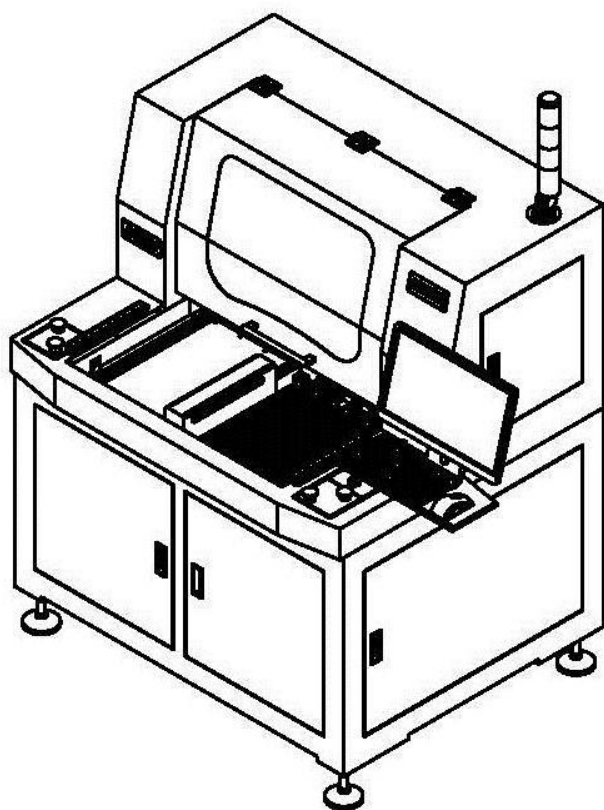

图 4-2-2

3. handling and placing precautions: handle with care when handling. Keep steady.

1. check accessories: please check the shipping list of the spare parts.
2. installation position: according to the occupation space (please refer to the 4-1 mechanical appearance size), plan the parking area of the machine.
3. fixed platform: place the foot plate of the machine base on the ground evenly, and the bolt rotates the lifting wheel to leave the 5~10mm.
4. level adjustment: put the level instrument in the middle of the working table, adjust the bolt to make the machine level state, and check the contact between the feet and the ground.
5. power supply device: access the single phase 220V power supply, lock the external power cord to the internal terminal and connect the grounding wire.
6. air pressure device: connect to the air pressure source and set the pressure gauge of the filter at 6 f/cm<sup>2</sup> (Figure 4-3-1).

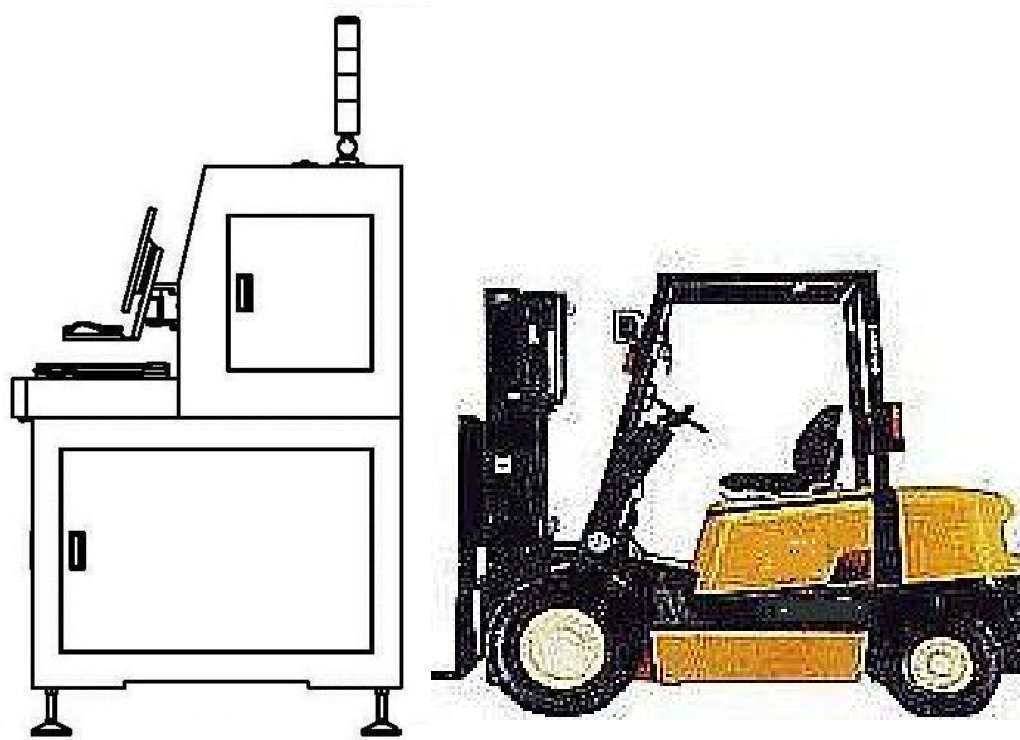

图 4-3-1

7. matching dust collector: connect the fittings wind pipe (like figure 4-3-2) to the dust collector interface of the suction outlet of the dust collector and the machine platform, and use the pipe clamp to fix the wind pipe (as in Figure 4-3-3).



图 4-3-2

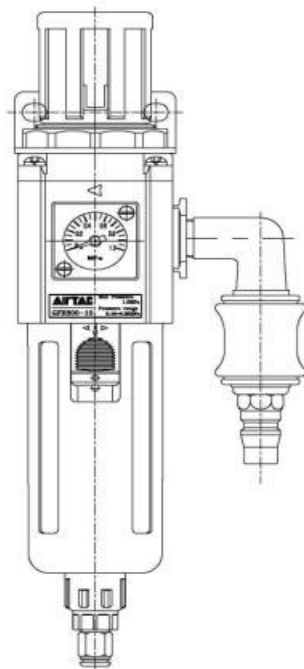

图 4-3-3

8. lamp device: adjust the three color indicator (4-2-1-A) to a vertical position.
9. computer equipment: check the more computer wiring (power line, video line, video transmission / power line, keyboard / mouse, connection line, USB extension line, etc.), whether or not it is properly connected and fixed.

