

北京包美机械有限公司  
Beijing Poemy Machinery Co.,Ltd.

地址: 北京市昌平区科技园超前路甲1号13楼302  
302, 13th Floor, No. A1 Chaoqian Road, Science and Technology Park,  
Changping District, Beijing  
网站: [www.poemy.cn](http://www.poemy.cn)  
邮箱: [liuyong@poemy.cn](mailto:liuyong@poemy.cn)  
电话: 400-1818-722

上海包美机械有限公司  
No.6933, Oriental Beauty Valley Avenue, Fengxian District, Shanghai,China

地址:中国上海市奉贤区东方美谷大道6933号  
Shanghai Branch Address: No. 6933, Oriental Beauty Valley Avenue,  
Fengxian District, Shanghai,China  
网站: <https://www.poemypackaging.com/>  
邮箱: [liuyong@poemy.cn](mailto:liuyong@poemy.cn)  
电话: 400-1818-722



Scan to our website



SAMPLE BOOK OF  
PRODUCTS

北京包美机械  
Poemy Machinery



## 关于企业

### ABOUT THE GROUP

#### 北京包美机械 上海包美机械

Beijing Poemy Machinery Co., Ltd/Shanghai Poemy Machinery Co., Ltd

#### 1. 成立:

北京包美机械成立于2015年北京市昌平区中关村科技园区,2019年在上海成立其全资子公司。

##### (1) Establishment:

Established in Zhongguancun Science and Technology Park, Changping District, Beijing, China,Established a wholly-owned subsidiary in Shanghai.

#### 2. 经营范围:

全自动方便面加工线以及包装线和面线解决方案类服务。

##### (2) Main products:

Fully automatic instant noodle processing making machinery and packaging machinery as well as the service for instant noodles equipment solutions.

#### 3. 技术实力:

公司技术团队原就职于日本知名包装机械公司,成立之初即确定以研发为主的创新型企业。

##### (3) Technical strength:

The company's technical team originally worked for a well-known Japanese instant noodle machinery company, and was determined to be an innovative enterprise focusing on research and development from the beginning.

#### 4.项目领域:

公司在方便面加工线以及包装线具有多年的经验,可提供发面团压片机,蒸面机,油炸机,枕式包装机,热收缩膜包机,装盒机,装箱机,以及机器人码垛机,具有整线设计能力。

##### (4) Project area:

The company has many years of experience in instant noodle production lines and packaging lines.It can provide: fully automatic packaging equipment such as composite dough press, steamer, fryer, pillow packaging, heat shrinkable film wrapping machine, boxing, and cartoning, robot palletizer with the ability to design the entire line.

#### 5. 我们的荣誉:

国家高新技术企业,拥有多项实用性发明专利。

##### (5) Our Honor:

A high-tech enterprise nationally certified by our government; possesses a number of practical invention patents.

## 荣誉证书

### CERTIFICATE OF HONOUR





01-04

## PART.A

- 全自动方便面生产线  
Full auto instant noodles making line 01
- 全自动单包方便面枕包装箱码垛线  
Full auto instant noodles single bag pillow packaging cartoning palletizer line 02
- 全自动多包面包装线  
Full auto multi-packs instant noodles packaging line 03
- 全自动杯面碗面桶面整理供料膜包装箱码垛  
Full auto cup bowl bucket instant noodles sorting feeding shrinking wrapping cartoning palletizer line 04

## PART.B

01-08

- 01 自动理料机  
Instant noodles sorting machine
- 02 XDJ-2000料包投放机  
Seasoning sachets dispensor
- 03 单包枕式包装机  
Single bag instant noodles pillow packaging machine
- 04 单包面集积器+装箱机  
Single bag instant noodles accumulator + cartoning machine
- 05 多包集积器+多包枕式包装机  
Multi bags accumulator +pillow packaging machine
- 06 多包装袋面装箱机  
Multi packs instant noodles cartoning machine
- 07 杯面碗面桶面热收缩膜包机  
Cup/bowl/bucket instant noodles heat shrinking wrapping machine
- 08 杯面碗面桶面装箱机  
Cup/bowl/bucket instant noodles cartoning machine

# 01 全自动方便面生产线 Full auto instant noodles making line

## ■ 生产过程 Process

01

混合机  
Auto mixer



03

连续延压机  
Continuous Press System



05

切面机  
Cutting Machine



07

冷却机  
Instant noodles  
cooling Machine



02

复合压面  
Automatic compound presser



04

蒸箱  
Steaming System



06

油炸机  
Frying machine



方便面的制造(制作)过程包括:

混合、复合、连续压制、蒸、切、折、油炸、然后冷却。

产量可根据客户需求定制。

The instant noodle manufacturing(making) process includes:

mixing, compounding, continuous pressing, steaming, cutting and folding, frying, and then cooling.

The capacity can be customized based on customer needs.

## ■ 设备布局图 Equipment layout

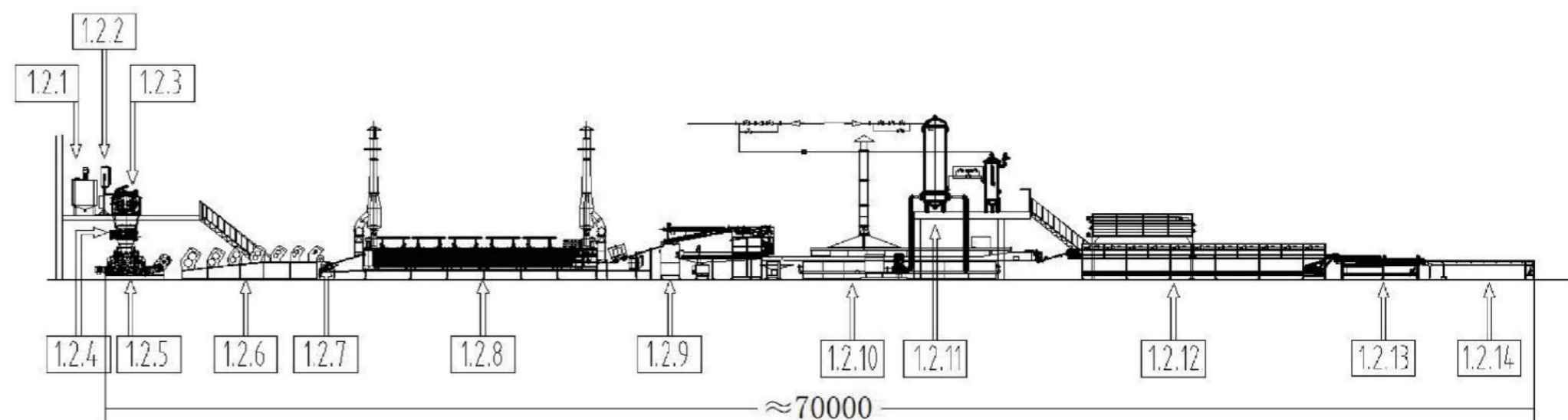



## 02 全自动单包方便面枕包装箱码垛线

Full auto instant noodles single bag pillow packaging cartoning palletizer line

### ■ 生产过程 Process

01

面块整理

Instant noodle cake sorting machine



03

单包装袋

Single bag pillow packing machine



05

码垛

Palletizer



02

调料包投放

Seasoning sachets dispenser



04

单包装箱

Single bag cartoning machine



单袋方便面包装生产线包括:

方便面整理机、调味包分配机、枕式包装机、装箱机、码垛机等。

主要适用于圆形方便面、方形方便面的自动输送、整理、包装和码垛。

The single bag instant noodle packaging line includes:

instant noodle sorting machine, seasoning sachets dispenser machine, pillow packing machine, cartoning machine (case packer), palletizer, etc.

Mainly suitable for round instant noodles, square instant noodles of automatic conveying, sorting and packaging and palletizer.

### ■ 设备布局图 Equipment layout

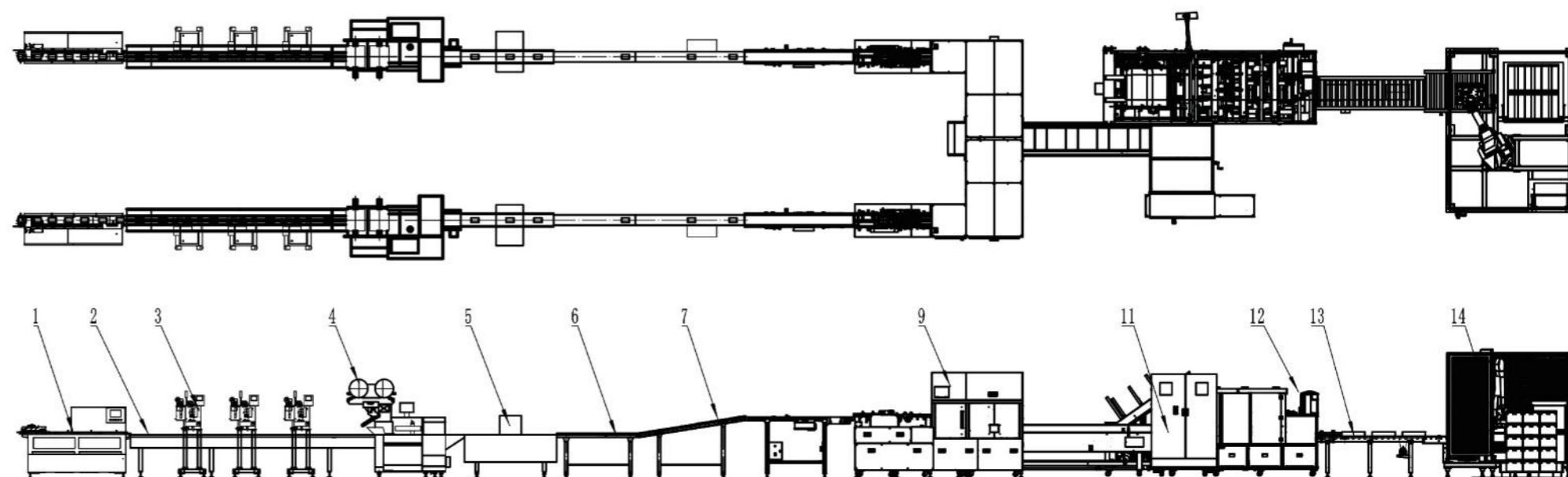

# 03 全自动多包面包装线 Full auto multi-packs instant noodles packaging line

## ■ 生产过程 Process

01

面块整理

Instant noodle cake sorting machine



03

单包装袋

Single bag pillow packing machine



05

多包装箱

Multipacks cartoning machine



02

调料包投放

Seasoning sachets dispensor



04

多包袋面包装

Multi bags noodles packaging machine



06

码垛

Palletizer



这是全自动多包方便面包装线，包括：

方便面整理供料机、单袋枕式包装机、集积器、多袋枕式包装机、多包装箱机、机器人码垛系统、输送系统。

整条线的产量可根据客户需求定制。

This is full auto multipacks instant noodles packaging line, includes: instant noodles sorting machine, single bag pillow packing machine, accumulator, multi bags pillow packing machine, multi-packs cartoning machine, robot palletizing system, conveyor system.

The capacity of the whole line can be customized based on customer needs.

## ■ 设备布局图 Equipment layout

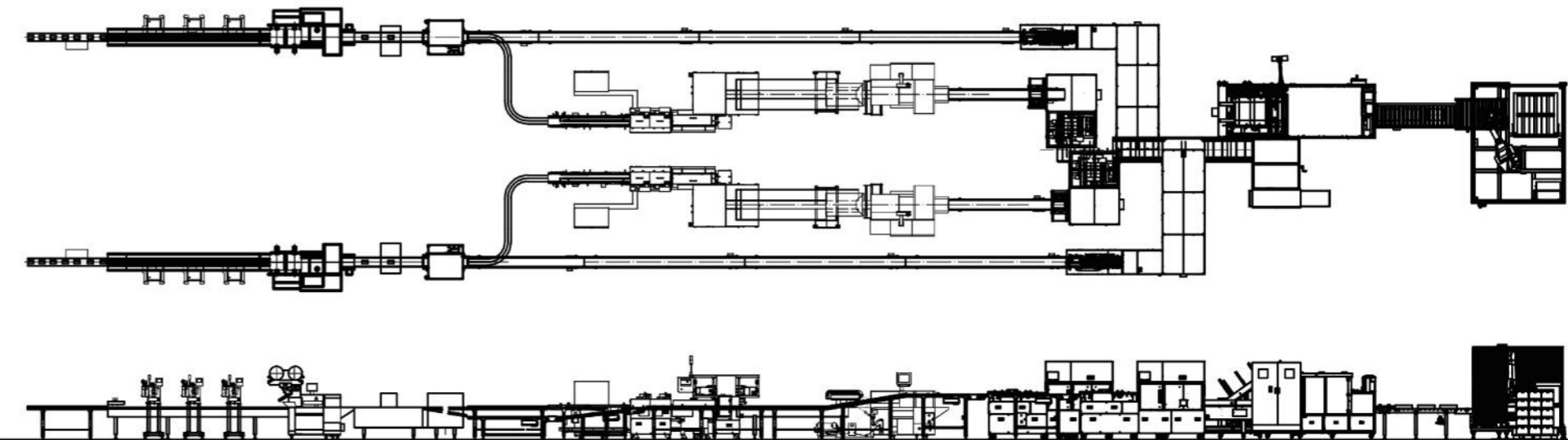



# 04 全自动杯面碗面桶面整理供料膜包装箱码垛线

Full auto cup bowl bucket instant noodles sorting feeding shrinking wrapping cartoning palletizer line

## ■ 生产过程 Process



该包装线包括:

杯/碗/桶整理供料, 热收缩薄膜包装机, 装箱机(装盒)和码垛机。

可用于包装杯面、碗面、桶面, 整条线的产量可根据客户需求定制。

This packaging line includes:

cup/bowl/bucket sorting feeding, heat shrink film wrapping machine, accumulator, case packer(cartoning) and palletizer.

Can be used for packaging cup noodles, bowl noodles and bucket noodles, the capacity of the whole line can be customized based on customer needs.

## ■ 设备布局图 Equipment layout

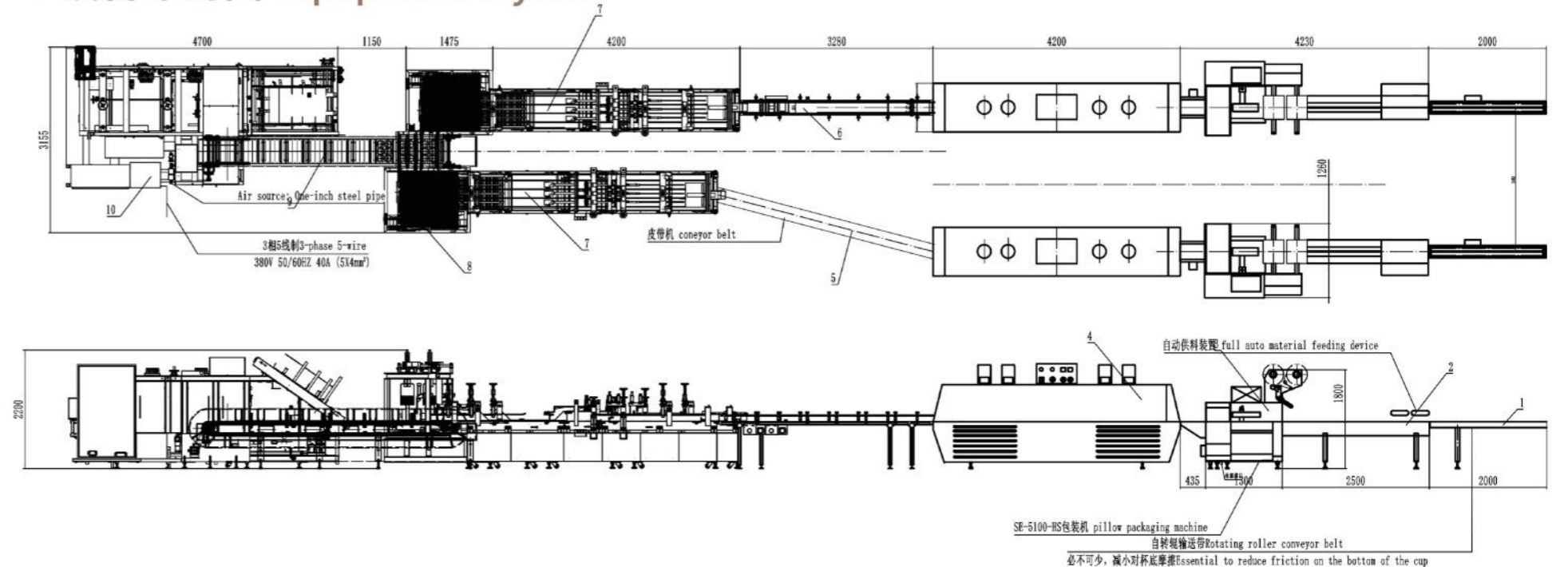



# 01 | 自动理料机

Instant noodles sorting machine

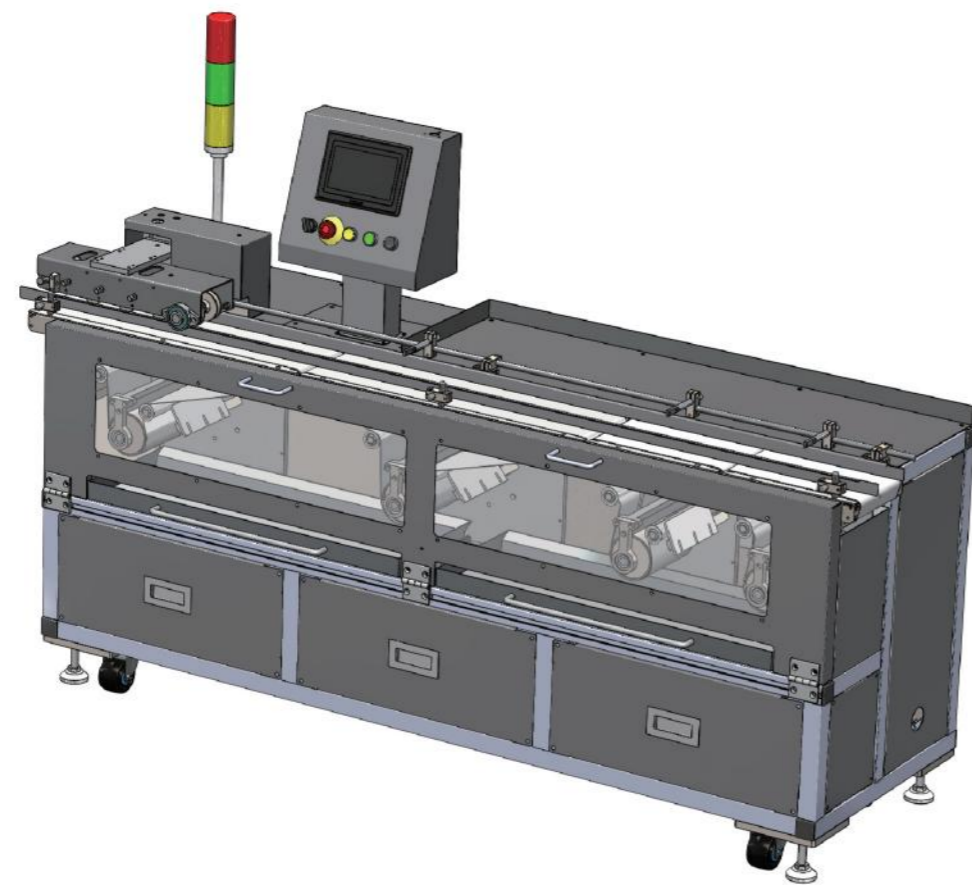

自动理料机采用多段伺服理料原理，对前端面线连续紧挨来料进行定位分离、位置修正、同步输送等动作，保证面块和包装机传送带推杆同步运行，实现自动上料。

The automatic instant noodles sorting machine adopts the principle of multi sets servo motors sorting, and performs positioning, separation, position correction, synchronous conveying and other actions on the front-end instant noodles continuously close to the incoming material, ensuring that the noodle blocks and the packaging machine conveyor belt push rod operate synchronously to achieve automatic loading material.

# 02 | XDJ-2000料包投放机

Seasoning sachets dispenser

## 参数 Parameter

设备型号 Model	XDJ-2000-B
动作流程 Action Process	Cut the package and place it on the product on the transportation line
运行速度 Running speed	200 bags/min (when bag length is 80mm)
电源、功率 Power, power	Power supply: 220V Power: 450W
设备尺寸 Equipment size	L=650mm; W=700mm; H=1400mm
PLC控制系统 PLC control system	japanpanasonic
触摸屏 HMI	Taiwan WEINVIEW
检测传感器 Detection sensor	Omron, Keyence
伺服电机 servo motor	Japan panasonic
本体和外罩材质 Body and cover material	SUS304
气动元件 Pneumatic Components	Japan SMC

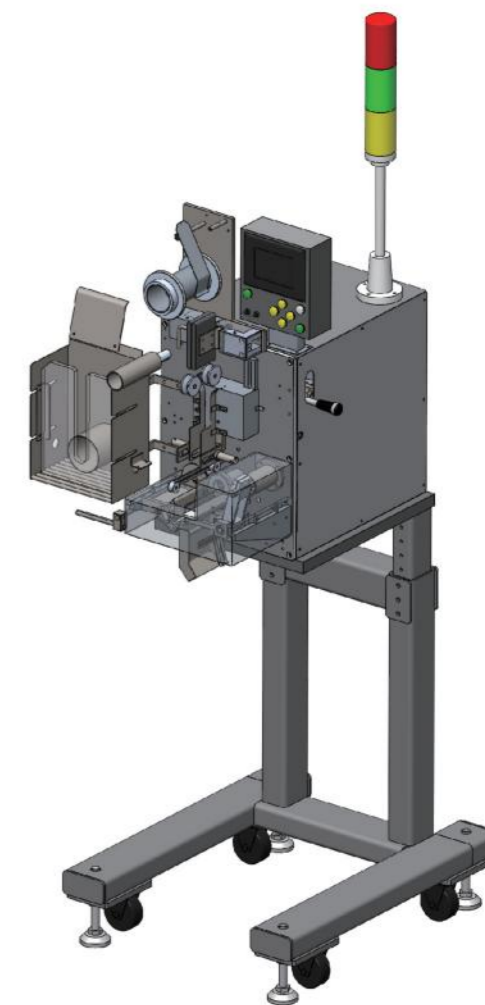

XDJ-2000型自动调味包投放机在其顶部设有投料装置，自动将调味包放置在方便面块上。

The XDJ-2000 automatic seasoning sachet placing machine is equipped with a second-floor feeding device, automatically place seasoning packets on the instant noodles blocks.



# 03 | 单包枕式包装机

Single bag instant noodles pillow packaging machine

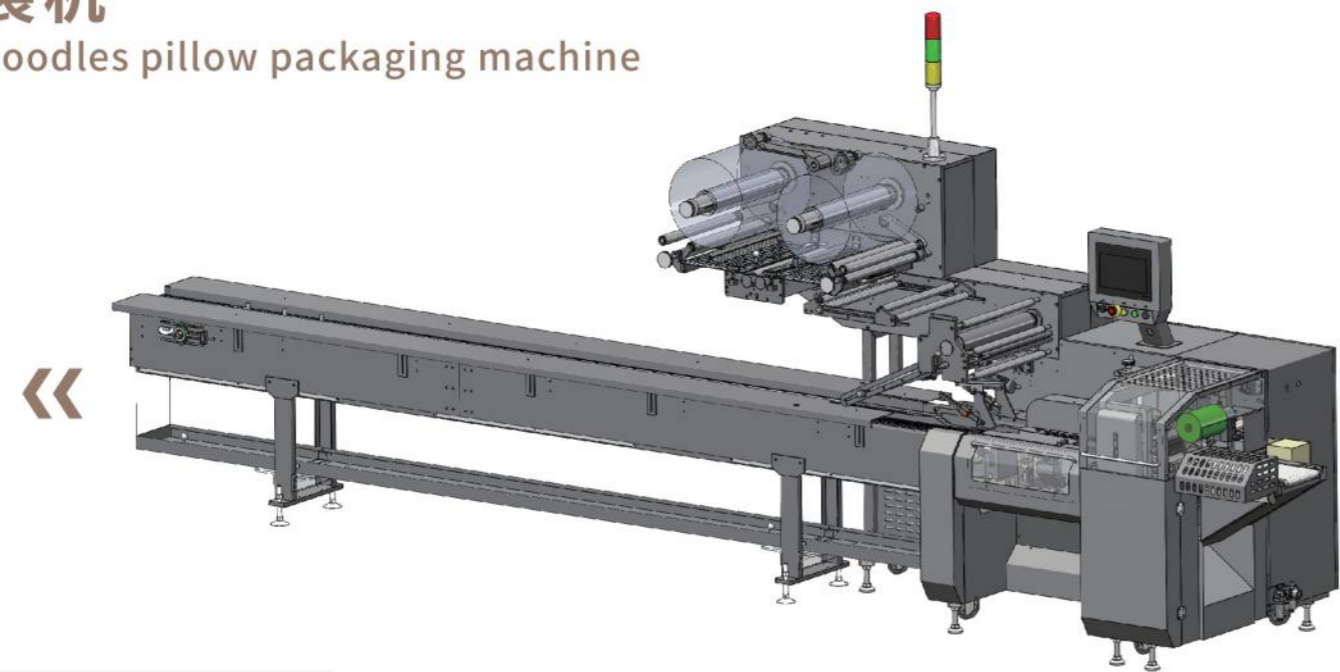

## 参数 Parameter

设备型号 Device model	枕式包装机 Pillow packaging machine
动作流程 Action Process	Pack and seal the products after being fed into bags by the small bag feeding machine
运行速度 Running speed	150~180 packs/min continuously adjustable
包膜种类 Type of coating	The maximum width of roll film is 300mm
电源、功率 Power, power	Power supply: 380V 3Ph power 9KW
气压 Air pressure	0.5-0.6MPa
设备尺寸 Equipment size	L=4000mm; W=1200mm; H=1600mm
PLC控制系统 PLC control system	Fuji

触摸屏 HMI	Japanese Fuji 10-inch touch screen
伺服电机 Servo motor	Fuji
减速机 Reducer	Japan's new treasure, New's Dart
气动元件 Pneumatic Components	Japan SMC
光电传感器 Photoelectric Sensors	Japan Keyence/Germany SICK/Japan OMRON/Swiss BMO
轴承 Bearing	Well-known brands such as NSK, NTN, Nihonbenben, and HRB
皮带 Belt	Siegelin food grade belt imported from Germany

# 03 | 单包枕式包装机

Single bag instant noodles pillow packaging machine

S-5020A枕式包装机是采用6轴全伺服驱动技术，对各个部件稳定性都有提高。

跟之前的老型号相比，以下部分做了升级：

1. 整机的防锈性能提高，采用较多的不锈钢零件；
2. 供膜部分采用独立的伺服电机控制，提升稳定性能；
3. 拉膜机构和封底也采用独立的电机控制，提升稳定性；
4. 加强之前易损的零部件。

The packaging machine adopts several servo drive technology, which improves the stability of each component. Compared with the previous old model, the following parts have been upgraded:

1. The anti-rust performance of the whole machine is improved, and more stainless steel parts are used;
2. The film supply part is controlled by an independent servo motor to improve stable performance;
3. The film pulling mechanism and the middle seal are also controlled by independent motors to improve stability;
4. Reinforce previously vulnerable parts.

## 主要功能 Main function

主要完成方便面、面包等产品的整理、定位、输送、卷膜成型、自动包装、封底、两端封切等功能。根据特殊需求，可增加自动接膜、空袋排出等辅助功能。

It mainly performs the functions of sorting, positioning and conveying products like instant noodles, breads, etc, roll film forming, automatic packaging, bottom sealing, sealing and cutting at both ends. According to specific needs, auxiliary functions such as automatic film splicing and empty bag discharge can be added.

## 主要组成部分 The main components

- |   |  |   |
|---|--|---|
| ① 双伺服自动送料机构<br>① Dual servo automatic feeding mechanism | ④ 自动接膜装置<br>④ Automatic film splicing device | ⑥ 上下皮带整理装置<br>⑥ Upper and lower belt sorting device |
| ② 2.5米定位输送带<br>② 2.5-meter positioning conveyor belt    | ⑤ 制袋及中封<br>⑤ Bag making & middle sealing     | ⑦ 熔合端封装置<br>⑦ Fusing end sealing device             |
| ③ 自动供膜系统<br>③ Automatic film supply system              |  |   |



# 04 | 单包面集积器+装箱机

Single bag instant noodles accumulator + cartoning machine

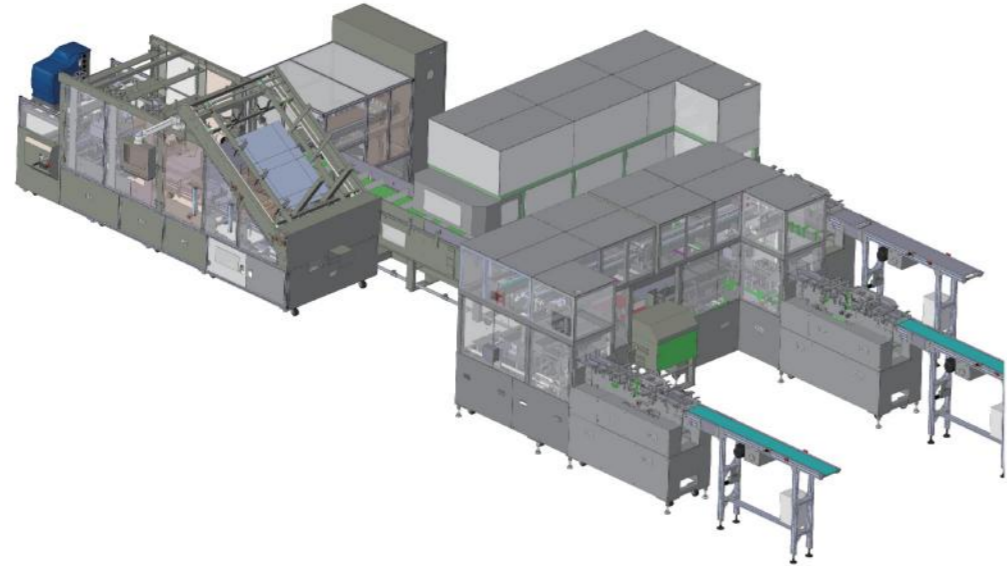

袋装方便面装箱机都由一台主机、一个工位式料格输送带和一个或多个收集整理装置（以下简称“积集器”）等这三部分构成。主机部分和输送带部分基本相同，不同形式的袋装面全自动装箱机的主要区别在于不同形式的集积器。

The bagged instant noodles cartoning machine consists of three parts: a host machine, a station-type material grid conveyor belt, and one or more collection and sorting devices (hereinafter referred to as "accumulators"). The main machine part and the conveyor belt part are basically the same. The main difference between different forms of bagged instant noodles automatic cartoning machines lies in the different forms of accumulators.

# 04 | 单包面集积器+装箱机

Single bag instant noodles accumulator + cartoning machine

## ■ 参数 Parameter

<b>设备型号</b> Device model	Cartoning machine	<b>软件接口设置</b> Software interface settings  配置三菱MES模块，预留PLC数据网络输出端口，可输出信息：  设备当前状态： 开机、待机、故障停机及设备当前故障信息；  设备操作信息： 当前操作人员；  设备产量信息： 总产量，当班计划产量，当前产量，当前良品，当前不良品等；  设备运行信息： 设备总运行时间，设备当班运行时间；  Configure Mitsubishi MES module and reserve PLC data network output port to output information:  The current status of the equipment: power on, standby, fault shutdown and current fault information of the equipment;  Equipment operation information: current operator;  Equipment output information: total output, planned output on shift, current output, current good products, current defective products, etc.;  Equipment operation information: total equipment operation time, equipment operation time on duty;
<b>动作流程</b> Action Process	单包自动集积、片式裹包、热溶胶封合 Single package automatic accumulation, sheet wrapping, hot melt sealing	
<b>集积器种类</b> Accumulator type	棘轮式集积器 Ratchet collector	
<b>集积器数量</b> Number of accumulators	4	
<b>集积器速度</b> Accumulator speed	单口180包~230包/min（根据产品不同） Single port 180 packs ~ 230 packs/min (depending on the product)	
<b>装箱机主机速度</b> Cartoning machine host speed	22箱/min（根据产品不同） 22 boxes/min (depending on the product)	
<b>纸箱兼容范围</b> Carton compatibility range	L=320mm-480mm; W=200mm-380mm; H=100-250mm;	
<b>电源、功率</b> Power, power	电源：380V 3Ph 功率23KW Power supply: 380V 3Ph power 23KW	
<b>气压</b> Air pressure	>0.6Mpa 800L/min	
<b>设备尺寸</b> Equipment size	Length 8076×width 3600×height 1808mm	
<b>设备重量</b> Equipment weight	4770kg	
<b>常规换产时间</b> Routine delivery time	≤60min	



## 05 | 多包集积器 + 多包枕式包装机

Multi bags accumulator + pillow packaging machine

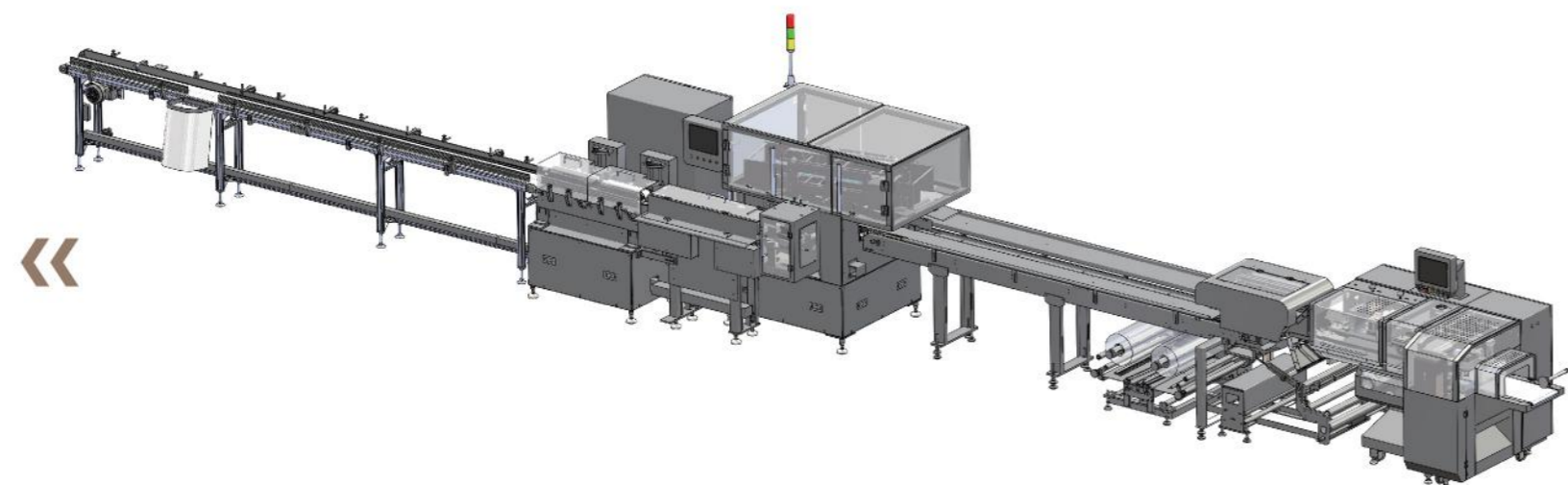

### ■ 参数 Parameter

包装速度 Packaging speed	≤20m/min (depends on products)
包装膜宽度 Packaging film width	≤750mm
包装产品尺寸范围 Packaging product size range	W≤280mm H≤140mm (depends on products)
设备尺寸 Equipment dimension	L=6500mm;W=1300mm;H=1700mm
整机重量 Weight	1500kg

## 05 | 多包集积器 + 多包枕式包装机

Multi bags accumulator + pillow packaging machine

此机器为多包集积器 + 多包枕式包装机组合而成，用于把多袋单包方便面包在一个大袋子里，主要有以下特点：

1. 整机采用多轴伺服控制，经济型机型，稳定性高；
2. 传送带、供膜、端封三部位均可实现单动，更好地满足不同产品的包装要求；
3. 可搭配自动接膜，实现不停机换膜；
4. 人机界面可编程触摸屏；
5. 独特的下供膜设计，针对特定产品包装保证设备稳定性。

This machine is a combination of multi-pack accumulator + multi-pack pillow packaging machine. It is used to pack multiple bags of single-pack instant noodle into a large bag. It has the following main features:

1. The whole machine adopts multi-axis servo control, economical model and high stability;
2. The conveyor belt, film supply, and end sealing parts can all achieve single movement to better meet the packaging requirements of different products;
3. Can be equipped with automatic film splicing to achieve film replacement without stopping the machine;
4. Human-machine interface programmable touch screen;
5. Unique lower film supply design ensures equipment stability for specific product packaging.



# 06 | 多包袋面装箱机

Multi packs instant noodles cartoning machine

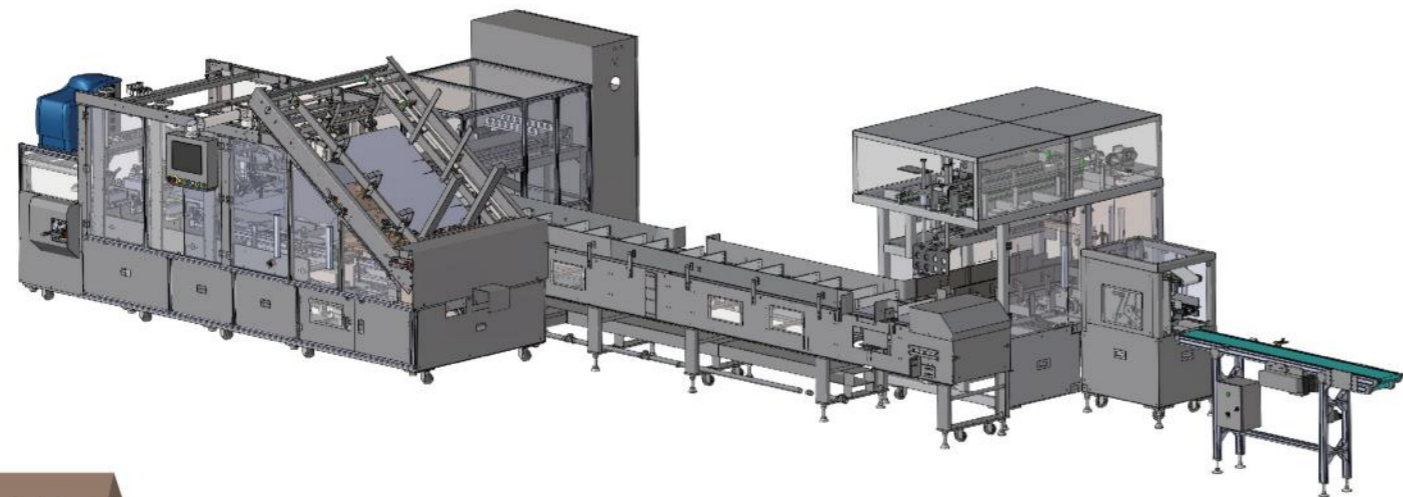

多包入全自动装箱机，是专门为集合包方便面等产品而开发的裹包式自动装箱机，用原有的片式裹包主机配置集合包集积器和升降叠双层机构组合而成。能够实现单个多包入集合包方便面到多个一组的高速自动计数积集，并且能够实现全自动装箱，从而实现生产过程的全自动。该机型并且可以兼容一层和二层的不同装箱形式，满足客户的兼容性需求。其单口稳定集积生产速度可达到50包/分钟，主机生产速度满足22箱/min。

The multi-pack fully automatic cartoning machine is a wrap-type automatic cartoning machine specially developed for packaged instant noodles and other products. It uses the original sheet-type wrapping host to configure a package accumulator and a lifting and stacking double-layer mechanism. It can complete high-speed automatic counting and accumulation from a single multi-pack of instant noodles to multiple groups, and can realize fully automatic packing, thereby realizing the full automation of the production process. This model is also compatible with different packaging forms on the first and second layers to meet the compatibility needs of customers. Its single-port stable integrated production speed can reach 50 packs/min, and the host production speed can reach 22 boxes/min.

# 06 | 多包袋面装箱机

Multi packs instant noodles cartoning machine

## ■ 参数 Parameter

设备型号 Device model	WDC-240DM	<b>软件接口设置</b> Software interface settings  配置三菱MES模块，预留PLC数据网络输出端口，可输出信息：  设备当前状态： 开机、待机、故障停机及设备当前故障信息；  设备操作信息： 当前操作人员；  设备产量信息： 总产量，当班计划产量，当前产量，当前良品，当前不良品等；  设备运行信息： 设备总运行时间，设备当班运行时间；  Configure Mitsubishi MES module and reserve PLC data network output to output information:  Current status of the equipment: power on, standby, fault shutdown and current fault information of the equipment;  Equipment operation information: current operator;  Equipment output information: total output, planned output on shift, current output, current good products, current defective products, etc.;  Equipment operation information: total equipment operation time, equipment operation time on duty;
流程 Process	集合包自动集积、片式裹包、热熔胶封合 Automatic accumulation of collection packages, sheet wrapping, and hot melt sealing	
集积器种类 Accumulator type	料格式集积器 Material format accumulator	
集积器数量 Number of accumulators	2	
集积器速度 Accumulator speed	单口40~50包/min (根据产品不同) Single port 40~50 packs/min (depending on the product)	
装箱机主机速度 Cartoning machine host speed	22箱/min (根据产品不同) 22 boxes/min (depending on the product)	
纸箱兼容范围 Carton compatibility range	L=320mm-480mm; W=200mm-380mm; H=100-350mm;	
电源、功率 Power, power	电源：380V 3Ph 功率23KW Power supply: 380V 3Ph power 23KW	
气压 Air pressure	>0.6Mpa 800L/min	
设备尺寸 Equipment size	Length 7019×Width 4752×H1808mm	
设备重量 Equipment weight	4270kg	
常规换产时间 Routine delivery time	≤60min	



# 07 | 杯面碗面桶面热收缩膜包机

Cup/bowl/bucket instant noodles heat shrinking wrapping machine

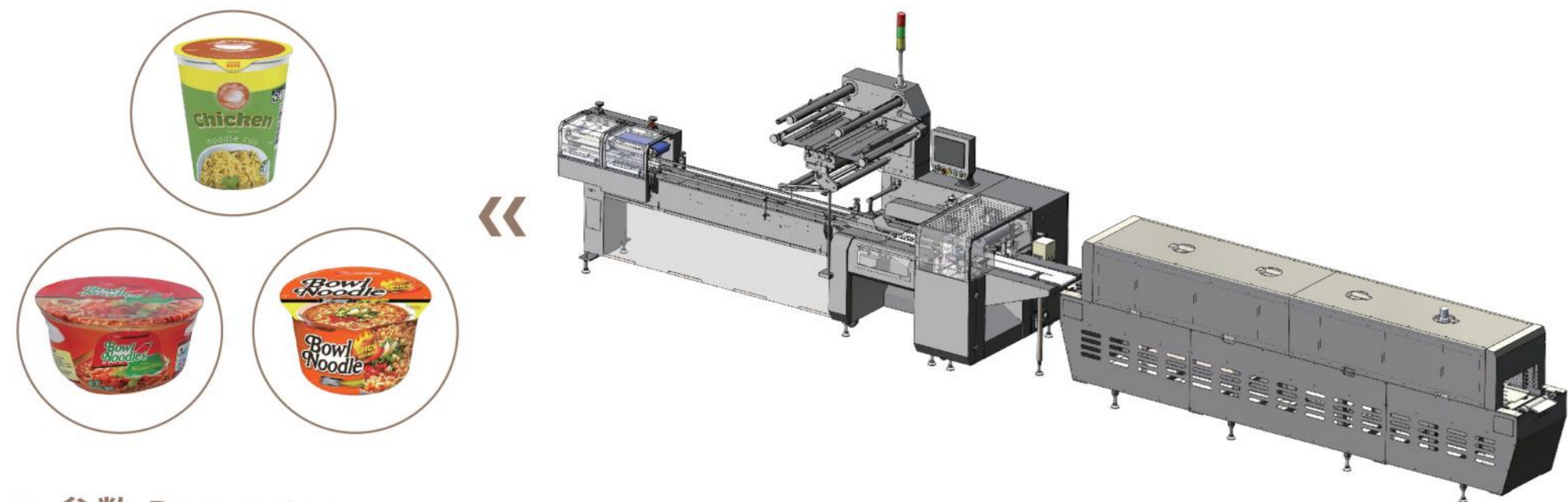

## ■ 参数 Parameter

包装速度 Packaging speed	50m/Min (Depends on product specifications)
包装膜宽度 Packaging film width	≤650mm
包装产品尺寸范围 Packaging product size range	W≤280mm 50mm≤H≤120mm (Depends on product specifications)
整机功率 Total power	5kW
热缩炉功 Heat shrink furnace power	23KW (Depends on product specifications)

主机尺寸 Host size	L=4500; W=1350; H=1850mm
整机重量 Weight	1500kg

# 07 | 杯面碗面桶面热收缩膜包机

Cup/bowl/bucket instant noodles heat shrinking wrapping machine

此机器用于桶杯碗面以及其他产品的热收缩膜包装，  
此机器主要有以下特点：

1. 整机三轴伺服控制，经济型机型，稳定性高；
2. 传送带、供膜、端封三部位均可实现单动，更好地满足不同产品的包装要求；
3. 可搭配自动接膜，实现不停机换膜；
4. 人机界面可编程触摸屏；
5. 包装机中封采用静电吸附式，节省包材，收缩效果美观；
6. 可根据不同包装速度选择合适的热收缩炉长度，保证收缩效果。

This machine is used for heat shrinkable film packaging of cups, bowls, buckets instant noodles and other products.  
This machine mainly has the following features:

1. Multi-axis servo control of the whole machine, economical model, high stability;
2. The conveyor belt, film supply, and end sealing parts can all achieve single movement to better meet the packaging requirements of different products;
3. Can be equipped with automatic film splicing to achieve film replacement without stopping the machine;
4. Human-machine interface programmable touch screen;
5. The middle seal of the packaging machine adopts electrostatic adsorption type, which saves packaging materials and has beautiful shrinkage effect;
6. The appropriate heat shrink furnace length can be selected according to different packaging speeds to ensure the shrinkage effect.



# 08 | 杯面碗面桶面装箱机

## Cup/bowl/bucket instant noodles cartoning machine

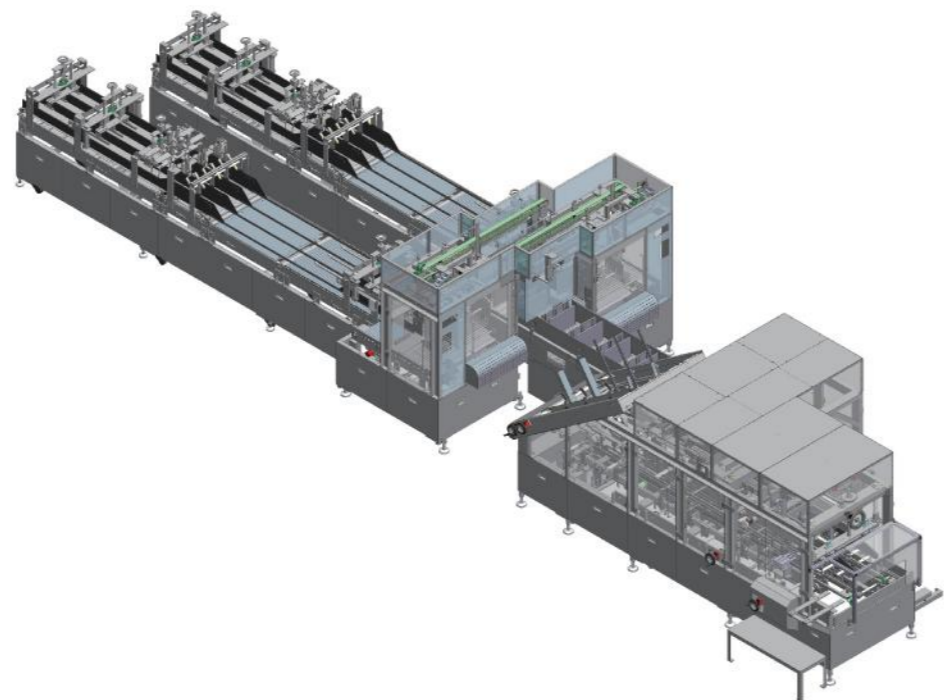

全自动装箱机，是专门为桶装、碗装、杯装等方便面等产品而开发的系列裹包式自动装箱机，用片式裹包主机配置桶面分列整理输送带和桶面集积器等模块组合而成。

该设备可实现桶面等产品分道、正反翻转、集积叠层整理、输送和产品裹包装箱封箱功能。主要包含多通道整理输送机、集积器和自动装箱机三大部分。

该机型并且可以兼容一层和二层的不同装箱形式，满足客户的兼容性需求。其单口最高集积生产速度可达到180桶/分钟，主机生产速度满足30箱/min。

The fully automatic cartoning machine is a series of wrap-type automatic cartoning machines specially developed for instant noodles in buckets, bowls, cups and other products. It is composed of a chip wrapping host equipped with modules such as a sorting conveyor belt and an accumulator.

This equipment can complete the functions of lane separation, forward and reverse flipping, accumulation and stacking sorting, transportation and product wrapping and carton packaging and carton sealing for cup/bowl/bucket noodles. It mainly includes three parts: multi-channel sorting conveyor, accumulator and automatic cartoning machine. This model is also compatible with different packaging forms on the first and second layer to meet the compatibility needs of customers. The maximum accumulator production speed of a single input can reach 180 barrels/min, and the cartoning machine production speed can reach 30 cartons/min.

# 08 | 杯面碗面桶面装箱机

## Cup/bowl/bucket instant noodles cartoning machine

### 参数 Parameter

设备型号 Device model	WDC-350WM	<b>软件接口设置</b> Software interface settings	配置三菱MES模块，预留PLC数据网络输出端口，可输出信息；
动作流程 Action Process	桶面自动分列、正反翻倒、集积叠层、片式裹包、热溶胶封合 Automatic cup/bowl/bucket noodles sorting, front and back flipping, stacking, carton sheet wrapping, and hot melt sealing		设备当前状态： 开机、待机、故障停机及设备当前故障信息；
集积器种类 Accumulator type	升降式集积器 Lifting accumulator		设备操作信息： 当前操作人员；
集积器数量 Number of accumulators	2		设备产量信息： 总产量，当班计划产量，当前产量，当前良品，当前不良品等；
集积器速度 Accumulator speed	单口160~180包/min（根据产品不同） Single input 160~180 packs/min (depending on the product)		设备运行信息： 设备总运行时间，设备当班运行时间；
装箱机主机速度 Cartoning machine host speed	30箱/min（根据产品不同） 30 boxes/min (depending on the product)		Configure Mitsubishi MES module and reserve PLC data network output port to output information:
纸箱兼容范围 Carton compatibility range	L=350mm-450mm; W=200mm-350mm; H=150-300mm;		The current status of the equipment: power on, standby, fault shutdown and current fault information of the equipment;
电源、功率 Power, power	Power supply: 380V 3Ph power 23KW		Equipment operation information: current operator;
气压 Air pressure	>0.6Mpa 800L/min		Equipment output information: total output, planned output on shift, current output, current good products, current defective products, etc.;
设备尺寸 Equipment size	Length 11229mm × Width 3154mm × Height 1808mm		Equipment operation information: total equipment operation time, equipment operation time on duty;
设备重量 Equipment weight	5570kg		
常规换产时间 Routine delivery time	≤60min		