

公司简介



浙江方大合金科技有限公司，作为中国五金行业龙头企业方大控股有限公司的控股子公司，成立于2012年，是一家致力于生产适用于多个行业用硬质合金产品，集设计，开发，生产销售于一体的生产企业。特别是硬质合金电锤钻头，木工刀具，锯齿片，开孔器，矿山用钎片，球齿，棒材，板材，旋转锉，非标等复杂产品，在国内外享有盛誉。产品远销欧美，中东，东南亚，非洲等国家和地区，深受广大客户的欢迎和信赖。

依托母公司积聚的实力，我司装备了整套生产高档硬质合金所必需的生产，研发，检测设备。检测设备齐全，检验方法科学，管理先进。同时本公司技术力量雄厚，拥有一批经验丰富的生产技术骨干，还聘请了行业内经验丰富的粉料，模具，压制，烧结等高级工程师和教授级高工，他们在各自的领域都有着几十年的技术生产管理经验，为我司生产，研发高质量以及稳定质量的硬质合金产品打下了坚实的基础。目前公司已拥有五项专利，具有年产600吨各种类型的硬质合金制品的能力。

公司本着“以客户为中心，为用户提供全方位服务”为原则，提供各种以客户要求为中心设计生产的产品。同时，根据我司所具备的开发经验，为客户打造相关领域的产品。

Company Overview



Fangda Cemented Carbide Technology Co., Ltd(FDCC), a wholly owned subsidiary of Fangda Holding Co., Ltd-leading company in the field of hardware in china was set up in 2001.It specializes in manufacturing, designing, R&D, producing and selling tungsten carbide products. Its tungsten carbide tips for wood-cutting tools, saw tips, tips for hollow saw, tips for hammer drill bit , tips for coal mining tools, buttons for DTH button bit, rods, strips, rotary bur heads, irregular & - complicated products, ect enjoy a good reputation in china. The products are sold to countries and areas in Europe and America, Middle East, Eastern-South Asia, Africa, etc and are warmly welcomed and trusted by the customers.

Aiming at customers' needs and provide perfect service for customers as its policy. FDCC offers the service to manufacture different kinds of tungsten carbide products according to the customers' requirements. Also, with its rich experience, the company also serves to design and manufacture specialized products for customers. FDCC warmly welcome customers domestically and abroad.

硬质合金牌号\性能\应用 Carbide Grade\Property\Application

国标牌号 GB Grade	ISO牌号 ISO Grade	硬度 HRA≥	密度 (g/cm ³)≥	抗弯强度 (N/mm ²)≥	应用Application
FD05E	-	87.8	14.95	2500	特粗晶粒合金，适用于水泥路修复铣刨齿。 Extra coarse grain size, suitable for milling and shaping teeth in cement road repair.
FD10E	-	87.6	14.90	2700	特粗晶粒合金，适用于沥青路修复铣刨齿。 Extra coarse grain size, suitable for milling teeth in asphalt road repair.
FD05A	G05	90.5	14.93	3000	适用于球齿、潜孔钻头球齿。 Suitable for making button bit, DTH button bit.
FD15	G15	88.9	14.71	2870	适用于球齿、潜孔钻头球齿。 Suitable for making button bit, DTH button bit.
FD40E	G40	85.8	14.30	2800	特粗晶粒合金，适用于截煤齿。 Extra coarse grain size, suitable for making coal mining teeth.
YG8	G10	90.3	14.73	2950	适用于地质勘探，煤炭采掘。钻进煤层无矽化面页岩钾盐。岩盐及其它均质岩石。亦适用于中硬砂岩，灰岩及软硬交替的岩石。也适用于建工钻头。 Suitable for geological exploration and coal mining. Drilling into coal seams without silicified shale potassium salts. Rock salt and other homogeneous rocks. It is also suitable for medium hard sandstone, limestone, and rocks with alternating softness and hardness. Also applicable to construction drill bits.

硬质合金牌号\性能\应用 Carbide Grade\Property\Application

国标牌号 GB Grade	ISO牌号 ISO Grade	硬度 HRA≥	密度 (g/cm ³)≥	抗弯强度 (N/mm ²)≥	应用Application
YG95	-	87.9	14.58	2650	适用于冲击回转钻头的钎片及、球齿、钻凿中硬及坚硬层。也适用于建工钻头。 Suitable for impact rotary drill bits, including - drill bits, buttons, and drilling hard and hard layers. Also applicable to construction drill bit.
YG11C	-	87.2	14.40	2730	适用于冲击回转钻头的钎片及矿用牙轮钻、球齿、钻凿坚硬层。也适用于建工钻头。 Suitable for drill bits with impact and rotation, as well as mining cone drills, ball teeth, and drilling hard and hard layers. Also applicable to construction drill bits.
YG13C	G30	86.7	14.18	2850	适用于制造石油牙轮钻及截煤齿。 Suitable for making tri-cone bits and coal mining teeth.
YG16C	-	85.8	13.85	2950	适用于制造石油牙轮钻及金刚石复合片基托。 Suitable for manufacturing oil-field tri-cone bit and diamond composite disc bases.

煤炭采掘用硬质合金
Carbide Inserts for Coal Mining Tools

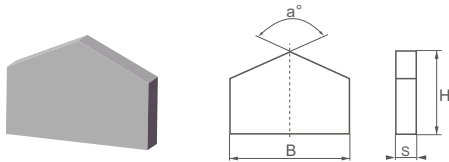

型号 Type	Dimension(mm)			
	B	H	S	a°
FM1306	6.0	5.0	1.4	130
FM1311	11.0	9.0	2.0	130
FM1313	13.0	10.0	2.5	130
FM1315	15.0	10.0	2.5	130
FM1317	17.0	13.0	3.0	130
FM1319	19.0	13.0	3.0	130
FM1322	22.0	15.0	3.5	130
FM1326	26.0	18.0	4.5	130
FM1333	33.0	22.0	3.0	130
FM1345	45.0	27.0	9.0	130

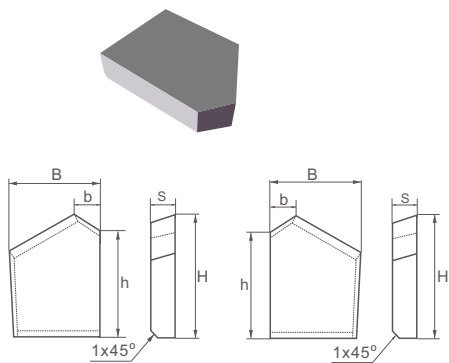

左刀
LEFT

右刀
RIGHT

型号 Type	Dimension(mm)			
	B	H	S	b
FM1011	11.0	12.0	2.5	4.0
FM1014	14.0	19.0	3.8	4.0
FM1015	15.0	22.0	3.0	5.0
FM1018	18.0	22.0	6.0	5.0

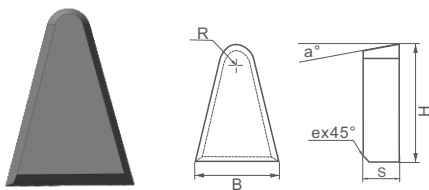

型号 Type	Dimension(mm)					
	B	H	S	R	e	a°
FM1216	16.0	22.0	7.0	6.0	1.0	15
FM1220	20.0	27.0	8.0	7.0	1.0	15
FM1222	22.0	22.0	7.5	8.0	1.5	10
FM1230	30.0	35.0	12.0	9.0	1.0	8

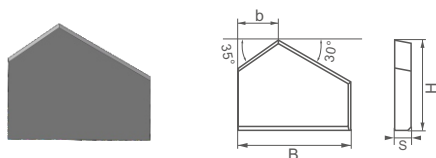

型号 Type	Dimension(mm)			
	B	H	S	b
FM1115	15.0	12.0	2.4	5.3
FM1118	18.0	15.0	3.0	6.5

* Customization is available to customers' requirement.

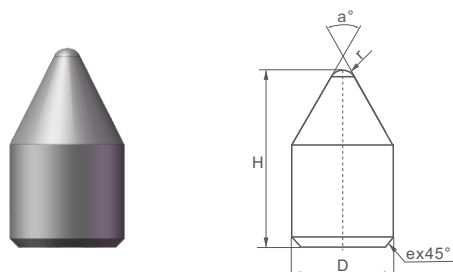

型号 Type	Dimension(mm)				
	D	H	r	a°	e
FM2009	9.0	16.0	1.0	90	1.0
FM2012A	12.0	18.0	1.5	82	1.0
FM2012B	12.0	20.0	1.5	82	1.5
FM2018	18.0	32.0	1.5	82	2.0

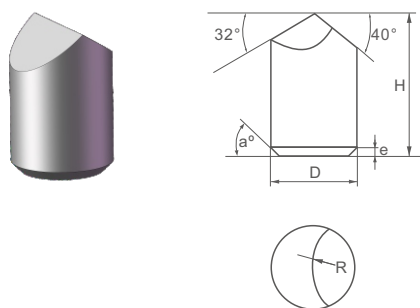

型号 Type	Dimension(mm)				
	D	H	R	e	a°
FM2110A	10.0	18.0	8.0	1.0	30
FM2110B	10.0	20.0	5.5	1.0	45
FM2112A	12.0	20.0	6.5	1.0	45
FM2112B	12.5	25.0	10.0	1.0	30
FM2115	15.0	22.0	11.0	2.5	30
FM2118	18.0	20.0	14.4	1.5	45

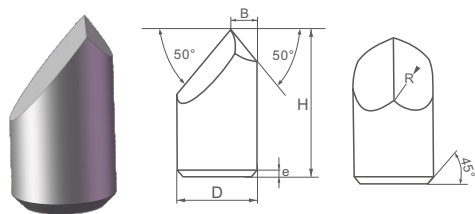

型号 Type	Dimension(mm)				
	D	H	R	e	B
FM2210A	10.0	18.0	8.0	1.0	4.0
FM2210B	10.0	20.0	8.0	1.0	4.0
FM2212A	12.0	22.0	9.0	1.0	4.0
FM2212B	12.5	25.0	9.0	2.0	4.0
FM2214	14.0	22.0	10.0	2.0	4.0
FM2216	16.0	28.0	8.0	2.0	5.0
FM2218	18.0	21.0	11.0	2.0	5.0

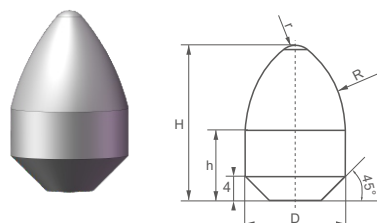

型号 Type	Dimension(mm)				
	D	H	h	R	r
FM2417A	17.0	26.5	12.0	26.0	1.8
FM2417B	17.0	26.5	12.0	26.0	1.8

* Customization is available to customers' requirement.