



泉州市凯鹰电源电器有限公司  
KAIYING POWER SUPPLY & ELECTRICAL EQUIP CO.,LTD



# E 企业简介 >>>>>>>>

## ENTERPRISE BRIEF INTRODUCTION

KaiYing Power Supply & Electrical Equip Co., Ltd. (LONGWAY Battery) is specialized in the research, design, manufacture and sales of Valve Regulated Lead Acid (VRLA) battery. Now it has 2 production plants, more than 100,000 square meters of standardized factory buildings and more than 1,000 employees.

Since establishment, KaiYing Power Supply & Electrical Equip Co., Ltd. dedicated in development of plates and batteries products. The company has strong technical force, advanced production, testing equipment, professional production of well-known brands LONGWAY battery. More than 80,000 batteries per day, the annual capacity of 2,000,000KVAh.

LONGWAY batteries covered by nominal voltage 2V, 4V, 6V, 8V, 12V, 18V, 24V rated capacity 0.8AH~3000AH. The performance of the battery products are reached or exceed IEC, BS, JIS standards. The product has the advantages of high capacity, small size, long life, light weight etc.. Products are widely used in telecommunications, power, defense, railway, bank and the national trunk line network key engineering industries, and power ups, EPS power supply, electric tools, electric toys, battery sound and weighing equipment. Products are exported to Europe and America, Middle East, Southeast Asia and other countries and regions.



# W 车间照片 >>>>>>

## ORK ROM PHOTO



# C 证书照片 >>>>>>

## ERTIFICATION PHOTO





# P 产品目录 >>>>>> PRODUCT CATALOG

产品特点 .....	04
6v小密蓄电池标准系列 .....	05
12v小密蓄电池标准系列 .....	06
中密蓄电池标准系列 .....	08
大密蓄电池标准系列 .....	09
电子秤用蓄电池系列 .....	09
童车/滑板车用蓄电池系列 .....	10
音响用蓄电池系列 .....	11
储能蓄电池系列 .....	12
EV蓄电池系列 .....	13
高功率蓄电池系列 .....	14
前置端子蓄电池系列 .....	14
Gel蓄电池系列 .....	15
特性曲线 .....	16
端子图说明 .....	17
注意事项 .....	18
Features .....	04
6v Small Capacity Battery Standard Series .....	05
12v Small Capacity Battery Standard Series .....	06
Medium Capacity Battery Standard Series .....	08
Large Capacity Battery Standard Series .....	09
Electronic Scale Battery Series .....	09
Children Car & Scooter Battery Series .....	10
Audio Battery Series .....	11
Solar Storage Battery Series .....	12
EV Battery Series .....	13
High Rate Battery Series .....	14
Front Terminal Battery Series .....	14
Gel Battery Series .....	15
Characteristic Curve .....	16
Terminal Diagram Description .....	17
Warning .....	18

## P 产品特点 >>>>>> RODUCT FEATURES

- High reliability, safe and leak-free. It has the advantage of continuous charging without leakage when the battery inversion . Can be used in any direction.
- Stable quality. The product performance between the same batch of products and between different batches of products is basically the same.
- The best Storage performance and low self-discharge rate. The average monthly self-discharge rate of the battery is less than 2.5%. After the battery is fully charged and stored 12 months, it can still be used normally without affecting the battery life.
- Strong resistance to over-discharge and best recovery. With a unique lead paste formula and plate matching design, it has superior over-discharge resistance.
- Environmentally friendly products. Meet the EU battery directive RoHS and REACH standards. No contains toxic substances.
- High Energy Density and best Vibration resistance.
- LONGWAY battery has a long service life due to its solid metal grid and special adhesive board.
- High charging reception capability.
- Maintenance free. Maintenance is not required during the use, and maintenance costs are reduced.
- Wide operating temperature range, LONGWAY battery can be discharged over at a temperature range of  $-20\text{ }^{\circ}\text{C}$  to  $+60\text{ }^{\circ}\text{C}$ , and charged at at a temperature range of  $-20\text{ }^{\circ}\text{C}$  to  $+50\text{ }^{\circ}\text{C}$
- Battery performance meets international standards such as EN/IEC61056-2012 (International Electrotechnical Commission), JIS C8702-1-2003 (Japanese Industrial Standard), UL 1989 (US Safety Standard), etc.

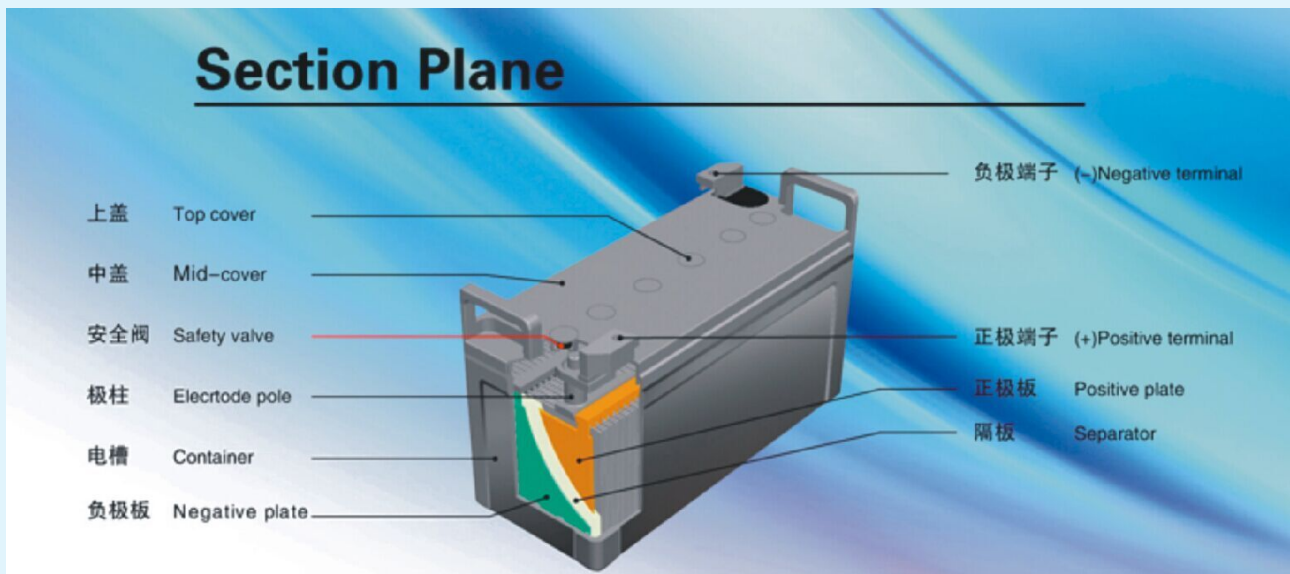



## 6V 小密蓄电池标准系列 6V small capacity battery standard series

LONGWAY's small valve-regulated sealed lead-acid battery standard series meet the requirements for general equipment use. Our company uses AGM technology and valve-controlled sealing technology to ensure that the battery design life is more than 5 years.

### 产品系列 Product series

电池型号 Battery Model	额定电压/V Nominal Voltage	容量 Capacity Ah(20HR)	长 Length		宽 Width		高 Height		总高 Total Height		重量 weight(±3%)		端子 Terminal	
			mm	in	mm	in	mm	in	mm	in	kg	lbs	型号 Type	位置 Position
2FM3.5	4	3.5	3.5	3.54	34	1.34	60	2.36	66	2.60	0.44	0.97	F1	C
2FM4	4	4.0	4.0	1.87	47.5	1.87	101	3.98	106	4.17	0.45	0.99	F1	D
2FM4.5	4	4.5	4.5	1.87	47.5	1.87	101	3.98	106	4.17	0.49	1.08	F1	D
2FM5	4	5.0	5.0	1.87	47.5	1.87	101	3.98	106	4.17	0.55	1.21	F1	D
2FM10	4	10	10	4.02	44.5	1.75	94.5	3.72	101	3.98	0.95	2.09	F1	D
3FM1.2	6	1.2	1.2	3.82	24	0.94	52	2.05	58	2.28	0.29	0.64	F1	C
3FM2.8	6	2.8	2.8	2.60	33	1.30	97.5	3.84	104	4.09	0.55	1.21	F1	A
3FM3.2H	6	3.2	3.2	5.28	34.5	1.36	59.5	2.34	65.5	2.58	0.60	1.32	F1	C
3FM3.2B	6	3.2	3.2	1.87	47.5	1.87	101	3.98	106	4.17	0.51	1.12	F1	D
3FM4E	6	4.0	4.0	2.76	47.5	1.87	99	3.90	105	4.13	0.62	1.37	F1/F2	A
3FM4	6	4.0	4.0	2.76	47.5	1.87	99	3.90	105	4.13	0.66	1.46	F1/F2	A
3FM4.5	6	4.5	4.5	2.76	47.5	1.87	99	3.90	105	4.13	0.73	1.61	F1/F2	A
3FM5E	6	5.0	5.0	2.76	47.5	1.87	99	3.90	105	4.13	0.74	1.63	F1/F2	A
3FM5	6	5.0	5.0	2.76	47.5	1.87	99	3.90	105	4.13	0.78	1.72	F1/F2	A
3FM4U/T7	6	4.0	4.0	2.68	68	2.68	98	3.86	116	4.57	0.74	1.63	T7/Spring	B
3FM5S/T8	6	5.0	5.0	2.68	68	2.68	98	3.86	116	4.57	0.80	1.76	S/F1	B
3FM6.5	6	6.5	6.5	3.86	56	2.20	113	4.45	118	4.65	1.18	2.60	F1/F2	A
3FM7	6	7.0	7.0	5.94	35	1.38	94	3.70	100	3.94	1.02	2.25	F1/F2	C
3FM7.2	6	7.2	7.2	5.94	35	1.38	94	3.70	100	3.94	1.05	2.31	F1/F2	C
3FM7.5	6	7.5	7.5	5.94	35	1.38	94	3.70	100	3.94	1.11	2.45	F1/F2	C
3FM8	6	8.0	8.0	3.86	56	2.20	115	4.53	115	4.53	1.40	3.09	F1/F2	B
3FM10	6	10.0	10.0	5.94	50	1.97	94	3.70	100	3.94	1.50	3.31	F1/F2	C
3FM12	6	12.0	12.0	5.94	50	1.97	94	3.70	100	3.94	1.64	3.62	F1/F2	C
3FM13	6	13.0	13.0	4.25	71	2.80	140	5.51	140	5.51	2.05	4.52	F3/T3	E
3FM14	6	14.0	14.0	4.25	71	2.80	140	5.51	140	5.51	2.27	5.00	F3/T1/T2	E
3FM20	6	20.0	20.0	6.18	83	3.27	127	5.00	126	4.96	3.50	7.72	F5	C

### 使用领域: Applications

Security System	Geophysical Equipment
Vending Machine	Medical Equipment
UPS	Electrical Test Equipment

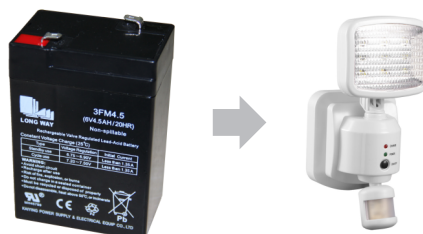

## 12V 小密蓄电池标准系列 12V small capacity battery standard series

LONGWAY's small valve-regulated sealed lead-acid battery standard series meet the requirements for general equipment use. Our company uses AGM technology and valve-controlled sealing technology to ensure that the battery design life is more than 5 years.

### 产品系列 (一) Product series (1)

电池型号 Battery Model	额定电压/V Nominal Voltage	容量 Capacity Ah(20HR)	长 Length		宽 Width		高 Height		总高 Total Height		重量 weight(±3%)		端子 Terminal	
			mm	in	mm	in	mm	in	mm	in	kg	lbs	型号 Type	位置 Position
6FM0.8	12	0.8	96.5	3.80	25	0.98	62	2.44	62	2.44	0.30	0.66	T4/T5	L
6FM1.2	12	1.2	97.5	3.84	43	1.69	52	2.05	58	2.28	0.56	1.23	F1	E
6FM2.0T	12	2.0	151	5.94	20	0.79	90	3.54	90	3.54	0.62	1.37	PC	F
6FM2.4	12	2.4	178.5	7.03	35	1.38	61.5	2.42	67	2.64	0.92	2.03	F1	F
6FM2.2	12	2.2	70.5	2.78	47.5	1.87	99	3.90	104	4.09	0.71	1.57	F1	C
6FM2.6B	12	2.6	70.5	2.78	47.5	1.87	99	3.90	104	4.09	0.85	1.87	F1	C
6FM2.6A	12	2.6	105	4.13	48	1.89	70	2.76	70	2.76	0.89	1.96	PC	F
6FM2.9	12	2.9	79.5	3.13	56	2.20	99	3.90	104	4.09	1.00	2.20	F1	D
6FM3	12	3	90	3.54	47	1.85	100	3.94	106	4.17	0.95	2.09	F1	C
6FM3R	12	3.5	90	3.54	47	1.85	100	3.94	106	4.17	1.10	2.43	F1	C
6FM3.2H	12	3.3	134	5.28	67	2.64	59.5	2.34	66	2.60	1.20	2.65	F1/F2	E
6FM4	12	4	90	3.54	70	2.76	101	3.98	107	4.21	1.30	2.87	F1/F2	C
6FM4F	12	4	90	3.54	70	2.76	101	3.98	107	4.21	1.28	2.82	F1/F2	C
6FM4.5	12	4.5	90	3.54	70	2.76	101	3.98	107	4.21	1.43	3.15	F1/F2	C
6FM5	12	5	90	3.54	70	2.76	101	3.98	107	4.21	1.55	3.42	F1/F2	C
6FM5U	12	5	90	3.54	70	2.76	101	3.98	107	4.21	1.35	2.98	F1/F2	C
6FM5E	12	5	90	3.54	70	2.76	101	3.98	107	4.21	1.48	3.26	F1/F2	C
6FM5R	12	5	90	3.54	70	2.76	99	3.90	104	4.09	1.60	3.53	F1	C
6FM3.5D	12	3.5	151	5.94	51.5	2.03	94	3.70	100	3.94	1.35	2.98	F1/F2	F
6FM4.5D	12	4.5	151	5.94	51.5	2.03	94	3.70	100	3.94	1.65	3.64	F1/F2	F
6FM5.5D	12	5.5	151	5.94	51.5	2.03	94	3.70	100	3.94	1.70	3.75	F1/F2	F
6FM6R	12	6	151	5.94	51.5	2.03	94	3.70	100	3.94	1.75	3.86	F1/F2	F
6FM6	12	6	151	5.94	65	2.56	94	3.70	100	3.94	1.92	4.23	F1/F2	F
6FM7	12	7	151	5.94	65	2.56	94	3.70	100	3.94	1.96	4.32	F1/F2	F
6FM7.2	12	7.2	151	5.94	65	2.56	94	3.70	100	3.94	2.05	4.52	F1/F2	F

### 使用领域: Applications

Security System	Geophysical Equipment
Vending Machine	Power Tools
Electronic Cash Registers	Smart Appliances

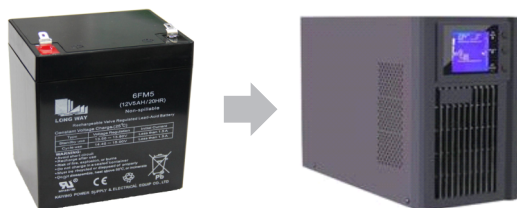



## 12V 小密蓄电池标准系列 12V small capacity battery standard series

LONGWAY's small valve-regulated sealed lead-acid battery standard series meet the requirements for general equipment use. Our company uses AGM technology and valve-controlled sealing technology to ensure that the battery design life is more than 5 years.

### 产品系列 (二) Product series (2)

电池型号 Battery Model	额定电压/V Nominal Voltage	容量 Capacity Ah/20HR	长 Length		宽 Width		高 Height		总高 Total Height		重量 weight(±3%)		端子 Terminal	
			mm	in	mm	in	mm	in	mm	in	kg	lbs	型号 Type	位置 Position
6FM8U	12	8	151	5.94	65	2.56	94	3.70	100	3.94	2.10	4.63	F1/F2	F
6FM8E	12	8	151	5.94	65	2.56	94	3.70	100	3.94	2.25	4.96	F1/F2	F
6FM9U	12	9	151	5.94	65	2.56	94	3.70	100	3.94	2.27	5.00	F1/F2	F
6FM9R	12	9	151	5.94	65	2.56	94	3.70	100	3.94	2.62	5.78	F1/F2	F
6FM6.5Y	12	6.5	225	8.86	47	1.85	100	3.94	106	4.17	2.05	4.52	F1/F2	C
6FM7.5Y	12	7.5	225	8.86	47	1.85	100	3.94	106	4.17	2.25	4.96	F1/F2	C
6FM9Y	12	9	225	8.86	47	1.85	100	3.94	106	4.17	2.80	6.17	F1/F2	C
6FM10A	12	10	151	5.94	65	2.56	111	4.37	117	4.61	2.75	6.06	F2	F
6FM10	12	10	151	5.94	98	3.86	93	3.66	99	3.90	3.00	6.61	F2	F
6FM12	12	12	151	5.94	98	3.86	93	3.66	99	3.90	3.24	7.14	F2	F
6FM12R	12	14	151	5.94	98	3.86	96	3.78	102	4.02	4.00	8.82	F2	F
6FM14	12	14	151	5.94	98	3.86	96	3.78	102	4.02	3.85	8.49	F2	F
6FM11	12	11	134	5.28	80	3.15	161	6.34	161	6.34	4.10	9.04	F5	C
6FM13NB	12	13	134	5.28	80	3.15	161	6.34	161	6.34	4.50	9.92	F5	C
6FM18BI/BF	12	18	181	7.13	77	3.03	166	6.54	166	6.54	4.85	10.69	F2/F5/I2	D
6FM18A	12	18	181	7.13	77	3.03	166	6.54	166	6.54	5.40	11.90	F5	D
6FM20	12	20	181	7.13	77	3.03	166	6.54	166	6.54	5.95	13.12	F5/I2	D
9FM4.5	18	4.5	151	5.94	65	2.56	94	3.70	100	3.94	2.15	4.74	F2	A
9FM7	18	8	151	5.94	98	3.86	94	3.70	100	3.94	2.95	6.50	F2	A
12FM5E	24	5	137	5.39	91	3.58	101	3.98	107	4.21	2.95	6.50	F2	C
12FM5H	24	5	137	5.39	91	3.58	101	3.98	107	4.21	3.25	7.16	F2	C
12FM8D	24	8	188	7.40	102	4.02	94.5	3.72	100	3.94	4.50	9.92	F2	D
12FM10	24	10	193	7.60	152	5.98	93	3.66	99	3.90	6.00	13.23	F2	D
12FM13	24	13	193	7.60	152	5.98	93	3.66	99	3.90	7.20	15.87	F2	D

### 使用领域: Applications

Security System	Geophysical Equipment
Vending Machine	Power Tools
Electronic Cash Registers	Smart Appliances

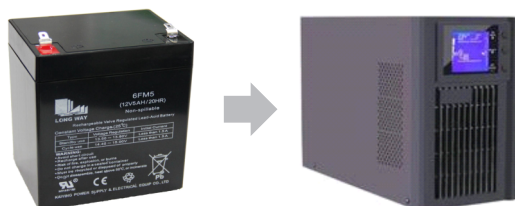



## 中密蓄电池标准系列 Medium capacity battery standard series

LONGWAY's medium capacity valve-regulated sealed lead-acid battery standard series meet the requirements for general equipment use. Our company uses AGM technology and valve-controlled sealing technology to ensure that the battery design life is more than 8 years.

### 产品系列 Product series

电池型号 Battery Model	额定电压/V Nominal Voltage	容量 Capacity Ah/20HR	长 Length		宽 Width		高 Height		总高 Total Height		重量 weight(±3%)		端子 Terminal	
			mm	in	mm	in	mm	in	mm	in	kg	lbs	型号 Type	位置 Position
3FM42B	6	42	162	6.38	88	3.46	163	6.42	170	6.69	5.85	12.90	F2/F5	A
3FM180G	6	180	306	12.05	168	6.61	222	8.74	227	8.94	25.80	56.88	I4	A
3FM200G	6	200	323	12.72	178	7.01	224	8.82	248	9.76	29.50	65.04	F15	A
4FM200U	8	200	260	10.24	180	7.09	280	11.02	285	11.22	36.00	79.37	17	C
6FM24G	12	24	175	6.89	166	6.54	125	4.92	125	4.92	7.50	16.53	F8/I1	D
6FM26G	12	26	175	6.89	166	6.54	125	4.92	125	4.92	8.25	18.19	F2/F8/I1	D
6FM28A/G	12	28	166	6.54	126	4.96	175	6.89	178	7.01	8.50	18.74	F9/I3	D
6FM33G	12	33	195	7.68	130	5.12	161	6.34	166	6.54	9.80	21.61	F10/I3	C
6FM35G	12	35	195	7.68	130	5.12	161	6.34	166	6.54	10.30	22.71	F10/I3	C
6FM40G	12	40	196	7.72	166	6.54	175	6.89	182	7.17	13.00	28.66	F9/I5	D
6FM50G	12	50	229	9.02	138	5.43	209	8.23	229	9.02	15.80	34.83	F25/I3	C
6FM55G	12	55	229	9.02	138	5.43	209	8.23	229	9.02	17.20	37.92	F25/I3	C
6FM60B	12	60	258	10.16	169	6.65	175	6.89	180	7.09	17.70	39.02	I4	D
6FM65G	12	65	350	13.78	166	6.54	175	6.89	175	6.89	21.00	46.30	F13/I3	D
6FM70G	12	70	260	10.24	169	6.65	211	8.31	231	9.09	21.30	46.96	F12/I4	C
6FM80A/G	12	80	307	12.09	167	6.57	211	8.31	231	9.09	25.40	56.00	F12/I6	C
6FM90G	12	90	307	12.09	167	6.57	211	8.31	231	9.09	26.50	58.42	F12/I6	C
6FM100A/G	12	100	331	13.03	173	6.81	217	8.54	222	8.74	28.90	63.71	F17/F18/I6	C
6FM120B	12	120	331	13.03	173	6.81	217	8.54	222	8.74	31.00	68.34	I6	C
6FM100U	12	100	331	13.03	173	6.81	219	8.62	244	9.61	28.30	62.39	F16/I5	C
6FM100D/G	12	100	405	15.94	173	6.81	210	8.27	237	9.33	32.00	70.55	F19	C
6FM120G	12	120	405	15.94	173	6.81	210	8.27	237	9.33	35.00	77.16	F19	C
6FM150G	12	150	485	19.09	170	6.69	241	9.49	241	9.49	44.00	97.00	F20/I7	C
6FM160B/G	12	160	532	20.94	207	8.15	215	8.46	244	9.61	51.50	113.54	F21/F11	E
6FM180	12	180	522	20.55	238	9.37	219	8.62	238	9.37	50.50	111.33	F22	E
6FM200G	12	200	522	20.55	238	9.37	219	8.62	238	9.37	58.00	127.87	F22/I7	E
6FM220G	12	220	521	20.51	269	10.59	220	8.66	238	9.37	68.00	149.91	F21/F11	E
6FM230	12	230	521	20.51	269	10.59	203	7.99	221	8.70	65.00	143.30	F21	F
6FM250	12	250	521	20.51	269	10.59	220	8.66	238	9.37	71.00	156.53	F21	E

### 使用领域：Applications

Medical Equipment	Office Microprocessor
Control Equipment	Communication System
UPS	Backup Power
Emergency Lighting Device	

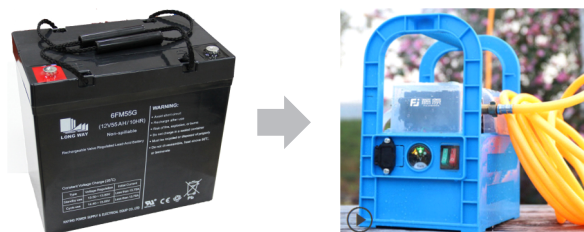



## 大密蓄电池标准系列 Large capacity battery standard series

LONGWAY's Large valve-regulated sealed lead-acid battery standard series meet the requirements of communication and power equipment. Our products are developed with the latest technology in the world and have a design life of 15 years.

### 产品系列 Product series

电池型号 Battery Model	额定电压/V Nominal Voltage	容量 Capacity Ah/20HR	长 Length		宽 Width		高 Height		总高 Total Height		重量 weight(±3%)		端子 Terminal	
			mm	in	mm	in	mm	in	mm	in	kg	lbs	型号 Type	位置 Position
FM100	2	100	171	6.73	72	2.83	205	8.07	210	8.27	6.00	13.23	I7	A
FM200	2	200	172	6.77	111	4.37	335	13.19	365	14.37	13.30	29.32	I7	G
FM300	2	300	172	6.77	151	5.94	340	13.39	365	14.37	18.50	40.79	I7	G
FM350	2	350	172	6.77	151	5.94	340	13.39	340	13.39	19.00	41.89	I7	G
FM400	2	400	211	8.31	175	6.89	336	13.23	365	14.37	25.50	56.22	I7	H
FM500	2	500	240	9.45	173	6.81	338	13.31	365	14.37	30.00	66.14	I7	H
FM600	2	600	302	11.89	175	6.89	340	13.39	365	14.37	36.00	79.37	I7	H
FM800	2	800	410	16.14	176	6.93	340	13.39	365	14.37	51.00	112.43	I7	I
FM1000	2	1000	475	18.70	175	6.89	338	13.31	365	14.37	60.00	132.28	I7	I
FM2000	2	2000	491	19.33	351	13.82	344	13.54	383	15.08	110.00	242.51	I7	K
FM3000	2	3000	712	28.03	353	13.90	341	13.43	382	15.04	175.00	385.81	F13	K

### 使用领域: Applications

Communications	Signal System Backup Power
Power Systems	Nuclear Power Plant Backup Power
Solar	Wind Energy Power Storage Systems

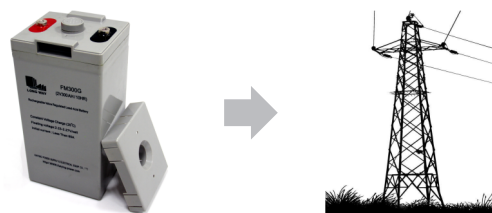

## 电子秤用蓄电池标准系列 Electronic scale battery standard series

LONGWAY battery standard series for electronic scales is designed and developed for weighing instruments. According to the characteristics of the weighting in the use of small current long-term use, low-charge state storage, frequent over-discharge, low charging voltage to design and development. Our company adopts advanced research and development technology to ensure high reliability, safety, no leakage, strong over-discharge, good recovery and long life.

### 产品系列 Product series

电池型号 Battery Model	额定电压/V Nominal Voltage	容量 Capacity Ah/20HR	长 Length		宽 Width		高 Height		总高 Total Height		重量 weight(±3%)		端子 Terminal	
			mm	in	mm	in	mm	in	mm	in	kg	lbs	型号 Type	位置 Position
2FM4	4	4.0	47.5	1.87	47.5	1.87	101	3.98	106	4.17	0.43	0.95	F1	D
2FM4.5	4	4.5	47.5	1.87	47.5	1.87	101	3.98	106	4.17	0.48	1.06	F1	D
3FM1.3	6	1.3	97	3.82	24	0.94	52	2.05	58	2.28	0.29	0.64	F1	C
3FM2.8	6	2.8	66	2.60	33	1.30	97.5	3.84	104	4.09	0.55	1.21	F1	A
3FM3.2/B	6	3.2	47.5	1.87	47.5	1.87	101	3.98	106	4.17	0.51	1.12	F1	D
3FM4	6	4.0	70	2.76	47.5	1.87	99	3.90	105	4.13	0.62	1.37	F1/F2	A
3FM4.5	6	4.5	70	2.76	47.5	1.87	99	3.90	105	4.13	0.73	1.61	F1/F2	A
3FM10	6	10.0	151	5.94	50	1.97	94	3.70	100	3.94	1.50	3.31	F1/F2	C
6FM7	12	7	151	5.94	65	2.56	94	3.70	100	3.94	2.00	4.41	F1/F2	F

### 使用领域: Applications

Bench Scales, Crane Scales	Balances
Household Human Scales	Medical Scales, Table Scales
Waterproof Scales	Floor Scales



童车/滑板车用蓄电池标准系列 Children car & Scooter battery standard series

The LONGWAY Children Car & Scooter battery series is designed and developed for children car and scooters. The special lead paste formula and internalization production process ensure the product has the advantages of long cycle life, low self-discharge rate and high temperature resistance. The design life is up to 5 years. This series of battery products meets CEC and DOE energy efficiency standards.

产品系列 Product series

电池型号 Battery Model	额定电压/V Nominal Voltage	容量 Capacity Ah(20HR)	长 Length		宽 Width		高 Height		总高 Total Height		重量 weight(±3%)		端子 Terminal	
			mm	in	mm	in	mm	in	mm	in	kg	lbs	型号 Type	位置 Position
3FM2.8	6	2.8	66	2.60	33	1.30	97.5	3.84	104	4.09	0.50	1.10	F1	A
3FM3	6	3.0	70	2.76	47.5	1.87	99	3.90	105	4.13	0.56	1.23	F1/F2	A
3FM4/E	6	4.0	70	2.76	47.5	1.87	99	3.90	105	4.13	0.62	1.37	F1/F2	A
3FM4	6	4.0	70	2.76	47.5	1.87	99	3.90	105	4.13	0.66	1.46	F1/F2	A
3FM4.5	6	4.5	70	2.76	47.5	1.87	99	3.90	105	4.13	0.73	1.61	F1/F2	A
3FM5	6	5.0	70	2.76	47.5	1.87	99	3.90	105	4.13	0.78	1.72	F1/F2	A
3FM7	6	7.0	151	5.94	35	1.38	94	3.70	100	3.94	1.02	2.25	F1/F2	C
3FM7.2	6	7.2	151	5.94	35	1.38	94	3.70	100	3.94	1.05	2.31	F1/F2	C
3FM7.5	6	7.5	151	5.94	35	1.38	94	3.70	100	3.94	1.10	2.43	F1/F2	C
3FM10	6	10.0	151	5.94	50	1.97	94	3.70	100	3.94	1.50	3.31	F1/F2	C
3FM12	6	12.0	151	5.94	50	1.97	94	3.70	100	3.94	1.64	3.62	F1/F2	C
6FM4.5	12	4.5	90	3.54	70	2.76	101	3.98	107	4.21	1.43	3.15	F1/F2	C
6FM3.5/D	12	3.5	151	5.94	51.5	2.03	94	3.70	100	3.94	1.35	2.98	F1/F2	F
6FM4.5/D	12	4.5	151	5.94	51.5	2.03	94	3.70	100	3.94	1.65	3.64	F1/F2	F
6FM5.5/D	12	5.5	151	5.94	51.5	2.03	94	3.70	100	3.94	1.70	3.75	F1/F2	F
6FM7	12	7	151	5.94	65	2.56	94	3.70	100	3.94	1.96	4.32	F1/F2	F
6FM7.2	12	7.2	151	5.94	65	2.56	94	3.70	100	3.94	2.05	4.52	F1/F2	F
6FM10	12	10	151	5.94	98	3.86	93	3.66	99	3.90	3.00	6.61	F2	F
6FM12	12	12	151	5.94	98	3.86	93	3.66	99	3.90	3.25	7.16	F2	F
6FM14	12	14	151	5.94	98	3.86	96	3.78	102	4.02	3.85	8.49	F2	F
12FM5	24	5	137	5.39	91	3.58	101	3.98	107	4.21	3.25	7.16	F2	C
12FM8	24	8	188	7.40	102	4.02	94.5	3.72	100	3.94	4.50	9.92	F2	D
6FM3/R	12	3.5	90	3.54	47	1.85	100	3.94	106	4.17	1.10	2.43	F1	C
6FM5/R	12	5	90	3.54	70	2.76	99	3.90	104	4.09	1.60	3.53	F1	C
6FM6/R	12	6	151	5.94	51.5	2.03	94	3.70	100	3.94	1.75	3.86	F1/F2	F
6FM9/R	12	9	151	5.94	65	2.56	94	3.70	100	3.94	2.62	5.78	F1/F2	F
6FM12	12	14	151	5.94	98	3.86	96	3.78	102	4.02	4.00	8.82	F2	F
6FM6.5/Y	12	6.5	225	8.86	47	1.85	100	3.94	106	4.17	2.05	4.52	F1/F2	C
6FM7.5/Y	12	7.5	225	8.86	47	1.85	100	3.94	106	4.17	2.25	4.96	F1/F2	C
6FM9/Y	12	9	225	8.86	47	1.85	100	3.94	106	4.17	2.80	6.17	F1/F2	C

使用领域: Applications

Children's Electric Tricycle	Children's Four-wheeled Stroller
Children's Drift Car	Electric Scooter





音响用蓄电池标准系列 Children car & Scooter battery standard series

LONGWAY audio battery standard series products are specially designed for battery sound/speaker . According to the characteristics of the battery sound in the process of using, such as high current, deep depth of discharge, easy over-discharge, etc., we design and development.

产品系列 Product series

电池型号 Battery Model	额定电压/V Nominal Voltage	容量 Capacity Ah/20HR	长 Length		宽 Width		高 Height		总高 Total Height		重量 weight(±3%)		端子 Terminal	
			mm	in	mm	in	mm	in	mm	in	kg	lbs	型号 Type	位置 Position
6FM2.2	12	2.2	70.5	2.78	47.5	1.87	99	3.90	104	4.09	0.71	1.57	F1	C
6FM2.6	12	2.6	70.5	2.78	47.5	1.87	99	3.90	104	4.09	0.85	1.87	F1	C
6FM3	12	3	90	3.54	47	1.85	100	3.94	106	4.17	0.95	2.09	F1	C
6FM4	12	4	90	3.54	70	2.76	101	3.98	107	4.21	1.30	2.87	F1/F2	C
6FM4.5	12	4.5	90	3.54	70	2.76	101	3.98	107	4.21	1.43	3.15	F1/F2	C
6FM5	12	5	90	3.54	70	2.76	101	3.98	107	4.21	1.55	3.42	F1/F2	C
6FM7	12	7	151	5.94	65	2.56	94	3.70	100	3.94	1.96	4.32	F1/F2	F
6FM7.2	12	7.2	151	5.94	65	2.56	94	3.70	100	3.94	2.05	4.52	F1/F2	F
6FM9	12	8.5	151	5.94	65	2.56	94	3.70	100	3.94	2.25	4.96	F1/F2	F
6FM12	12	12	151	5.94	98	3.86	93	3.66	99	3.90	3.00	6.61	F2	F
6FM12/A	12	12	151	5.94	98	3.86	93	3.66	99	3.90	3.25	7.16	F2	F
6FM14	12	14	151	5.94	98	3.86	93	3.66	99	3.90	3.50	7.72	F2	F
6FM20	12	20	181	7.13	77	3.03	166	6.54	166	6.54	5.40	11.90	F5	D
9FM4.5	18	4.5	151	5.94	65	2.56	94	3.70	100	3.94	2.15	4.74	F2	A
9FM7	18	8	151	5.94	98	3.86	94	3.70	100	3.94	2.95	6.50	F2	A
12FM5/E	24	5	137	5.39	91	3.58	101	3.98	107	4.21	2.95	6.50	F2	C
12FM9	24	8.5	188	7.40	102	4.02	94.5	3.72	100	3.94	4.50	9.92	F2	D
12FM12	24	12	193	7.60	152	5.98	93	3.66	99	3.90	6.00	13.23	F2	D
6FM24	12	24	175	6.89	166	6.54	125	4.92	125	4.92	7.50	16.53	F8	D
6FM28	12	28	166	6.54	126	4.96	175	6.89	178	7.01	8.50	18.74	F9	D
6FM35	12	35	195	7.68	130	5.12	160	6.30	180	7.09	10.30	22.71	F10	C

使用领域：Applications

Lever Sound	Portable Audio
Computer Audio	Outdoor Audio
Square Dance Audio	



## 太阳能储能用蓄电池系列 Solar storage battery series

LONGWAY solar series battery is specially designed for solar system & wind power system. According the condition of applications. According to the application environment, LONGWAY battery uses a high-density lead paste formula and a special low-density electrolyte formula to develop a new energy storage battery. This ensures high charging reception capability in a harsh charging environment.

### 产品系列 Product series

电池型号 Battery Model	额定电压V Nominal Voltage	容量 Capacity Ah/20HR	长 Length		宽 Width		高 Height		总高 Total Height		重量 weight (±3%)		端子 Terminal	
			mm	in	mm	in	mm	in	mm	in	kg	lbs	型号 Type	位置 Position
3FM200S	6	200	323	12.72	178	7.01	224	8.82	229	9.02	29.0	63.93	F15	A
6FM9S	12	9	151	5.94	65	2.56	94	3.70	100	3.94	2.6	5.73	F2	F
6FM12S	12	12	151	5.94	98	3.86	96	3.78	101	3.98	3.87	8.53	F2	F
6FM18S	12	18	181	7.13	77	3.03	167	6.57	167	6.57	5.6	12.35	F5	D
6FM20S	12	20	181	7.13	77	3.03	167	6.57	167	6.57	6.0	13.12	F5	D
6FM24S	12	24	175	6.89	166	6.54	126	4.96	126	4.96	8.2	18.08	F8	D
6FM28S	12	28	175	6.89	166	6.54	126	4.96	126	4.96	9.0	19.84	F8	D
6FM33S	12	33	195	7.68	130	5.12	161	6.34	181	7.13	10.5	23.15	F10	C
6FM40S	12	40	198	7.80	166	6.54	170	6.69	170	6.69	13.2	29.10	F9	D
6FM45S	12	45	198	7.80	166	6.54	170	6.69	170	6.69	13.70	30.20	F9	D
6FM50S	12	50	229	9.02	138	5.43	208	8.19	223	8.78	16.5	36.38	F25	C
6FM55S	12	55	229	9.02	138	5.43	208	8.19	223	8.78	17.2	37.92	F25	C
6FM65S	12	65	350	13.78	160	6.30	180	7.09	180	7.09	21.00	46.30	F13	D
6FM80S	12	80	307	12.09	167	6.57	210	8.27	215	8.46	24.0	52.91	I4	C
6FM100S	12	100	330	12.99	173	6.81	219	8.62	224	8.82	30.10	66.36	I6	C
6FM120S	12	120	405	15.94	173	6.81	210	8.27	237	9.33	34.5	76.06	F19	C
6FM140S	12	140	342	13.46	173	6.81	283	11.14	283	11.14	41.50	91.49	I6	C
6FM150S	12	150	483	19.02	170	6.69	241	9.49	241	9.49	44.5	98.10	F20	C
6FM200S	12	200	522	20.55	240	9.45	219	8.62	224	8.82	62.0	136.69	F22	E
6FM250S	12	250	522	20.55	269	10.59	219	8.62	224	8.82	74.0	163.14	F22	E

### 使用领域：Applications

Green Energy Systems	Solar
Wind	Hydro
Solar Power Stations	





## EV蓄电池系列 EV battery series

LONG WAY EV battery series are Deep Cycle series of Kaiying Power Supply & Electrical Equip Co.,Ltd. Featuring a specially designed active material and a strong grid grid, the series battery delivers reliable performance under high load conditions and provides more than 300 cycles on 100% DOD. It has high energy density and best Vibration resistance. The product performance meets the technical requirements of GB/T18332.1-2009 lead-acid battery for electric road vehicles.

### 产品系列 Product series

电池型号 Battery Model	额定电压/V Nominal Voltage	容量 Capacity Ah/20HR	长 Length		宽 Width		高 Height		总高 Total Height		重量 weight(±3%)		端子 Terminal	
			mm	in	mm	in	mm	in	mm	in	kg	lbs	型号 Type	位置 Position
EV6-150	6	150	260	10.24	180	7.09	246	9.69	250	9.84	30.0	66.14	I6	B
EV6-190	6	190	244	9.61	187	7.36	277	10.91	277	10.91	34.5	76.06	I7	B
EV6-200	6	200	260	10.24	180	7.09	272	10.71	276	10.87	36.0	79.37	I7	B
EV8-150	8	150	260	10.24	181	7.13	280	11.02	283	11.14	36.0	79.37	I7	C
EV12-70	12	70	260	10.24	168	6.61	208	8.19	212	8.35	26.2	57.76	I4	C
EV12-100	12	100	330	12.99	173	6.81	217	8.54	221	8.70	34.0	74.96	I7	C
EV12-120	12	120	405	15.94	173	6.81	210	8.27	237	9.33	43.0	94.80	I7	C
EV12-135	12	135	341	13.43	172	6.77	281	11.06	285	11.22	46.0	101.41	I6	C
EV12-150	12	150	480	18.90	171	6.73	237	9.33	237	9.33	52.0	114.64	I7	C
EV12-180	12	180	532	20.94	207	8.15	215	8.46	219	8.62	62.0	136.69	I6	E
EV12-200	12	200	522	20.55	240	9.45	219	8.62	223	8.78	70.0	154.32	I7	E

### 产品系列 Product series

电池型号 Battery Model	额定电压/V Nominal Voltage	容量 Capacity Ah/20HR	长 Length		宽 Width		高 Height		总高 Total Height		重量 weight(±3%)		端子 Terminal	
			mm	in	mm	in	mm	in	mm	in	kg	lbs	型号 Type	位置 Position
6-EVF-28	12	28	166	6.54	126	4.96	175	6.89	178	7.01	8.4	18.41	I3	D
6-EVF-35	12	33	195	7.68	130	5.12	161	6.34	166	6.54	10.0	22.05	I3	C
6-EVF-42	12	40	196	7.72	166	6.54	175	6.89	175	6.89	13.2	29.10	I5	D
6-EVF-55	12	55	229	9.02	138	5.43	208	8.19	212	8.35	16.0	35.27	I3	C
6-EVF-75	12	70	260	10.24	168	6.61	208	8.19	212	8.35	21.3	46.96	I4	C
6-EVF-120	12	120	331	13.03	173	6.81	219	8.62	222	8.74	31.00	68.34	I6	C

### 使用领域: Applications

Electric Sanitation Vehicles	Low Speed Electric Vehicles
Golf Cart, Travel Car	Old Scooter
Electrical Wheel Chair	Police Patrol Car

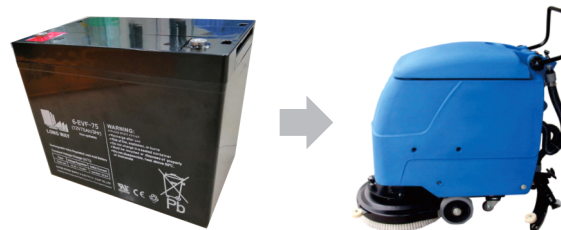

## 高功率蓄电池系列 EV battery series

LONGWAY HR series batteries are specially designed for applications that require high power output. Optimized design with high-rate lead paste formulation and radiation grid for ultra-high current output capability. High-power series batteries provide up to 40% more energy than the standard series.

### 产品系列 Product series

电池型号 Battery Model	额定电压/V Nominal Voltage	容量 Capacity Ah/20HR	长 Length		宽 Width		高 Height		总高 Total Height		重量 weight(±3%)		端子 Terminal	
			mm	in	mm	in	mm	in	mm	in	kg	lbs	型号 Type	位置 Position
6FM7L	12	7	151	5.94	65	2.56	96	3.78	108	4.25	2.27	5.00	F6	D
6FM9L	12	9	151	5.94	65	2.56	110.5	4.35	123	4.84	2.75	6.06	F6	D
6FM12L	12	12	151	5.94	98	3.86	94	3.70	105	4.13	3.55	7.83	F6	D
6FM17L	12	17	181	7.13	77	3.03	166	6.54	166	6.54	5.15	11.35	F5	D
6FM12H	12	13	151	5.94	98	3.86	98	3.86	120	4.72	3.78	8.33	F7	F
6FM14H	12	14	151	5.94	98	3.86	98	3.86	120	4.72	3.90	8.60	F7	F
6FM12H	12	12	151	5.94	98	3.86	93	3.66	99	3.90	3.50	7.72	F2	F
3FM12H	12	12	151	5.94	50.5	1.99	94	3.70	100	3.94	1.70	3.75	F2	C

### 使用领域：Applications

Jump Starter	Electric Lawn Mower
Car Backup Power	Family Emergency Power Supply



## 前置端子蓄电池系列 Front terminal battery series

LONGWAY front terminal series batteries are designed with front conversion terminal, faster installation and save floor space, long life float service design and high energy density, used in back-up power for communication and UPS system.

### 产品系列 Product series

电池型号 Battery Model	额定电压/V Nominal Voltage	容量 Capacity Ah/20HR	长 Length		宽 Width		高 Height		总高 Total Height		重量 weight(±3%)		端子 Terminal	
			mm	in	mm	in	mm	in	mm	in	kg	lbs	型号 Type	位置 Position
6FM55FR	12	55	291	11.46	106	4.17	226	8.90	235	9.25	18.0	39.68	I4	E
6FM75FR	12	75	562	22.13	115	4.53	187	7.36	196	7.72	23.5	51.81	I6	E
6FM85FR	12	85	562	22.13	115	4.53	187	7.36	196	7.72	25.5	56.22	I6	E
6FM105FR	12	105	527	20.75	110	4.33	225	8.86	232	9.13	32.5	71.65	I3	E
6FM110FR	12	110	410	16.14	110	4.33	288	11.34	295	11.61	33.5	73.85	I6	E
6FM125FR	12	125	548	21.57	109	4.29	239	9.41	239	9.41	36.0	79.37	I6	E
6FM150FR	12	150	565	22.24	110	4.33	288	11.34	295	11.61	47.0	103.62	I6	E
6FM180FR	12	180	560	22.05	125	4.92	316	12.44	316	12.44	53.3	117.51	I6	E
6FM180FR/A	12	180	546	21.50	125	4.92	323.5	12.74	323.5	12.74	52.0	114.64	I6	E

### 使用领域：Applications

Telecommunications Base Station	Power System
Energy Storage System	

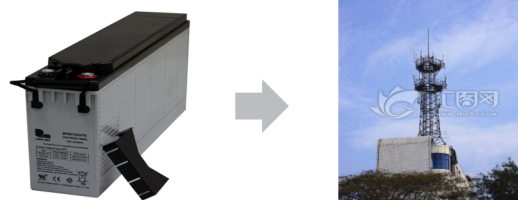



GEL蓄电池系列 GEL battery series

LONGWAY GEL series batteries contain gel electrolyte (GEL). By using a strong grid and a special paste, adding evenly distributed SiO<sub>2</sub> (gel with thixotropic properties) to the electrolyte, and using a specially designed vent valve to control the water loss rate, it can effectively extend the battery by more than 30% the service life.

产品系列 Product series

电池型号 Battery Model	额定电压/V Nominal Voltage	容量 Capacity Ah(20HR)	长 Length		宽 Width		高 Height		总高 Total Height		重量 weight(±3%)		端子 Terminal	
			mm	in	mm	in	mm	in	mm	in	kg	lbs	型号 Type	位置 Position
6FM7.2 GEL	12	7.2	151	5.94	65	2.56	94	3.70	100	3.94	2.05	4.52	F1/F2	F
6FM18 GEL	12	18	181	7.13	77	3.03	166	6.54	166	6.54	5	11.02	F2/F5/I2	D
12FM8 GEL	24	8	188	7.40	102	4.02	94.5	3.72	100	3.94	4.5	9.92	F2	D
12FM13 GEL	24	13	193	7.60	152	5.98	93	3.66	99	3.90	7.2	15.87	F2	D
3FM200 GEL	6	200	323	12.72	178	7.01	224	8.82	248	9.76	29.50	65.04	F15	A
6FM24 GEL	12	24	175	6.89	166	6.54	125	4.92	125	4.92	7.50	16.53	F8	D
6FM35 GEL	12	35	195	7.68	130	5.12	160	6.30	180	7.09	10.30	22.71	F10	C
6FM45 GEL	12	45	196	7.72	166	6.54	175	6.89	182	7.17	13.70	30.20	F9	D
6FM50 GEL	12	50	229	9.02	138	5.43	209	8.23	229	9.02	15.80	34.83	F25	C
6FM60 GEL	12	60	258	10.16	169	6.65	175	6.89	180	7.09	17.70	39.02	I4	D
6FM70 GEL	12	70	260	10.24	169	6.65	211	8.31	239	9.41	21.30	46.96	F14	C
6FM90 GEL	12	90	307	12.09	167	6.57	211	8.31	216	8.50	26.50	58.42	I6	C
6FM100 GEL	12	100	331	13.03	173	6.81	217	8.54	222	8.74	28.90	63.71	I6	C
6FM120 GEL	12	120	405	15.94	173	6.81	210	8.27	237	9.33	35.00	77.16	F19	C
6FM150 GEL	12	150	485	19.09	170	6.69	241	9.49	241	9.49	44.00	97.00	F20	C
6FM200 GEL	12	200	522	20.55	238	9.37	219	8.62	238	9.37	58.00	127.87	F22	E
6FM250 GEL	12	250	521	20.51	269	10.59	220	8.66	238	9.37	71.00	156.53	F21	E
FM200 GEL	2	200	172	6.77	111	4.37	335	13.19	365	14.37	13.30	29.32	I7	G
FM400 GEL	2	400	211	8.31	175	6.89	336	13.23	365	14.37	25.50	56.22	I7	H
FM1000 GEL	2	1000	475	18.70	175	6.89	338	13.31	365	14.37	60.00	132.28	I7	I
FM2000 GEL	2	2000	491	19.33	351	13.82	344	13.54	383	15.08	110.00	242.51	I7	K
FM3000 GEL	2	3000	712	28.03	353	13.90	341	13.43	382	15.04	175.00	385.81	F13	K
6FM110FR/GEL	12	110	410	16.14	110	4.33	288	11.34	295	11.61	33.5	73.85	I6	E
6FM180FR/GEL	12	180	560	22.05	125	4.92	316	12.44	316	12.44	53.3	117.51	I6	E

使用领域: Applications

Telecommunications Base Station

Power System

Energy Storage System





## 特性曲线图 Characteristic Curve

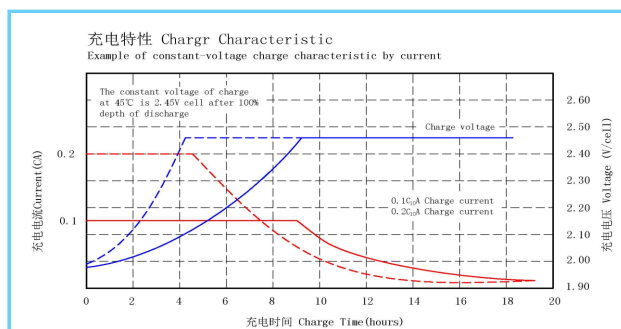
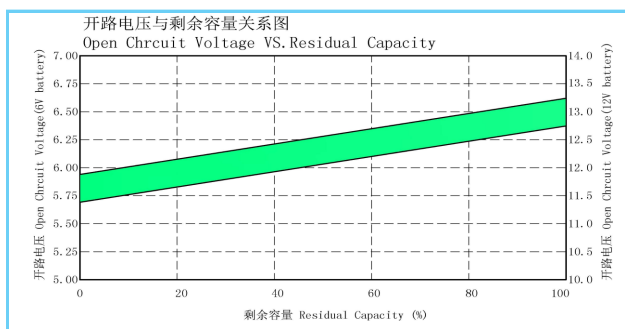
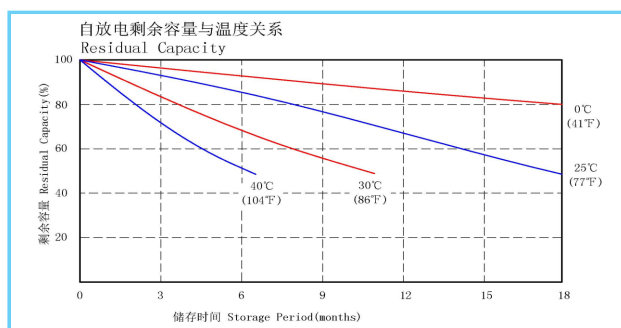
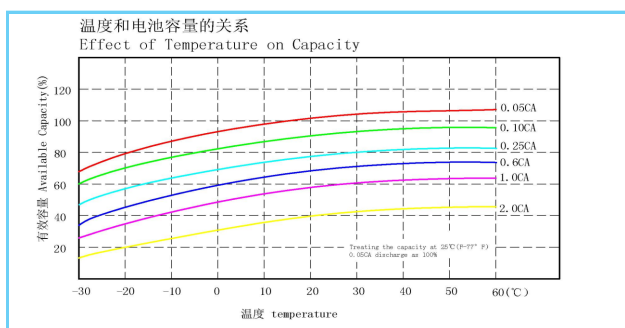
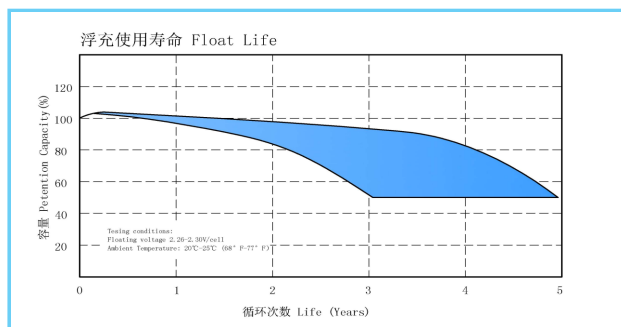
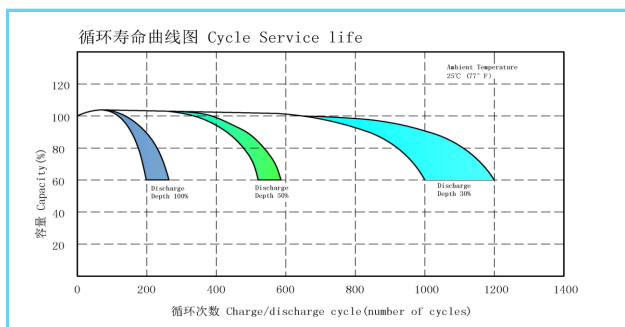

## 充电步骤 Charging Procedures

使用领域 Application	充电电压 Charge Voltage (V/cell)			最大充电电流 Max. Charge Current
	温度 Temperature	设置电压 Set Point voltage	电压范围 Allowable Range	
循环使用 Cycle use	25°C (77° F)	2.45	2.40 ~ 2.50	0.3C
浮充使用 Standby use	25°C (77° F)	2.275	2.25 ~ 2.30	

## 放电电流以及对应的终止电压 Discharge Current VS Discharge Voltage

放电终止 Final Discharge Voltage V/cell	1.75	1.70	1.65	1.60
放电电流 Discharge Current(A)	0.2C > A	0.2C < A < 0.5C	0.5C < A < 1.0C	A > 1.0C



端子图说明 Terminal Diagram Description

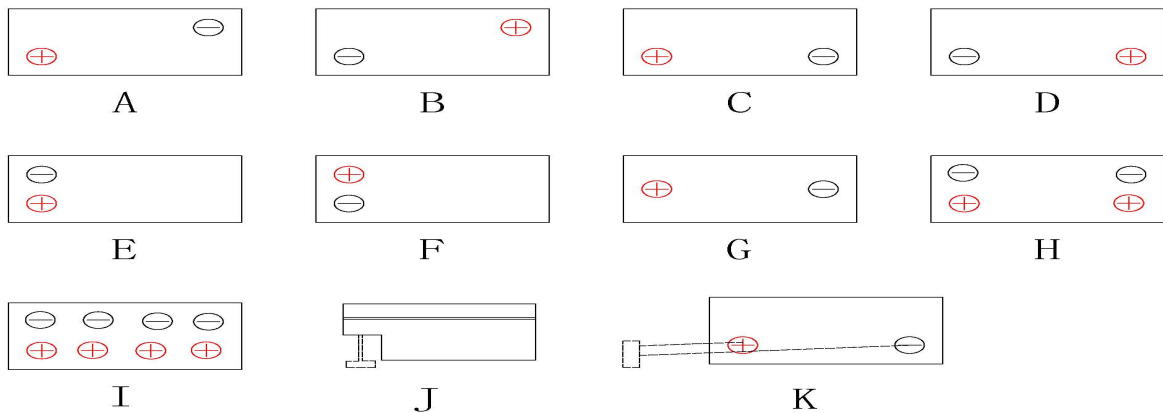
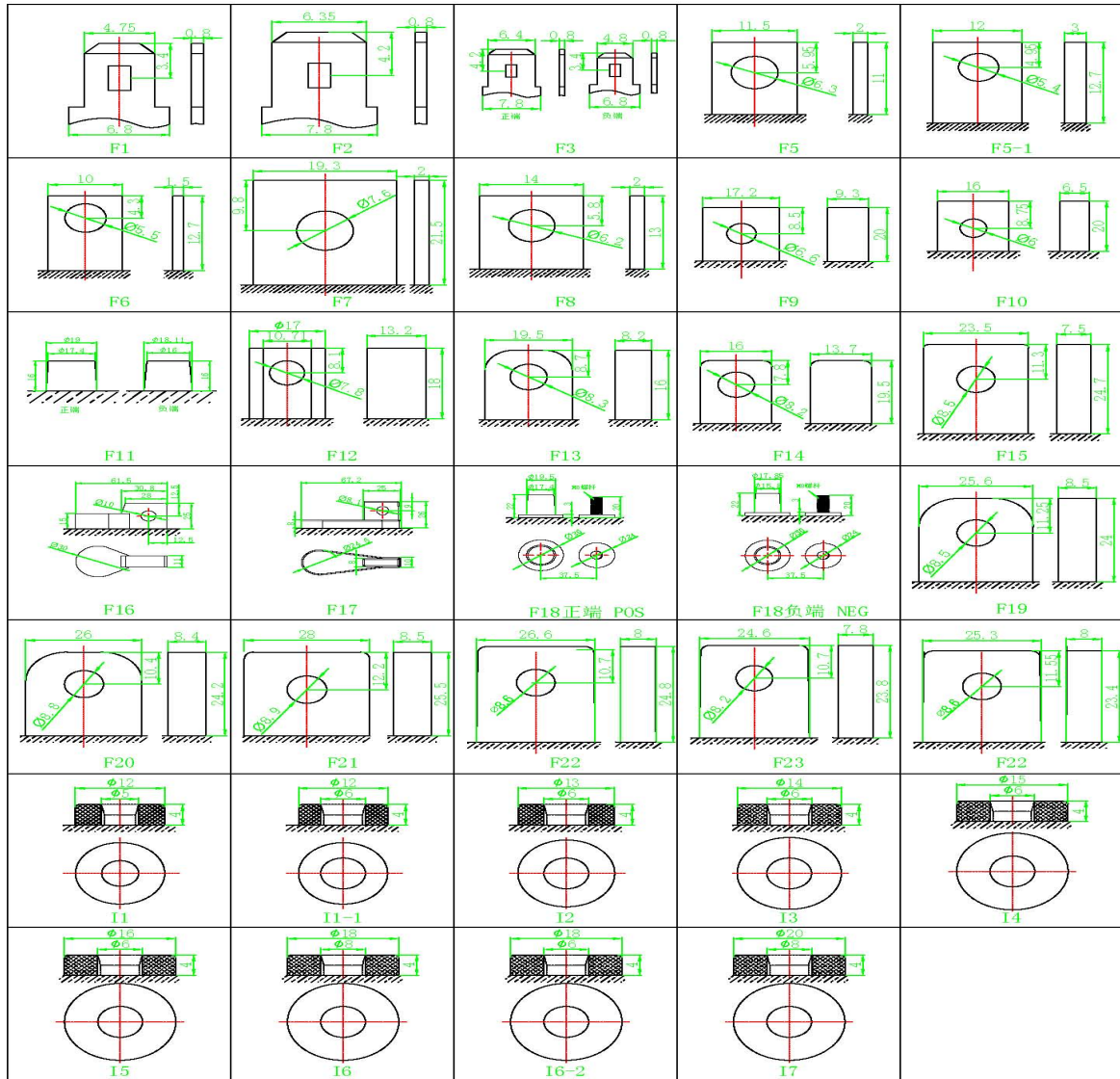

## 注意事项

- 不能再密闭环境中或使用温度高于60℃的情况下使用蓄电池；
- 不要用导体直接连接电池的正负端子，不要在安装时将电池正负极装反；
- 不要剖开电池，以免触及漏出的硫酸溶液；
- 电池各部件连接应牢固，避免意外的冲击和振动导致打火甚至出现事故；
- 电池不要安装在热源及可能产生火花的设备（如开关、保险丝等）附近；
- 电池在使用、贮存和运输过程中如出现变形、裂纹、散发气味等异常现象请用其它电池替换。
- 应严格遵守电池放电终止电压的规定，不得过放，电池过放会严重影响电池的容量；
- 电池放电后应马上进行充电，否则严重影响电池的容量和使用寿命。
- 定期检查充好电的电池的开路电压，如出现低于额定电压值时，应用新电池替换；
- 不同型号、不同容量、不同生产厂家、不同荷电状态的电池不得混用；

## Warning

- Do not use the battery in a sealed container or in the environment temperature above 60 ° C.
- Do not short the battery or reverse the positive and negative terminals when installing.
- Do not cut the battery to avoid touching the leaked sulfuric acid solution.
- The connection of all parts of the battery should be firm to avoid accidental impact and vibration, resulting in fire or even accidents.
- Do not install the battery near heat sources and equipment that may generate sparks (such as switches, fuses, etc.)
- If the battery is deformed, cracked, or smelled during use, storage and transportation, please replace it with other batteries.
- The battery discharge termination voltage shall be strictly observed, and shall not be over-discharged. Over-discharge of the battery may seriously affect the capacity of the battery.
- The battery should be charged immediately after discharge, otherwise it will seriously affect the battery capacity and service life.
- Regularly check the open circuit voltage of the charged battery. If it is lower than the rated voltage, replace it with a new one.
- Different types, different capacities, different manufacturers, batteries with different state of charge must not be mixed.

## 贮存

- 电池贮存前应充满电,开路状态下进行储存；
- 当电池在25℃环境中贮存时，应在6个月内给电池补电一次。
- 电池贮存时应避免受潮、雨淋；电池应避免接近热源。

## Storage

- Fully charge the battery before storage.
- If the battery is stored at an ambient temperature of 25℃,it should be charged at least every sixth months.
- The battery should not be exposed to moisture or rain during storage.
- The battery should not be placed near heat sources.

## 运输

- 搬运时应小心，避免人员受伤、避免损坏电池；
- 避免受潮、雨淋；
- 避免电池受日光暴晒；
- 不要让电池受到冲击和振动。

## Transportation

- Be careful when handling the battery to avoid injury or damage to the battery.
- Avoid exposure to moisture or rain.
- Avoid prolonged sun exposure.
- Avoid shocks and vibrations.



## 泉州市凯鹰电源电器有限公司

KAIYING POWER SUPPLY & ELECTRICAL EQUIP CO.,LTD

地址：中国福建省泉州市安溪县城厢镇滂港村  
Add: Laogang village, Chengxiang Town, Anxi,  
Quanzhou, Fujian Province, China

TEL: +86-595-68782266

FAX: +86-595-68782222

Website: <http://www.batterylongway.com>

Email: [lily.chang@longwaybattery.com](mailto:lily.chang@longwaybattery.com)