

#### MHB MM Series—Medium-size Battery

- High performance, completely maintenance-free, low self-discharge
- 100% precise quality testing, stable quality and high reliable performance
- Unique grid alloy formula and updated manufacturing technique
- Floating & standby use: up to 8 years
- Cycle use 1: Up to 260 cycles at 100% DOD
- Cycle use 2: Up to 500 cycles at 50% DOD

#### Application:

- Telecommunications
- Alarm and security system
- Uninterruptable Power Supply (UPS)
- Communication power supply
- Electric Power System (EPS)
- DC power supply
- Emergency backup power supply
- Auto control system

#### Construction:

- Component .....Raw material
- Sealant .....Epoxy
- Positive .....Lead dioxide
- Safety valve .... Rubber
- Negative .....Lead
- Terminal .....Copper/Pb
- Container .....ABS
- Separator .....Fiber glass
- Cover .....ABS
- Electrolyte ..... Sulfuric acid

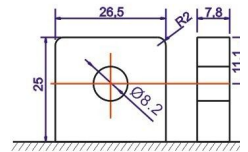
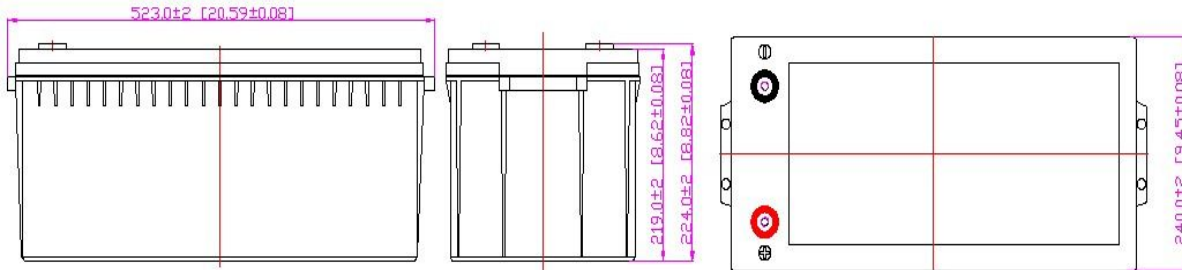

M8 Bolt & Nut

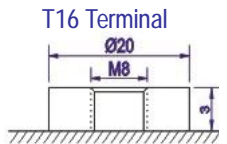

M8 Bolt

B5 Terminal

#### Speification:

Battery Model	MM 200-12 12V200AH			
Designed Floating Life	Up to 8 Years			
Capacity (25°C)	20HR(10.470A,10.8V)	10HR(20.000A,10.8V)	5HR(35.070A,10.5V)	1HR(108.410A,10.5V)
	209.40 AH	200.00 AH	175.35 AH	108.41 AH
Dimensions	Length	Width	Height	Total Height
	523 mm	240 mm	219 mm	223 mm
Approx. Weight	58.00 KG ±3%			
Internal Resistance	Full charged at 25°C: ≤5.00 mΩ			
Self Discharge	2% of capacity declined per month at (25°C)			
Capacity Affected by Temp.(20HR)	40°C	25°C	0°C	-15°C
	102%	100%	85%	65%
Charge Voltage(25oC)	Cycle use		Float use	
	14.4-14.6V(-30mV/°C), max. Current:60.00A		13.5-13.8V (-20mV/°C)	

### Terminal Voltage (V) and Discharge Time

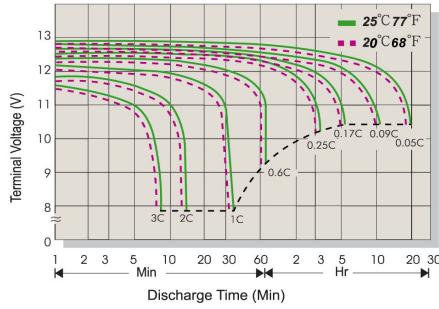

### Capacity Retention Characteristic

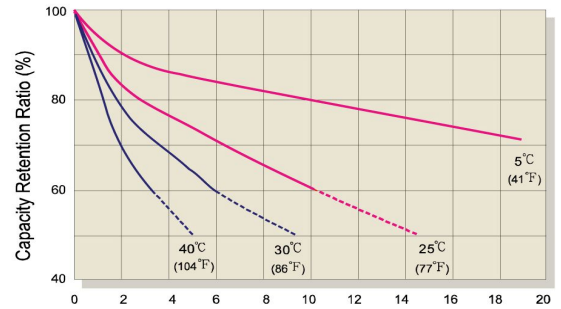

### Battery Voltage and Charge Time for Standby Use

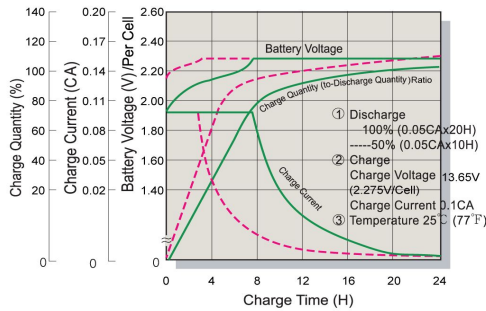

### Battery Voltage and Charge Time for Cycle Use

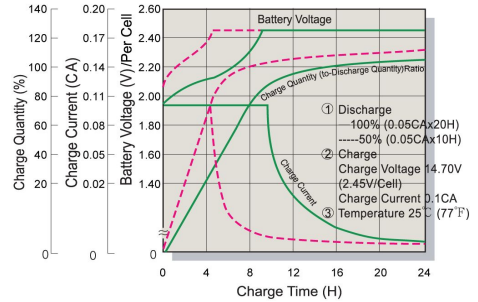

### Tickle(or Float) Service Life

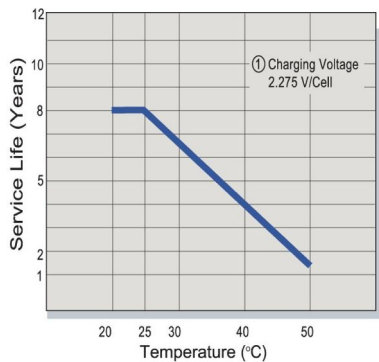

### Cycle Service Life

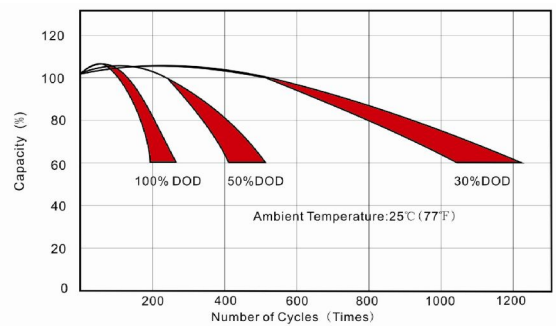

### Constant Current Discharge(CC,Unit:A) at 25°C(77°F)

F.V/Time	5Min	10Min	15Min	30Min	1Hr	2Hr	3Hr	4Hr	5Hr	6Hr	10Hr	20Hr
1.80V/Cell	619.4	421.3	288.5	175.44	107.50	67.09	52.16	41.02	34.77	23.23	20.00	10.47
1.75V/Cell	624.6	424.9	290.9	176.93	108.41	67.66	52.60	41.37	35.07	23.43	20.30	10.63
1.70V/Cell	640.2	435.5	298.2	181.35	111.12	69.35	53.91	42.40	35.94	24.01	20.60	10.79
1.67V/Cell	655.8	446.2	305.5	185.78	113.83	71.04	55.23	43.44	36.82	24.60	20.90	10.94
1.60V/Cell	685.0	466.0	319.1	194.05	118.90	74.20	57.69	45.37	38.46	25.69	21.20	11.10

### Constant Power Discharge (CP,Unit:W) at 25°C(77°F)

F.V/Time	5Min	10Min	15Min	30Min	1Hr	2Hr	3Hr	4Hr	5Hr	6Hr	10Hr	20Hr
1.80V/Cell	1208	822	563	342.1	209.6	130.82	101.71	79.99	67.80	45.30	39.00	20.42
1.75V/Cell	1218	829	567	345.0	211.4	131.93	102.57	80.67	68.38	45.68	39.59	20.73
1.70V/Cell	1248	849	582	353.6	216.7	135.23	105.13	82.69	70.09	46.83	40.17	21.03
1.67V/Cell	1279	870	596	362.3	222.0	138.53	107.70	84.70	71.80	47.97	40.76	21.34
1.60V/Cell	1336	909	622	378.4	231.8	144.69	112.49	88.48	74.99	50.10	41.34	21.64