

* SYJ□□2R is only for manifold use.

Type of actuation

1	Normally closed
2	Normally open

Coil specifications

Nil	Standard
T	With power saving circuit (24, 12 VDC only)

* Power saving circuit is not available in the case of W□ type.

Electrical entry

24, 12, 6, 5, 3 VDC/100, 110, 200, 220 VAC				24, 12, 6, 5, 3 VDC	
Grommet	L plug connector	M plug connector		M8 connector	
G: Lead wire length 300 mm	L: With lead wire (Length 300 mm)	M: With lead wire (Length 300 mm)	MN: Without lead wire	WO: Without connector cable	
H: Lead wire length 600 mm	LN: Without lead wire	LO: Without connector	MO: Without connector	W□: With connector cable (Note 1)	

* LN, MN type: with 2 sockets.
 * Refer to page 1005 for the lead wire length of L and M plug connectors.
 * Refer to page 1008 for the connector assembly with cover for L and M plug connectors.
 * For connector cable of M8 connector, refer to page 1009.
 * A M8 connector conforming to IEC60947-5-2 is also available. Refer to page 1002 for details.
 Note 1) Enter the cable length symbols in □. Please be sure to fill in the blank referring to page 1009.

Note) When placing an order for body ported solenoid valve as a single unit, mounting screws for manifold and gasket are not attached. Order them separately, if necessary. (For details, refer to page 959.)

Rated voltage

DC	CE/UKCA-compliant
5	24 VDC ●
6	12 VDC ●
V	6 VDC ●
S	5 VDC ●
R	3 VDC ●

AC (50/60 Hz)	CE/UKCA-compliant
1	100 VAC —
2	200 VAC —
3	110 VAC (115 VAC) —
4	220 VAC (230 VAC) —

* For type W□, DC voltage is only available.
 Note) CE/UKCA-compliant: For DC only.

Light/Surge voltage suppressor

Nil	Without light/surge voltage suppressor
S	With surge voltage suppressor
Z	With light/surge voltage suppressor
R	With surge voltage suppressor (Non-polar type)
U	With light/surge voltage suppressor (Non-polar type)

* For AC voltage valves there is no "S" option. It is already built-in to the rectifier circuit.
 * For type R, U, DC voltage is only available.
 * Power saving circuit is only available in the "Z" type.

Bracket

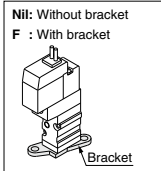

* Bracket is mounted.
 * Brackets cannot be retrofitted.
 * External pilot type is not available.

Port size

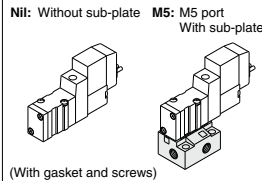

CE/UKCA-compliant

Nil	—
Q	CE/UKCA-compliant

Note) CE/UKCA-compliant: For DC only.

Manual override

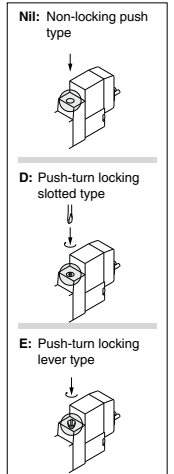

Rated voltage

DC	
5	24 VDC
6	12 VDC
V	6 VDC
S	5 VDC
R	3 VDC

* DC specifications of type D, Y, DO and YO is only available with 12 and 24 VDC.

AC (50/60 Hz)	
1	100 VAC
2	200 VAC
3	110 VAC [115 VAC]
4	220 VAC [230 VAC]

* For type W□, DC voltage is only available.
Note) AC-type models that are CE/UKCA-compliant have DIN terminals only.

Type of actuation

1	Normally closed
2	Normally open

Light/Surge voltage suppressor

Electrical entry for G, H, L, M and W

Nil	Without light/surge voltage suppressor
S	With surge voltage suppressor
Z	With light/surge voltage suppressor
R	With surge voltage suppressor (Non-polar type)
U	With light/surge voltage suppressor (Non-polar type)

* For AC voltage valves there is no "S" option. It is already built-in to the rectifier circuit.
* For type "R" and "U", DC voltage is only available.
* Power saving circuit is only available in the "Z" type.

Electrical entry for D, Y

Nil	Without light/surge voltage suppressor
S	With surge voltage suppressor (Non-polar type)
Z	With light/surge voltage suppressor (Non-polar type)

* DOZ and YOZ are not available.
* For AC voltage valves there is no "S" option. It is already built-in to the rectifier circuit.

3 port

(For manifold type 20, 21R)

Body ported

SYJ5 1 2 □ □ - 5 M □ □ - M5 - □ □

Base mounted

SYJ5 1 4 □ □ - 5 M □ □ - 01 □ □ - □ □

Bracket

Nil:	Without bracket
F:	With bracket

* Bracket is not mounted.



Made to Order
(page 1003)
Body ported external pilot

3 port

(For sub-plate type, manifold type 40, 40R, 41, 41R)

Coil specifications

Nil	Standard
T	With power saving circuit (24, 12 VDC only)

* Power saving circuit is not available in the case of D, Y, DO, YO or W□ type.

Manual override

Nil: Non-locking push type



D: Push-turn locking slotted type

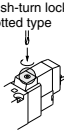

Port size

Nil: Without sub-plate 01: 1/8 port With sub-plate



(With gasket and screws)

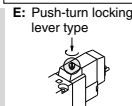

Thread type

Nil	Rc
F	G
N	NPT
T	NPTF

CE/UKCA-compliant

Nil	—
Q	CE/UKCA-compliant

Note) AC-type models that are CE/UKCA-compliant have DIN terminals only.

Electrical entry

24, 12, 6, 5, 3 VDC/100, 110, 200, 220 VAC				24, 12 VDC/100, 110, 200, 220 VAC		24, 12, 6, 5, 3 VDC	
Grommet	L plug connector	M plug connector		DIN terminal		M8 connector	
G: Lead wire length 300 mm	L: With lead wire (Length 300 mm)	M: With lead wire (Length 300 mm)	MN: Without lead wire	D: With connector	Y: With connector	WO: Without connector cable	
H: Lead wire length 600 mm	LN: Without lead wire	LO: Without connector	MO: Without connector	DO: Without connector	YO: Without connector	WI: With connector cable Note 1)	
CE/UKCA-compliant	DC	●	●	●	●	●	●
	AC	—	—	—	—	—	—

Note) When placing an order for body ported solenoid valve as a single unit, mounting screws for manifold and gasket are not attached. Order them separately, if necessary. (For details, refer to page 973.)

* DIN terminal type "Y" which conforms to EN-175301-803C (former DIN43650C) is also available. For details, refer to page 1007.

* For connector cable of M8 connector, refer to page 1009.
* A M8 connector conforming to IEC60947-5-2 is also available. Refer to page 1002 for details.

Note 1) Enter the cable length symbols in □. Please be sure to fill in the blank referring to page 1009.

Body option

Nil: Individual pilot exhaust type



M: Common exhaust for the pilot and main valve



R: External pilot type*



* SYJ5□2R is only for manifold use.

* LN, MN type: with 2 sockets.

* Refer to page 1005 for the lead wire length of L and M plug connectors.

* Refer to page 1008 for the connector assembly with cover for L and M plug connectors.

How to Order

Light/Surge voltage suppressor

Electrical entry for G, H, L, M and W

Nil	Without light/surge voltage suppressor
S	With surge voltage suppressor
Z	With light/surge voltage suppressor
R	With surge voltage suppressor (Non-polar type)
U	With light/surge voltage suppressor (Non-polar type)

* For AC voltage valves there is no "S" option. It is already built-in to the rectifier circuit.
* For type "R" and "U", DC voltage is only available.
* Power saving circuit is only available in the "Z" type.

Electrical entry for D, Y

Nil	Without light/surge voltage suppressor
S	With surge voltage suppressor (Non-polar type)
Z	With light/surge voltage suppressor (Non-polar type)

* DOZ and YOZ are not available.
* For AC voltage valves there is no "S" option. It is already built-in to the rectifier circuit.

Rated voltage

DC	
5	24 VDC
6	12 VDC
V	6 VDC
S	5 VDC
R	3 VDC

* DC specifications of type D, Y, DO and YO is only available with 12 and 24 VDC.

AC (50/60 Hz)	
1	100 VAC
2	200 VAC
3	110 VAC [115 VAC]
4	220 VAC [230 VAC]

* For type W□, DC voltage is only available.
Note) AC-type models that are CE/UKCA-compliant have DIN terminals only.

Type of actuation

1	Normally closed
2	Normally open

3 port

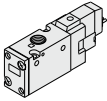

(For manifold type 20, 21R)

Bracket

Nil	Without bracket
F	With bracket

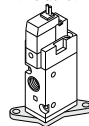

* Bracket is not mounted.



Made to Order
(page 1003)

Body ported external pilot

Body ported



Base mounted



3 port

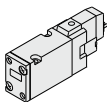

(For sub-plate type, manifold type 40, 41, 41R, 42, 42R)

Coil specifications

Nil	Standard
T	With power saving circuit (24, 12 VDC only)

* Power saving circuit is not available in the case of D, Y, DO, YO or W□ type.

Manual override

Nil: Non-locking push type



Thread type

Nil	Rc
F	G
N	NPT
T	NPTF

CE/UKCA-compliant

Nil	—
Q	CE/UKCA-compliant

Note) AC-type models that are CE/UKCA-compliant have DIN terminals only.

Port size

Nil: Without sub-plate
01: 1/8 port With sub-plate
02: 1/4 port With sub-plate

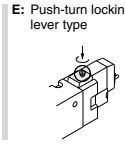
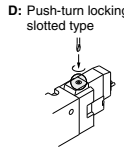

Body option

Nil: Individual pilot exhaust type

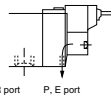

R port P, E port

M: Common exhaust for the pilot and main valve

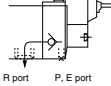

R port P, E port

R: External pilot type*



* SYJ□2R is only for manifold use.

Electrical entry

	24, 12, 6, 5, 3 VDC/100, 110, 200, 220 VAC				24, 12 VDC/100, 110, 200, 220 VAC		24, 12, 6, 5, 3 VDC	
	Grommet	L plug connector	M plug connector	MN: Without lead wire	DIN terminal	Y: With connector	WO: Without connector cable	M8 connector
DC	●	●	●	●	●	●	●	●
AC	—	—	—	—	—	—	—	—

G: Lead wire length 300 mm
L: With lead wire (Length 300 mm)
M: With lead wire (Length 300 mm)
MN: Without lead wire
H: Lead wire length 600 mm
LN: Without lead wire
LO: Without connector
MO: Without connector
DO: Without connector
YO: Without connector
W□: With connector cable (Note 1)

Note) When placing an order for body ported solenoid valve as a single unit, mounting screws for manifold and gasket are not attached. Order them separately, if necessary. (For details, refer to page 991.)

* LN, MN type: with 2 sockets.
* Refer to page 1005 for the lead wire length of L and M plug connectors.
* Refer to page 1008 for the connector assembly with cover for L and M plug connectors.

* DIN terminal type "Y" which conforms to EN-175301-803C (former DIN4365C) is also available. For details, refer to page 1007.

* For connector cable of M8 connector, refer to page 1009.
* A M8 connector conforming to IEC60947-5-2 is also available. Refer to page 1002 for details.

Note 1) Enter the cable length symbols in □. Please be sure to fill in the blank referring to page 1009.

M8 Connector Conforming to IEC60947-5-2

SYJ300/500/700 Series

Made to Order



How to Order Valve

Type of actuation

1	Normally closed
2	Normally open

Series

3	SYJ300
5	SYJ500
7	SYJ700

Rated voltage DC

5	24 VDC
6	12 VDC
V	6 VDC
S	5 VDC
R	3 VDC

Light/Surge voltage suppressor

NII	Without light/surge voltage suppressor
S	With surge voltage suppressor
Z	With light/surge voltage suppressor
R	With surge voltage suppressor (Non-polar type)
U	With light/surge voltage suppressor (Non-polar type)

Port size

M3	M3 x 0.5 (SYJ300 only)
M5	M5 x 0.8 (SYJ500 only)
O1	1/8 (SYJ700 only)

Bracket

NII	Without bracket
F	With bracket

Body ported SYJ 5 1 2 □ - 5 WAO □ □ - M5 - □ □

Base mounted SYJ 5 1 4 □ - 5 WAO □ □ - O1 - □ □

Body option

NII	Pilot valve individual exhaust
M	Common exhaust type for main and pilot valve
R	External pilot*

* SYJ3□2R, SYJ5□2R, SYJ7□2R are only for manifold use.

Electrical entry

WAO: Without connector



WA□: With connector (Note)

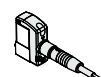

(Note) Enter the cable length symbols in □. Please be sure to fill in the blank referring to page 1009.

CE/UKCA-compliant

NII	—
Q	CE/UKCA-compliant

Thread type

NII	Rc
F	G
N	NPT
T	NPTF

Port size

NII	Without sub-plate	
M5	M5 port With sub-plate	SYJ300
O1	1/8 port With sub-plate	SYJ500 SYJ700
O2	1/4 port With sub-plate	SYJ700

Manual override

NII	Non-locking push type
D	Push-turn locking slotted type
E	Push-turn locking lever type

Made to Order (page 1003)
Body ported external pilot
* X20 for the SYJ300 series is not available.

How to Order Pilot Valve Assembly

V111 - 5 WAO □ □

Rated voltage DC

5	24 VDC
6	12 VDC
V	6 VDC
S	5 VDC
R	3 VDC

Light/Surge voltage suppressor

NII	Without light/surge voltage suppressor
S	With surge voltage suppressor
Z	With light/surge voltage suppressor
R	With surge voltage suppressor (Non-polar type)
U	With light/surge voltage suppressor (Non-polar type)

Electrical entry

WAO	M8 connector	Without connector
WA□		With connector (Note)

(Note) Enter the cable length symbols in □. Please be sure to fill in the blank referring to page 1009.

(Note) Since V111 is CE/UKCA-compliant as standard, the suffix "Q" is not necessary.