

AY-10A



SPECIFICATION

Working Medium	Compressed Air (filtered by 40μm filter screen)
Type	3/2
Working Type	Direct Action
Orifice	0.7mm
Working Pressure	0-0.7MPa
Working Temp.	-5~50°C
Voltage	DC12V, DC24V, AC110V, AC220V
Protection Class	IP65
Insulation Class	H
Body Material	PA66
Seal Material	NBR

INSTALL AND OPERATION

1. It is recommended that the user unit specially-assigned person to be responsible for the use and maintenance.
2. When the valve is not used for a long time, it shall be stored in a dry place. After the solenoid valve is installed, the medium must be input for several times, and it can be put into formal use only after it is confirmed to be normal.
3. Before use, pay attention to check whether the components are damaged during transportation. During operation, the working pressure shall not exceed the rated pressure, and the working differential pressure must be within the range of the rated differential pressure. When the working pressure exceeds the rated pressure or the working differential pressure exceeds the rated differential pressure, the micro solenoid valve shall be stopped.
4. Please pay attention to the media flow direction during installation.
5. Please pay attention to dust prevention. When it is removed and not in use, install dust plugs at the inlet and outlet.

FEATURES

1. It is equipped with surge elimination device to protect against overvoltage.
2. The DC circuit is designed with non-polar input, and the terminal line can be adjusted freely according to the installation and whole line requirements. The general mode of vertical / parallel / vertical parallel is adopted.
3. Bridge rectifier full wave rectification to reduce the problem of AC power supply buzzer.
4. Various voltage specifications are available: AC220V, AC110V, DC24V, DC12V.
5. Low starting voltage and long service life.

FLOW CHARACTERISTICS

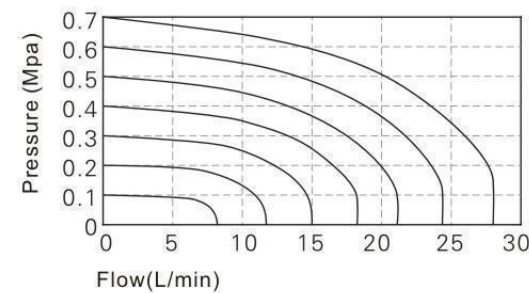
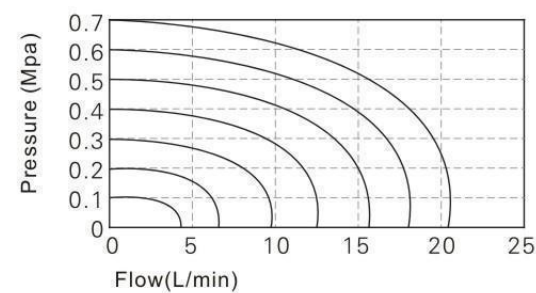

ORDERING CODE

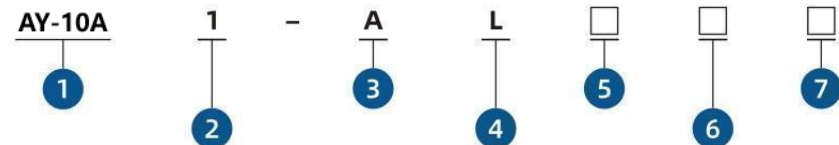

- | | | | |
|---------------------------------------------------------------------------------------------------------------|---------------------------------------------------------------------------------------------------------------------------------------------------------------------------------------------------------|-----------------------------------------------------------------------------------------------------------------------------------------------------------------------------------------------------------------------------------------------------------------------------------------------------------------------------------------------------------------------------|--------------------------------------------------------------------------------------------------------------------------------------------------------------------------------|
| <p>1. Model Series
AY-10A</p> <p>2. Working Type
1:3/2 NC
2:3/2 NO
3:2/2 NC</p> | <p>3. Voltage
A : AC220V
B:DC24V
C:AC110V
D:DC12V</p> <p>4. Connection Type
L:Vertical type
M :Parallel type
N:Vertical parallel universal
P:Pin type</p> | <p>5. Indicator light, surge voltage protection circuit
Blank: With indicator light and no surge voltage protection circuit
R: With indicator light and surge voltage protection circuit
Z: No indicator light, no surge voltage protection circuit
U: No indicator light, with surge voltage protection circuit
*Pin type without indicator</p> | <p>6. Exhaust Type
Blank : Exhaust Directly
N: Indirect Exhaust</p> <p>7. Manual Lever Mode
Blank: With Manual Lever
1: Without Manual Lever</p> |
|---------------------------------------------------------------------------------------------------------------|---------------------------------------------------------------------------------------------------------------------------------------------------------------------------------------------------------|-----------------------------------------------------------------------------------------------------------------------------------------------------------------------------------------------------------------------------------------------------------------------------------------------------------------------------------------------------------------------------|--------------------------------------------------------------------------------------------------------------------------------------------------------------------------------|

AY-10A (PIN TYPE)

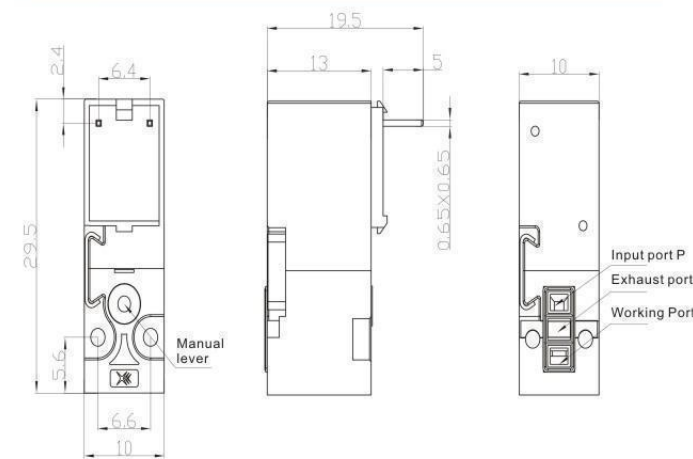

AY-10A (Vertical Type)

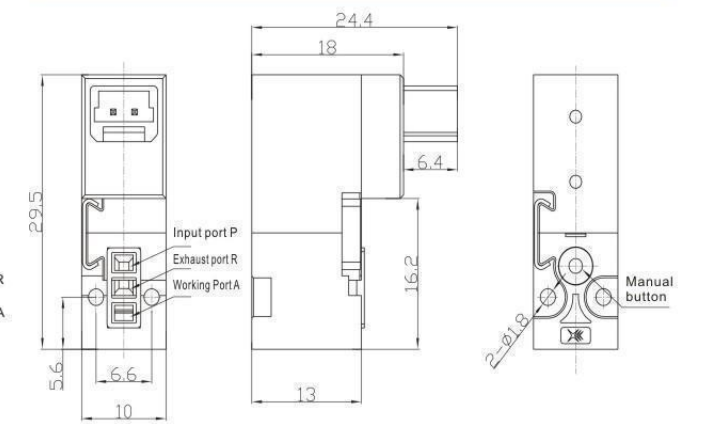

AY-10A (Parallel type)

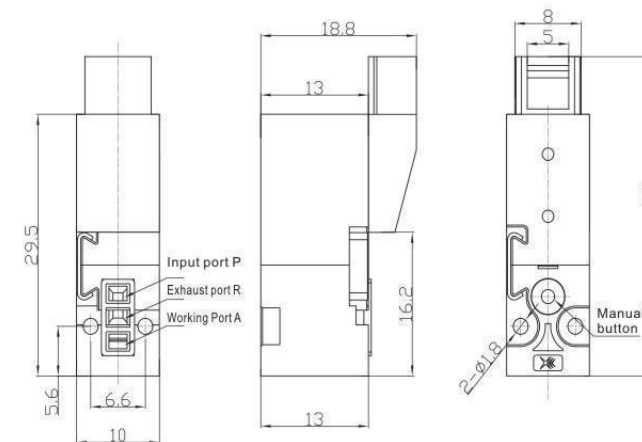

AY-10A (Vertical parallel universal)

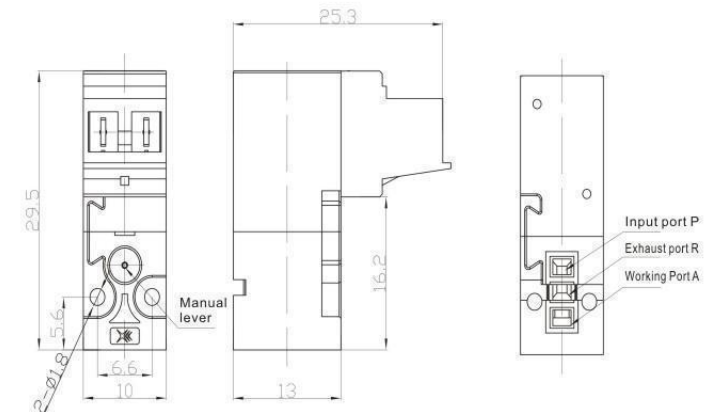

AY-10A (Profile)

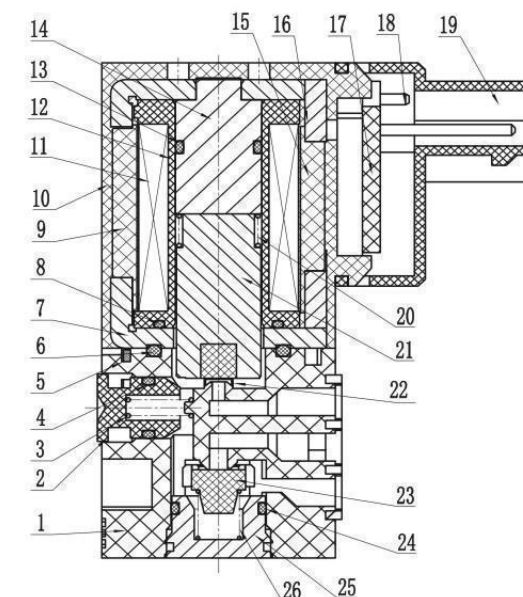

No.	Description	Mat.	No.	Description	Mat.
1	Valve Body	Resin	16	Bracket Side plate	Carbon steel
2	Manual Lever	POM	17	PCB board	
3	Manual Lever Spring	S.S	18	Pin	Copper
4	O-ring	NBR	19	Housing	PC
5	Manual Lever Card	S.S	20	Spring	S.S
6	O-ring	NBR	21	Plunger	Electromagnetic stainless steel
7	Bracket	Carbon steel	22	Ejector rod	POM
8	O-ring	NBR	23	Plug	NBR
9	Shim	Nylon	24	O-ring	NBR
10	Encapsulation	Nylon	25	Bottom cover	Copper
11	Copper Wire		26	Spring	S.S
12	Bobbin	POM	27		
13	O-ring	NBR	28		
14	Iron core	Electromagnetic stainless steel	29		
15	Shim	Nylon	30		

AY-10 系列



订购码

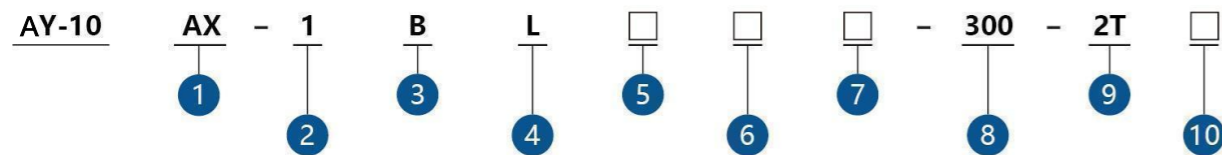

1. 规格

AX 阀口: 0.5mm 功率: 1W
 AH 阀口: 0.7mm 功率: 1.2W
 AD 阀口: 0.7mm 功率: 1.8W/0.5W
 *AR 阀口: 1mm 功率: 3.2W/0.5W

2. 动作类型

1: 3/2 常闭
 3: 2/2 常闭

3. 电压规格

B: DC24V
 D: DC12V

4. 导线引线方式

W: 引线式 P: 插针式

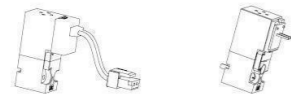

L: 垂直式 M: 平行式



N: 垂直平行通用式



5. 指示灯、电涌电压保护回路

空白: 带指示灯, 无过电保护回路
 R: 带指示灯, 带电保护回路
 Z: 不带指示灯, 无过电保护回路
 U: 不带指示灯, 带电保护回路
 插针式不可带指示灯

6. 排气方式

无记号: 直接排气
 N: 非直接排气

7. 手动杆

无记号: 无手动功能
 1: 有手动功能

8. 线长

300mm
 600mm
 选定尺寸

9. 阀岛联数

1T 1 联阀岛

 20T 20 联阀岛

10. 汇流板螺纹种类

空白: G
 R: RC
 N: NPT

技术参数

系列	AY-10AH	AY-10AX	AY-10AD	*AY-10AR
使用压力范围 MPa	0-0.7	0-0.7	0-0.7	0-0.7
阀口尺寸 mm	0.7	0.5	0.7	1.0
使用介质	经 40μm 滤芯过滤过的压缩空气			
环境温度及介质温度 °C	-5~60(但未冻结)			
响应时间 ms	ON: 6 OFF: 5	ON: 7 OFF: 6	ON: 7 OFF: 6	ON: 6 OFF: 5
最大动作频率 Hz	35	20	35	50
流量 L/min	20	10	20	30
出线方式	垂直式、平行式、垂直平行通用式、插针式、引线式			
线圈额定电压 V	DC12/DC24			
允许波动电压	额定电压 ±10%			
消耗功率 W	1.2	1	1.8/0.5	3.2/0.5
动作方式	直动式			
过电保护回路	可选			
指示灯	有 采用 LED 显示			
手动操作方式	可选			
绝缘等级	H 级			
防护等级	IP40			

垂直式AY-10A

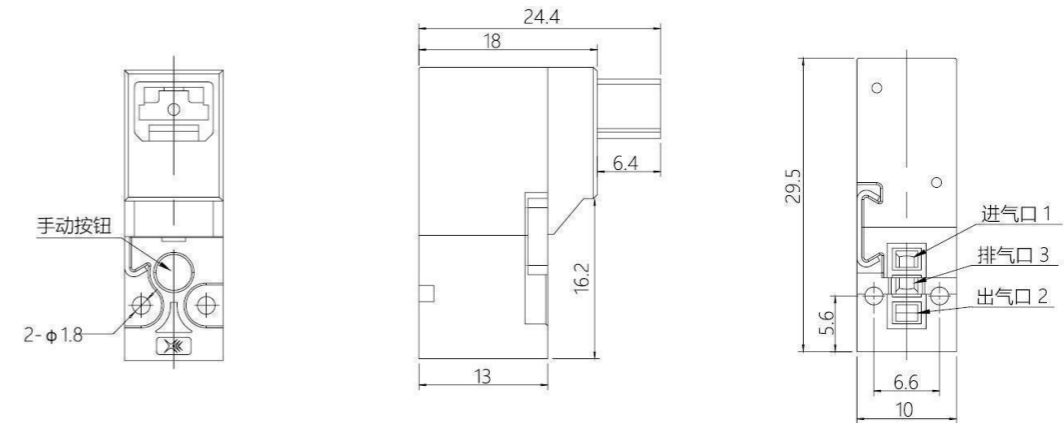

平行式AY-10A

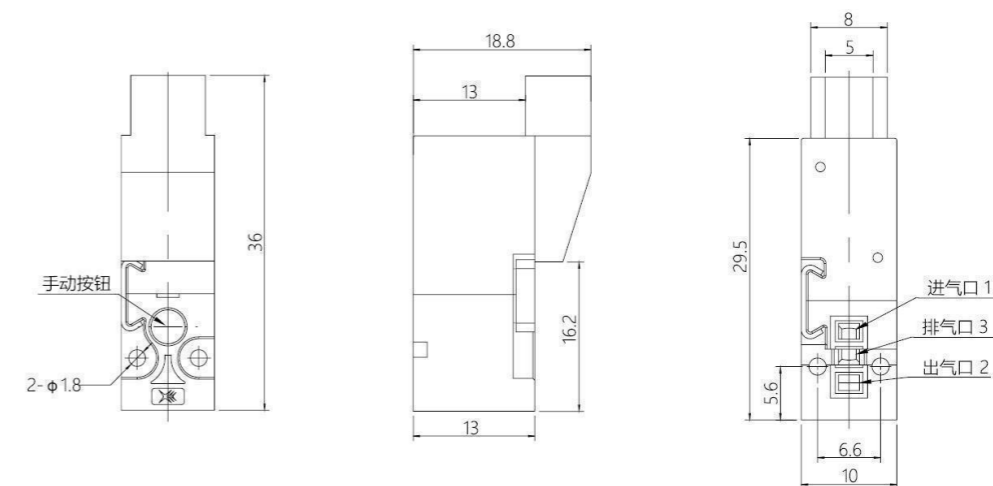

垂直平行通用式AY-10A

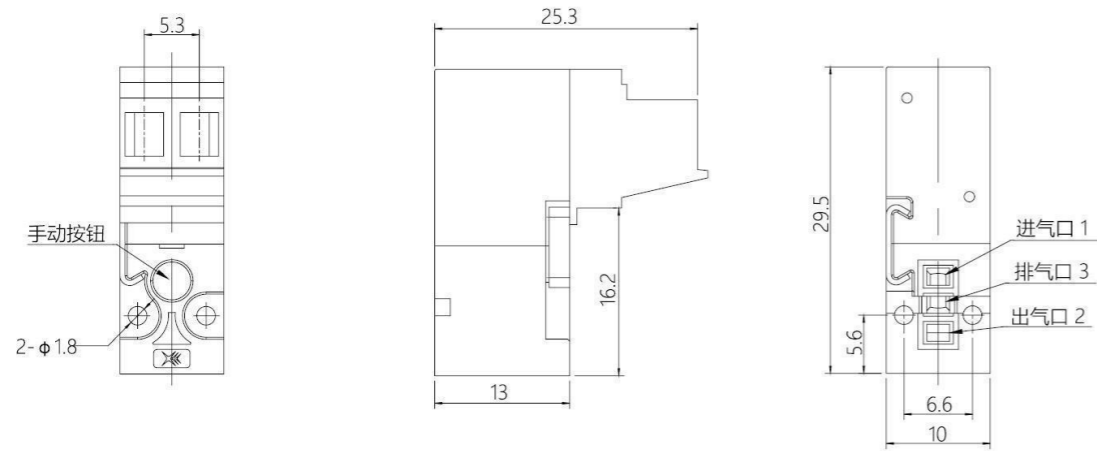

插针式AY-10A

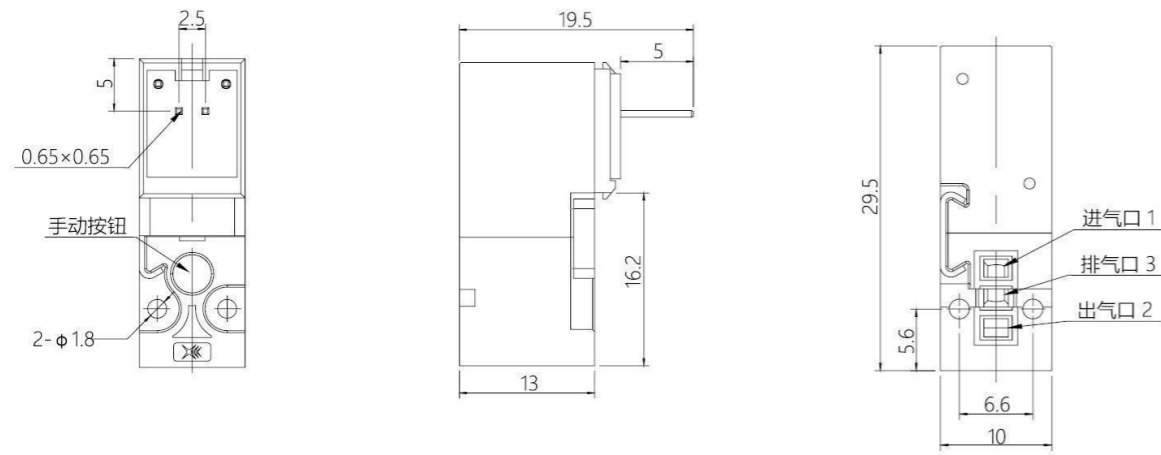

密封区安装尺寸

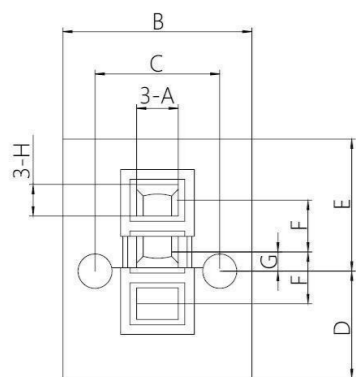

A	B	C	D	E	F	G
2.2	10	6.6	5.6	6.9	2.7	1.6

AY-10A 汇流板

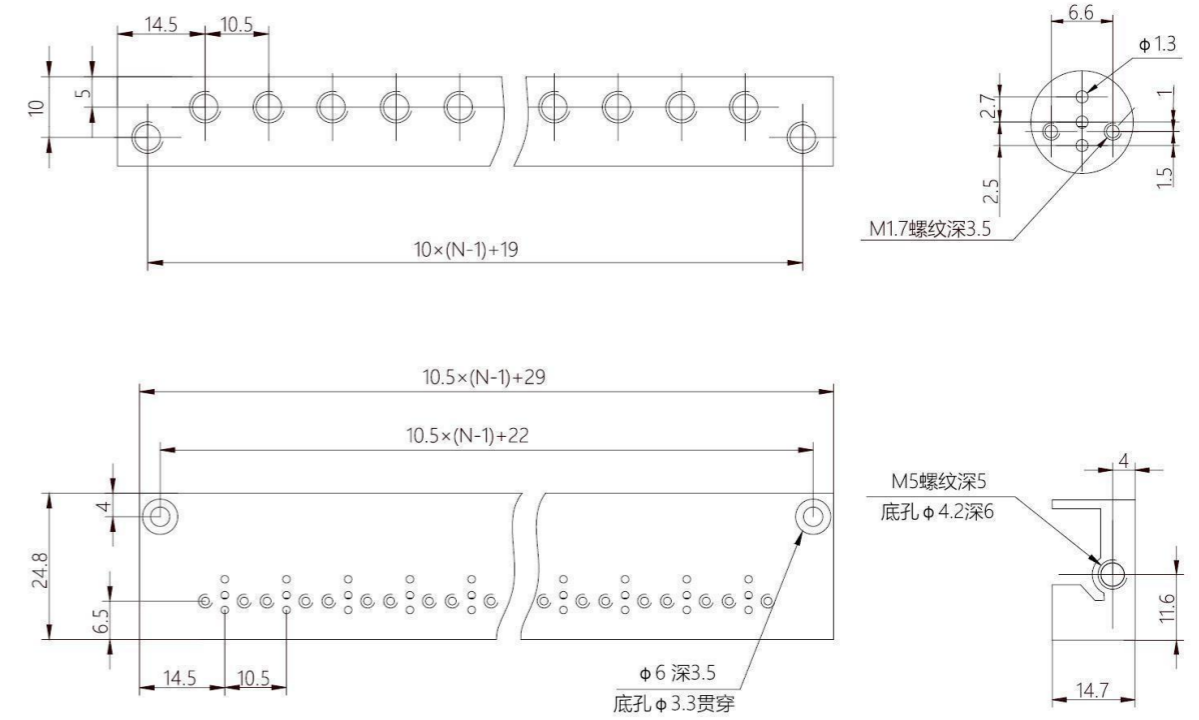

垂直平行通用式接插件

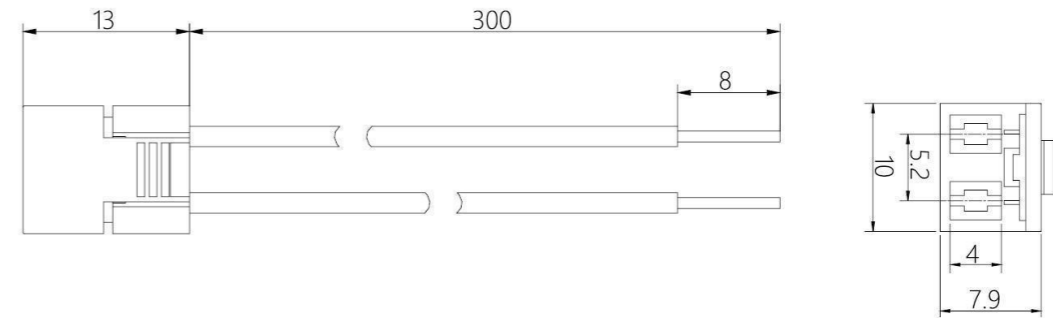

垂直式 / 平行式接插件

