

XD105T



XD105T

Vibratory Roller

XD105T vibratory roller meets the requirements of high-end customers in the European market and special working conditions, is suitable for compaction operation of bitumen paving, and can compact paving of different materials and thicknesses. It is especially suitable for pavement compaction operation of large-scale projects such as roads, parking yards, airports, etc.



XCMG ROAD MACHINERY BUSINESS UNIT

Performance and characteristics

- The integral design hood can slide upward, and the whole power space is clear at a glance;
- The air cleaner, machine filter, diesel filter, hydraulic oil filter and other parts requiring service/replace shall be placed in a position easy to contact;
- Vulnerable parts are also placed in a position where they are easily accessible or where they can be replaced without disassembling more parts.
- 55Hz high frequency vibration greatly shortens the operation time;
- 0 ~ 12km/H stepless speed regulation to meet the operation requirements of different working conditions;
- Double-frequency and double-amplitude vibration system. The front and rear wheels can vibrate independently.

Main dimensions

Dimensions	A	B	C	L	H	D	S	W	O	K
XD105T	3570	1860	782	4790	3080	1220	17	1680	85	290

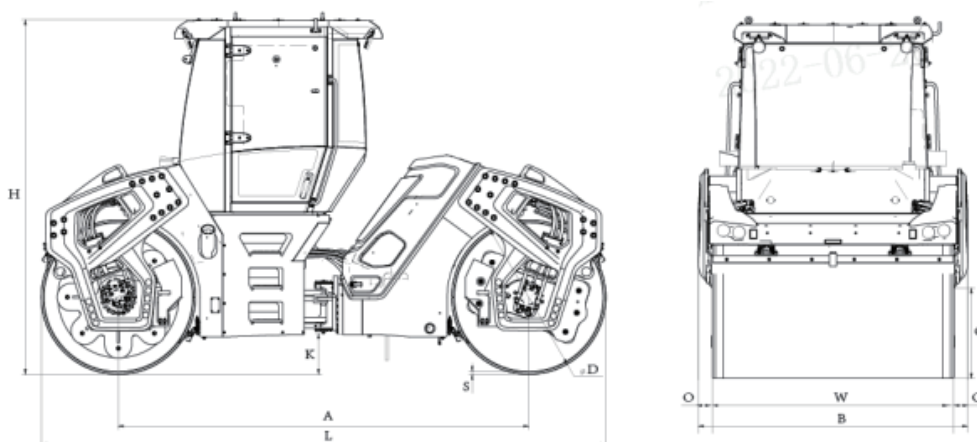

Main specifications

Item	Content	Unit	Value
Weight Parameters	Operating weight	kg	10000
	Front axle weight	kg	5000
	Rear axle weight	kg	5000
	Static linear load (front/rear)	N/cm	292/292
Maneuverability	Working speed	km/h	0 ~ 12
	Theoretical gradeability		35%
	Minimum turning radius (inside/outside)	mm	4800/6480
	Minimum Ground Clearance	mm	290
	Wheelbase	mm	3570
	Steering angle		±35°
	Oscillation angle		±8°
Compaction Parameters	Braking distance	m	≤4.36
	Vibration frequency	Hz	55/45
	Nominal amplitude	mm	0.5/0.9
	Excitation force (high/low frequency)	kN	90/110
	Drum diameter	mm	1220
	Drum width	mm	1680
Hydraulic system	Charge pressure, drive system	MPa	2.4
	Peak pressure, drive system	MPa	38
	Peak pressure, vibration system	MPa	32
	Peak pressure, steering system	MPa	17.5
Engine	Model		F3.8(Stage V)
	Rated power	kW	90
	Rated speed	r/min	2200