

—— 立足全国 · 放眼世界 ——  
Based on the whole country, looking at the world.



—— 应用行业 / Application industry ——

金属线束、医疗、灯饰、电讯、耗材、家电、汽车、包装、卫生、文具、玩具、水处理、注塑等。

Metal wiring harness, medical treatment, lighting, telecommunications, consumables, home appliances, automobiles, packaging, sanitation, stationery, toys, water treatment, injection molding, etc.



# 20年专注超声波 焊接设备制造、研发

Focus on welding equipment manufacturing and research for 20 years



诚信 · 务实 · 专注 · 高效  
INTEGRITY · PRAGMATISM · FOCUS · EFFICIENCY

2024 产品画册

COMPANY  
PROFILE

## 公司简介

本公司是一家集科研、生产、销售及服务于一体的超声波设备制造企业。公司拥有专业的研发、生产、售前、售后服务团队，主要产品有超声波发生器、超声波焊接机、转盘式焊接机、高频精密焊接机、超声波水口分离机、超声波点焊机、旋转式焊接机及非标自动化定制等。公司配备先进的超声波测试仪器，拥有数名从事超声波行业达 20 年以上的资深研发人员，致力于各种高精度的超声波研发，全面发展各种熔接技术及非标设备，为客户提供专业的超声波焊接技术方案。

公司以追求品质、诚信服务为宗旨；以客户满意为目标；以引领超声波行业发展为己任；将众多国际先进技术引入超声波行业。公司的诚信、实力和产品质量已获得业界的认可，我们将建立属于本行业所持有的规范，并立志成为超声波行业永远的典范。

公司将一如既往地坚持以优质的产品找市场、以合理的价格寻朋友、以真诚的服务待客户，真诚与社会各界合作，携手共进、开拓市场、共创辉煌。

The company is an ultrasonic equipment manufacturing enterprise integrating scientific research, production, sales and service. The company has a professional R&D, production, pre-sale and after-sales service team. The main products are ultrasonic generators, ultrasonic welding machines, rotary welding machines, high-frequency precision welding machines, ultrasonic nozzle separators, ultrasonic spot welding machines, and rotary welding machines. Machine and non-standard automation customization, etc. The company is equipped with advanced ultrasonic testing equipment, and has several senior R&D personnel who have been engaged in the ultrasonic industry for more than 20 years. They are committed to various high-precision ultrasonic research and development, comprehensively develop various welding technologies and non-standard equipment, and provide customers with professional ultrasonic Welding technical solutions.

The company takes the pursuit of quality and sincere service as its purpose; customer satisfaction as its goal; its mission to lead the development of the ultrasound industry; and the introduction of many international advanced technologies into the ultrasound industry. The company's integrity, strength and product quality have been recognized by the industry. We will establish standards that belong to the industry and aspire to become an eternal model in the ultrasound industry.

The company will, as always, insist on finding the market with high-quality products, seeking friends at reasonable prices, treating customers with sincere service, and sincerely cooperate with all walks of life in the society to advance hand in hand, open up the market, and create brilliance together.

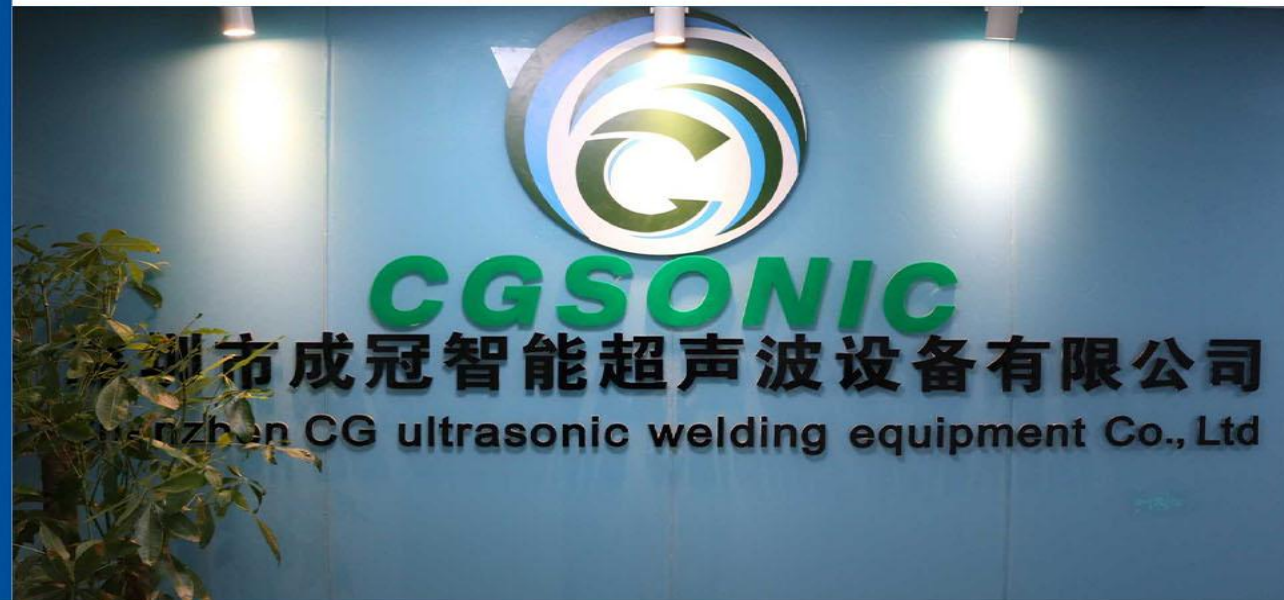



C G 0 0 - W

特点 / Features

- 全新操作系统，数字化操控。
  - 换能器电容精准匹配,黄片、黑片全系列兼容。
  - 钢模、铝模兼容。
  - 可切换中英文。
  - 输出功率更强劲、性能更稳定、发波更细腻。
  - 支持485通讯、支持修改本地通讯地址、支持三级密码解锁。
  - 工作界面可视，具备品质监控功能及数据导出。
  - 可订制全彩开机界面。
- Brand new operating system, digital control.
  - The transducer capacitance is accurately matched, and the full range of yellow and black films are compatible.
  - Compatible with steel mold and aluminum mold.
  - Can switch between Chinese and English.
  - The output power is stronger, the performance is more stable, and the wave is more delicate.
  - Support 485 communication, support modification of local communication address, support three-level password unlocking.
  - The working interface is visible, with quality monitoring functions and data export.
  - Full-color boot interface can be customized.



主打应用行业 / Main application industry

金属线束、食品、汽配、家电、耗材、电子电讯、医疗、灯饰、包装等。  
Metal wiring harness, food, auto parts, home appliances, consumables, electronic telecommunications, medical treatment, lighting, packaging, etc.

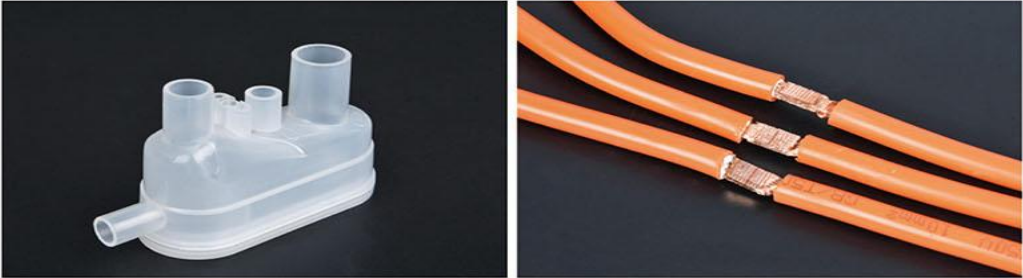

技术参数 / Technical Parameters

外形尺寸 Dimensions	380mm × 345mm × 155mm
主机净重 Host net weight	10.5KG
工作频率 working frequency	15KHZ/20KHZ/28KHZ/30KHZ/35KHZ/40KHZ 可选
输出功率 Output Power	400W-5000W
工作电源 Power supply	AC220V 50HZ
自动追频精度 Automatic frequency tracking accuracy	±0.5KHZ
款式 shape	立式/卧式 可选

C G 0 0 - R

特点 / Features

- 全新操作系统，数字化操控。
- 换能器电容精准匹配,黄片、黑片全系列兼容。
- 钢模、铝模兼容。
- 可切换中英文。
- 输出功率更强劲、性能更稳定、发波更细腻。
- 支持485通讯、支持修改本地通讯地址、支持三级密码解锁。
- 工作界面可视，具备品质监控功能及数据导出。
- 可订制全彩开机界面。
- Brand new operating system, digital control.
- The transducer capacitance is accurately matched, and the full range of yellow and black films are compatible.
- Compatible with steel mold and aluminum mold.
- Can switch between Chinese and English.
- The output power is stronger, the performance is more stable, and the wave is more delicate.
- Support 485 communication, support modification of local communication address, support three-level password unlocking.
- The working interface is visible, with quality monitoring functions and data export.
- Full-color boot interface can be customized.



主打应用行业 / Main application industry

金属线束、食品、汽配、家电、耗材、电子电讯、医疗、灯饰、包装等。  
Metal wiring harness, food, auto parts, home appliances, consumables, electronic telecommunications, medical treatment, lighting, packaging, etc.

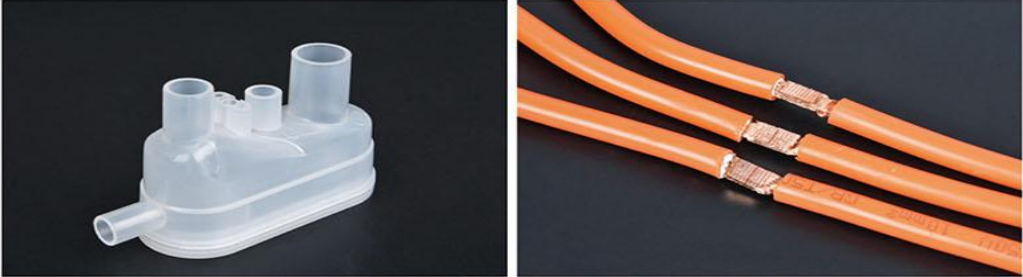

技术参数 / Technical Parameters

外形尺寸 Dimensions	380mm × 345mm × 155mm
主机净重 Host net weight	10.5KG
工作频率 working frequency	15KHZ/20KHZ/28KHZ/30KHZ/35KHZ/40KHZ 可选
输出功率 Output Power	400W-5000W
工作电源 Power supply	AC220V 50HZ
自动追频精度 Automatic frequency tracking accuracy	±0.5KHZ
款式 shape	立式/卧式 可选

CG01-R

特点 / Features

- 升级款操作系统，数字化操控。
- 换能器电容精准匹配,黄片、黑片全系列兼容。
- 钢模、铝模兼容。
- 可切换中英文。
- 输出功率更强劲、性能更稳定、发波更细腻。
- 支持485通讯、支持修改本地通讯地址。
- 可订制全彩开机界面。
- Upgraded operating system, digital control.
- The transducer capacitance is accurately matched, and the full range of yellow and black films are compatible.
- Compatible with steel mold and aluminum mold.
- Can switch between Chinese and English.
- The output power is stronger, the performance is more stable, and the wave is more delicate.
- Support 485 communication, support modification of local communication address.
- Full-color boot interface can be customized.



主打应用行业 / Main application industry

口罩机、制袋机、拉链机、办公文具、土工格栅、切带机、无纺布等。  
mask machine, bag making machine, zipper machine, office stationery, geogrid, tape cutting machine, non-woven fabric, etc.

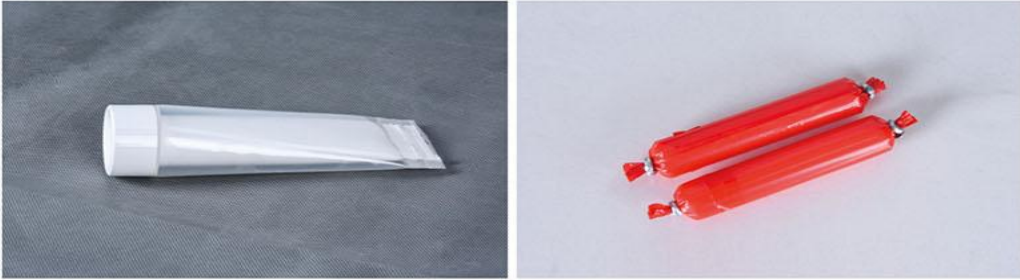

技术参数 / Technical Parameters

外形尺寸 Dimensions	380mm × 290mm × 110mm
主机净重 Host net weight	6KG
工作频率 working frequency	15KHZ/20KHZ/28KHZ/30KHZ/35KHZ/40KHZ
输出功率 Output Power	400-3000W
工作电源 Power supply	AC220V 50HZ
自动追频精度 Automatic frequency tracking accuracy	± 0.5KHZ
款式 shape	立式/卧式 可选



C G O 1 - S

特点 / Features

- 自动追频，无需人工调频。
- 智能保护，有效降低模具、换能器损耗。
- 振幅1~100可调，实现精准焊接。
- 德国IGBT功率模块，输出稳定。
- Automatic frequency tracking, without manual frequency adjustment.
- Intelligent protection effectively reduces the loss of molds and transducers.
- The amplitude is adjustable from 1~100 to realize precise welding.
- German IGBT power module with stable output.



主打应用行业 / Main application industry

玩具、文具、小家电等。  
Toys, stationery, small household appliances, etc.



技术参数 / Technical Parameters

外形尺寸 Dimensions	380mm × 290mm × 110mm
主机净重 Host net weight	6KG
工作频率 working frequency	15KHZ/20KHZ/28KHZ/30KHZ/35KHZ/40KHZ
输出功率 Output Power	400~2600W
工作电源 Power supply	AC220V 50HZ
自动追频精度 Automatic frequency tracking accuracy	±0.5KHZ
款式 shape	文本屏/触摸屏 可选

## C G T C 标准款

### 特点 / Features

- 全新操作系统，数字化操控。
- 工作界面可视，焊接品质可监控。
- 支持485通讯，焊接数据导出。
- 可修改通讯地址，实现远程一键操控。
- 钢质机身，立柱采用同心直轴设计，焊接精度高。
- 时间、能量、外控、自循环模式。
- Brand new operating system, digital control.
- The working interface is visible, and the welding quality can be monitored.
- Support 485 communication and export welding data.
- The communication address can be modified to realize remote one-key control.
- The steel body, the column adopts the concentric straight shaft design, and the welding accuracy is high.
- Time, energy, external control, self-circulation mode.

### 技术参数 / Technical Parameters

工作频率 working frequency	15KHZ	15KHZ	20KHZ	20KHZ
输出功率 output power	2000W	3200W	2000W	2600W
语言选择 language selection	中文/英文			
输入电压 input voltage	单相AC220V			
频率范围 frequency range	±0.5KHZ			
振幅调整 amplitude adjustment	1%~100%可调			
焊头行程 welding head stroke	50~125mm			
焊接时间 welding time	0.01~9.99s			
接入气压 access air pressure	0.1~0.7Mpa			
振头冷却 vibrating head cooling	风冷			
工作台尺寸 working desk size	330*330mm			
机器尺寸 machine size	710*370*1150mm			
机器重量 machine weight	约90KG			

### 主打应用行业 / Main application industry

家电、耗材、电讯、医疗等。  
Home appliances, consumables, telecommunications, medical care, etc.

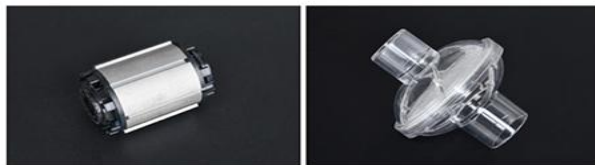

## C G S M 豪华款

### 特点 / Features

- 全新操作系统，数字化操控。
- 工作界面可视，焊接品质可监控。
- 支持485通讯，焊接数据导出。
- 可修改通讯地址，实现远程一键操控。
- 钢质机身，立柱采用同心直轴设计，焊接精度高。
- 时间、能量、外控、自循环模式。
- 双层储物空间设计，可放置电箱、模具、工具箱等。
- Brand new operating system, digital control.
- The working interface is visible, and the welding quality can be monitored.
- Support 485 communication and export welding data.
- The communication address can be modified to realize remote one-key control.
- The steel body, the column adopts the concentric straight shaft design, and the welding accuracy is high.
- Time, energy, external control, self-circulation mode.
- Double-layer storage space design can be placed in electrical boxes, molds, tool boxes, etc.

### 技术参数 / Technical Parameters

工作频率 working frequency	15KHZ	15KHZ	20KHZ	20KHZ
输出功率 output power	2000W	3200W	2000W	2600W
语言选择 language selection	中文/英文			
输入电压 input voltage	单相AC220V			
频率范围 frequency range	±0.5KHZ			
振幅调整 amplitude adjustment	1%~100%可调			
焊头行程 welding head stroke	50~125mm			
焊接时间 welding time	0.01~9.99s			
接入气压 access air pressure	0.1~0.7Mpa			
振头冷却 vibrating head cooling	风冷			
工作台尺寸 working desk size	650*650mm			
机器尺寸 machine size	740*650*1800mm			
机器重量 machine weight	约190KG			

### 主打应用行业 / Main application industry

家电、医疗、灯饰、汽配等。  
Home appliances, medical care, lighting, auto parts, etc.



## C G S F 2 0 2 6 / C G S F 1 5 2 6

### 特点 / Features

- 升级款操作系统，数字化操控。
- 加厚机身，稳固稳定、方便实用。
- 双键启动，符合安全标准。
- 应用场景多元化。
- Upgraded operating system, digital control.
- The thickened body is firm and stable, convenient and practical.
- Two-key start, in line with safety standards.
- Diversified application scenarios.

### 技术参数 / Technical Parameters

工作频率 working frequency	15KHZ	20KHZ
输出功率 output power	2600W	2000W
语言选择 language selection	中文/英文	
输入电压 input voltage	单相AC220V	
频率范围 frequency range	±0.5KHZ	
振幅调整 amplitude adjustment	1%~100%可调	
焊头行程 welding head stroke	50~125mm	
焊接时间 welding time	0.01~9.99s	
接入气压 access air pressure	无	
振头冷却 vibrating head cooling	风冷	
工作台尺寸 working desk size	195*310mm	
机器尺寸 machine size	640*400*1000mm	
机器重量 machine weight	约65KG	

### 主打应用行业 / Main application industry

包装、文具、耗材、电讯、无纺布、灯饰等。  
Packaging, stationery, consumables, telecommunications, non-woven fabrics, lighting, etc.



## C G G P 系列

### 特点 / Features

- 加厚钢质机身，抱合式燕尾槽，下压回升不偏移。
- SMC气动组合+滑块导轨，焊头升降顺畅稳定。
- 焊接行程可精密微调，焊接精度高。
- 底板可调式结构，调试模具方便快捷。
- The thickened steel body, with a closed dovetail groove, does not deviate when the downward pressure rises.
- SMC pneumatic combination + slide rail, the welding head rises and falls smoothly and stably.
- The welding stroke can be fine-tuned precisely, and the welding accuracy is high.
- Adjustable bottom plate structure, convenient and quick to debug the mold.

### 技术参数 / Technical Parameters

工作频率 working frequency	28KHZ	30KHZ	35KHZ	40KHZ
输出功率 output power	1200W	1000W	800W	600W
语言选择 language selection	中文/英文			
输入电压 input voltage	单相AC220V			
频率范围 frequency range	±0.5KHZ			
振幅调整 amplitude adjustment	1%~100%可调			
焊头行程 welding head stroke	50~75mm			
焊接时间 welding time	0.01~9.99s			
接入气压 access air pressure	0.1~0.7Mpa			
振头冷却 vibrating head cooling	风冷			
工作台尺寸 working desk size	195*310mm			
机器尺寸 machine size	500*320*1000mm			
机器重量 machine weight	约70KG			

### 主打应用行业 / Main application industry

精密型电子产品、耗材等。  
Precision electronic products, consumables, etc.





### 15K 2600W

压电直径:  $\phi 60 \times \phi 30 \times 10$  (P4)  
 螺纹规格: M24\*1.5/M16\*1 常规叫法: 15K塑焊  
 d: 36mm D: 75mm L1: 103mm L: 345mm

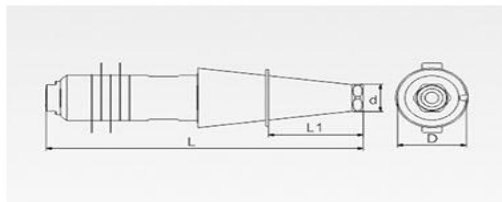
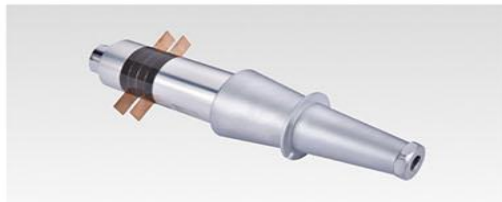

### 15K 2600W倒喇叭

压电直径:  $\phi 60 \times \phi 30 \times 10$  (P4)  
 螺纹规格: M24\*1.5/M16\*1 常规叫法: 15K倒喇叭  
 d: 38mm D: 74mm L1: 106mm L: 345mm

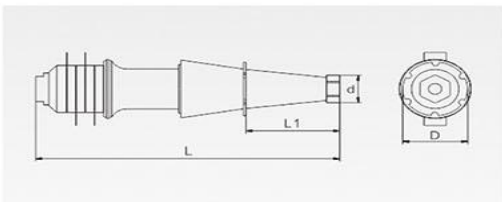

### 20K 1200W

压电直径:  $\phi 50 \times 4$   
 螺纹规格:  $\frac{3}{8}$ -24 常规叫法: 20K 1200W  
 d: 31mm D: 64mm L1: 59mm L: 258.5mm

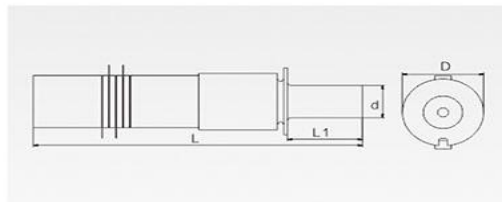

### 20K 2000W

压电直径:  $\phi 50 \times \phi 20 \times 6.5$  (P8) 两组  
 螺纹规格: M18\*1.5/ $\frac{3}{8}$ -24 常规叫法: 20K 2000  
 d: 31mm D: 64mm L1: 59mm L: 255mm

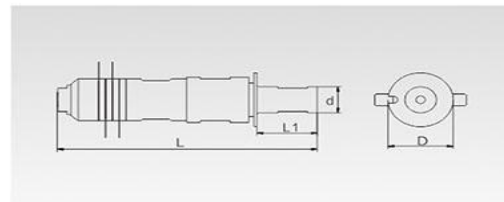
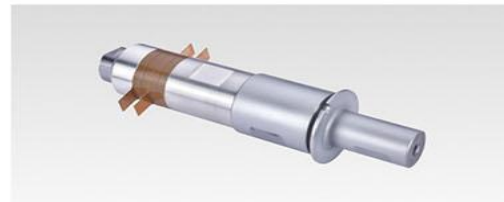

### 15K 3200W单头

压电直径:  $\phi 60 \times \phi 30 \times 10$  (P8)  
 螺纹规格: M24\*1.5/M16\*1 常规叫法: 单头3200  
 d: 39.5mm D: 90mm L1: 111mm L: 355mm

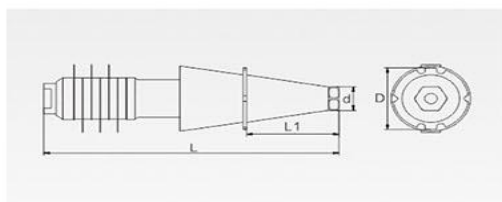
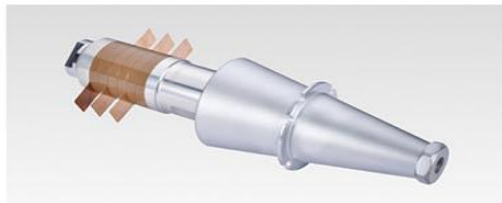

### 15K 4200W

压电直径:  $\phi 60 \times \phi 30 \times 10$  (P8) 两组  
 螺纹规格: M24\*1.5/M16\*1 常规叫法: 15K 4200  
 d: 50mm D: 98mm L1: 120mm L: 345mm

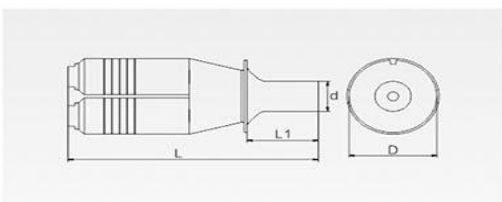
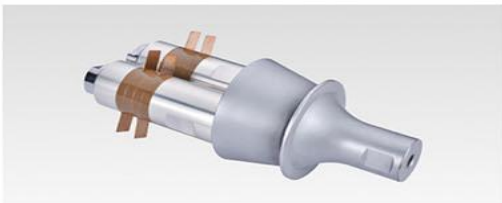

### 20K 2600W

压电直径:  $\phi 38 \times 2$ 组  
 螺纹规格: ( $\frac{3}{8}$ -24) ( $\frac{3}{8}$ -20) 常规叫法: 20K 双头  
 d: 38mm D: 75mm L1: 63mm L: 260mm

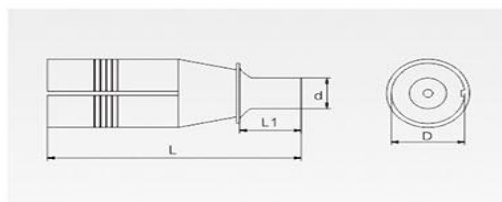

### 20K 美式换能器

压电直径:  $\phi 50 \times 4$   
 螺纹规格:  $\frac{3}{8}$ -24 常规叫法: 美式换能器  
 d: 38mm D: 76mm L1: 60mm L: 303mm

