

CE ISO FDA MDSAP TGA



# PRODUCTS

## MEDICAL NEEDLE EXPERT

WHILE ENSURING THE HIGHEST STANDARDS OF QUALITY AND SAFETY IN THEIR PRODUCTS.



**SHANGHAI MEKON MEDICAL DEVICES CO., LTD**

Tel: 0086-13916581865 0086-21-39557965  
 Fax: 0086-21-39555265  
 e-mail: info@mekonneedle.com skype: jack.qu1  
 Add.: 526 No. 697-3 lingshi road shanghai 200072 China  
 www.mekonneedle.com mekonneedle.en.alibaba.com



CE ISO FDA MDSAP TGA

SHANGHAI MEKON MEDICAL DEVICES CO., LTD



# SHANGHAI MEKON MEDICAL DEVICES

## Company Profile

SHANGHAI MEKON MEDICAL DEVICES CO., LTD.

Shanghai Mekon Medical Devices Co., Ltd. was established in 2009 and is dedicated to providing customized solutions for a wide range of special medical needles, cannulas, precision medical metal products, and various medical consumables specifically designed for needles and cannulas. Our comprehensive production process includes tube welding, tube drawing, machining, cleaning, packaging, and sterilization. We utilize advanced equipment imported from Japan and the United States to ensure the quality and stability of our production. Additionally, we have developed specialized processing equipment to meet our customers' unique product requirements.

## OUR PRODUCTS

Over the years, we have successfully developed a diverse array of products including anesthesia needles, blood collection needles, cosmetic needles, ophthalmic needles, Huber needles, biopsy needles, liposuction cannulas, and bone marrow needles. We also developed many complex needle and cannula accessories, such as half-cut guide needles, ovum aspiration needles, laser-cut tubes, spatula tip cannulas, and insulin pump cannula accessories etc.

## BUSINESS ADVANTAGE

We are committed to becoming the largest customized needle and cannula service company in China, as well as a manufacturer of high-quality standard medical consumables for needles and cannulas. Currently, we develop hundreds of special needle types each year, and the quality of tube manufacturing same or even exceeds similar products in Japan.



## International standard production line

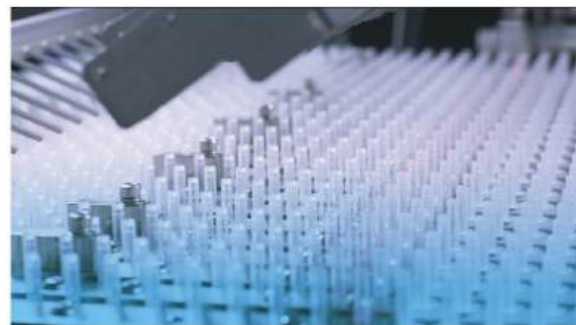

We utilize advanced equipment imported from Japan and the United States to ensure the quality and stability of our production.

# CATALOG

- 03 - Blood Collection (Multi -Sample) Needles
- 05 - Safety Blood Collection Set
- 07 - Push button blood collection set
- 09 - Safety Blood Collection Needle
- 11 - Blood collection assembly Product
- 13 - Spinal Needles
- 15 - Epidural Needles
- 16 - Introducer Needles
- 17 - Chiba Needles
- 19 - Radiofrequency Needle
- 21 - Veress Needle
- 22 - Biopsy Needle
- 23 - Bone Marrow Biopsy Needles
- 25 - Huber Needles
- 27 - Safety Huber Needle
- 29 - Micro Cannula for Fillers
- 30 - Mesotherapy needle
- 31 - Hair transplant needle
- 33 - Disposable Needles
- 35 - Safety Disposable Needles
- 37 - Low Dead Space Needle
- 39 - Scalp Vein Sets /Safety Scalp Vein Sets
- 41 - Blunt Fill Needle & Blunt Filter Needle
- 43 - Insulin Pen Needles
- 45 - Safety Pen Needle
- 47 - Insulin Syringe
- 48 - Safety Insulin Syringe
- 49 - Pen-type IV Catheter
- 50 - IV catheter with wings & port
- 51 - Spring Loaded Safety IV Catheter
- 53 - Slide type Safety IV Catheter
- 55 - Closed IV Catheter System
- 57 - Safety Closed IV Catheter System
- 59 - Dental irrigation needle
- 61 - Dental Needles
- 63 - Special Needles
- 65 - Cannulas
- 67 - Special Plastic Needle
- 68 - Polycarbonate Syringe
- 69 - Syringe
- 70 - 3-parts Syringe with Safety Needle
- 71 - Enteral Syringe
- 73 - Oral Syringe
- 75 - Syringes for Pre-Filled Use
- 77 - COC syringes

## Blood Collection (Multi-sample) Needles

### 1. Pen type blood collection needle:(type I)

- Latex Free
- Multi-sample needles permit several samples to be taken with a single puncture
- Sharp&smooth edges make penetration painless,easy connection to rubberstoppers

### 2. Pen type(flash back) blood collection needle(type II)

- Latex Free
- Multi-sample needles permit several samples to be taken with a single puncture
- Special design can observe the vein blood flash back.

### 3. Blood collection needle with scalp vein set (type III ) Blood Collection needle with hypodermic needle(type IV)

- Latex Free
- Soft and transparent tube can observe the vein blood flow clearly.
- Double wings make puncture safe.
- Different color wings means different size.



Type I		Type II		COLOR CODES AND SPECIFICATIONS							
SIZE		COLOR	LENGTH			LD		BEVEL	ANGLE	REF	
OD (mm)	GAUGE	COLOR & CODE	20 3/4"	25 1"	38 1 1/2"	RW	TW	Long bevel	Short bevel	Type I	Type II
0.60	23G	blue								BN-101	BN-201
0.70	22G	black								BN-102	BN-202
0.80	21G	green								BN-103	BN-203
0.90	20G	yellow								BN-104	BN-204
1.20	18G	pink								BN-105	BN-205

Remark:normal size in above table,we can also make special size as clients' request.

Type III		Type IV		COLOR CODES AND SPECIFICATIONS								
SIZE		COLOR	LENGTH				LD		BEVEL	ANGLE	REF	
OD (mm)	GAUGE	COLOR & CODE	16 5/8"	20 3/4"	25 1"	38 1 1/2"	RW	TW	Long bevel	Short bevel	Type III	Type IV
0.55	24G	purple									BN-301	BN-401
0.60	23G	blue									BN-302	BN-402
0.70	22G	black									BN-303	BN-403
0.80	21G	green									BN-304	BN-404
0.90	20G	yellow									BN-305	BN-405
0.10	19G	cream									BN-306	BN-406
1.20	18G	pink									BN-307	BN-407

Remark:normal size in above table,we can also make special size as clients' request.

## Safety Blood Collection Set

The Safety Blood Collection Set with an integrated safety mechanism, which shields the needle after use. This shield has been specifically designed to fit and secure around the needle for greater protection. Once the needle is secured in the shield, it is locked into position, preventing further exposure to the needle.

### Features & Benefits

- Slide-shield design provides safety for both nurse and patient.
- UTW, ETW wall thickness design to increase flow rate.
- Unique bevel design requires lower penetration force and provides more comfortable patient experience.

**Types:** Safety Blood Collection Set with holder and Safety Blood collection Set without holder

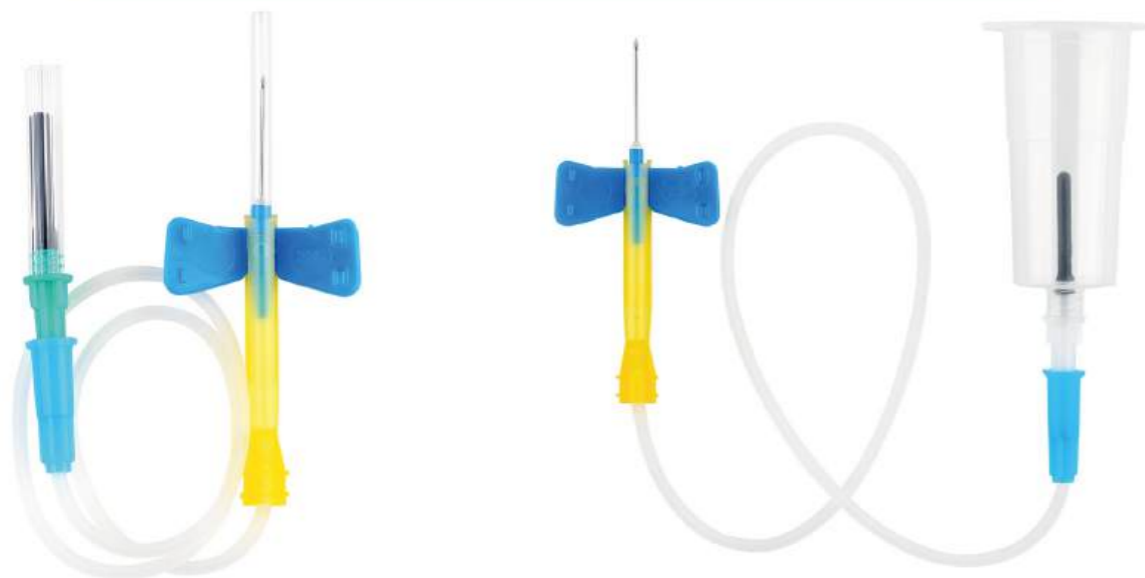

**Before**

1. Push the safety cover forward over the needle after using up

**After**

2. Make butterfly part totally lock into slot of safety device

### Safety Blood Collection Set

COLOR CODES AND SPECIFICATIONS

OD (mm)	SIZE	GAUGE	COLOR & CODE	LENGTH	ID		BEVEL ANGLE		REF
					RW	TW	Long bevel	Short bevel	
0.55	25G		orange	20 3/4"					SN-101
0.60	23G		blue						SN-102
0.70	22G		black						SN-103
0.80	21G		green						SN-104

Remark: normal size in above table, we can also make special size as clients' request.

### Safety Blood Collection Set with Holder

COLOR CODES AND SPECIFICATIONS

OD (mm)	SIZE	GAUGE	COLOR & CODE	LENGTH	ID		BEVEL ANGLE		REF
					RW	TW	Long bevel	Short bevel	
0.55	25G		orange	20 3/4"					SN-105
0.60	23G		blue						SN-106
0.70	22G		black						SN-107
0.80	21G		green						SN-108

Remark: normal size in above table, we can also make special size as clients' request.

## Push button blood collection set

Push button blood collection set features a push button safety mechanism that instantly helps protect you against needle stick injury. Its in-vein activation reduces the risk of healthcare worker exposure to a contaminated needle provides easy activation without patient discomfort and works well in high-risk environments.

### Features & Benefits

- Single-handed activation retracts the needle instantly from the vein into the needle hub, which provides safety for both nurse and patient.
- UTW, ETW wall thickness design to increase flow rate.
- Unique bevel design requires lower penetration force and provides more comfortable patient experience.

**Types:** Push button blood collection set without holder and Push button blood collection set with holder



Push button blood collection set

COLOR CODES AND SPECIFICATIONS

SIZE	COLOR	NEEDLE LENGTH	TUBING LENGTH	REF	
OD (mm)	GAUGE	COLOR & CODE			
0.55	25G	Orange	19mm	305mm	PBBCS2519305
0.60	23G	Blue	19mm	305mm	PBBCS2319305
0.80	21G	Green	19mm	305mm	PBBCS2119305
0.55	25G	Orange	19mm	178mm	PBBCS2519178
0.60	23G	Blue	19mm	178mm	PBBCS2319178
0.80	21G	Green	19mm	178mm	PBBCS2119178

Push button blood collection set pre-attached holder

COLOR CODES AND SPECIFICATIONS

SIZE	COLOR	NEEDLE LENGTH	TUBING LENGTH	REF	
OD (mm)	GAUGE	COLOR & CODE			
0.55	25G	Orange	19mm	305mm	PBBCS2519305
0.60	23G	Blue	19mm	305mm	PBBCS2319305
0.80	21G	Green	19mm	305mm	PBBCS2119305
0.55	25G	Orange	19mm	178mm	PBBCS2519178
0.60	23G	Blue	19mm	178mm	PBBCS2319178
0.80	21G	Green	19mm	178mm	PBBCS2119178

## Safety Blood Collection Needle

Safety Blood Collection Needle pen type, can be supplied with or without holder, the design of safeprotector cap can shield the cannula after use, prevent needle point from stabbing nurse, patient or other people, which can effectively reduce infection. This kind of safety blood collection needle is a safe substitute of the general blood collection needle for clinical application.

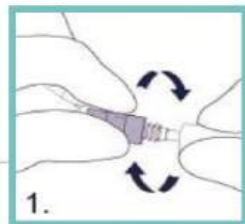

1. Holding both safety shield and colored needle cap, twist and remove white needle cap.

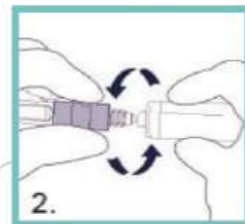

2. Hold safety shield and colored needle cap, screw holder onto needle.

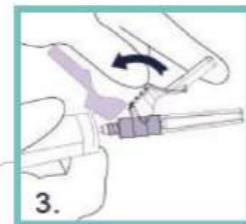

3. Gently position safety shield straight back.

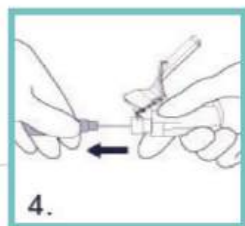

4. Twist and pull colored needle cap straight off.

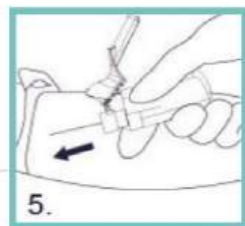

5. Perform venipuncture.

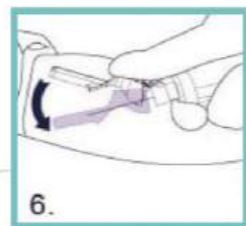

6. Engage safety shield with thumb on thumbpad.



7. Dispose of all used materials in appropriate container.

## Intended Use

This kind of product which is used for blood collection is applicable for needle holder and vacuum tube for blood sample collection.



### Safety Blood Collection Needle

COLOR CODES AND SPECIFICATIONS

OD (mm)	SIZE	GAUGE	COLOR & CODE	LENGTH			LD		BEVEL ANGLE		REF
				20 3/4"	25 1"	38 1 1/2"	RW	TW	Long bevel	Short bevel	
0.60	23G		blue								SN-201
0.70	22G		black								SN-202
0.80	21G		green								SN-203
0.90	20G		yellow								SN-204
1.20	18G		pink								

Remark: normal size in above table, we can also make special size as clients' request.

### Safety Blood Collection Needle with holder

COLOR CODES AND SPECIFICATIONS

OD (mm)	SIZE	GAUGE	COLOR & CODE	LENGTH			LD		BEVEL ANGLE		REF
				20 3/4"	25 1"	38 1 1/2"	RW	TW	Long bevel	Short bevel	
0.60	23G		blue								SN-206
0.70	22G		black								SN-207
0.80	21G		green								SN-208
0.90	20G		yellow								SN-209
1.20	18G		pink								SN-210

Remark: normal size in above table, we can also make special size as clients' request.

## Blood collection assembly Product Safety holder

Safety holder is a new designed of safety product, can be used with blood collection needles to collect blood samples. There are two types: Holder with safety sheath; quicke release holder. The design is aim to avoid nurse or patient injury efficiently.



1. After collection of the blood, thumb press down on the safety device of the holder.

2. Make safety device safety lock completely locked needle.

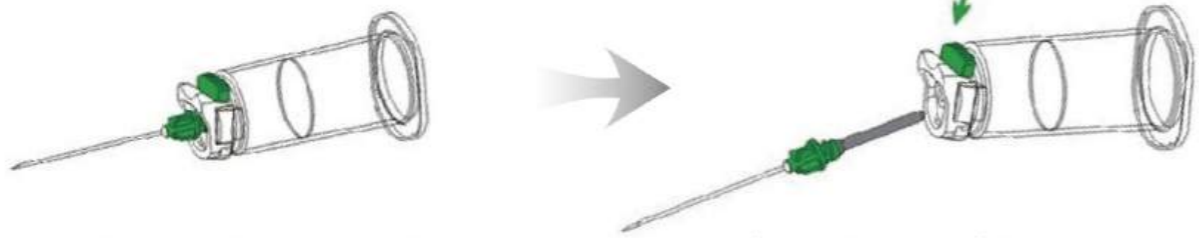

1. Put blood collection needle into the holder.

2. After collection of the blood. thumb press down the green button.

## Holder with luer adapter

There are three types: LH001, LH002 and LH003



SIZE	REF	DIAGRAM
0.8 x 19	LH001	
0.9 x 19	LH002	
0.9 x 19	LH003	

## Spinal Needles

Available Types: Quincke bevel or pencil point.

Can be with guide needle or without guide needle.

Sterile, latex-free, non-pyrogenic.

Available size: 18G-27G, length 30-180mm.

Transparent hub, easy to observe the cerebrospinal fluid discharge.

Unique needle tip design, thin-walled tube, high flow rate, and the 6:100 hub.

The hub of the stylet is color coded according to the diameter of the needle.



Quincke bevel



Pencil point

### COLOR CODES AND SPECIFICATIONS

Type	SIZE	GAUGE	COLOR	Length	REF	REF if with guide needle	
Spinal needle quincke bevel	0.4	27G	Grey	90mm	SQ2790	SQI2790	
	0.45	26G	Brown	90mm	SQ2690	SQI2690	
	0.5	25G	Orange	90mm	SQ2590	SQI2590	
	0.55	24G	Purple	90mm	SQ2490	SQI2490	
	0.6	23G	Blue	90mm	SQ2390	SQI2390	
	0.7	22G	Black	90mm	SQ2290	SQI2290	
	0.8	21G	Green	90mm	SQ2190	SQI2190	
	0.9	20G	Yellow	90mm	SQ2090	SQI2090	
	1.1	19G	Cream	90mm	SQ1990	SQI1990	
	1.2	18G	Pink	90mm	SQ1890	SQI1890	
	Spinal needle pencil point	0.4	27G	Grey	90mm	SP2790	SPI2790
		0.45	26G	Brown	90mm	SP2690	SPI2690
0.5		25G	Orange	90mm	SP2590	SPI2590	
0.55		24G	Purple	90mm	SP2490	SPI2490	
0.6		23G	Blue	90mm	SP2390	SPI2390	
0.7		22G	Black	90mm	SP2290	SPI2290	
0.8		21G	Green	90mm	SP2190	SPI2190	
0.9		20G	Yellow	90mm	SP2090	SPI2090	
1.1		19G	Cream	90mm	SP1990	SPI1990	
1.2		18G	Pink	90mm	SP1890	SPI1890	

## Epidural Needles

Epidural needle is used for epidural anaesthesia. The Epidural needle is designed to enhanced the tactile feel and the short tip length minimizes accidental dural puncture

- Colour coded hub indicating different needle gauge/ measurement
- Metal or plastic stylet
- Depth markers for awareness of needle placement depth
- Bevel tip smooth reducing risk of cutting the epidural catheter
- Sterile, latex-free, non-pyrogenic
- Available size includes 14G, 16G, 18G, 20G, 22G, length 60-150mm
- We can also make customized tip as your demand

### Customized services

#### Regular:



#### Other or you want:



#### Crawford needle (thin walled)

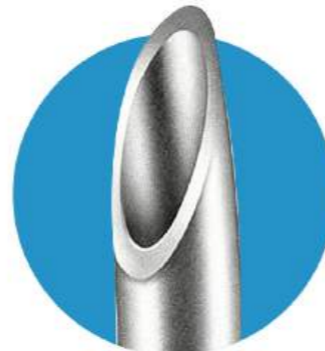

Tips: Try our best to meet your customized regirements

## Introducer Needles

- Smooth tip or Echogenic tip for enhanced visibility
- Designed for anterior, single wall, arterial percutaneous puncture.
- Smooth surface for easy insertion.
- Available with a clear window wall hub.
- Facilitates insertion of guidewire smoothly.
- Both bulk, non-sterile and sterile single pack is ok



COLOR CODES AND SPECIFICATIONS

SIZE OD (mm)	GAUGE	COLOR &CODE	LENGTH			ID		BEVEL ANGLE		REF
			25	40	70	UTW	TW	Long bevel	Short bevel	
0.55	24G	Purple								INT24
0.7	22G	Black								INT22
0.8	21G	Green								INT21
0.9	20G	Yellow								INT20
1.1	19G	Cream								INT19
1.28	18G	Pink								INT18
1.65	16G	White								INT16
2.1	14G	Pale green								INT14

Remark: normal size in above table, we can also make special size as clients' request.

## Chiba Needles

The chiba needle is highly versatile and can be used for fine needle aspiration biopsy and injection of drugs and contrast agents. It also features color coding on the hub of the needle to make identification of accurate gauge size easy.

The innovative internal echogenic marking on the needle tip ensures proper needle placement and provides continuous visualization under ultrasound guidance, maximizing surgical accuracy and safety.

The centimeter markings to help medical professionals determine insertion depth for maximum patient safety.

The hub is color-coded for easier determination of the needle size (gauge). Customization is also possible; customers can get the product in the size that best suits their needs.

Customized services can be provided, the needle tip, the markings or other customized demand is available.



- Precision-ground metal styletMinimized tissue carry-out into the puncture
- Rounded,blunt stylet-set backfrom tip
- Sharper tip design for east punctu-reoperation.



- larger inner diameterhigh Flow rate
- High flow rate
- High flow rate enablesfaster Flashpack
- larger inner diameter



### Medical grade SUS304, 316L

Have great stiffness, tenacity corrosion resistance.

Needle is manufactured of high performance thin wall stainless steel tubing

Reference	G	Needle Length	Color coded
CNA1810	18	10 CM	Pink
CNA1815	18	15 CM	Pink
CNA1820	18	20 CM	Pink
CNA1825	18	25 CM	Pink
CNA2010	20	10 CM	Yellow
CNA2015	20	15 CM	Yellow
CNA2020	20	20 CM	Yellow
CNA2025	20	25 CM	Yellow
CNA2110	21	10 CM	Green
CNA2115	21	15 CM	Green
CNA2120	21	20 CM	Green
CNA2125	21	25 CM	Green
CNA2210	22	10 CM	Black
CNA2215	22	15 CM	Black
CNA2220	22	20 CM	Black
CNA2225	22	25 CM	Black

## Radiofrequency Needle

- Straight, Curved, Blunt or Sharp Tips
- Available size: 16G 18G 20G 22G or other customized size
- Available length: 5cm 10cm 15cm or other customized length
- Active Tip Length: 5mm, 10mm or other customized length
- Lubricated or Non-lubricated
- Echogenic or Non-echogenic
- Quincke Bevel or Lancet Bevel
- Insulation coating



### Specifications



Curved

COLOR CODES AND SPECIFICATIONS					
Catalog No.	Quantity	Gauge	Length	Active tip	Color
RF-SC-2205-5	Box of 25 pcs	22G	5 cm	5 mm	Black
RF-SC-2210-5	Box of 25 pcs	22G	10 cm	5 mm	Black
RF-SC-2210-10	Box of 25 pcs	22G	10 cm	10 mm	Black
RF-SC-2010-5	Box of 25 pcs	20G	10 cm	5 mm	Yellow
RF-SC-2010-10	Box of 25 pcs	20G	10 cm	10 mm	Yellow
RF-SC-2015-5	Box of 25 pcs	20G	15 cm	5 mm	Yellow
RF-SC-2015-10	Box of 25 pcs	20G	15 cm	10 mm	Yellow
RF-SC-1810-10	Box of 25 pcs	18G	10 cm	10 mm	Pink
RF-SC-1815-10	Box of 25 pcs	18G	15 cm	10 mm	Pink
RF-SC-1610-10	Box of 25 pcs	16G	10 cm	10 mm	Light Grey
RF-SC-1615-10	Box of 25 pcs	16G	15cm	10 mm	Light Grey



Straight

COLOR CODES AND SPECIFICATIONS					
Catalog No.	Quantity	Gauge	Length	Active tip	Color
RF-ST-2205-5	Box of 25 pcs	22g	5 cm	5 mm	Black
RF-ST-2210-5	Box of 25 pcs	22g	10 cm	5 mm	Black
RF-ST-2210-10	Box of 25 pcs	22g	10 cm	10 mm	Black
RF-ST-2215-5	Box of 25 pcs	22g	15 cm	5 mm	Black
RF-ST-2215-10	Box of 25 pcs	22g	15 cm	10 mm	Black
RF-ST-2010-5	Box of 25 pcs	20g	10 cm	5 mm	Yellow
RF-ST-2010-10	Box of 25 pcs	20g	10 cm	10 mm	Yellow
RF-ST-2015-5	Box of 25 pcs	20g	15 cm	5 mm	Yellow
RF-ST-2015-10	Box of 25 pcs	20g	15 cm	10 mm	Yellow
RF-ST-1810-10	Box of 25 pcs	18g	10 cm	10 mm	Pink
RF-ST-1815-10	Box of 25 pcs	18g	15 cm	10 mm	Pink

The Radiofrequency Blunt Needles are designed with an atraumatic blunt tip, uniform tapered insulation, enhanced dielectric strength, hub reference indicator and are radiopaque. They are available in multiple sizes, needle lengths, and active tip lengths.



Blunt

### Curved

COLOR CODES AND SPECIFICATIONS					
Catalog No.	Quantity	Gauge	Length	Active tip	Color
RF-BC-2210-5	Box of 25 pcs	22g	10 cm	5 mm	Black
RF-BC-2210-10	Box of 25 pcs	22g	10 cm	10mm	Black
RF-BC-2010-5	Box of 25 pcs	20g	10 cm	5 mm	Yellow
RF-BC-2010-10	Box of 25 pcs	20g	10 cm	10mm	Yellow
RF-BC-2015-5	Box of 25 pcs	20g	15 cm	5 mm	Yellow
RF-BC-2015-10	Box of 25 pcs	20g	15 cm	10mm	Yellow

### Straight

COLOR CODES AND SPECIFICATIONS					
Catalog No.	Quantity	Gauge	Length	Active tip	Color
RF-ST-2010-5	Box of 25 pcs	22g	10cm	5 mm	Yellow
RF-ST-2010-10	Box of 25 pcs	22g	10cm	10mm	Yellow
RF-ST-2015-5	Box of 25 pcs	20g	15 cm	5 mm	Yellow
RF-ST-2015-10	Box of 25 pcs	20g	15 cm	10mm	Yellow

## Veress Needle

- Veress Needles are designed for the safe, simple, effective creation of the pneumoperitoneum.
- Big size spring-loaded stylet provides loud audible "click" when passing through tissue layers.
- Visible red indicator of needle position.
- Sharp tip for easy insertion.
- High flow stopcock.
- Two sizes with 120/150mm length are available



## Biopsy Needle

- Atraumatic and Echogenic needle tip design for optimum ultrasound visibility
- Light weight handle
- Adjustable sample notch: 10mm/20mm
- Centimeter marked cannula
- Color code available to identify the accurate size easily
- Optionally: "Co-axial needles" are available
- It is a disposable semi-automatic biopsy device used to take samples of soft tissues and organs.
- Echogenic marker placed at the distal tip and needle with depth marking.
- 14G, 16G and 18G

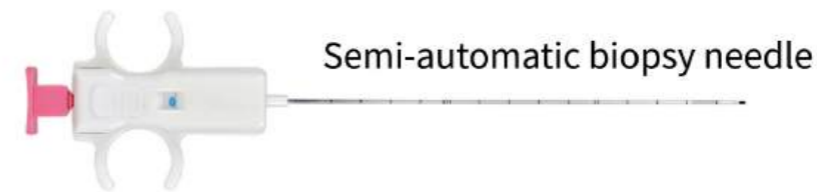

GAUGE	LENGTH	COLOR
14G	100 · 150 · 200 · 250mm	PALE GREEN
16G	100 · 150 · 200 · 250mm	WHITE
18G	100 · 150 · 200 · 250mm	PINK



10,20mm visible window More for clinical operation



Special treatment for the cannula tip Applicable for CT and B-ultrasound



Safety lock device Ensure safety in using



centimeter marking Accurate positioning, easy for clinical use



Deep notch design Sampling more complete

## Bone Marrow Biopsy Needles

Twist-lock human ergonomic handle designed to minimize hand and arm fatigue  
 Extra sharp stylet point designed for quick and easy penetration  
 Unique extraction cannula captures and retains marrow specimens  
 Centimeter markings for estimated depth of penetration  
 Both sharp bevel tip and diamond tip is available for different use.  
 Side holes are available to allow for efficient aspiration.



Specification		COLOR CODES AND SPECIFICATIONS					REF
SIZE	COLOR	LENGTH					
OD (mm)	GAUGE	COLOR & CODE	2¾"	3½"	4¼"	5"	
4.20	8G	blue					BMW08
3.40	10G	blue					BMW10
3.00	11G	blue					BMW11
2.50	13G	blue					BMW13
1.80	15G	blue					BMW15

Remark: normal size in above table, we can also make special size as clients' request.

The handle includes a sharpened luer-lock which gives a safer attachment to the syringe. Aspiration can be performed at any step of the procedure

Digital scale can provide accurate puncture depth

### Multiple edge

The edge is strong and sharp, that allows a quick and less invasive penetration into the cortical

Pick up needle is provided with a rotation coupling security system which limits the risk of movement of the stylet during the insertion.

Special trocar needle and sharp tubing ensure minimal invasion, 5 side holes at front end of tubing, multi-way collect bone marrow, more efficient and less pain.

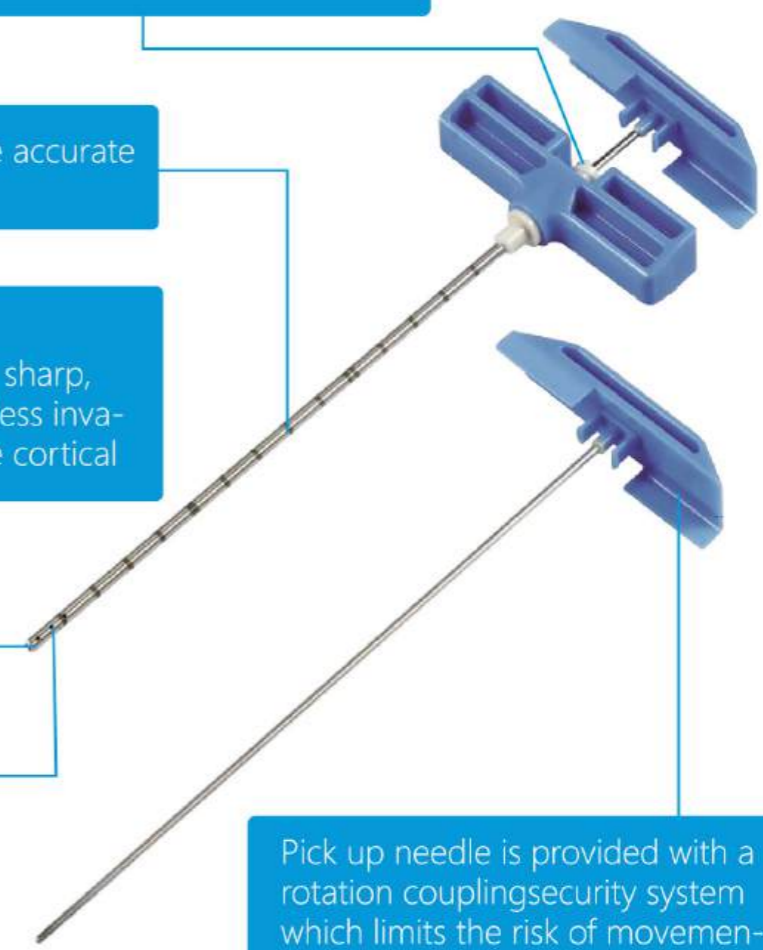

## Huber Needles

### Structure and composition:

The huber needles are assembled by protective cap, needle hub, needle tube, tubing, injection site, robert clamp and other parts. All materials meet medical requirement, sterilized by ETO. pyrogenfree.

### Material:

PC, PP, PVC, SUS304 Stainless Steel Cannula, Silicone oil

### Intended use:

The huber needle is intended to be used to feed medicine to the device implanted in patient hypoderm.

### Types:

Huber needle with wing: with Y port and without Y port

Huber needle with air-vent hub

Huber needle with disposable hub: Straight huber needle, 90 degree curved huber needle



#### Huber needle with wing

SIZE		COLOR	LENGTH							ID		BEVEL ANGLE		REF	
OD (mm)	GAUGE	COLOR & CODE	8 1/3"	13 1/2"	16 5/8"	20 3/4"	25 1"	32 1 1/4"	38 1 1/2"	50 2"	RW	TW	Long bevel	Short bevel	
0.70	22G	black													01-951
0.80	21G	green													01-952
0.90	20G	yellow													01-953
1.10	19G	cream													01-954

Remark:normal size in above table,we can also make special size as clients' request.

#### Huber needle with disposable hub

SIZE		COLOR	LENGTH							ID		BEVEL ANGLE		REF	
OD (mm)	GAUGE	COLOR & CODE	8 1/3"	13 1/2"	16 5/8"	20 3/4"	25 1"	32 1 1/4"	38 1 1/2"	50 2"	RW	TW	Long bevel	Short bevel	
0.40	27G	grey													01-955
0.45	26G	brown													01-956
0.50	25G	orange													01-957
0.55	24G	purple													01-958
0.60	23G	blue													01-959
0.70	22G	black													01-960
0.80	21G	green													01-961
0.90	20G	yellow													01-962
1.10	19G	cream													01-963
1.20	18G	pink													01-964

Remark:normal size in above table,we can also make special size as clients' request.

## Safety Huber Needle

The Safety Huber Needle is designed for the safe and efficient access of implanted ports. It is an essential tool for healthcare professionals, ensuring patient safety and comfort during a variety of medical procedures.

Safety mechanism provides additional protection

With additional Y port or without additional Y port

Size: 19G, 20G and 22G

Length: 15mm, 20mm, 25mm, 32mm, or other customized length.

Wing: can be with wing or without wing

Y port: can be with Y port or without Y port



### Needle tip shielding protection device

A unique needle tip shielding device is used to reduce the risk of stabbing injuries for doctors and patients,



### Special needle tip design

minimize coring and fragmentation at penetration



### Special needle tip design

Standard Needle

VS

Huber Needles

minimize coring and fragmentation

#### COLOR CODES AND SPECIFICATIONS

OD (mm)	SIZE	GAUGE	COLOR & CODE	LENGTH			ID		BEVEL ANGLE		REF	
				15	19	25	RW	TW	Long bevel	Short bevel	W/Y port	WO Y port
0.60		23G	blue								SHY23	SHN23
0.70		22G	black								SHY22	SHN22
0.80		21G	green								SHY21	SHN21
0.90		20G	yellow								SHY20	SHN20
1.10		19G	cream								SHY19	SHN19

Remark: normal size in above table, we can also make special size as clients' request.

## Micro cannula for fillers

- Round tip designed for non-invasive intradermal injections of fluids such as dermal fillers, hyaluronic acid fillers (HA fillers) and other injectable fillers.
- The red dot on the hub marks the location of the product outlet, allowing for precise control over product dispensing. Other customized color for indicator is also ok.
- Can be supplied with graduation or without graduation, packed with sharp needle or without needle
- Sizes from 14G to 30G.
- Length: 25mm, 40mm, 50mm, 70mm, 100mm or other customized length
- Sterilized by ethylene oxide, non-pyrogenic.
- Flexible cannula provides you better experience.
- OEM printing or ODM design is also available.
- Wall thickness can be customized, we can make UTW,ETW as client's demand

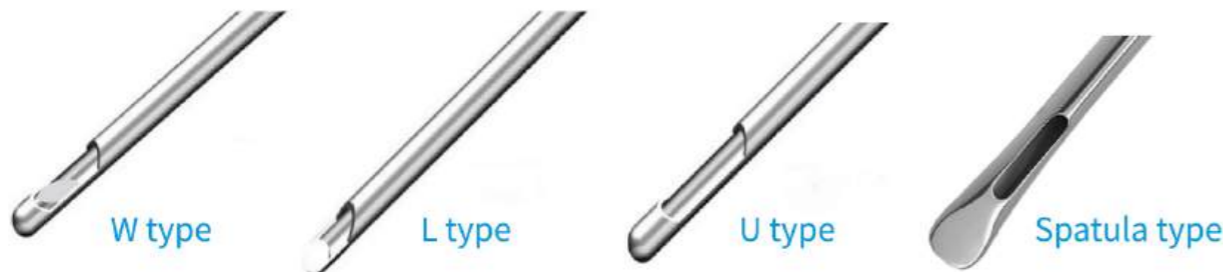

## Mesotherapy needle

- Made of high quality stainless steel
- With large ID and high flow
- Delicately-designed needle-point with features of sharpness, smooth puncture, less damage to the tissue, less painful feeling to the patient Size distinguished by the needle-hub's color for thr recongnition
- Sterilized: by EO



SIZE		COLOR	LENGTH							REF
OD (mm)	GAUGE	COLOR & CODE	1.5mm	2mm	2.5mm	4mm	6mm	8mm	12mm	
0.4	27G	Grey	[Grey bar]							MN27
0.3	30G	Light yellow	[Light yellow bar]							MN30
0.25	31G	White	[White bar]							MN31
0.23	32G	Green	[Green bar]							MN32
0.21	33G	Black	[Black bar]							MN33
0.18	34G	Orange	[Orange bar]							MN34

Remark: normal size in above table, we can also make special size as clients' request.

## Hair transplant needle

### Structure and composition:

- The Hair transplant needle consist of needle hub, needle tube. Protective cap.
- All materials meet medical requirement, sterilized byETO, pyrogen free.

### Material:

- PP
- SUS304 Stainless Steel Cannula
- Silicone oil

### Intended use:

- The Hair transplant needle is used for single hair follicle transplantation.
- The hair follicle is directly inserted into the skin for implantation.

### Specifications:

- 0.6mm
- 0.8mm
- 1.0mm
- 1.2mm

### Medical grade SUS304

- Have great stiffness, tenacity corrosion resistance. Comply with international standards,
- with excellent precision and unparalleled results

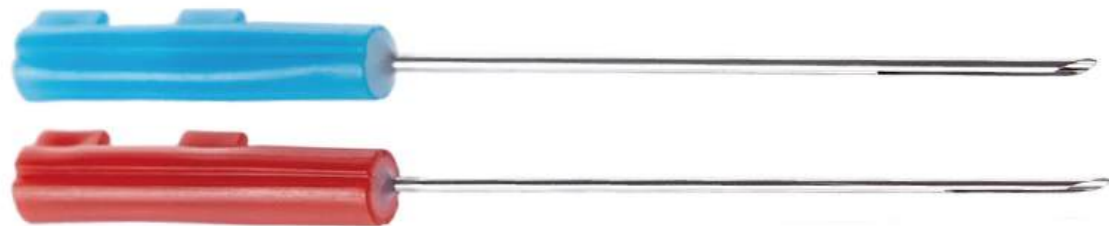

BEFORE



AFTER

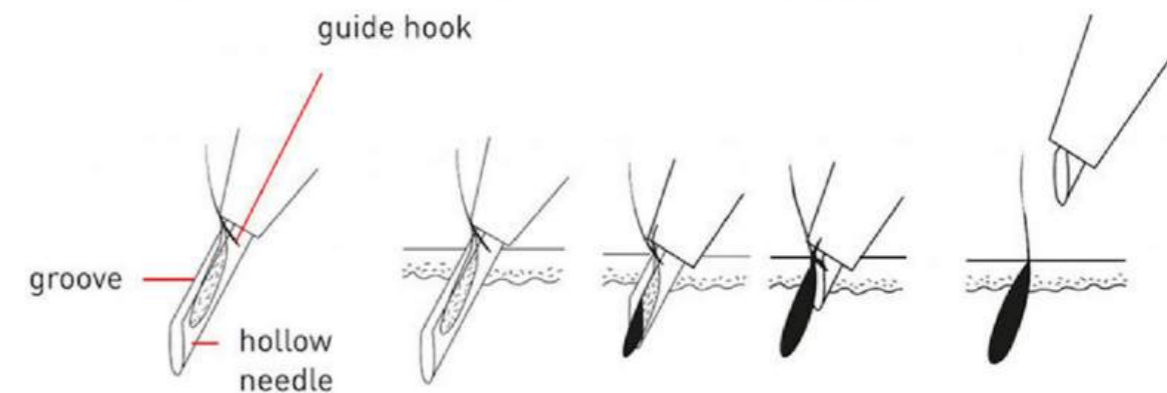

## Disposable Needles

- Made of high quality stainless steel
- With large ID and high flow
- Semi-transparent needle-hub for the convenient observation of blood reflux
- Delicately-designed needle-point with features of sharpness,smooth puncture
- less damage to the tissue,less painful feeling to the patient
- Size distinguished by the needle-hub's color for the clear recognition
- The flexible supply form:in bulk or pack,sterilized or unsterilized
- Production of all kinds of special needles required by our customers
- Packing types:in bulk or in blister
- Wall thickness can be customized, we can make UTW,ETW as client's demand



SIZE		COLOR	LENGTH										ID		BEVEL ANGLE		REF
OD (mm)	GAUGE	COLOR & CODE	4 1/6"	6 1/4"	8 1/3"	13 1/2"	16 5/8"	20 3/4"	25 1"	32 1 1/4"	38 1 1/2"	50 2"	RW	TW	Long bevel	Short bevel	
0.18	34G	orange	[Orange bar]										[Orange bar]	[Orange bar]			DN-000
0.21	33G	black	[Black bar]										[Black bar]	[Black bar]			DN-001
0.23	32G	green	[Green bar]										[Green bar]	[Green bar]			DN-002
0.25	31G	blue	[Blue bar]										[Blue bar]	[Blue bar]			DN-003
0.30	30G	light-yellow	[Light-yellow bar]										[Light-yellow bar]	[Light-yellow bar]			DN-004
0.33	29G	red	[Red bar]										[Red bar]	[Red bar]			DN-005
0.36	28G	blue-green	[Blue-green bar]										[Blue-green bar]	[Blue-green bar]			DN-006
0.40	27G	grey	[Grey bar]										[Grey bar]	[Grey bar]			DN-007
0.45	26G	brown	[Brown bar]										[Brown bar]	[Brown bar]			DN-008
0.50	25G	orange	[Orange bar]										[Orange bar]	[Orange bar]			DN-009
0.55	24G	purple	[Purple bar]										[Purple bar]	[Purple bar]			DN-010
0.60	23G	blue	[Blue bar]										[Blue bar]	[Blue bar]			DN-012
0.70	22G	black	[Black bar]										[Black bar]	[Black bar]			DN-013
0.80	21G	green	[Green bar]										[Green bar]	[Green bar]			DN-014
0.90	20G	yellow	[Yellow bar]										[Yellow bar]	[Yellow bar]			DN-015
1.10	19G	cream	[Cream bar]										[Cream bar]	[Cream bar]			DN-016
1.20	18G	pink	[Pink bar]										[Pink bar]	[Pink bar]			DN-017
1.60	16G	white	[White bar]										[White bar]	[White bar]			DN-018
1.80	15G	blue-grey	[Blue-grey bar]										[Blue-grey bar]	[Blue-grey bar]			DN-019
2.10	14G	pale-green	[Pale-green bar]										[Pale-green bar]	[Pale-green bar]			DN-020

Remark:normal size in above table,we can also make special size as clients' request.

## Safety Disposable Needles

### Product Use:

- It can match with normal syringe in clinical injection of liquid medicine.
- which can effectively prevent the acupuncture accident.

### Product Features:

- It can match with all kinds of syringes with standard luer tip.
- After injection, only need to push upward lightly or knock the safety protector, which can immediately achieve the purpose of protecting the needle tip.
- Multiple protections, the safety protector will not be off accidentally.
- Effective function and simple design can reduce the cost of safety injection.
- Wall thickness can be customized, we can make UTW, ETW as client's demand

### Operation Method



Index finger



Thumb form



Tabletop



It activates an audible click to validate that the needle is covered and fully protected.

### Wide-Textured Finger Pad

Provides safe activation area for thumb and forefinger

### Needle hub

The 6:100 conical fitting produced according to international standard-shas accurate size



### Bevel-Oriented Needle

Allows for low-angle injections

SIZE		COLOR	LENGTH						ID		BEVEL ANGLE		REF
OD (mm)	GAUGE	COLOR & CODE	13 1/2"	16 5/8"	20 3/4"	25 1"	32 1 1/4"	38 1 1/2"	RW	TW	Long bevel	Short bevel	
0.30	30G	light yellow											SN-001
0.33	29G	red											SN-002
0.36	28G	blue-green											SN-003
0.45	27G	grey											SN-004
0.50	26G	brown											SN-005
0.55	25G	orange											SN-006
0.60	24G	purple											SN-007
0.70	23G	blue											SN-008
0.80	22G	black											SN-009
0.90	21G	green											SN-010
1.10	20G	yellow											SN-011
1.20	19G	cream											SN-012
	18G	ping											SN-013

Remark: normal size in above table, we can also make special size as clients' request.

## Low Dead Space Needle

Low Dead Space needles may help to reduce the risk of blood borne virus transmission by significantly reducing the dead space in a syringe, therefore minimising exposure to potentially contaminated blood fluid.

Wall thickness can be customized, we can make UTW,ETW as client's demand

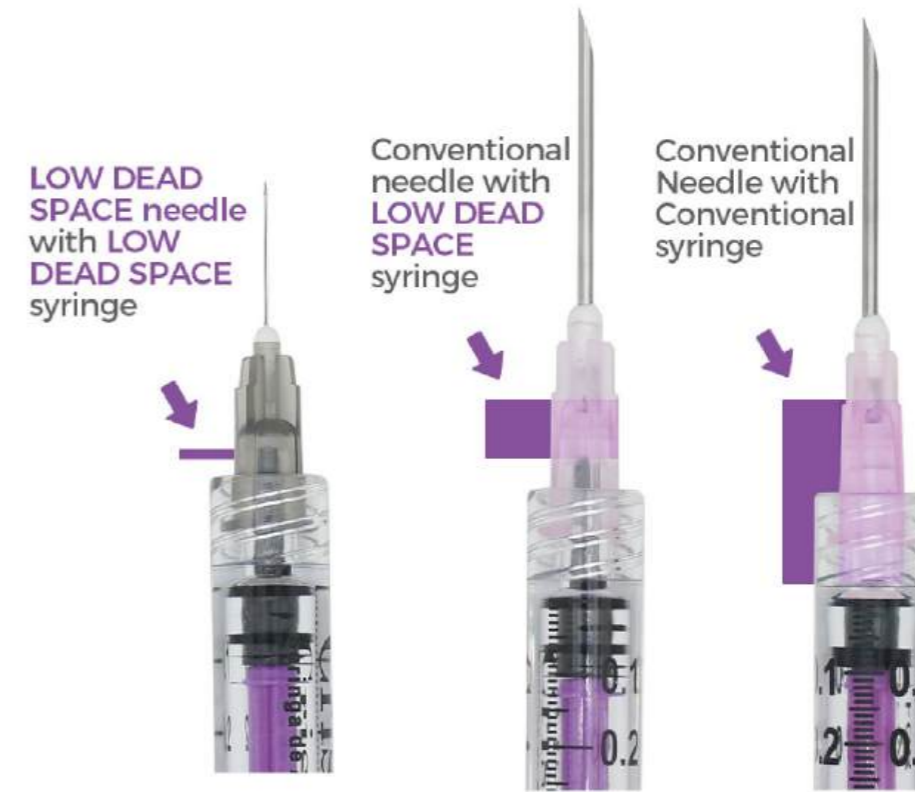
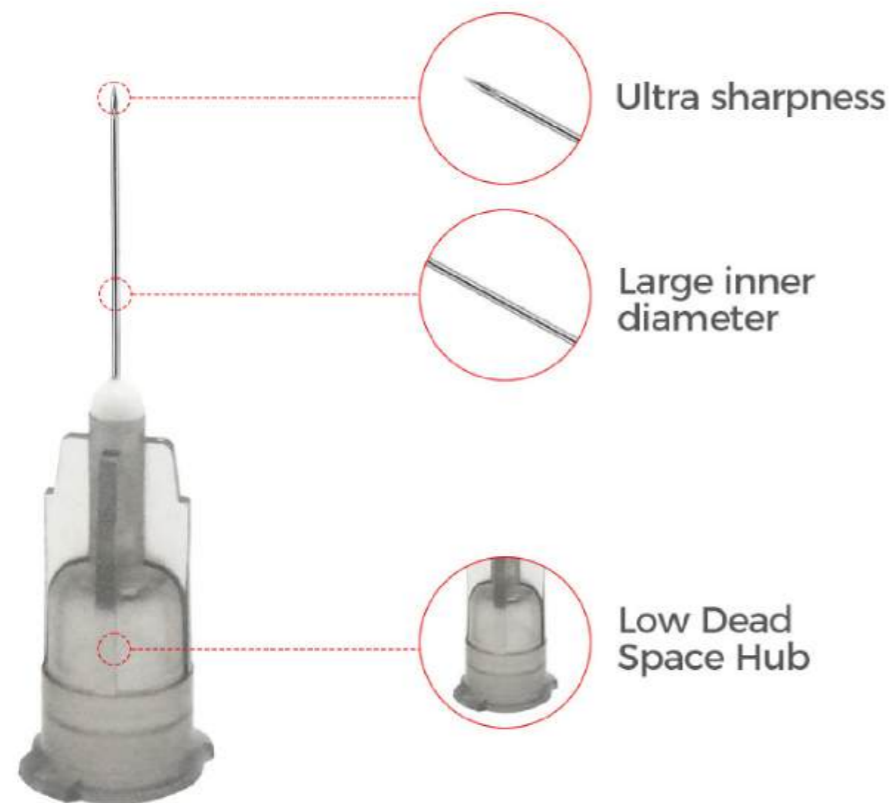

LOW DEAD SPACE needle hub design reduces the excess effective hub space to nearly ZERO

COLOR CODES AND SPECIFICATIONS

SIZE OD (mm)	GAUGE	COLOR & CODE	LENGTH							REF
			1.5mm	2mm	2.5mm	4mm	6mm	8mm	12mm	
0.4	27G	Grey	[Grey bar]							LDS27
0.3	30G	Light yellow	[Light yellow bar]							LDS30
0.25	31G	White	[White bar]							LDS31
0.23	32G	Green	[Green bar]							LDS32
0.21	33G	Black	[Black bar]							LDS33
0.18	34G	Orange	[Orange bar]							LDS34

Remark: normal size in above table, we can also make special size as clients' request.

## Scalp Vein Sets Safety Scalp Vein Sets

- Types: normal type and safety type
- Delicately-designed needle-point with features of sharpness, smooth puncture, less damage to the tissue, less painful feeling to the patient
- With soft wings for the convenience of fixation
- With large ID and high flow
- Size distinguished by the wing's color for the clear recognition
- Safety scalp vein set with protective sheath on the tube
- Soft pulling after the infusion so that the needle can be pulled into the protective sheath so as to prevent the medical care persons hurt by the used needle.
- Needle-hub types: 1. PVC hub; 2. ABS hub
- Wing types: 1. Single wing ABS; 2. Double wing PVC
- Packing types: in bulk, PE package or in blister package

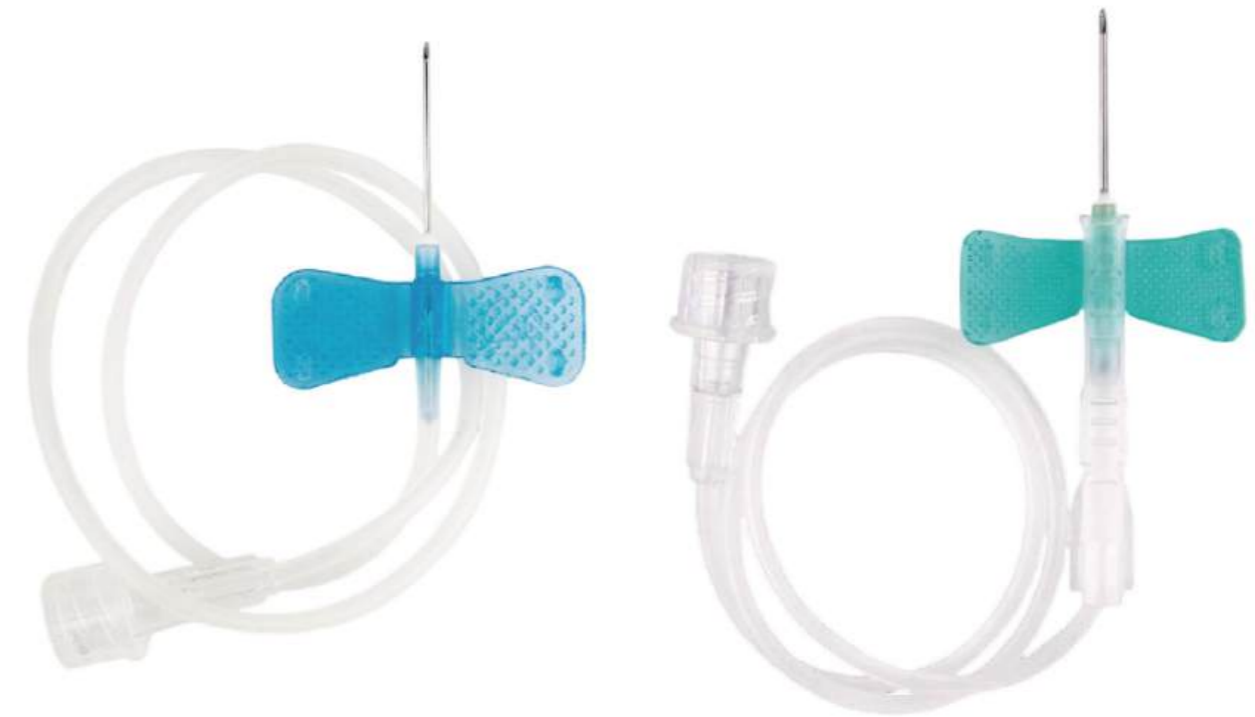

SIZE		COLOR	LENGTH					ID		BEVEL ANGLE		REF	REF FOR SAFETY TYPE
OD (mm)	GAUGE	COLOR & CODE	13 1/2"	16 5/8"	20 3/4"	25 1"	28 1 1/4"	RW	TW	Long bevel	Short bevel		
0.40	27G	grey										01-051	SN-051
0.45	26G	brown										01-052	SN-052
0.50	25G	orange										01-053	SN-053
0.55	24G	purple										01-054	SN-054
0.60	23G	blue										01-055	SN-055
0.70	22G	black										01-056	SN-056
0.80	21G	green										01-057	SN-057
0.90	20G	yellow										01-058	SN-058
1.10	19G	cream										01-059	SN-059
1.20	18G	pink										01-060	SN-060

Remark: normal size in above table, we can also make special size as clients' request.

## Blunt Fill Needle & Blunt Filter Needle

### Brief description of the product

The Blunt Filter Needles are assembled by projective cap, needle tube, needle hub (with filter), one-way valve, adapter.

The Drawing-up Filter Straw are assembled by tube, needle hub (with filter), one-way valve, adapter. All connect with Syringes used to draw up medicine liquid from container, with features such as filtering, prevent counter current.

### Characteristic

- Use cannula construction, inner puncturing needle with inverse angle for less hurt on tissue.
- Outer cannula: cutting end with inclined blade, less pain, less friction, quicker cutting.
- Graduation on outer cannula let doctor know exact position puncturing reach, then sampling
- Little hurt, safe, effective.



### Detailed specifications

COLOR CODES AND SPECIFICATIONS

Type	SIZE		COLOR	Length	FILTER	REF
	OD(mm)	GAUGE	COLOR & CODE			
Blunt fill needle	1.1	19G	Cream	50mm	/	BNO1950
	1.1	19G	Cream	38mm	/	BNO1938
	1.1	19G	Cream	25mm	/	BNO1925
	1.2	18G	Pink	50mm	/	BNO1850
	1.2	18G	Pink	38mm	/	BNO1838
	1.2	18G	Pink	25mm	/	BNO1825
Blunt filter needle	1.1	19G	Cream	50mm	5 μm	BNW1950
	1.1	19G	Cream	38mm	5 μm	BNW1938
	1.1	19G	Cream	25mm	5 μm	BNW1925
	1.2	18G	Pink	50mm	5 μm	BNW1850
	1.2	18G	Pink	38mm	5 μm	BNW1838
	1.2	18G	Pink	25mm	5 μm	BNW1825
Side hole tip filter needle	1.1	19G	Cream	50mm	5 μm	SHW1950
	1.1	19G	Cream	38mm	5 μm	SHW1938
	1.1	19G	Cream	25mm	5 μm	SHW1925
	1.2	18G	Pink	50mm	5 μm	SHW1850
	1.2	18G	Pink	38mm	5 μm	SHW1838
	1.2	18G	Pink	25mm	5 μm	SHW1825
Common tip filter needle	1.1	19G	Cream	50mm	5 μm	SHW1950
	1.1	19G	Cream	38mm	5 μm	HW1938
	1.1	19G	Cream	25mm	5 μm	HW1925
	1.2	18G	Pink	50mm	5 μm	HW1850
	1.2	18G	Pink	38mm	5 μm	HW1838
	1.2	18G	Pink	25mm	5 μm	HW1825

Remark: normal size in above table, we can also make special size as clients' request.

### Product Conformance

"In compliance with European Medical Device Directive 93/42/EEC (CE Class: I)"

### Quality Assurance

Manufacturing process is in compliance with ISO 13485 and ISO 9001 Quality System.

### Main material

ABS, PP, PC, SUS304 Stainless Steel Cannula, Silicone oil

## Insulin Pen Needles

The insulin pen needles is used in conjunction with an insulin injection pen for subcutaneous insulin injection in diabetic patients.

- Optimum treatment with maximum simplicity
- Sterile, non-toxic, non-pyrogenic
- Double point system
- Patient point with triple beveling for easy and atraumatic
- Cartridge point sharpened for a perfect punch with no fragmentation
- Compatible with all available pen models
- Easy flow of medication without any impurities



Reference	Gauge	length (mm)	Color code
PN2904	29G	4	Red
PN2905	29G	5	Red
PN2906	29G	6	Red
PN2908	29G	8	Red
PN3004	30G	4	Yellow
PN3005	30G	5	Yellow
PN3006	30G	6	Yellow
PN3008	30G	8	Yellow
PN3104	31G	4	Blue
PN3105	31G	5	Blue
PN3106	31G	6	Blue
PN3108	31G	8	Blue
PN3204	32G	4	Green
PN3205	32G	5	Green
PN3206	32G	6	Green
PN3208	32G	8	Green
PN3304	33G	4	Purple
PN3305	33G	5	Purple
PN3306	33G	6	Purple
PN3308	33G	8	Purple

## Safety Pen Needle

Same use steps as normal insulin pen needles, no more operation, automatically achieve the function of protecting needle tip after use  
Match with normal insulin pen in market  
Pain-release triple bevel needle tip design, large flow thin wall cannula

**Available size:** 29G,30G,31G,32G,33G,  
**length:** 4mm,5mm,6mm,8mm



Gauge	Product code	length (mm)	Product code	length (mm)	Product code	length (mm)	Product code	length (mm)
29G	SPN2904	4	SPN2905	5	SPN2906	6	SPN2908	8
30G	SPN3004	4	SPN3005	5	SPN3006	6	SPN3008	8
31G	SPN3104	4	SPN3105	5	SPN3106	6	SPN3108	8
32G	SPN3204	4	SPN3205	5	SPN3206	6	SPN3208	8
33G	SPN3304	4	SPN3305	5	SPN3306	6	SPN3308	8

### 1. Before use.



Connect the insulin needle to the pen, and remove the outer protective cap.(The tip part is protected by a transparent protective cap)

### 2. Injection Process



#### Advantage

1. One-handed activation safety mechanism.
2. Small and compact structure for convenient use.
3. Short needle tube with large flow rate and low residue volume.

Fit the protective cover vertically to the skin, then press it down to the end. After hear a "click" ,the protection device is in the excited state and the needle tip has punctured into the skin.

### 3. After use.



Take out the insulin needle, activate the safety protection device, and automatically complete the needle tip protection.

## Insulin Syringe

### Structure and Composition:

The Syringes are assembled by Needle Protective Cap, Needle Tube, Barrel, Plunge, Piston and Protective Cap. All parts and material for this product meet medical requirements. Sterilized by EO.

### Main Material:

PP, isoprene Rubber, Silicone Oil, SUS304 Stainless Steel Cannula

### Certificate and Quality Assurance:

CE, FDA, ISO13485

### Specification:

0.3ml, 0.5ml, 1ml  
U-40, U-100

### Needle Size:

27G-31G



### Intend Use:

Insulin syringe is intended to be used for the patients to inject insulin.

### Refer Code:

Specification	U-40	U-100
0.3ml	INS111	INS112
0.5ml	INS121	INS122
1ml	INS131	INS132

## Safety Insulin Syringe

### Structure and Composition:

The Syringes are assembled by Sliding Sleeve, Needle Protective Cap, Needle Tube, Barrel, Plunge and Piston. All parts and material for this product meet medical requirements. Sterilized by EO.

### Main Material:

PP, Isoprene Rubber, Silicone Oil.  
SUS304 Stainless Steel Cannula

### Specification:

0.3ml, 0.5ml, 1ml  
U-40, U-100

### Needle Size:

27G-31G



Sliding Sleeve



### Certificate and Quality Assurance:

CE, FDA, ISO13485

### Intend Use:

Safety Insulin syringe is intended to be used for the patients to inject insulin.

### Refer Code:

Specification	U-40	U-100
0.3ml	INS211	/
0.5ml	INS221	INS222
1ml	INS231	INS232

## Pen-type IV Catheter

Designed to perform in delicate vasculature delivering maximum efficiency and patient comfort

- Hard plastic outer packaging protects catheter before use
- Smooth catheter-to-needle transition results in easy insertion
- Teflon catheter material is biocompatible minimizing risk of irritation and infection while catheter is indwelling
- Hub is color-coded for rapid identification of catheter size



COLOR CODES AND SPECIFICATIONS

SIZE	Catheter Length (mm)	Outer diameter (mm)	Flow Rate (mm)	Color Code	Shelf Box/ Shipping Case
24G	19	0.7	22	yellow	50/2000
22G	25	0.9	36	blue	50/2000
20G	32	1	58	pink	50/2000
18G	32	1.2	90	green	50/2000
17G	45	1.5	120	white	50/2000
16G	45	1.8	172	grey	50/2000
14G	45	2	208	orange	50/2000

## IV Catheter with wings & port

- Color-coded Injection port for easy bolus administration
- Wings are specially treated to provide easy & secure fixation with the patient skin.
- Teflon catheter material is biocompatible minimizing risk of irritation and infection while catheter is indwelling
- Back cut Needle reduces penetration force and optimizes insertion performance.



COLOR CODES AND SPECIFICATIONS

SIZE	Catheter Length (mm)	Outer diameter (mm)	Flow Rate (mm)	Color Code	Shelf Box/ Shipping Case
24G	19	0.7	22	yellow	50/500
22G	25	0.9	36	blue	50/500
20G	32	1	58	pink	50/500
18G	32	1.2	90	green	50/500
17G	45	1.5	120	white	50/500
16G	45	1.8	172	grey	50/500
14G	45	2	208	orange	50/500

## Spring Loaded Safety IV Catheter

The spring-loaded safety IV catheter is a type of intravenous (IV) catheter designed with a built-in safety mechanism to reduce the risk of needlestick injuries to health-care professionals. This mechanism typically involves a spring that, when activated the push button, retracts the sharp needle directly into a protective barrel or housing.



blood control



reduce risk of needle injury



Teflon

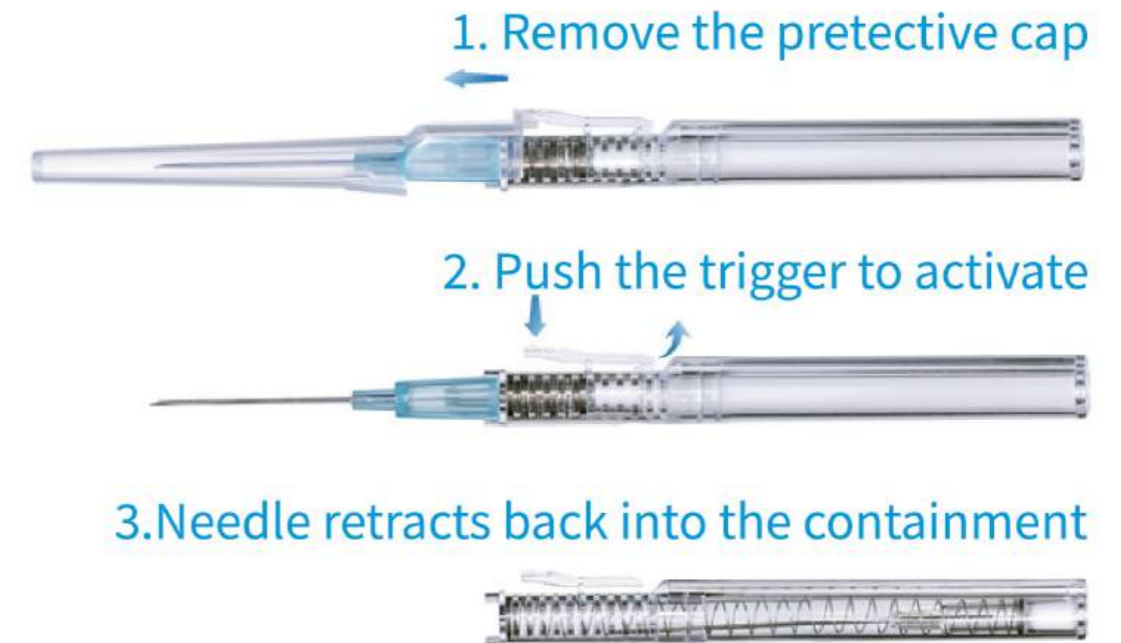

### Using step

Push -button needle shielding

COLOR CODES AND SPECIFICATIONS					
SIZE	Catheter Length (mm)	Outer diameter (mm)	Flow Rate (mm)	Color Code	Shelf Box/ Shipping Case
24G	19	0.7	22	yellow	50/500
22G	25	0.9	36	blue	50/500
20G	32	1	58	pink	50/500
18G	32	1.2	90	green	50/500
17G	45	1.5	120	white	50/500
16G	45	1.8	172	grey	50/500
14G	45	2	208	orange	50/500

## Slide type Safety IV Catheter

The slide type safety IV catheter is another type of safety-engineered intravenous catheter designed to protect healthcare workers from needlestick injuries. Instead of a spring-loaded mechanism, these catheters feature a protective shield or sleeve that the user manually slides forward to cover the sharp needle after the catheter has been successfully inserted into the patient's vein.

Blood Control  
Smooth  
Safety

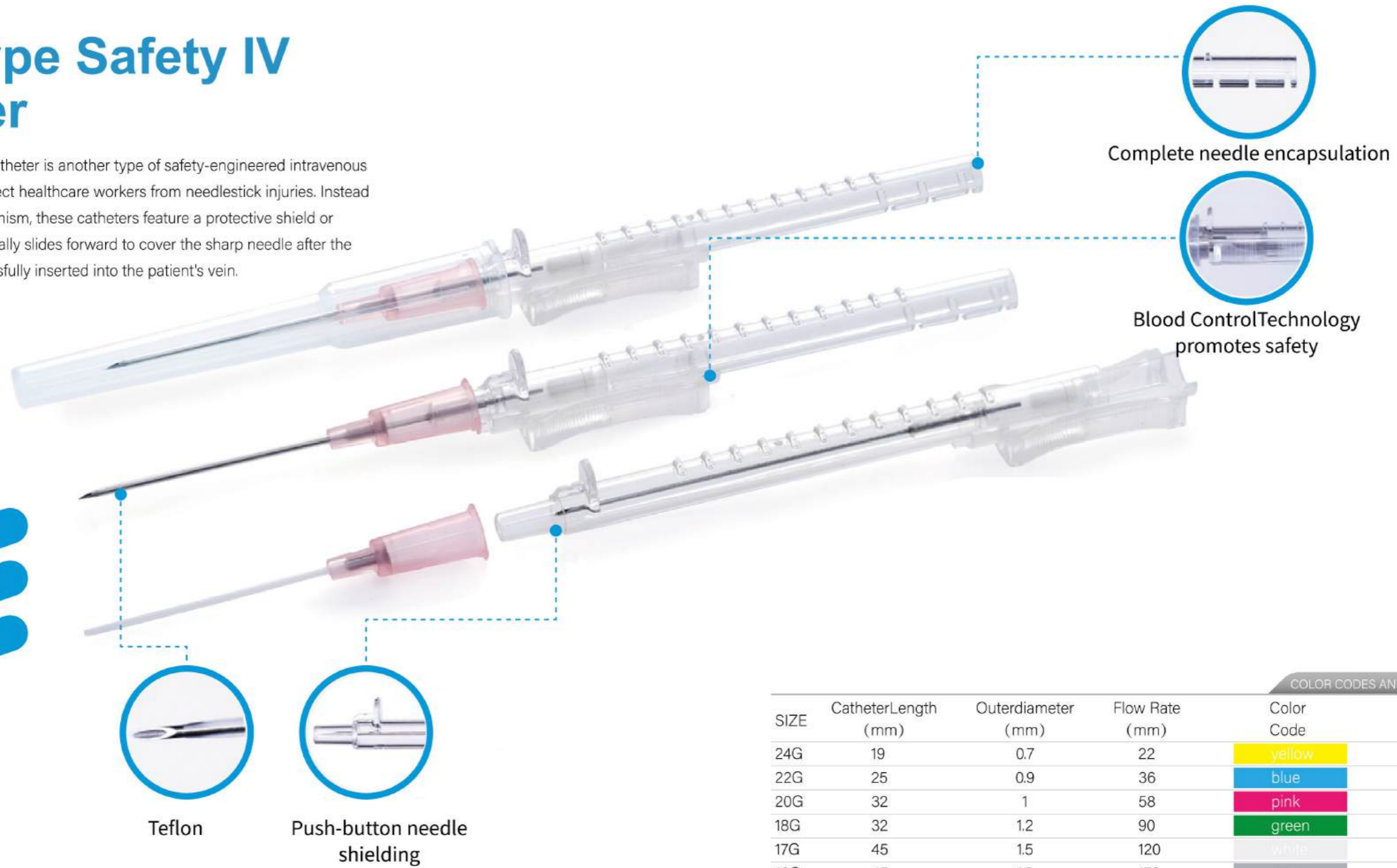

COLOR CODES AND SPECIFICATIONS					
SIZE	Catheter Length (mm)	Outer diameter (mm)	Flow Rate (mm)	Color Code	Shelf Box/ Shipping Case
24G	19	0.7	22	yellow	50/500
22G	25	0.9	36	blue	50/500
20G	32	1	58	pink	50/500
18G	32	1.2	90	green	50/500
17G	45	1.5	120	white	50/500
16G	45	1.8	172	grey	50/500
14G	45	2	208	orange	50/500

## Closed IV Catheter System

- The sharp needle features Universal Bevel geometry that allows a wider choice of insertion angles, offering greater adaptability.
- Flashback "window" for quick visualization of blood.
- PU Biomaterial Catheter for longer indwelling period

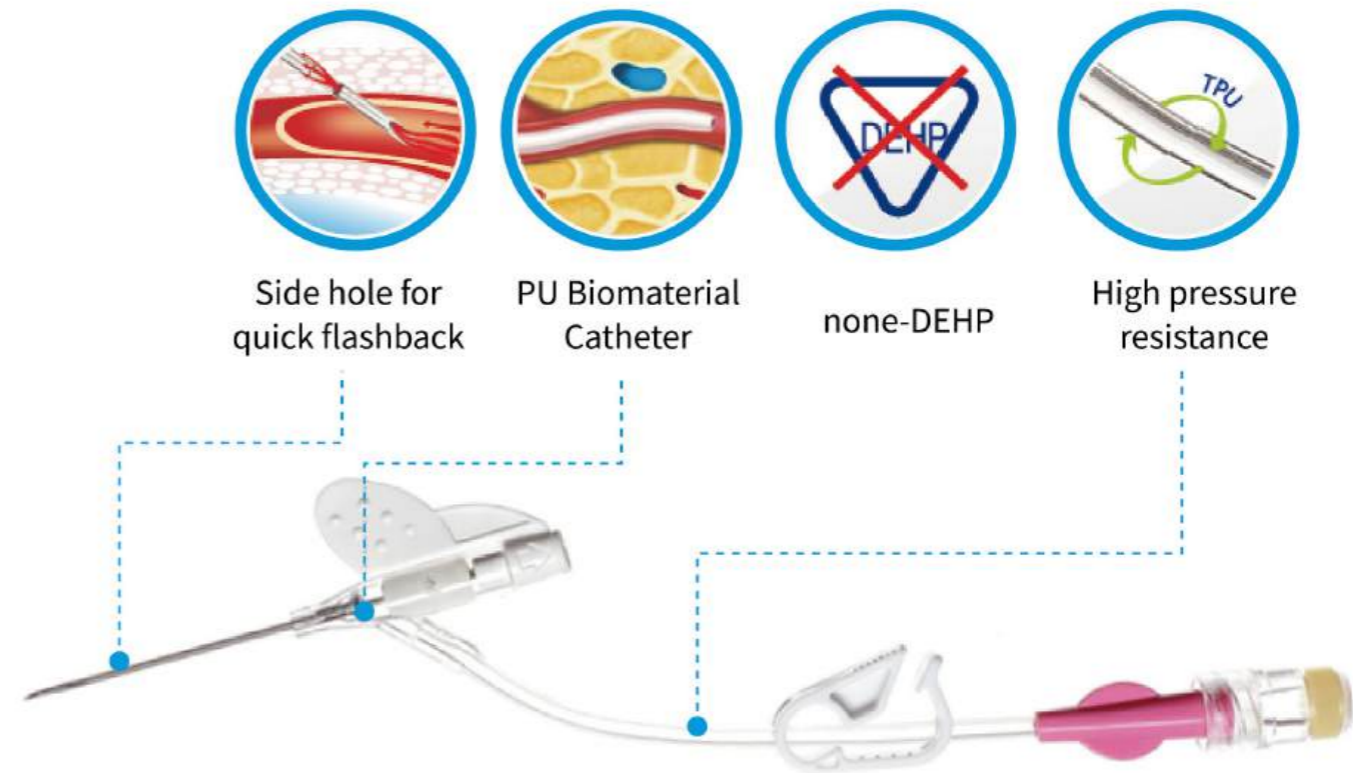

COLOR CODES AND SPECIFICATIONS

SIZE	Catheter Length (mm)	Outer diameter (mm)	Flow Rate (mm)	Color Code	Shelf Box/ Shipping Case
26G	15	0.6	12	purple	50/500
24G	19	0.7	22	yellow	50/500
22G	25	0.9	36	blue	50/500
20G	32	1	58	pink	50/500
18G	32	1.2	90	green	50/500
16G	45	1.8	172	grey	50/500

## Safety Closed LV Catheter System

- The sharp needle features Universal Bevel geometry that allows a wider choice of insertion angles, offering greater adaptability.
- Flashback "window" for quick visualization of blood.
- PU Biomaterial Catheter for longer indwelling period.
- Passive safety and blood control technology to protect against needle sticks and blood exposure

Bonded extension set reduces the risk of contamination from repeated disconnections and reconnections

Radiopaque catheter features flashback "window" for quick visualization of blood

Passive safety and blood control technology to protect against needle sticks and blood exposure

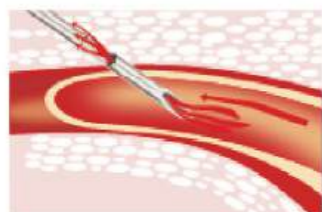

Side hole for quick flashback



PU Biomaterial Catheter



High pressure resistance

COLOR CODES AND SPECIFICATIONS

SIZE	Catheter Length (mm)	Outer diameter (mm)	Flow Rate (mm)	Color Code	Shelf Box/ Shipping Case
26G	15	0.6	12	purple	50/500
24G	19	0.7	22	yellow	50/500
22G	25	0.9	36	blue	50/500
20G	32	1	58	pink	50/500
18G	32	1.2	90	green	50/500
16G	45	1.8	172	grey	50/500

## Dental irrigation needle

Needle Type: Single Side Vent, Double Side Vent, Half Cut

18G-30G gauges and custom lengths available.

Needle size is easily identified by the color-coded hub.

Sterile, single use only

An "endo irrigation needle" is a specialized dental instrument used during endodontic (root canal) procedures. Its primary function is to deliver irrigating solutions into the root canal system.

It's intended for root canal flushing, with a rounded, sealed tip and a single side port to eliminate the risk of root canal damage.

Used in the delivery of dental compounds.

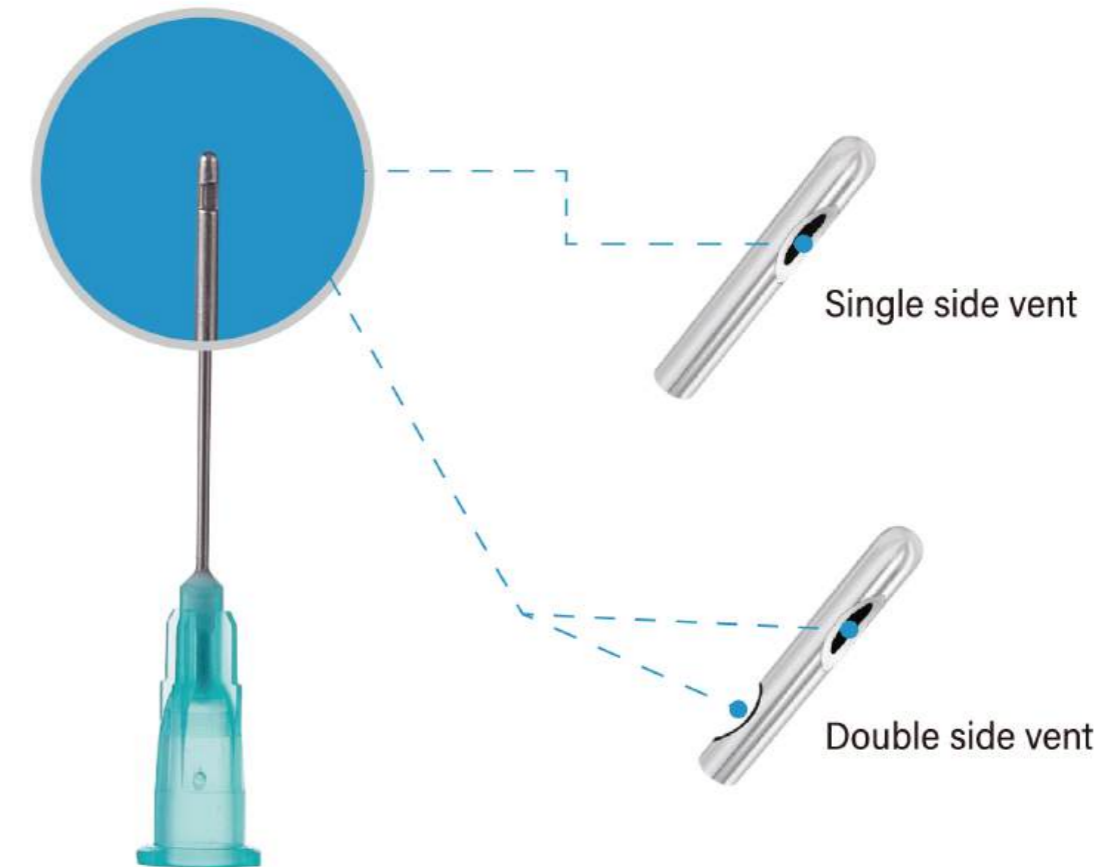

SIZE		COLOR	LENGTH					ID		BEVEL ANGLE		REF
OD (mm)	GAUGE	COLOR & CODE	20 3/4"	25 1"	32 1 1/4"	38 2 1/2"	50 2"	RW	TW	Long bevel	Short bevel	
0.3	30G	lightyellow	[lightyellow bar]							[lightyellow bar]		30G DIN30
0.4	27G	grey	[grey bar]							[grey bar]		27G DIN27
0.5	25G	orange	[orange bar]							[orange bar]		25G DIN25
0.36	24G	purple	[purple bar]							[purple bar]		24G DIN24
0.6	23G	blue	[blue bar]							[blue bar]		23G DIN23
0.7	22G	black	[black bar]							[black bar]		22G DIN22
0.8	21G	green	[green bar]							[green bar]		21G DIN21
0.9	20G	yellow	[yellow bar]							[yellow bar]		20G DIN20
1.2	18G	pink	[pink bar]							[pink bar]		18G DIN18

Remark: normal size in above table, we can also make special size as clients' request.

# PRODUCTS

WHILE ENSURING THE HIGHEST STANDARDS OF QUALITY AND SAFETY IN OUR PRODUCTS.



## Dental Needles

The dental needle is intended for the administration of dental anesthetics via dental syringes, providing a reliable and efficient injection method.

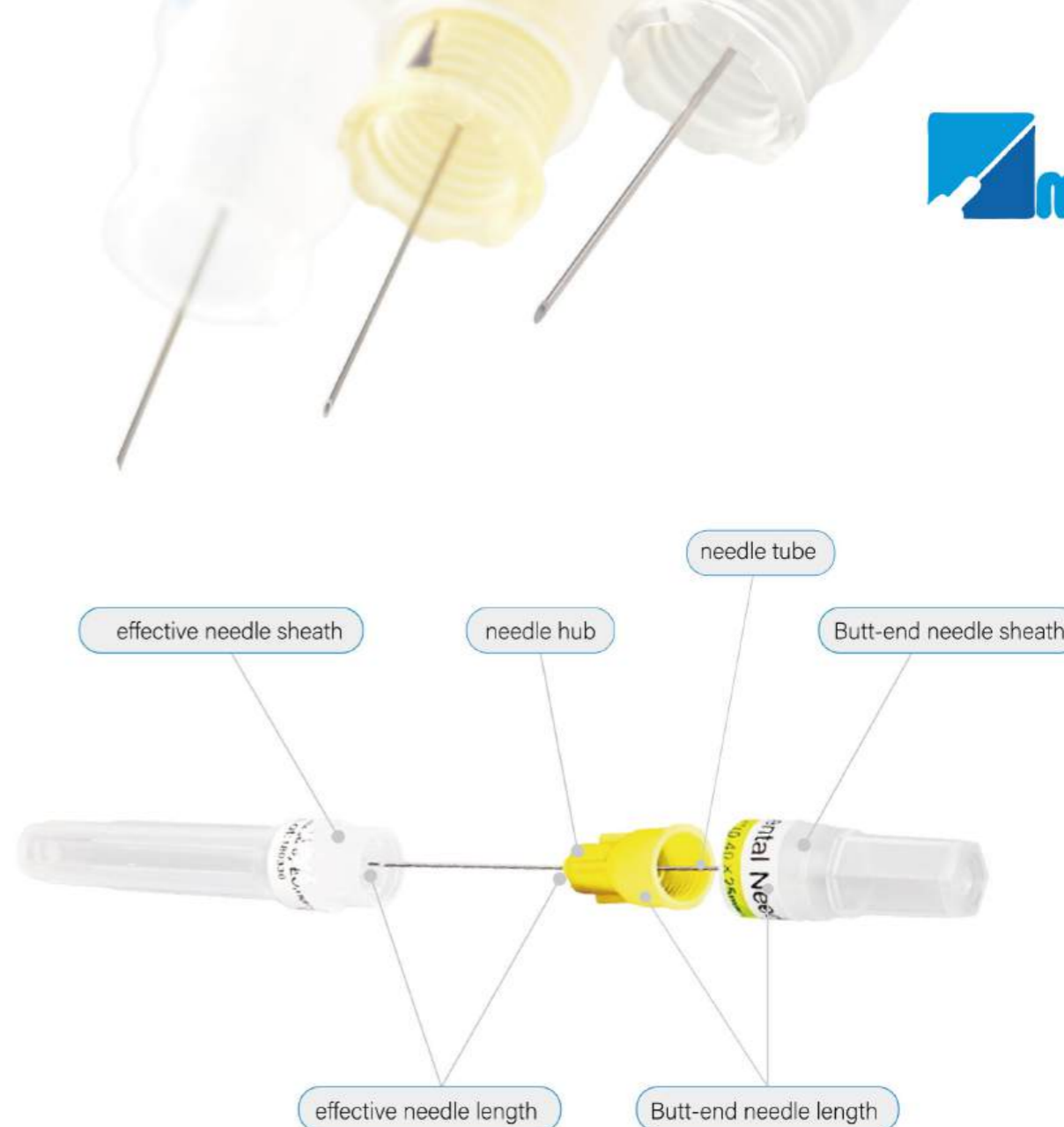

SIZE		COLOR	LENGTH					ID		BEVEL ANGLE		WORM TYPE	REF
OD (mm)	GAUGE	COLOR & CODE	13 1/2"	16 5/8"	25 1"	32 1 1/4"	38 1 1/2"	RW	TW	Long bevel	Short bevel	METRIC INCH	
0.30	30G	purple											01-401
		white											01-402
0.40	27G	blue											01-403
		yellow											01-404
0.50	25G	green											01-405
		orange											01-406

Remark: normal size in above table, we can also make special size as clients' request.

## Special Needles

Made of high quality stainless steel 304 or 316  
Producing all kinds of special needles required by our customers

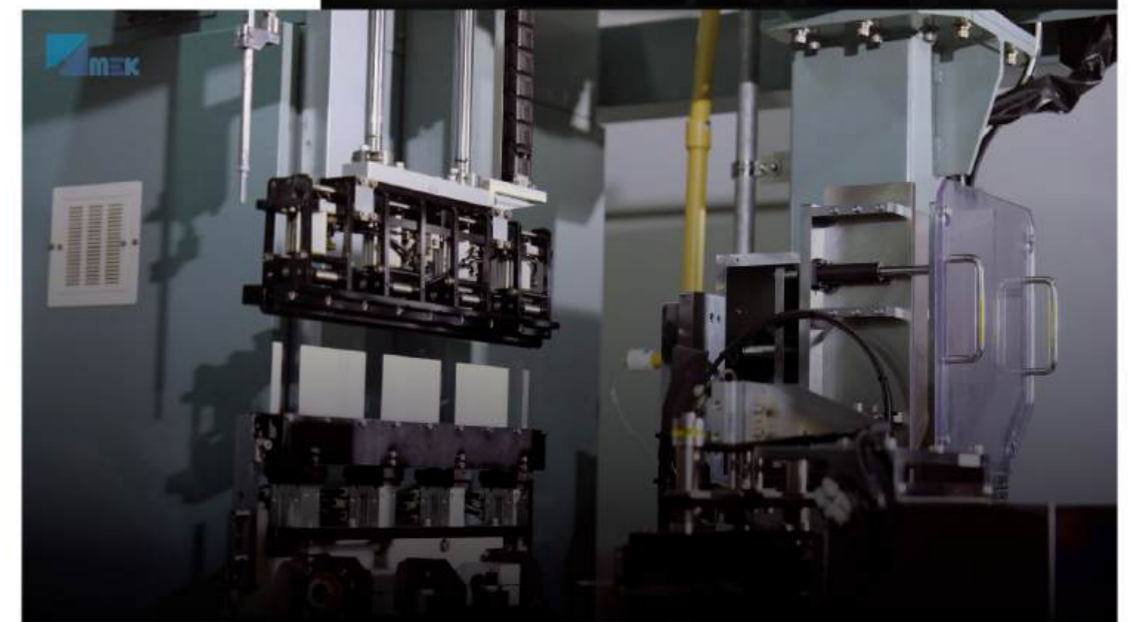
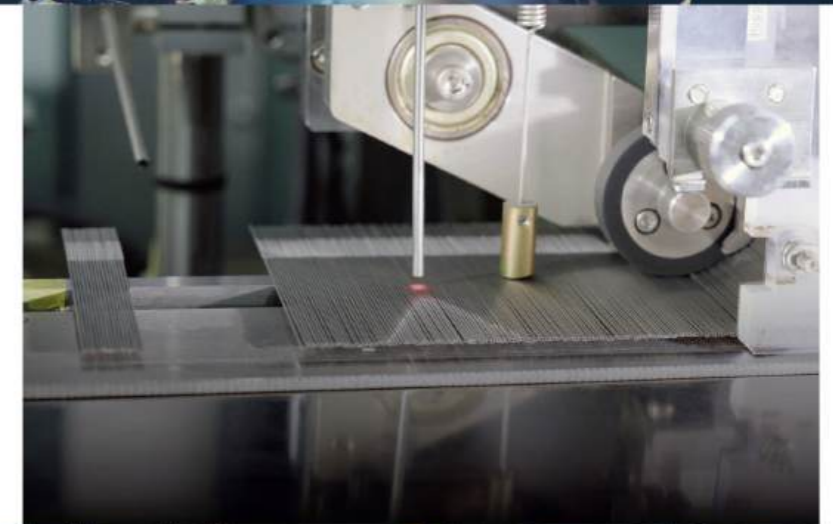

# PRODUCTS

WHILE ENSURING THE HIGHEST STANDARDS OF QUALITY AND SAFETY IN OUR PRODUCTS.

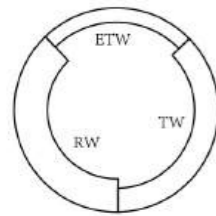

Comparison between Regular Wall, Thin wall and Extra Thin Wall



long bevel

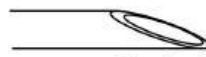

short bevel

GAUGE	Size		Outer diameter		Inner diameter		
	Nominal	Min	Max	Regular wall min	Thin wall min	Extra thin wall min	
31G	0.25	0.254	0.267	0.114	0.125		
30G	0.30	0.298	0.320	0.133	0.165		
29G	0.33	0.324	0.351	0.133	0.190		
28G	0.36	0.349	0.370	0.133	0.190		
27G	0.40	0.400	0.420	0.184	0.241		
26G	0.45	0.440	0.470	0.232	0.292		
25G	0.50	0.500	0.530	0.232	0.292		
24G	0.55	0.550	0.580	0.280	0.343		
23G	0.60	0.600	0.650	0.317	0.370	0.460	
22G	0.70	0.698	0.730	0.390	0.440	0.522	
21G	0.80	0.800	0.830	0.490	0.547	0.610	
20G	0.90	0.860	0.920	0.560	0.635	0.687	
19G	1.10	1.030	1.100	0.648	0.750	0.850	
18G	1.20	1.200	1.300	0.790	0.910	1.041	
17G	1.40	1.400	1.510	0.950	1.156	1.244	
16G	1.60	1.600	1.690	1.100	1.283	1.390	
15G	1.80	1.750	1.900	1.300	1.460	1.560	
14G	2.10	1.950	2.150	1.500	1.600	1.727	
13G	2.40	2.300	2.500	1.700	1.956		
12G	2.70	2.650	2.850	0.950	2.235		
11G	3.00	2.950	3.150	2.200	2.464		
10G	3.40	3.300	3.500	2.500	2.819		

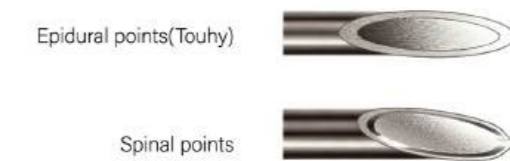
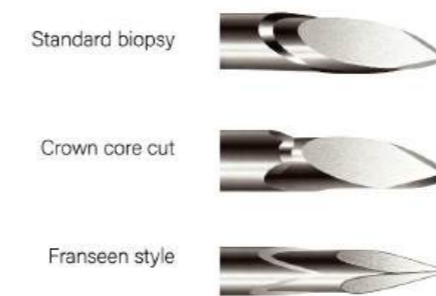

## Special Plastic Needle

All of the needle is plastic, without any metal material, special design for special use



## Polycarbonate Syringe

it is made with a crystal-clear PC polycarbonate cylinder, which offers excellent visibility and an engraved scale to facilitate accurate reading of administered doses  
1ml, 3ml, 5ml, 10ml, 20ml, and 30ml

### Luer Lock nozzle

Keep the product free from contamination, and prepare medicines in advance, saving time  
Non-slip base Anti-slip stripe at the bottom, more comfortable to use

### Color coded option

We developed a comprehensive range of Color-coded Polycarbonate Syringe, customized color as client's demand is available.



# Syringe

## Structure and Composition:

The Syringes are assembled by Barel, Plunger, Piston with/without Hypodermic Needles. All parts and material for this product meet medical requirements. Sterilized by EO.

## Intended Use:

Sterile syringes are intended to inject drug for patients, and syringes are intended for use immediately after filling and are not intended to contain the medicament for extended periods of time.

## Main Material:

PP, Isoprene Rubber, Silicone Oil



Luer slip syringe



Luer slip syringe with needle



Luer lock syringe



Luer lock syringe with needle

SIZE	LUER SLIP REF	LUER LOCK REF	ECCENTRIC REF
1ml	LS001	LL001	/
2ml	LS002	LL002	/
3ml	LS003	LL003	/
5ml	LS005	LL005	/
10ml	LS010	LL010	LSC010
20ml	LS020	LL020	LSC020

SIZE	LUER SLIP REF	LUER LOCK REF	ECCENTRIC REF
25ml	LS025	LL025	LSC025
30ml	LS030	LL030	LSC030
35ml	LS035	LL035	LSC035
50ml	LS050	LL050	LSC050
100ml	LS100	LL100	/

# 3-Parts Syringe With Safety Needle

## Structure and Composition:

The Syringe with Safety Needle is assembled by Barel, Plunger, Piston with Safety Needles. All parts and material for this product meet medical requirements. Sterilized by EO.

## Intended Use:

Sterile syringes are intended to inject drug for patients, and syringes are intended for use immediately after filling and are not intended to contain the medicament for extended periods of time. Features a pre-attached, innovative safety mechanism that covers the needle immediately after use, minimizing the risk of accidental needlestick injuries.

## Main Material:

PP, Isoprene Rubber, Silicone Oil, SUS304



SIZE	SLIP REF	LOCK REF	ECCENTRIC REF
1ml	SLS001	SLL001	/
2ml	SLS002	SLL002	/
3ml	SLS003	SLL003	/
5ml	SLS005	SLL005	/
10ml	SLS010	SLL010	SLSC010
20ml	SLS020	SLL020	SLSC020

SIZE	SLIP REF	LOCK REF	ECCENTRIC REF
25ml	SLS025	SLL025	SLSC025
30ml	SLS030	SLL030	SLSC030
35ml	SLS035	SLL035	SLSC035
50ml	SLS050	SLL050	SLSC050
100ml	SLS100	SLL100	/

## Syringes for Pre-Filled Use

### Structure and Composition:

The Syringes are assembled by barrel, plunger, piston and syringe cap. All parts and material for this product meet medical requirements.

### Main Material:

PP, BIR, Silicone Oil (We can also develop this type of product based on other customized material.)

### Refer Code:

3ml	PFSR1031
5ml	PFSR1051
10ml	PFSR1101
20ml	PFSR1201



**Specification**

20ml

10ml

5ml

3ml



## PRE-FILLED FLUSH SYRINGES IMPROVE CARE EFFICIENCY

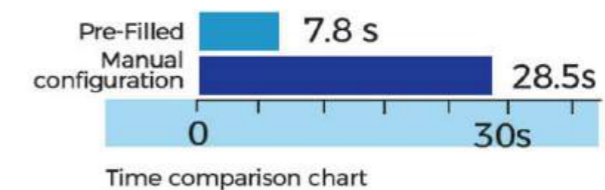
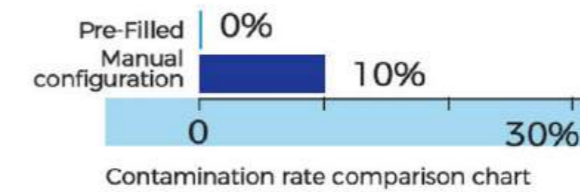

## Oral Syringe

Oral syringes are widely used to give liquid medications to infants, children, and adults who have difficulty swallowing pills.

They are particularly helpful for administering small or precise doses.

Available size: 0.5 mL, 1 mL, 3 mL, 5 mL, 10 mL, 20 mL and 60mL

Easy-to-read scale markings for accuracy, and the scale markings can be customized

This product is available Sterile and Non-Sterile.

Plunger and barrel color can be customized

Both clear type and amber type are available

Amber barrel design for protect light-sensitive drug



Clear type

Amber type

### Detail

### Product description



#### Cap

Secure, clear, rounded tip cap is easy to grasp and prevents leaking and loss of syringe contents



#### Clear scale

Clear scale can better accurately grasp the dosage



#### Non-slip

The design of anti-slip strips can make it safer and more reliable during use



	Type	Volume	product code
Oral syringe	Clear type	1ml	OS-01
		3ml	OS-03
		5ml	OS-05
		10ml	OS-10
		20ml	OS-20
		60ml	OS-60
	Amber type	1ml	OSA-01
		3ml	OSA-03
		5ml	OSA-05
		10ml	OSA-10
		20ml	OSA-20
		60ml	OSA-60
		100ml	OSA-100

## Enteral Syringe

Enteral syringes are specifically designed for the administration of enteral nutrition (tube feeding), medications, and fluids directly into the gastrointestinal tract through an enteral feeding tube.

The ENFit connector is a standardized connection system designed to prevent misconnections between enteral feeding systems and other medical tubing, such as intravenous (IV) lines. This significantly reduces the risk of potentially dangerous administration errors.



Isoprene rubberpiston



Silicone gasket

		Type	Volume	product code
ENFit Enteral syringe	Piston type		1ml	OS-01
			3ml	OS-03
			5ml	OS-05
			10ml	OS-10
			20ml	OS-20
			60ml	OS-60
	O-ring type		1ml	OSA-01
			3ml	OSA-03
			5ml	OSA-05
			10ml	OSA-10
			20ml	OSA-20
			60ml	OSA-60
			100ml	OSA-100

## COC (Cyclic Olefin Copolymer) syringes

OC (Cyclic Olefin Copolymer) syringes are primarily intended for the safe and stable containment and delivery of a wide range of injectable pharmaceutical drug products, especially those that are sensitive or high-value.

Made of high-performance Cyclic Olefin Copolymer, ensures the integrity and safety of sensitive drug formulations with excellent chemical resistance and minimal extractables, offering superior strength and clarity for various pharmaceutical uses.

### Applications

- Medical and healthcare
- Laboratory and research
- Cosmetics and beauty
- Veterinary medicine

