

DC small DC20KW wall mounted charging station

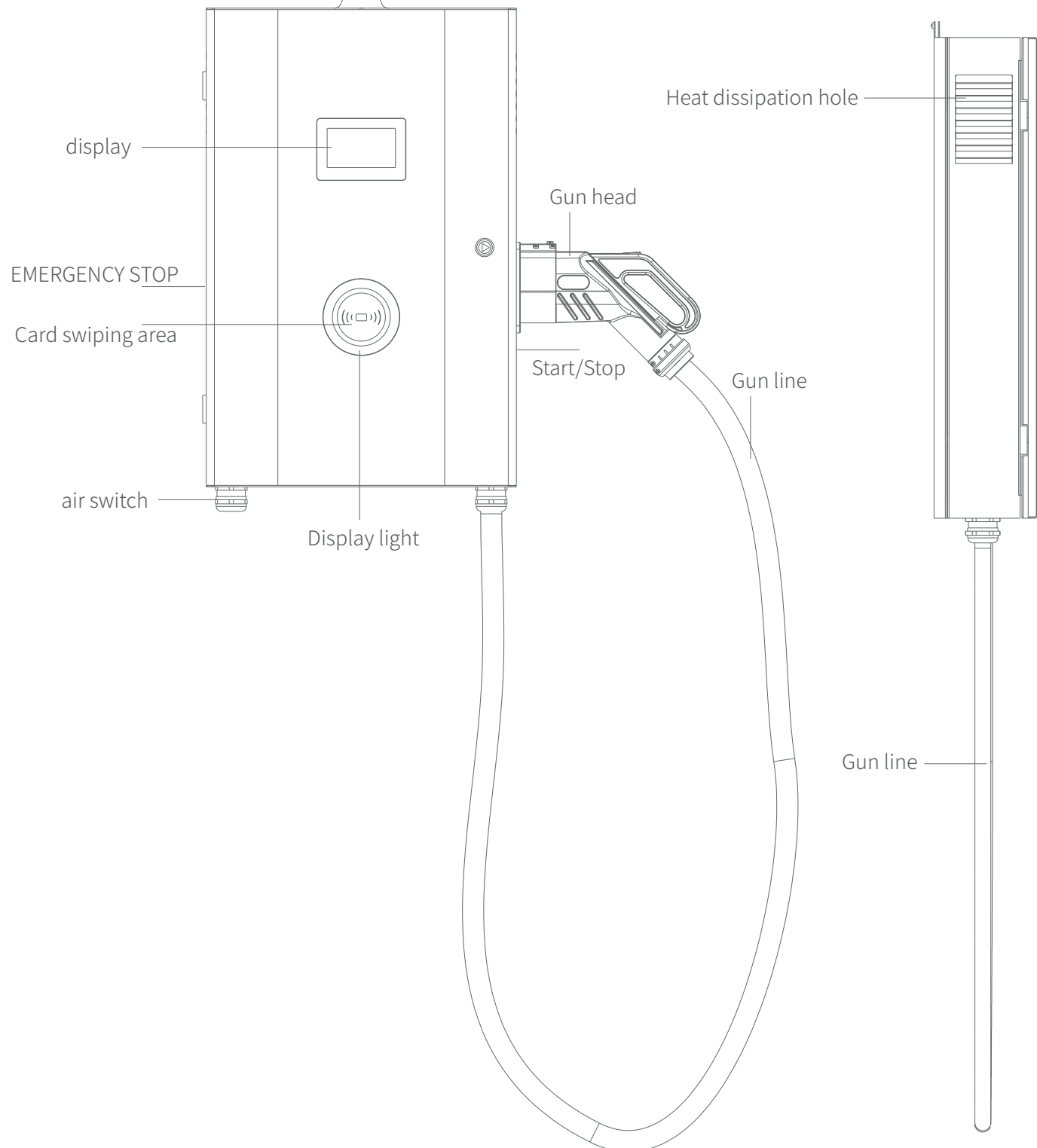

Parameter/specification sheet

Rated input voltage	380Vac ± 20%(three-phase)
Rated output power	20kW
Maximum input current	50A(Three phase)
Output constant power range	1~100A
Voltage stabilization accuracy	≤+0.5%
Output voltage	Within the range of 200-1000V
Charging method	Swipe card charging, button charging
Protection function	Overcurrent, Overvoltage, Undervoltage, Leakage Protection
protection grade	IP54
Charging interface	CCS2
Exposed gun line length	Standard configuration of 3 meters (customizable)
work environment	Altitude:< 2000m, temperature:- 20 °C~65 °C, derating work above 50 °C
External dimensions	439*144*678(mm)
Number of charging guns	ONE
human-computer interaction	4.3-inch screen
operation temperature	-25 °C to 40 °C
humidity	5% -95% RH (no condensation)
Design standards	IEC-61851.IS0-15118



usage method

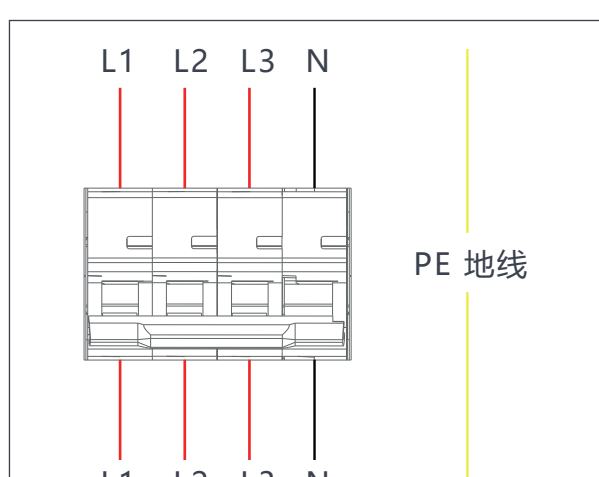

1. Connect as shown in the diagram, L1 live wire, L2 live wire, L3 live wire, N neutral wire, PE wire

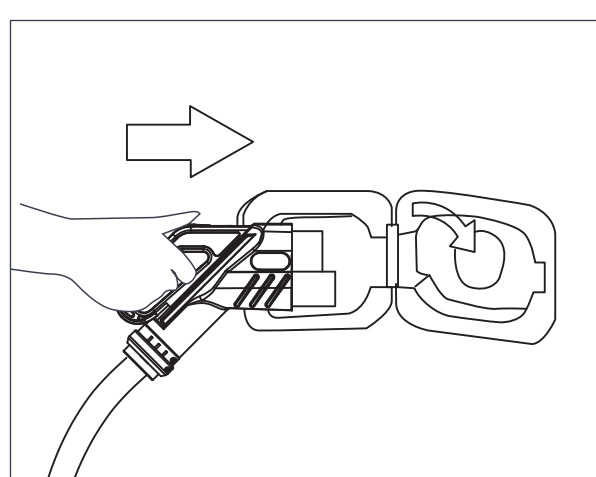

2. Insert the charging gun head into the vehicle body

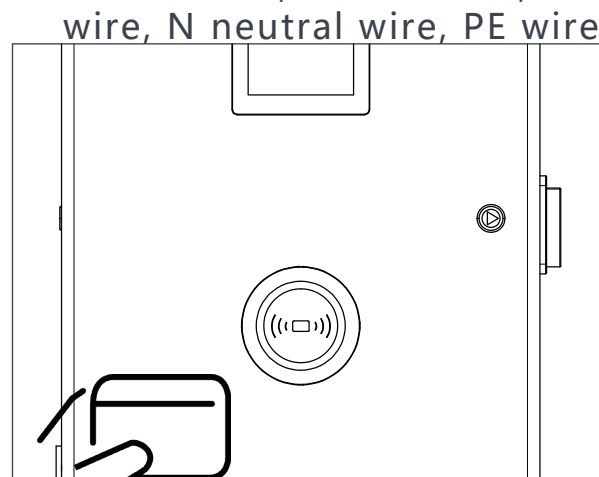

3. Card swiping for charging

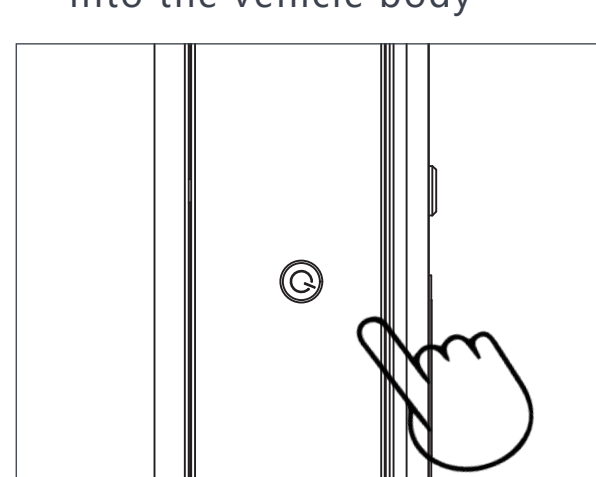

4. After charging is complete, close the button

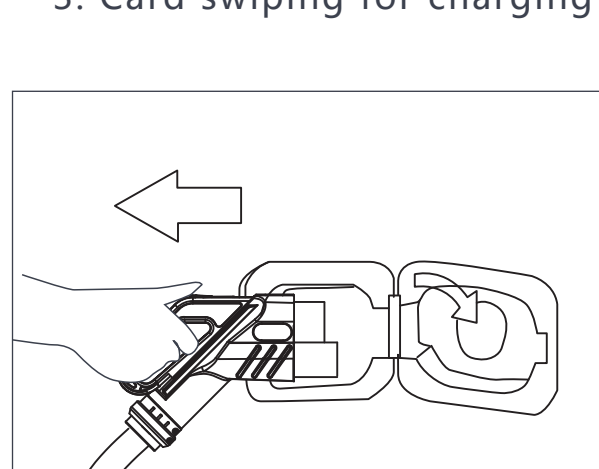

5. Unplug the charging plug

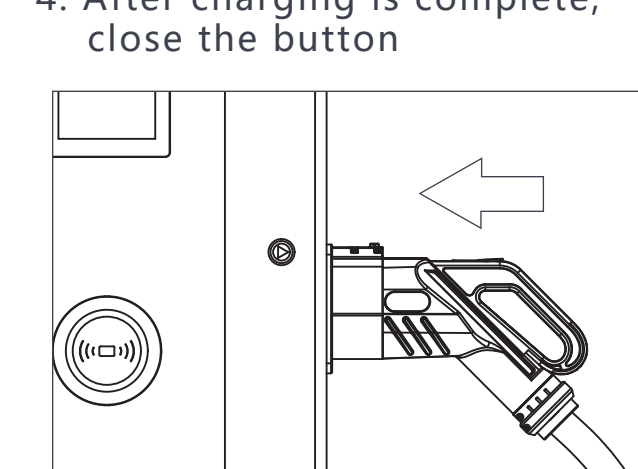

6. Insert the charging gun head back into the charging station

Box specifications/weight, quantity, size

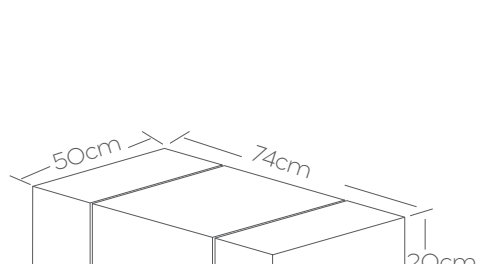

Length 50, Width 20, Height 74(cm)
weight: ≈24kg

Product packaging

