



# 02

# LIGHTING SOURCE

Classical product - PAR56

Epoxy Resin LED panel

# P1001 and P1002 Contrast



IP68



P1001 big lens



P1002 small lens

## Features

- \* Material : ABS+PC
- \* Structure : Double protection
- \* Craft : Ultrasonic welding + epoxy resin, IP68
- \* LED : high quality SMD2835 / SMD5054
- \* Big lens and small lens



ABS + PC body

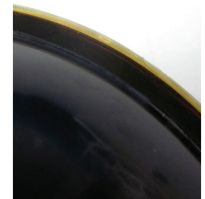

Epoxy Resin Sealing

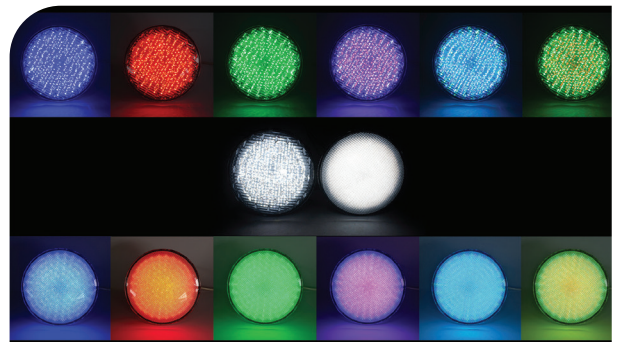
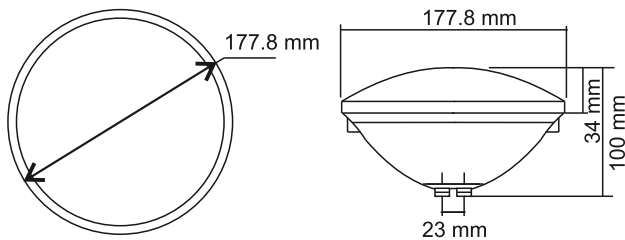

## Product Parameters

Model	P1001 / P1002			
Applicable Scene	Concrete pool, Fiberglass Pool, Vinyl liner pool			
Body Material	ABS+PC			
Beam Angle	120°			
Voltage	12V (AC)			
Power	12W	18W	25W	35W
LED Type	SMD2835	SMD2835	SMD2835	SMD5054
Led Quantity	180pcs	252pcs	351pcs	150pcs
Lumen(6400K)	1200lm	1800lm	2500lm	3200lm
Lumen(3000K)	1100lm	1700lm	2400lm	3100lm
Lumen(RGB)	600lm	900lm	1200lm	1600lm
Control Way	ON/OFF control , Remote control , Wifi control			

# Epoxy Resin LED panel



IP68



DW (warm white & cool white)

3

Different Colors

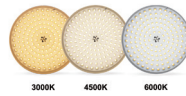

5

Brightness Level

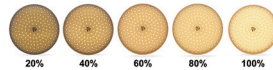

- \* AC control mode
- \* SMD5050 LED chip, color mixing perfect performance
- \* Two white colors in one light, with R6 remote you can select preferable color and adjust the brightness as well
- \* Standard Par56 size, alternative par56 bulb, with elegant frame it can be wall mounting light.
- \* Three years guarantee, 50,000 hours spanlife.

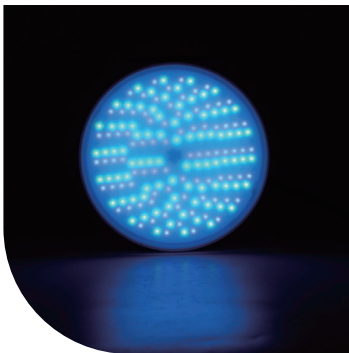

Milky white



- \* Soft lighting
- \* Fantastic colors to make your pool more attractive
- \* No Air in the lamp, IP68.

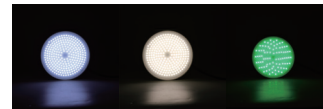

WW WHT RGB



3000K



- \* Material : ABS+PC
- \* Structure : Double protection
- \* Craft : Filled with epoxy resin, IP68
- \* LED : high quality SMD2835 / SMD5050/ SMD5054



6400K



- \* Material : ABS+PC
- \* Structure : Double protection
- \* Craft : Filled with epoxy resin, IP68
- \* LED : high quality SMD2835 / SMD5050/ SMD5054

# Epoxy Resin LED panel



IP68

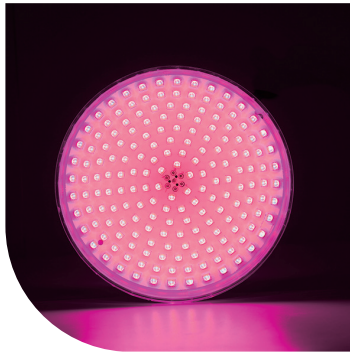

RGBW



- \* Material : ABS+PC
- \* Structure : Double protection
- \* Craft : Filled with epoxy resin, IP68
- \* LED : high quality SMD2835 / SMD5050/ SMD5054

## Accessories



## Size

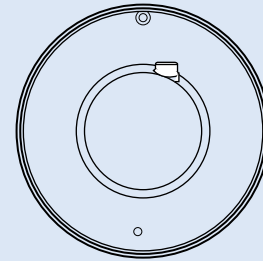
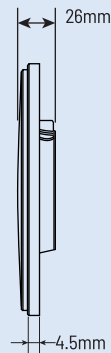
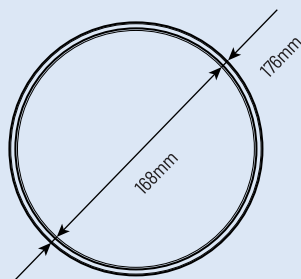

Model	Sxxx Panel							
Applicable Scene	Concrete pool, Fiberglass Pool, Vinyl liner pool							
Body Material	ABS+PC							
Beam Angle	120°							
Voltage	12V (AC/DC)							
Power	18W	25W	32W	40W	18W	25W	32W	40W
LED Type	SMD2835	SMD2835	SMD2835	SMD2835	SMD5054	SMD5054	SMD5054	SMD5054
Led Quantity	252pcs	351pcs	441pcs	513pcs	90pcs	120pcs	150pcs	180pcs
Lumen(6400K)	1800lm	2500lm	3200lm	4000lm	/	/	/	/
Lumen(DW)	/	/	/	/	1900lm	2600lm	3300lm	4100lm
Lumen(3000K)	1750lm	2400lm	3100lm	3800lm	/	/	/	/
Lumen(RGB)	900lm	1200lm	1600lm	2000lm	900lm	1200lm	1600lm	2000lm
Lumen(RGBW)	/	/	/	/	1000lm	1300lm	1700lm	2100lm
Control Way	ON/OFF control , Remote control , Wifi control							

# Installed

Such as Astral , Hayward .....



IP68



## How to replace PAR56 ( A )

Remove the lamp holder, put the epoxy LED panel in the frame.  
Fix the screws and adjust the bolts to lock the panel.



## How to replace PAR56 ( B ) — Hayward Niche



### Accessories

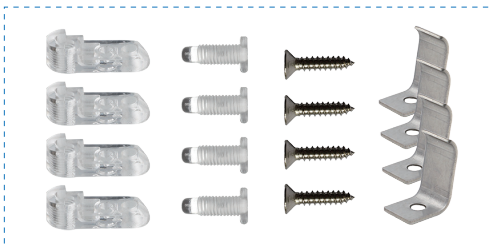

Remove the lamp holder, put the epoxy LED panel in the frame.  
Fix the screws and SS clips, adjust the bolts to lock the panel.

## How to replace PAR56 ( C ) — Astral Niche

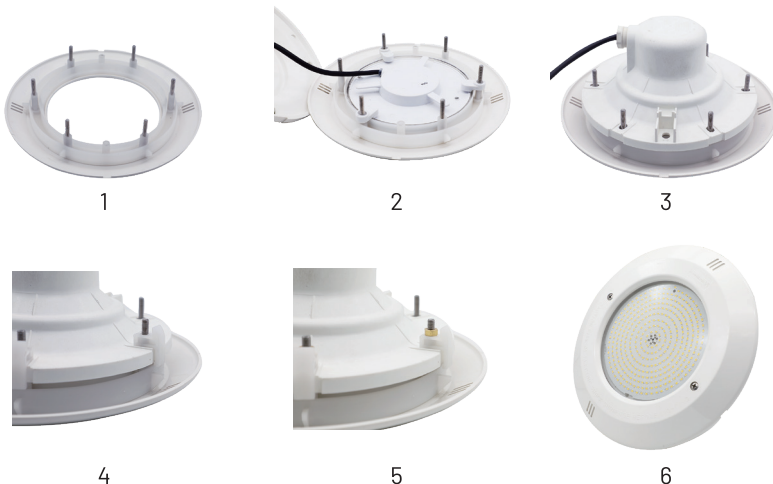

Put the epoxy LED panel in the frame,  
add the 3pcs ABS clips..

Put the lamp holder and Astral clips  
on the panel

Tighten the clips with 3pcs copper screws

### Accessories

