



喜阳阳机械

新乡市喜阳阳筛分机械制造有限公司

Xinxiang Xiyangyang Machinery Manufacturing Co.,Ltd.

钢丝螺套

让天下没有滑丝的螺纹孔

Wire thread insert-Make the world without threaded holes with slippery threads

钢丝螺套就选喜阳阳

Choose Xiyang Yang for the steel wire screw sleeve

品质改变世界，服务决定未来

Quality changes the world, service determines the future



座机/Tel:0373-3875118

邮箱/E-mail:xiyangyangjixie@163.com

内贸/Website:www.xyyjx.com

外贸/Online shop:www.rmbxxy.com

地址:中国河南省新乡市中德产业园43号

Add:No.43 Xinxiang Sino-German Industrial Park,

kelong Avenue,Hongqi District,Xinxiang City,Henan Province

Mike li

WhatsApp 联系人



李阳 13409215871
河南新乡





新乡市喜阳筛分机械制造有限公司
Xinxiang Xiyang Machinery Manufacturing Co., Ltd.

喜阳机械

公司简介 company profile

新乡市喜阳筛分机械制造有限公司是以紧固件产品和军工产品为主的高新企业，拥有30多年的生产设计经验，我司已通过IATF16949质量管理体系，ISO9001质量管理体系认证，ISO14001环境管理体系认证，ISO45001中国职业健康安全管理体系认证，GJB9001C武器装备质量管理体系认证等资质，并且申请20种专利，可按照标准和图纸加工产品，支持OEM&ODM。

我司生产的产品已广泛用于航空，船舶，高铁，及新能源汽车，光伏发电等领域。喜阳产品已经出口美国、俄罗斯、巴西、马来西亚、韩国、土耳其等国家。

Xinxiang Xiyang Screening Machinery Manufacturing Co., Ltd. is a high-tech enterprise mainly engaged in fastener products and military products, with more than 30 years of production and design experience. Our company has obtained qualifications such as IATF16949 quality management system, ISO9001 quality management system certification, ISO14001 environmental management system certification, ISO45001 China Occupational Health and Safety Management System certification, GJB9001C Weapon Equipment Quality Management System certification, and has applied for 20 patents. Can process products according to standards and drawings, supporting OEM&ODM.

Our products have been widely used in aviation, shipbuilding, high-speed rail, new energy vehicles, photovoltaic power generation and other fields. Xiyang products have been exported to the United States, Russia, Brazil, Malaysia, South Korea, Türkiye and other countries.



资质证书 qualification certificate

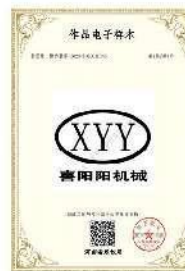

C 目录 atalogue

喜阳阳钢丝螺套简介-----	01
Introduction to Xiyang Yang Steel Wire Screw Insert (有尾) 钢丝螺套-----	02
(with tail) steel wire screw sleeve	
无尾钢丝螺套-----	03
Tailless steel wire screw sleeve	
插销螺套 (轻型) -----	04
Insert screw sleeve (lightweight)	
插销螺套 (重型) -----	05
Insert screw sleeve (heavy-duty)	
美制插销螺套-----	06
American bolt insert	
自攻螺套-----	07
Self tapping screw sleeve	
302H型+307孔型自攻螺套-----	08
302H type+307 type	
303槽型+302槽型内六角自攻螺套-----	09
303 type+302 type	
307+308孔型内六角自攻螺套-----	10
307 type+308 type	
347+347孔型自攻螺套-----	11
347 type+34 type	
花齿螺母-----	12
Serrated nut	
火花塞自攻螺套-----	13
Spark plug self tapping screw sleeve	
内外牙一字槽-----	14
Internal and external teeth groove	
308+308E孔型-----	15
308 type+308E type	

喜阳阳钢丝螺套的简介

Hiyangyang wire screw sleeve introduction



产品名称 Product name
国军标钢丝螺套
National military standard
steel wire screw sleeve

产品优势 Product
advantages
精度高 耐腐蚀性强
显著提高螺孔强度
High precision, strong
corrosion resistance
Significantly improve
the strength of screw holes

钢丝螺套是一种新型的内螺纹紧固件。它是用高强度、高精度、表面光洁的冷轧菱形不锈钢丝精确加工形成的螺旋线圈，为高精度内、外螺纹同心体。钢丝螺套装好后形成一个符合国际标准的高精度内螺纹，其各项性能均优于直接攻好丝所形成的内螺纹。

Wire screw sleeve is a new type of fastener with internal thread. It is made of high strength, high precision. The spiral coil formed by the cold-rolled diamond stainless steel wire with smooth surface is precisely machined for high precision Concentric body with internal and external threads. The wire screw package forms a high precision that meets international standards. The internal thread has various properties better than the internal thread formed by direct tapping.



(有尾) 钢丝螺套 With tail wire screw sleeve

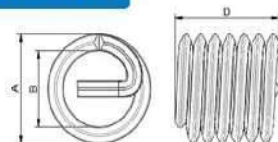

特点:

用高强度、高精度、表面光洁的冷轧菱形不锈钢丝精确加工而成的一种弹簧状内外螺纹同心体，主要用于增强和保护低强度材质的内螺纹，提高连接强度和可靠性。

Features:

With high strength, high precision, surface smooth cold rolled diamond shaped stainless steel wire. A spring-like concentric body with internal and external threads produced and used mainly for reinforcing and Protect internal threads in low-strength materials for increased connection strength and reliability.

材质：不锈钢、铜合金、高温合金

Material: Stainless steel, copper alloy, superalloy

Technical Data
技术参数

规格 Specification	螺套圈数 Number of screw rings					安装前外径L ₂	钻头直径L ₃
	1D	1.5D	2D	2.5D	3D		
St1.6×0.35	3.1	4.5	6.2			2.1-2.3	1.6
St2×0.4	3.2	5.3	7.4	9.5	11.6	2.5-2.8	2.1
St2.5×0.45	3.6	5.9	8.2	10.5	12.8	3.25-3.5	2.6
St3×0.5	4.2	6.8	9.4	12	14.6	3.7-4.0	3.1
St4×0.7	4	6.6	9.1	11.7	14.2	5.0-5.3	4.2
St5×0.8	4.4	7.1	9.9	12.6	15.3	6.3-6.6	5.2
St6×1.0	4.3	6.9	9.6	12.2	14.9	7.5-7.9	6.3
St8×1.25	4.8	7.7	10.6	13.5	16.5	9.8-10.1	8.3
St10×1.5	5	8.1	11.2	14.2	17.3	12-12.5	10.4
St12×1.75	5.3	8.4	11.6	14.8	18	14.3-14.8	12.4
St14×2	5.4	8.7	11.9	15.2	18.4	16.7-17.2	14.5
St16×2	6.3	10	13.7	17.5	21.2	18.8-19.4	16.5



无尾钢丝螺套 No tail screw sleeve



特点:

解决了传统螺套安装速度慢的问题，也避免了传统螺套安装过程中安装柄不易控制，造成凸起、易断的情况，螺钉不易装入，影响设备的正常运行，提升了生产效率，减少机械设备的故障率。

Features:

Solve the problem of slow installation of traditional screw sleeve, but also avoid the traditional screw sleeve installation. During the process, the mounting handle is not easy to control, resulting in protrusion and easy to break, and the screw is not easy to load. It affects the normal operation of the equipment, improves the production efficiency, and reduces the failure rate of mechanical equipment.

材质：不锈钢、铜合金、高温合金

Material: Stainless steel, copper alloy, superalloy

Technical Data
技术参数

规格 Specification	螺套圈数					安装前外径L ₂	钻头直径L ₃
	1D	1.5D	2D	2.5D	3D		
M2.5*0.45	3.6	5.9	8.2	10.5	12.8	3.2-3.5	2.6
M3*0.5	4.2	6.8	9.4	12	14.6	3.7-4.0	3.1
M4*0.7	4	6.6	9.1	11.7	14.2	5.0-5.3	4.2
M5*0.8	4.4	7.1	9.9	12.6	15.3	6.3-6.6	5.2
M6*1	4.3	6.9	9.6	12.2	14.9	7.5-7.9	6.3
M8*1.25	4.8	7.7	10.6	13.5	16.5	9.8-10.1	8.3
M10*1.5	5	8.1	11.2	14.2	17.3	12-12.5	10.4
M12.1.75	5.3	8.4	11.6	14.8	18	14.3-14.8	12.4



插销螺套 (轻型) Bolt bolt sleeve (light)

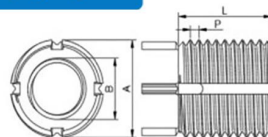

特点:

插销螺套装入攻丝后的底孔中, 再把四根插销压入, 起到强劲的紧固作用, 产品主要用于对螺纹强度要求较高的产品上。

Features:

Bolt screw set into the bottom hole after tapping, and then press the four bolts in. It plays a strong fastening role, the product is mainly used for thread strength Seek higher products on.

Technical Data 技术参数

规格 Specification	内径B	内牙距P	长度L	外径A	外牙距P	安装底孔 L2	钻孔深度 L3
M2*0.4-L3-M4*0.7	M2	0.4	3	M4	0.7	43.4	4
M2.5*0.45-L3.8-M4.5*0.75	M2	0.45	3.8	M4.5	0.75	3.9	5
M3*0.5-L4.25-M5*0.8	M3	0.5	4.25	M5	0.8	4.4	5.5
M4*0.7-L5.25-M6*0.75	M4	0.7	5.25	M6	0.75	5.5	6.5
M5*0.8-L8-M8*1.25	M5	0.8	8	M8	1.25	6.9	9.5
M6*1.0-L10-M10*1.25	M6	1.0	10	M10	1.25	8.9	11.5
M8*1.25-L12-M12*1.25	M8	1.25	12	M12	1.25	10.9	13.5
M10*1.5-L14-M14*1.5	M10	0.5	14	M14	1.5	12.8	15.5
M10*1.5-L14-M14*1.6	M10	1.25	14	M14	1.5	12.8	15.5

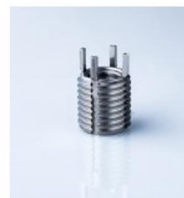

插销螺套 (重型) Bolt bolt sleeve (heavy)

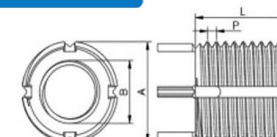

特点:

插销螺套装入攻丝后的底孔中, 再把四根插销压入, 起到强劲的紧固作用, 产品主要用于对螺纹强度要求较高的产品上。

Features:

Bolt screw set into the bottom hole after tapping, and then press the four bolts in. It plays a strong fastening role, the product is mainly used for thread strength Seek higher products on.

Technical Data 技术参数

规格 Specification	内径B	内牙距P	长度L	外径A	外牙距P	安装底孔 L2	钻孔深度 L3
M2.5*0.45-L6-M5*1.6	M2.5	0.45	6	5	1.6	3.5-3.8	8
M3*0.5-L6-M5.5*1.6	M3.0	0.5	6	5.5	1.6	4.1-4.3	8
M3.5*0.6-L8-M6.5*1.6	M3.5	0.6	8	6.5	1.6	4.6-4.8	10
M4*0.7-L10-M7*2.5	M4	0.7	10	7	2.5	5.1-5.3	13
M5*0.8-L12-M9*3.0	M5	0.8	12	9	3	6.6-6.9	15
M6*1.0-L14-M10*4.0	M6	1.0	14	10	4	7.6-7.9	17
M8*1.25-L20-M13*4.0	M8	1.25	20	13	4	9.9-10.3	23
M10*1.5-L23-M16*5.0	M10	1.5	23	16	5	12.4-12.8	26
M12*1.75-L26-M19*5.0	M12	1.75	26	19	5	15.4-15.8	30
M14*2.0-L26-M22*5.0	M14	2	26	22	5	18.6-18.8	30



美制插销螺套 American bolt bolt sleeve

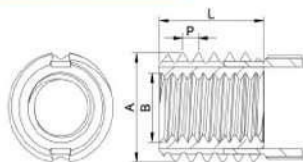

特点:

广泛用于工业、家具装饰等行业使用范围广泛，使其受各行业一致欢迎。具有良好的耐腐蚀性抗氧化耐热性、强度高、韧性高的特点。

Features:

Widely used in industry, furniture decoration and other industries wide range of use, Make it popular in all industries. It has good corrosion resistance, oxidation resistance and heat resistance Characteristics of high strength, high toughness.

Technical Data 技术参数

规格 Specification	内径B	内牙距P	长度L	外径A	外牙距P	安装底孔L2	钻孔深度L3
10-24-L7.87-5/16-18	10-24	1.058	7.87	5/16-18	1.411	6.8	10
10-32-L7.87-5/16-18	10-32	0.794	7.87	5/16-18	1.411	6.8	10
1/4 20-L9.4 3/8 16	1/4 20	1.27	9.4	3/8-16	1.588	8.1	12
1/4-28-L9.4-3/8-16	1/4-28	0.907	9.4	3/8-16	1.588	8.1	12
5/16-18-L10.9-7/16-14	5/16-18	1.411	10.9	7/16-14	1.814	9.7	14
5/16-24-L10.9-7/16-14	5/16-24	1.058	10.9	7/16-14	1.814	9.7	14
3/8-16-L12.7-1/2-13	3/8-16	1.058	12.7	1/2-13	1.954	11.2	15
3/8-24-L12.7-1/2-13	3/8-24	1.058	12.7	1/2-13	1.954	11.2	15



自攻螺套 Self-tapping screw sleeve

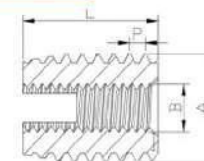

特点:

自攻螺套内外都有牙纹，嵌入塑料、铝合铸铁、铜等较软材料内可以形成较高强度的内螺纹孔，302槽型使用最为广泛，属于槽型切削类，稍微有一点螺纹自锁的特性。

Features:

Both inside and outside the self-tapping screw sleeve have teeth, embedded in plastic, aluminum cast iron, copper and other soft materials can form higherThe strength of the internal thread hole, 302 groove type is the most widely used, belongs to the groove cutting class, and has a little thread self-locking The characteristics of...

Technical Data 技术参数

规格 Specification	内径B	内牙距P	长度L	外径A	外牙距P	安装底孔L2	钻孔深度L3
M2*0.4-L6-M4.5*0.5	M2	0.4	L6	M4.5	0.5	4.2-4.3	8
M2.5*0.45-L6-M4.5*0.5	M2.5	0.45	L6	M4.5	0.5	4.2-4.3	8
M3*0.5-L6-M5*0.5	M3	0.5	L6	M5	0.5	4.7-4.8	8
M3.5*0.6-L8-M6*0.75	M3.5	0.6	L8	M6	0.75	5.6-5.7	10
M4*0.7-L8-M6.5*0.75	M4	0.7	L8	M6.5	0.75	6.1-6.2	10
M5*0.8-L10-M8*1.0	M5	0.8	L10	M8	1	7.5-7.6	13
M6*1.0-L12-M9*1.0	M6	1	L12	M9	1	8.5-8.6	15
M6*1.0-L14-M10*1.5	M6	1	L14	M10	1.5	9.2-9.4	17
M8*1.25-L15-M12*1.5	M8	1.25	L15	M12	1.5	11.2-11.4	18



302H型自攻螺套

Type 302H self-tapping screw sleeve

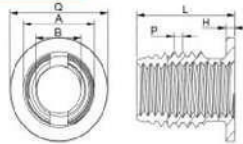

特点:

在302 槽型上加了法兰, 用在某些需要更高拉拔强度的应用场所。

Features:

Flanges are added to the 302 groove type for higher use in certain

Applications of drawing strength.

Technical Data

技术参数

规格 Specification	内径B	内牙牙距P	长度L	外径A	外牙牙距P	sw	安装底孔L2	钻孔深度L3
M4*0.7-L8-M6.5*0.75	M4	0.7	L8	M6.5	0.75	3.2	6.1-6.2	10
M5*0.8-L10-M8*1.0	M5	0.8	L10	M8	1	4.1	7.5-7.6	13
M6*1.0-L14-M10*1.5	M6	1	L14	M10	1.5	4.9	9.2-9.4	17



307孔型自攻螺套

307 hole self-tapping screw sleeve

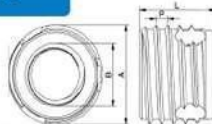

特点:产品用于相对难切削的材料, 三个孔用来做自攻切割。

Features:

The product is used relatively for the materials which are difficult to cut, three holes are used to do Self-tapping cutting.

Technical Data

技术参数

规格 Specification	内径B	内牙牙距	长度L	外径A	外牙牙距P	安装底孔L2	钻孔深度L3
M3*0.5-L4-M5*0.6	M3	0.5	4	M5	0.6	4.7-4.8	6
M4*0.7-L6-M6.5*0.8	M4	0.7	6	M6.5	0.8	6.1-6.2	8



303槽型自攻螺套

303 Trough type self-tapping screw sleeve

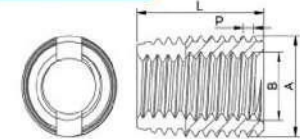

特点:

广泛使用于工业、家具装饰等行业使用范围广泛, 使其受各行业一致欢迎。具有良好的耐腐蚀性抗氧化耐热性、强度高、韧性高的特点。

Features:

Widely used in industry, furniture decoration and other industries wide range of use, make it popular in all industries. It has good corrosion resistance, oxidation resistance and heat resistance Characteristics of high strength, high toughness.



302槽型内六角自攻螺套

302 SLOT TYPE HEXAGONAL SELF-TAPPING SCREW SLEEVE

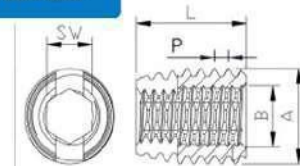

特点:

成品接触面大, 承受拉力强, 对振动抵抗力强, 可防止松动, 安装简便, 迅速。
feature:

The finished product has large contact surface, strong tensile strength, strong resistance to vibration, and can prevent looseMove, easy to install, fast.

Technical Data

技术参数

规格 Specification	内径B	内牙牙距P	长度L	外径A	外牙牙距P	安装底孔L2	钻孔深度L3
M3*0.5-L6-M4.5*0.5	M3	0.5	L6	M4.5	0.5	4.1-4.2	8
M3.5*0.6-L6-M5*0.6	M3.5	0.6	L6	M5	0.6	4.6-4.7	8



307孔型内六角自攻螺套

307 HEX HOLE SELF-TAPPING SCREW SLEEVE

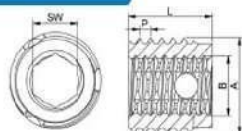

特点:

广泛使用于工业、家具装饰等行业使用范围广泛,有良好的耐腐蚀性抗氧化耐热性、强度高、韧性高的特点。

Features:

Widely used in industry, furniture decoration and other industries a wide range of use, good corrosion resistance, oxidation resistance, heat resistance, high strength, high toughness characteristics.



308孔型内六角自攻螺套

308 HOLE HEXAGONAL SELF-TAPPING SCREW SLEEVE

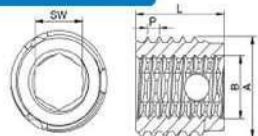

特点:

成品接触面大,承受拉力强,对振动抵抗力强,可防止松动,安装简便、迅速。

Features:

The finished product has large contact surface, strong tensile strength, strong resistance to vibration, and can prevent loose Move, easy to install fast.

Technical Data

技术参数

规格 Specification	内径B	内牙距P	长度L	外径A	外牙距P	sw	安装底孔L2	钻孔深度L1
M4*0.7-L6-M6.5*0.8	M4	0.7	6	M6.5	0.8	3.2	6.1-6.2	8
M5*0.8-L7-M8*1.0	M5	0.8	7	M8	1	4.1	7.6-7.7	9
M6*1.0-L8-M10*1.25	M6	1	8	M10	1.25	4.9	9.5-9.6	10



347孔型自攻螺套

347 pass self tapping screw sleeve

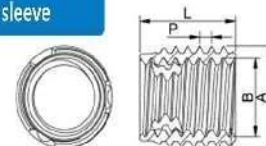

特点:

广泛使用于工业、家具装饰等行业使用范围广泛,有良好的耐腐蚀性抗氧化耐热性、强度高、韧性高的特点。

Features:

Widely used in industry, furniture decoration and other industries a wide range of use, have good corrosion resistance, oxidation resistance, heat resistance, high strength, high toughness characteristics.



337孔型自攻螺套

337 hole type self-tapping screw sleeve

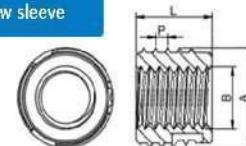

特点:

这个螺套的切削孔是盲孔,它主要用在不允许有切削掉入基材孔中的场所。

Features:

The cutting hole of this screw sleeve is a speech hole, which is mainly used in not allowed to have Cut into holes in the substrate.

Technical Data

技术参数

规格 Specification	内径B	内牙距P	长度L	外径A	外牙距P	安装底孔L2	钻孔深度L1
M3.5*0.6-L5-M5*0.6	M3.5	0.6	5	M5	0.6	4.7-4.8	7
M4*0.7-L6-M6*0.7	M4	0.7	6	M6	0.7	5.6-5.7	8
M5*0.8-L7-M6.5*0.8	M5	0.8	7	M6.5	0.8	6.1-6.2	9



花齿螺母 Tooth nut

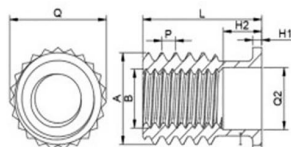

特点:

小而精巧, 广泛应用于精密电子电器产品或精密设备;具有高抗扭矩阻力, 规格系列化, 能满足多种设计要求。

Features:

Small and compact, widely used in precision electronic and electrical products or Precision equipment; With high torque resistance, serial specifications, can be full Meet a variety of design requirements.

Technical Data

技术参数

规格 Specification	内径B	内牙牙距P	长度L	外径A	外牙牙距P	头部直径Q	安装底孔	头部高度H	钻孔深度L3
M4*0.7-M7*1.0-L8.6	M4	0.7	8.6	M7	1	7.6	4.35	0.6	3.3
M5*0.8-M8*1.25-L10.8	M5	0.8	10.8	M8	1.25	8.8	5.35	0.8	3.5
M6*1.0-M10*1.5-L11	M6	1	11	M10	1.5	11	6.8	1	2.7
M6*1.0-M10*1.5-L12.8	M6	1	12.8	M10	1.5	10.8	6.8	0.8	3.5
M8*1.25-M12*1.5-L16	M8	1.25	16	M12	1.5	13	8.5	1	3.3
M10*1.5-M14*1.5-L19	M10	1.5	19	M14	1.5	15	10.5	1	3.3
M12*1.5-M16*1.5-L22	M12	1.5	22	M16	1.5	17	12.5	1	3.5
M12*1.75-M16*1.5-L22	M12	1.75	22	M16	1.5	17	12.5	1	3.5
M12*1.75-M16*1.5-L22	M14	1.5	25	M20	1.5	21	15.5	1	3.6



火花塞自攻螺套 Spark plug self tapping screw sleeve

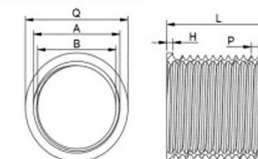

特点:

广泛使用于工业、家具装饰等行业使用范围广泛, 使其受各行业一致欢迎。具有良好的耐腐蚀性抗氧化耐热性、强度高、韧性高的特点。

Features:

Widely used in industry, furniture decoration and other industries wide range of use, Make it popular in all industries. It has good corrosion resistance, oxidation resistance and heat resistance, Characteristics of high strength, high toughness.

Technical Data

技术参数

规格	内径B	内牙牙距P	长度L	外径A	外牙牙距P	头部直径Q	安装底孔	头部高度H	钻孔深度L3
M6*1*M8*1*L9.4mm	M6	1	9.4	M8	1	8.6	7.1	0.6	12
M8*1.25*M10*1.25*L11.7mm	M8	1.25	11.7	M10	1.25	10.6	8.9	0.6	14
M10*1*M12*1*L12.7mm	M10	1	12.7	M12	1	12.6	11.2	0.8	15
M10*1.25*M12*1.25*L17 mm	M10	1.25	17	M12	1.25	12.6	10.9	0.8	20
M12*1.25*M14*1.25*L17mm	M12	1.25	17	M14	1.25	14.8	12.9	0.8	20
M12*1.5-M14*1.5*L16.2mm	M12	1.5	16.2	M14	1.5	14.8	12.7	0.8	19
M14*1.25*M16*1.25*L17mm	M14	1.25	17	M16	1.25	16.8	14.9	0.8	20
M14*1.5*M16*1.5*L9.4mm	M14	1.5	9.4	M16	1.5	16.8	14.7	0.8	12

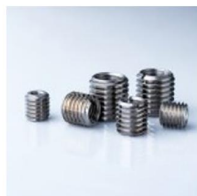

内外牙一字槽

The internal and external teeth are slotted

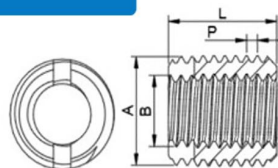

特点:

广泛使用于工业、家具装饰等行业使用范围广泛，使其受各行业一致欢迎。具有良好的耐腐蚀性抗氧化耐热性、强度高、韧性高的特点。

Features:

Widely used in industry, furniture decoration and other industries wide range of use, Make it popular in all industries. It has good corrosion resistance, oxidation resistance and heat resistance Characteristics of high strength, high toughness.

Technical Data
技术参数

规格 Specification	内径B	内牙距P	长度L	外径A	外牙距P	安装底孔L2	钻孔深度L3
M3*0.5*M5*0.8*L6mm	M3	0.5	6	M5	0.8	4.4	8
M4*0.7*M6*1.0*L8mm	M4	0.7	8	M6	1	5.2	10
M5*0.8*M8*1.25*L10MM	M5	0.8	10	M8	1.25	6.9	12
M6*1*M8*1.25*L10MM	M6	1	10	M8	1.25	7	12
M6*1*M10*1.5*L12MM	M6	1	12	M10	1.5	8.8	14
M8*1.25*M10*1.5*L12MM	M8	1.25	12	M10	1.5	9-9.1	14



308孔型

308 pass

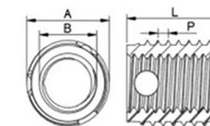

特点:

产品用于相对难切削的材料，三个孔用来做自攻切削

Features:

The product is used for relatively difficult to cut materials, three holes are used to do Self-tapping cutting.



308E孔型

308E pass

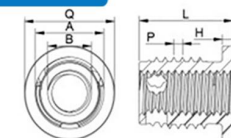

特点:

在307/308型上加了法兰，用在某些需要更高拉拔强度的应用场所。

Features:

Added flanges on model 307/308 for higher use in certain Applications of drawing strength.

Technical Data
技术参数

规格 Specification	内径B	内牙距P	长度L	外径A	外牙距P	头部直径Q	安装底孔	头部高度H	钻孔深度L3
M5*0.8-L11-M8*1.0	M5	0.8	L11	M8	1	11	7.6-7.7	1	13
M6*1-L13.5-M10*1.25	M6	1	L13.5	M10	1.25	13	9.5-9.6	1.5	15
M8*1.25-L15.5-M12*1.5	M8	1.25	L15.5	M12	1.5	15	11.3-11.5	1.5	17
M10*1.5-L19.5-M14*1.5	M10	1.5	L19.5	M14	1.5	17	13.3-13.5	1.5	22