

# CHAC

## CQB2 Series Miniature Circuit Breaker

PRODUCT CATALOG



### ZHEJIANG CHUANGQI ELECTRIC CO.,LTD.

- WenzhouBase  
No.18,ShahongRoad,BeibaixiangTown,YueqingCity,Wenzhou,ZhejiangProvince,China
- JiaxingBase  
No.61,ZhengyangWestRoad,XiuzhouDistrict,Jiaxing,ZhejiangProvince,China
- 0577-27878806
- marketing@chac-en.com
- www.chac-electric.com



LINKEDIN



WEBSITE

V2026.03-CHAC-MKT



# CQB2-63

## Miniature Circuit Breaker



### Product Features

- High interruption rating capabilities
- Overload & short circuit protection
- Positive isolation
- Suitable for industrial, commercial, high-rise and civil residences circuit protection

### Type designation

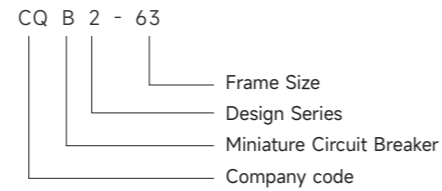

### Tripping curves

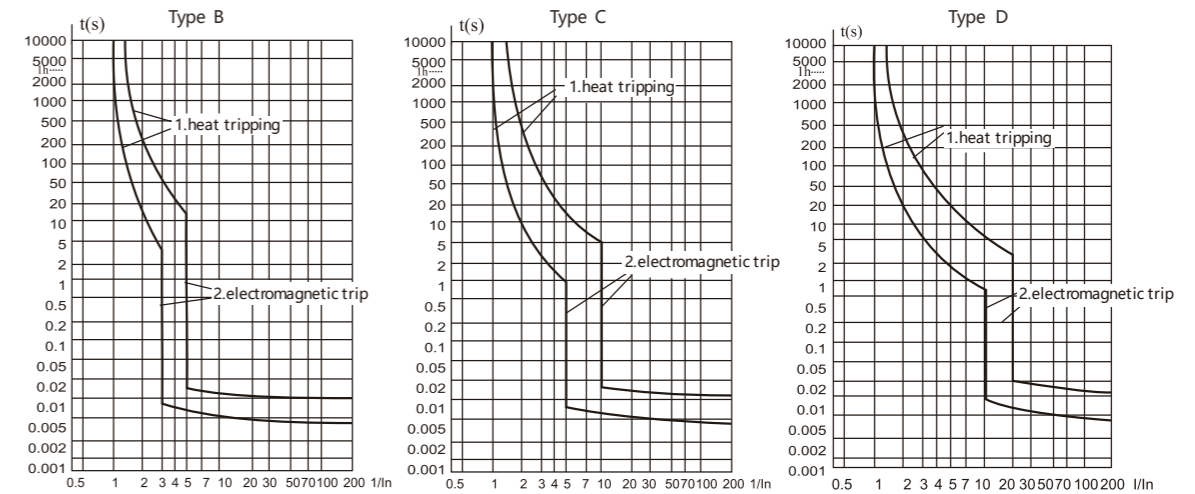

### Technical Specifications

| Parameter                              |  |
|--|--|
| Rated insulation voltage               | 500 V                                      |
| Rated impulse withstand voltage (Uimp) | 4000 V                                     |
| Rated current                          | 6A, 10A, 16A, 20A, 25A, 32A, 40A, 50A, 63A |
| Rated frequency                        | 50 Hz / 60 Hz                              |
| Number of poles                        | 1P, 1P+N, 2P, 3P, 3P+N, 4P                 |
| Rated breaking capacity (Icn = Ics)    | 6000 A                                     |
| Mechanical life                        | ≥ 10,000 operations                        |
| Electrical life                        | ≥ 6,000 operations                         |
| Tripping characteristics               | B, C, D                                    |
| Terminal center distance               | 45 mm                                      |
| Degree of protection                   | IP20                                       |
| Standards                              | IEC 60898-1, GB/T 10963.1                  |
| Certification                          | CCC  |

### Conductor requirements and cross section

| Copper cross-section(mm <sup>2</sup> ) | Rated current In(A) |
|--|---------------------|
| 1                                      | In≤6                |
| 1.5                                    | 6 < In≤13           |
| 2.5                                    | 13 < In≤20          |
| 4                                      | 20 < In≤25          |
| 6                                      | 25 < In≤32          |
| 10                                     | 32 < In≤50          |
| 16                                     | 50 < In≤63          |

### Dimensions(mm)

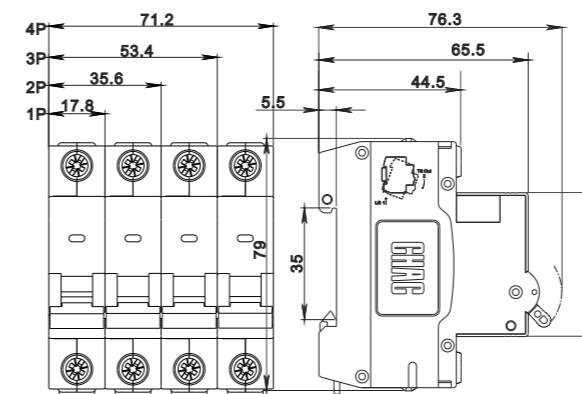

### Ordering Specification

Please specify the following when ordering:

- 1.Product Model: CQB2-63
  - 2.Number of Poles: 1P, 1P+N, 2P, 3P, 3P+N, 4P
  - 3.Rated Current & Tripping Curve: [e.g.: C/16A]
    - Tripping Curve (Type): B, C, D
    - Rated Current (In): 6A, 10A, 16A, 20A, 25A, 32A, 40A, 50A, 63A
  - 4.Quantity: [e.g.: 100 pcs]
- Ordering Example:  
CQB2-63 2P C/16A 100 pcs

### Tripping characteristics (Reference temperature 30°C)

| Item | Tripping Curve | Test current In(A) | Initial Status        | Time limit for tripping or non-tripping             | Expected result | Remarks  |
|------|----------------|--------------------|-----------------------|---|-----------------|--|
| a    | B, C, D        | 1.13In             | Cold                  | t ≤ 1h  | Non-tripping    | Current smoothly rises to specified value within 5s        |
| b    | B, C, D        | 1.45In             | Following item a test | t < 1h  | Tripping        |  |
| c    | B, C, D        | 2.55In             | Cold                  | 1s < t < 60s (In ≤ 32A)<br>1s < t < 120s (In > 32A) | Tripping        |  |
| d    | B              | 3In                | Cold                  | t ≤ 0.1s  | Non-tripping    | Switch on the power supply by closing the auxiliary switch |
|      | C              | 5In                |                       |   |                 |  |
| e    | D              | 10In               | Cold                  | t < 0.1s  | Tripping        | Switch on the power supply by closing the auxiliary switch |
|      | B              | 5In                |                       |   |                 |  |
|      | C              | 10In               |                       |   |                 |  |
|      | D              | 20In               |                       |   |                 |  |

Note: The term "cold" means that the test is carried out at a reference calibration temperature without load before the test.

# CQB2-125

## Miniature Circuit Breaker



### Product Features

- Overload & short circuit protection
- Positive isolation
- High breaking capacity up to 10KA
- Comprehensive range of accessories suitable for subsequent installation
- Suitable for industrial, commercial, high-rise and civil residences circuit protection

### Type designation

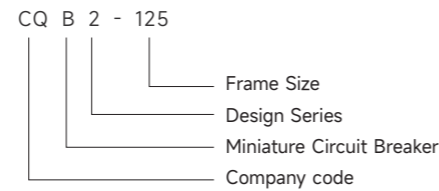

### Tripping curves

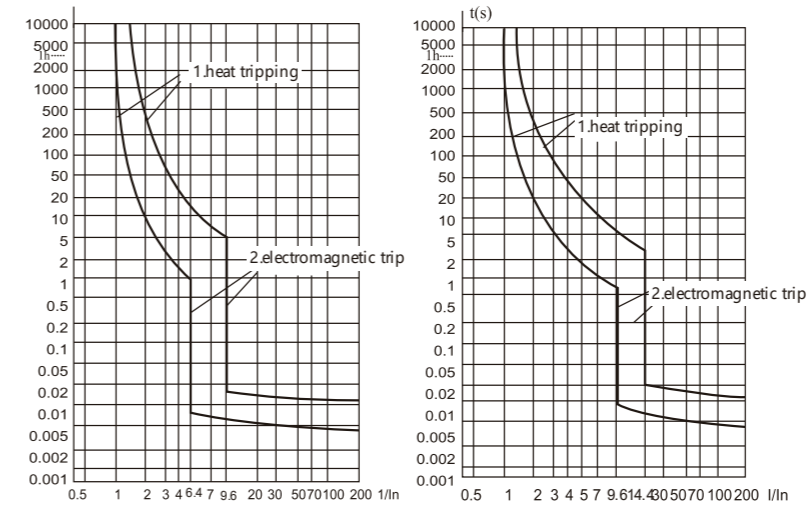

### Technical Specifications

| Parameter  |                           |
|--|---------------------------|
| Rated voltage (V)  | AC230V, AC400V            |
| Rated current (A)  | 63A, 80A, 100A, 125A      |
| Number of poles  | 1P, 2P, 3P, 4P            |
| Tripping curves  | C, D                      |
| Rated short-circuit breaking capacity $I_{cu}$ (A)         | 10000 A                   |
| Rated service short-circuit breaking capacity $I_{cs}$ (A) | 7500 A                    |
| Rated impulse withstand voltage $U_{imp}$ (V)              | 4000 V                    |
| Mechanical life  | $\geq 8500$ operations    |
| Electrical life  | $\geq 1500$ operations    |
| Degree of protection                                       | IP20                      |
| Standards  | IEC 60947-2, GB/T 14048.2 |
| Certification  | CCC                       |

### Conductor requirements and cross section

| Copper cross-section(mm <sup>2</sup> ) | Rated current $I_n$ (A) |
|--|-------------------------|
| 16                                     | 63A                     |
| 25                                     | 80A                     |
| 35                                     | 100A                    |
| 50                                     | 125A                    |

### Dimensions(mm)

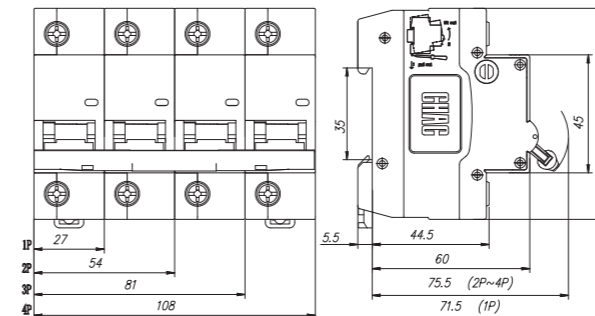

### Ordering Specification

Please specify the following when ordering:

- 1.Product Model: CQB2-125
- 2.Number of Poles: 1P, 2P, 3P, 4P
- 3.Tripping Curve Type: C or D
- 4.Rated Current ( $I_n$ ): 63A, 80A, 100A, 125A
- 5.Quantity: [e.g.: 100 pcs]

Ordering Example:

CQB2-125 2P C/100A 100 pcs

### Tripping characteristics (Reference temperature 30°C)

| Item | Tripping Curve | Test current $I_n$ (A) | Initial Status        | Time limit for tripping or non-tripping   | Expected result | Remarks  |
|------|----------------|------------------------|-----------------------|---|-----------------|--|
| a    | C, D           | 1.05 $I_n$             | Cold                  | 1h( $I_n \leq 63A$ )<br>2h( $I_n > 63A$ ) | Non-tripping    | Current smoothly rises to specified value within 5s        |
| b    | C, D           | 1.3 $I_n$              | Following item a test | 1h( $I_n \leq 63A$ )<br>2h( $I_n > 63A$ ) | Tripping        |  |
| c    | C, D           | 2 $I_n$                | Cold                  | 1s<t<300s                                 | Tripping        |  |
| d    | C              | 8 $I_n \times 80\%$    | Cold                  | t $\leq$ 0.2s                             | Non-tripping    | Switch on the power supply by closing the auxiliary switch |
|      | D              | 12 $I_n \times 80\%$   |                       |   |                 |  |
| e    | C              | 8 $I_n \times 80\%$    | Cold                  | t < 0.2s                                  | Tripping        | Switch on the power supply by closing the auxiliary switch |
|      | D              | 12 $I_n \times 80\%$   |                       |   |                 |  |

Note: The term "cold" means that the test is carried out at a reference calibration temperature without load before the test.

# CQB2LE-40

Residual Current Circuit Breaker with Overcurrent Protection - Electronic Type



## Product Features

- Sensitive protection: 30mA earth leakage protection with 0.1s fast response
- Dual safety: Overload and short-circuit protection in one device
- Wide applicability: 6-40A multi-current options for various loads
- Compact design: 1P+N configuration saves space

## Type designation

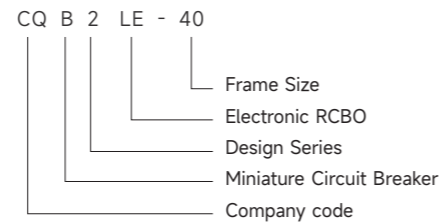

## Tripping curves

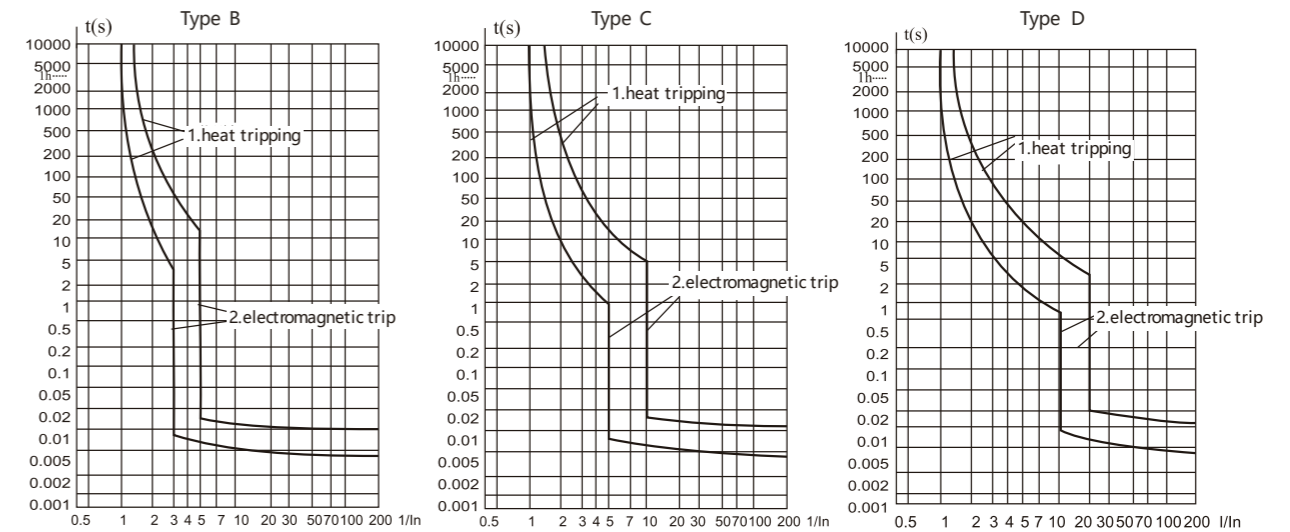

## Technical Specifications

| Parameter                                   |                                  |
|---|----------------------------------|
| Rated voltage                               | 230V~                            |
| Rated current                               | 6A, 10A, 16A, 20A, 25A, 32A, 40A |
| Frequency                                   | 50Hz/60Hz                        |
| Number of poles                             | 1P+N                             |
| Rated residual operating current (IΔn)      | 30 mA                            |
| Rated residual non-operating current        | 15 mA                            |
| Rated short-circuit breaking capacity (Icu) | 4500 A                           |
| Rated residual making and breaking capacity | 500 A                            |
| Tripping time                               | ≤ 0.1 s                          |
| Mechanical life                             | 10,000 operations                |
| Electrical life                             | 10,000 operations                |
| Tripping characteristics                    | B, C, D                          |
| Pollution degree                            | 2                                |
| Degree of protection                        | IP20                             |
| Standards                                   | IEC 61009-1, GB/T 16917.1        |
| Certification                               | CCC                              |

## Conductor requirements and cross section

| Copper cross-section(mm <sup>2</sup> ) | Rated current In(A) |
|--|---------------------|
| 1                                      | In≤6                |
| 1.5                                    | 6 < In≤13           |
| 2.5                                    | 13 < In≤20          |
| 4                                      | 20 < In≤25          |
| 6                                      | 25 < In≤32          |
| 10                                     | 32 < In≤40          |

## Dimensions(mm)

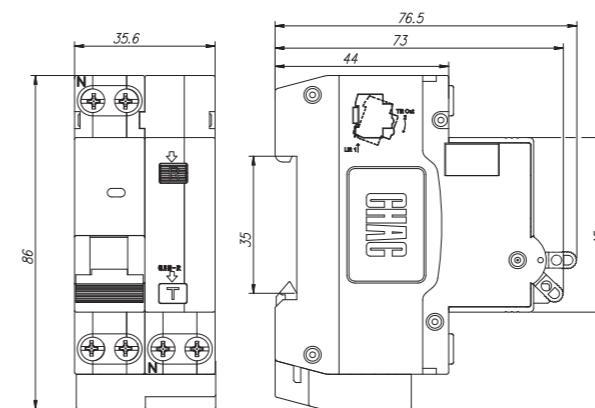

## Ordering Specification

Please specify the following when ordering:

- 1.Product Model: CQB2LE-40
- 2.Number of Poles: 1P+N
- 3.Rated Current & Tripping Curve: [e.g.: C/16A]
  - Tripping Curve: B, C, D
  - Rated Current (In): 6A, 10A, 16A, 20A, 25A, 32A, 40A
- 4.Rated Residual Operating Current (IΔn): 30mA
- 5.Quantity: [e.g.: 100 pcs]

Ordering Example:

CQB2LE-40 1P+N C/16A 30mA 100 pcs

## Tripping characteristics (Reference temperature 30°C)

| Item          | Tripping Curve | Test current In(A)      | Initial Status | Time limit for tripping or non-tripping | Expected result | Remarks   |
|---------------|----------------|-------------------------|----------------|---|-----------------|---|
| Delay         | ≤40            | Cold                    | 1.13In         | ≤1h                                     | Non-tripping    |   |
| Delay         | ≤40            | Following previous test | 1.45In         | <1h                                     | Tripping        | Current smoothly rises to specified value in 5s |
| Delay         | ≤32            | Cold                    | 2.55In         | 1<t<60s                                 | Tripping        |   |
| Delay         | 40             | Cold                    | 2.55In         | 1<t<120s                                | Tripping        |   |
| Instantaneous | Any value      | Cold                    | 3、5、10In       | ≤0.1s                                   | Non-tripping    | B、C、D   |
| Instantaneous | Any value      | Cold                    | 5、10、20In      | <0.1s                                   | Tripping        | B、C、D   |

Note: The term "cold" means that the test is carried out at a reference calibration temperature without load before the test.

# CQB2LE-63

Residual Current Circuit Breaker with Overcurrent Protection - Electronic Type



## Product Features

- Balanced performance: 63A rating with 6000A breaking capacity
- Fast protection:  $\leq 0.1s$  tripping time for quick fault isolation
- Flexible application: 2P to 4P options for single/three-phase systems
- Easy installation: Standard size for simple integration

## Type designation

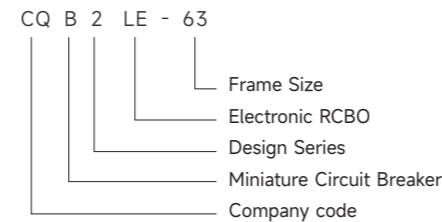

## Tripping curves

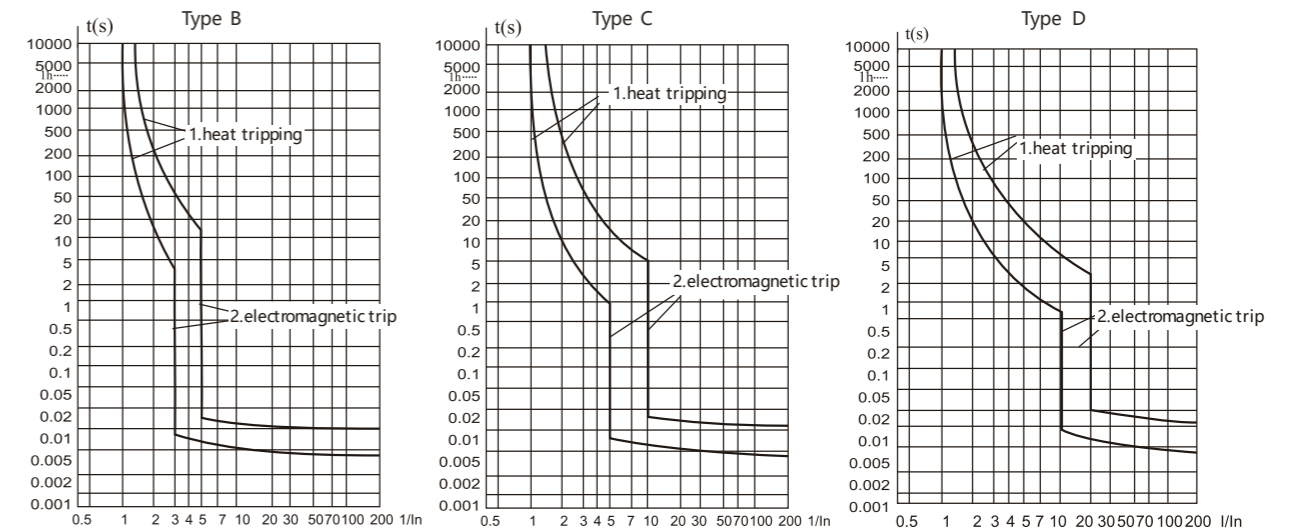

## Technical Specifications

| Parameter                                   |  |
|---|--|
| Rated voltage                               | 230V~ (2P, 1P+N) / 400V~ (3P, 4P, 3P+N)    |
| Rated current                               | 6A, 10A, 16A, 20A, 25A, 32A, 40A, 50A, 63A |
| Number of poles                             | 2P, 3P, 4P, 1P+N, 3P+N                     |
| Rated breaking capacity (Icn = Ics)         | 6000 A                                     |
| Rated residual operating current (IΔn)      | 30, 50, 100, 300 mA                        |
| Rated residual non-operating current        | 0.5 IΔn                                    |
| Rated residual making and breaking capacity | 2000 A                                     |
| Tripping time                               | $\leq 0.1$ s                               |
| Mechanical life                             | 4000 operations                            |
| Electrical life                             | 4000 operations                            |
| Tripping curves                             | B, C, D                                    |
| Degree of protection                        | IP20                                       |
| Overvoltage category                        | III  |
| Standards                                   | IEC 61009-1, GB/T 16917.1                  |
| Certification                               | CCC  |

## Tripping characteristics (Reference temperature 30°C)

| Item          | Tripping Curve | Test current I <sub>n</sub> (A) | Initial Status          | Time limit for tripping or non-tripping | Expected result | Remarks   |
|---------------|----------------|---------------------------------|-------------------------|---|-----------------|---|
| Delay         | $\leq 63$      | Cold                            | 1.13I <sub>n</sub>      | $\leq 1h$                               | Non-tripping    |   |
| Delay         | $\leq 63$      | Following previous test         | 1.45I <sub>n</sub>      | $< 1h$                                  | Tripping        | Current smoothly rises to specified value in 5s |
| Delay         | $\leq 32$      | Cold                            | 2.55I <sub>n</sub>      | 1<t<60s                                 | Tripping        |   |
| Delay         | >32            | Cold                            | 2.55I <sub>n</sub>      | 1<t<120s                                | Tripping        |   |
| Instantaneous | Any value      | Cold                            | 3, 5, 10I <sub>n</sub>  | $\leq 0.1s$                             | Non-tripping    | B, C, D   |
| Instantaneous | Any value      | Cold                            | 5, 10, 20I <sub>n</sub> | $< 0.1s$                                | Tripping        | B, C, D   |

Note: The term "cold" means that the test is carried out at a reference calibration temperature without load before the test.

## Conductor requirements and cross section

| Copper cross-section(mm <sup>2</sup> ) | Rated current I <sub>n</sub> (A) |
|--|----------------------------------|
| 1                                      | I <sub>n</sub> ≤6                |
| 1.5                                    | 6 < I <sub>n</sub> ≤13           |
| 2.5                                    | 13 < I <sub>n</sub> ≤20          |
| 4                                      | 20 < I <sub>n</sub> ≤25          |
| 6                                      | 25 < I <sub>n</sub> ≤32          |
| 10                                     | 32 < I <sub>n</sub> ≤50          |
| 16                                     | 50 < I <sub>n</sub> ≤63          |

## Dimensions(mm)

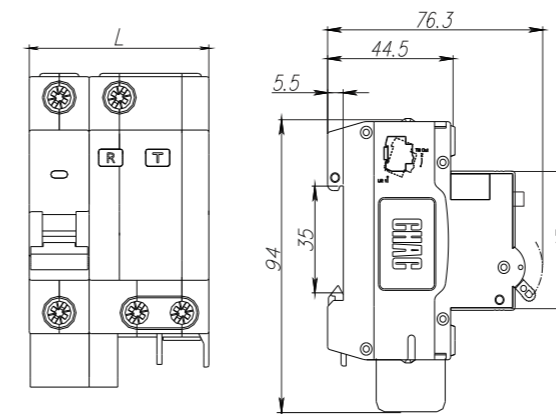

| Poles | L     |
|-------|-------|
| 1P+N  | 53.4  |
| 2P    | 71.2  |
| 3P    | 102.4 |
| 3P+N  | 115.8 |
| 4P    | 133.6 |

## Ordering Specification

Please specify the following when ordering:

- 1.Product Model: CQB2LE-63
  - 2.Number of Poles: 1P+N, 2P, 3P, 3P+N, 4P
  - 3.Rated Current & Tripping Curve: [e.g.: C/32A]
    - Tripping Curve: B, C, D
    - Rated Current (I<sub>n</sub>): 6A, 10A, 16A, 20A, 25A, 32A, 40A, 50A, 63A
  - 4.Rated Residual Operating Current (IΔn): 30mA, 50mA, 100mA, 300mA
  - 5.Quantity: [e.g.: 100 pcs]
- Ordering Example:  
CQB2LE-63 2P C/32A 30mA 100 pcs

# CQB2LE-125

Residual Current Circuit Breaker with Overcurrent Protection - Electronic Type



## Product Features

- Industrial grade: 125A high rated current for main distribution
- Strong breaking: 10kA breaking capacity handles severe faults
- Flexible settings: 30-300mA adjustable sensitivity
- Multiple poles: 1P+N to 4P options for three-phase systems
- High reliability: Long mechanical life for frequent operation

## Type designation

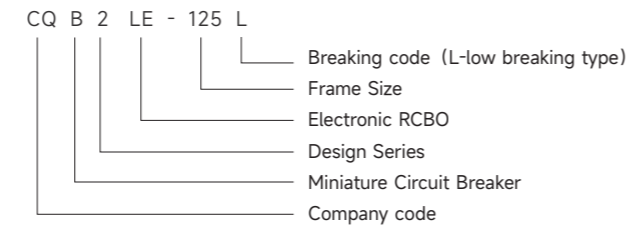

## Technical Specifications

| Parameter                       |                                      |
|---------------------------------|--------------------------------------|
| Rated voltage                   | 230V~ (1P+N/2P), 400V~ (3P/3P+N/4P)  |
| Rated current                   | 63A, 80A, 100A, 125A                 |
| Number of poles                 | 1P+N, 2P, 3P, 3P+N, 4P               |
| Rated breaking capacity Icu (A) | 10000 A, 6000 A (Lower type)         |
| Rated sensitivity IΔn           | 30 mA, 50 mA, 75 mA, 100 mA, 300 mA  |
| Mechanical & Electrical life    | Mechanical ≥ 8500, Electrical ≥ 1500 |
| Tripping curves                 | C, D                                 |
| Tightening torque (N·m)         | 3.5                                  |
| Pollution degree                | 2                                    |
| Degree of protection            | IP20                                 |
| Overvoltage category            | III                                  |
| Standards                       | IEC 60947-2, GB/T 14048.2            |
| Certification                   | CCC                                  |

## Tripping characteristics (Reference temperature 30°C)

| Item | Tripping Curve | Test current I <sub>n</sub> (A) | Initial Status        | Time limit for tripping or non-tripping            | Expected result | Remarks  |
|------|----------------|---------------------------------|-----------------------|--|-----------------|--|
| a    | C, D           | 1.05I <sub>n</sub>              | Cold                  | 1h(I <sub>n</sub> ≤63A)<br>2h(I <sub>n</sub> >63A) | Non-tripping    | Current smoothly rises to specified value within 5s        |
| b    | C, D           | 1.3I <sub>n</sub>               | Following item a test | 1h(I <sub>n</sub> ≤63A)<br>2h(I <sub>n</sub> >63A) | Tripping        |  |
| c    | C, D           | 2I <sub>n</sub>                 | Cold                  | 1s<t<300s  | Tripping        |  |
| d    | C              | 8I <sub>n</sub> ×80%            | Cold                  | t ≤ 0.2s   | Non-tripping    | Switch on the power supply by closing the auxiliary switch |
|      | D              | 12I <sub>n</sub> ×80%           |                       |  |                 |  |
| e    | C              | 8I <sub>n</sub> ×80%            | Cold                  | t < 0.2s   | Tripping        | Switch on the power supply by closing the auxiliary switch |
|      | D              | 12I <sub>n</sub> ×80%           |                       |  |                 |  |

Note: The term "cold" means that the test is carried out at a reference calibration temperature without load before the test.

## Tripping curves

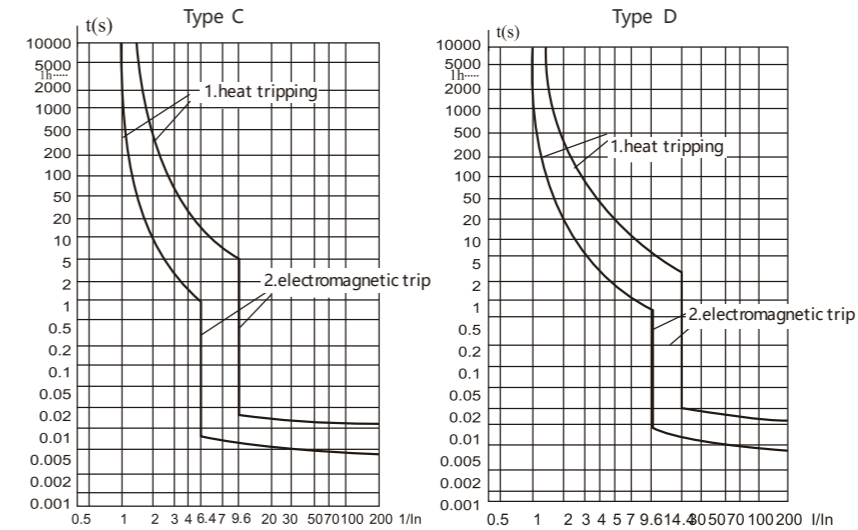

## Conductor requirements and cross section

| Copper cross-section(mm <sup>2</sup> ) | Rated current I <sub>n</sub> (A) |
|--|----------------------------------|
| 16                                     | 63A                              |
| 25                                     | 80A                              |
| 35                                     | 100A                             |
| 50                                     | 125A                             |

## Dimensions(mm)

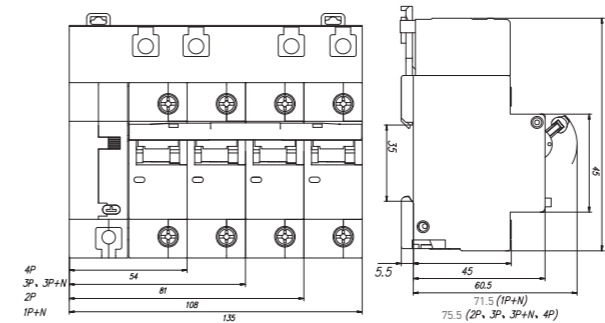

## Ordering Specification

Please specify the following when ordering:

- 1.Product Model: CQB2LE-125
- 2.Number of Poles: 1P+N, 2P, 3P, 3P+N, 4P
- 3.Rated Current & Tripping Curve: [e.g.: C/100A]
  - Tripping Curve: C, D
  - Rated Current (I<sub>n</sub>): 63A, 80A, 100A, 125A
- 4.Rated Residual Operating Current (IΔn): 30mA, 50mA, 75mA, 100mA, 300mA
- 5.Quantity: [e.g.: 100 pcs]

Ordering Example:

CQB2LE-125 3P C/100A 100mA 100 pcs

## CQD2-125

### Switch Disconnecter



#### Product Features

- Rated insulation voltage of 500V, High rated current (up to 125A) and strong short-time withstand current.
- Complies with the requirements for isolation function. It features safe isolation distance and a clear "OFF" position indication, ensuring the circuit is completely isolated from the power source when switched off, thereby safeguarding equipment and personnel.
- Available in 1P to 4P and multiple current ratings.

#### Type designation

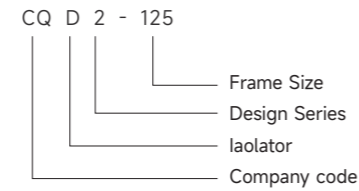

#### Technical Specifications

| Parameter                                 |                                      |
|---|--------------------------------------|
| Rated voltage (Ue)                        | AC 230 V, AC 400 V                   |
| Rated current (Ie)                        | 32A, 40A, 50A, 63A, 80A, 100A, 125A  |
| Number of poles                           | 1P, 2P, 3P, 4P                       |
| Rated short-time withstand current (Icw)  | 12 Ie (t = 1 s)                      |
| Rated short-circuit making capacity (Icm) | 20 Ie (t = 0.05 s)                   |
| Rated impulse withstand voltage (Uimp)    | 6 kV (1.2/50 μs, 2000 m)             |
| Mechanical & Electrical life              | Mechanical ≥ 8500, Electrical ≥ 1500 |
| Standards                                 | IEC 60947-3, GB/T 14048.3            |
| Certification                             | CCC                                  |

#### Conductor requirements and cross section

| Copper cross-section(mm <sup>2</sup> ) | Rated current In(A) |
|--|---------------------|
| 6                                      | 32A                 |
| 10                                     | 40A                 |
| 10                                     | 50A                 |
| 16                                     | 63A                 |
| 25                                     | 80A                 |
| 35                                     | 100A                |
| 50                                     | 125A                |

#### Dimensions(mm)

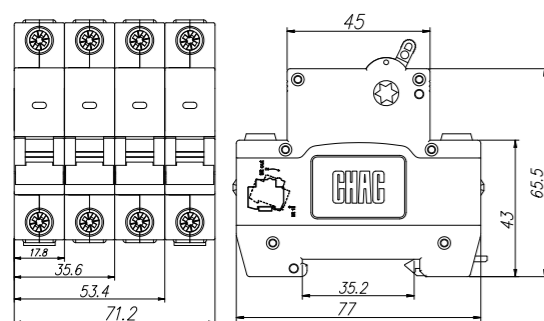

#### Ordering Specification

Please specify the following when ordering:

- 1.Product Model: CQD2-125
- 2.Number of Poles: 1P, 2P, 3P, 4P
- 3.Rated Current: 32A, 63A, 100A
- 4.Quantity: [e.g.: 100 pcs]

Ordering Example:

CQD2-125 2P 32A 100 pcs

## CQAF2

### Auxiliary Switch



#### Product Features

- Designed to be assembled with CQB2 circuit breakers to provide remote signal indication for the breaker's ON/OFF status.
- Suitable for both AC 230V and DC 110V control circuits.
- Complies with GB/T 14048.5 and IEC 60947-5-1 standards, with a mechanical life of no less than 10,000 operations.

#### Type designation

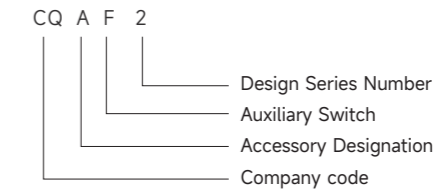

#### Technical Specifications

| Parameter       |                             |              |
|-----------------|-----------------------------|--------------|
| AC-15           | Rated Operational Voltage   | AC 230V 50Hz |
|                 | Rated operating current     | 6A           |
| DC-13           | Rated Operational Voltage   | DC110V       |
|                 | Rated operating current     | 1A           |
| Mechanical Life | 10000                       |              |
| Standards       | GB/T 14048.5, IEC 60947-5-1 |              |

#### Dimensions(mm)

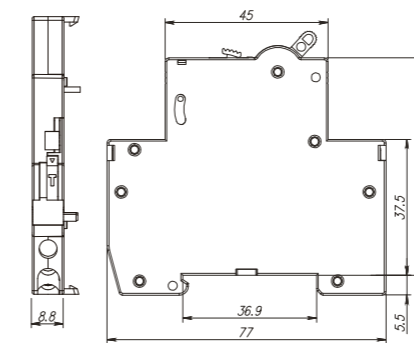

#### Ordering Specification

Please specify the following when ordering:

- Product Model: CQAF2
- Quantity: [e.g.: 100 pcs]

Ordering Example:

CQAF2 100 pcs

## CQAS2 Alarm Switch



### Product Features

- Designed to be assembled with CQB2 circuit breakers to provide a remote alarm signal upon fault tripping (e.g., due to overload or short circuit).
- Suitable for both AC 230V and DC 110V control circuits.
- Complies with GB/T 14048.5 and IEC 60947-5-1 standards, with a mechanical life of no less than 10,000 operations.
- Rated operational current: 6A under utilization category AC-15; 1A under utilization category DC-13.

### Type designation

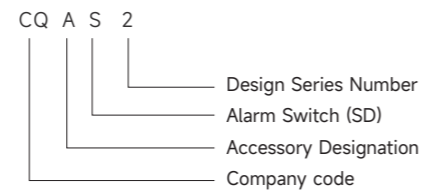

### Technical Specifications

| Parameter       |                             |              |
|-----------------|-----------------------------|--------------|
| AC-15           | Rated Operational Voltage   | AC 230V 50Hz |
|                 | Rated operating current     | 6A           |
| DC-13           | Rated Operational Voltage   | DC110V       |
|                 | Rated operating current     | 1A           |
| Mechanical Life | 10000                       |              |
| Standards       | GB/T 14048.5, IEC 60947-5-1 |              |

### Dimensions(mm)

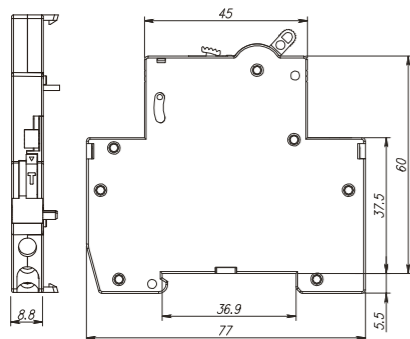

### Ordering Specification

Please specify the following when ordering:

- Product Model: CQAS2
- Quantity: [e.g.: 100 pcs]

Ordering Example:

CQAS2 100 pcs

## CQAM2 Shunt Release



### Product Features

- Designed to be assembled with CQB2 circuit breakers to achieve remote tripping and opening of the breaker by applying the rated voltage.
- Features a broad operating voltage range (160V - 260V), ensuring reliable operation and stability of remote control within this range.
- Complies with GB/T 14048.5 and IEC 60947-5-1 standards, with a rated insulation voltage of 415V.

### Type designation

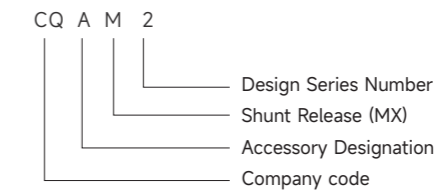

### Technical Specifications

| Parameter                 |   |              |
|---------------------------|---|--------------|
| AC-15                     | Rated Operational Voltage (V)   | AC 230V 50Hz |
|                           | Rated Insulation Voltage (V)  | 415V         |
| Operating Characteristics | When the voltage is between 160-260V, the trip unit can reliably operate. |              |
| Mechanical Life           | 4000  |              |
| Standards                 | GB/T 14048.5, IEC 60947-5-1   |              |

### Conductor requirements and cross section

| Copper cross-section(mm <sup>2</sup> ) |
|--|
| 1 X 2.5                                |

### Dimensions(mm)

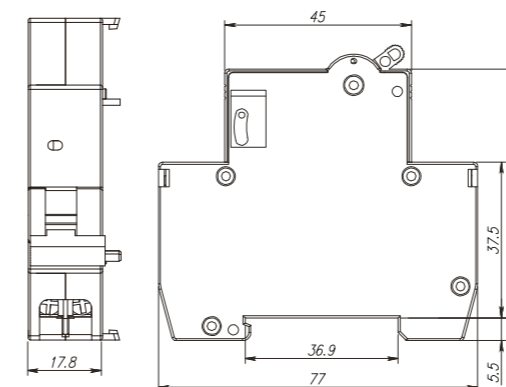

### Ordering Specification

Please specify the following when ordering:

- Product Model: CQAM2
- Quantity: [e.g.: 100 pcs]

Ordering Example:

CQAM2 100 pcs

## CQAU2

Over-Voltage & Under-Voltage Protector



### Product Features

- Designed to be assembled with CQB2 circuit breakers to monitor line voltage and automatically trip to protect downstream equipment in the event of over-voltage or under-voltage conditions.
- Over-voltage tripping:  $\geq (265\pm 10)V$ ; Under-voltage tripping:  $\leq (165\pm 10)V$ . Normal operating voltage range: 175V - 255V.
- Complies with GB/T 14048.5 and IEC 60947-5-1 standards, with a rated insulation voltage of 415V.

### Type designation

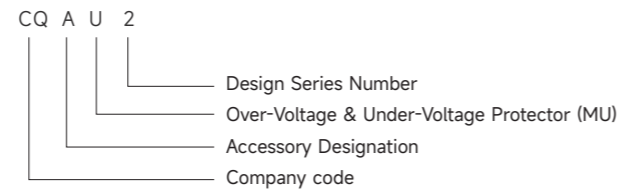

### Technical Specifications

| Parameter                 |   |              |
|---------------------------|---|--------------|
| AC-15                     | Rated Operational Voltage (V)   | AC 230V 50Hz |
|                           | Rated Insulation Voltage (V)  | 415V         |
| Operating Characteristics | Maintains long-term circuit breaker operation at voltages between 175V - 255V.                            |              |
|                           | Trips at voltages $\geq 265\pm 10V$ (Over-Voltage)<br>Trips at voltages $\leq 165\pm 10V$ (Under-Voltage) |              |
| Mechanical Life           | Not less than 4,000 operations.   |              |
| Standards                 | GB/T 14048.5, IEC 60947-5-1   |              |

### Conductor requirements and cross section

| Copper cross-section(mm <sup>2</sup> ) |
|--|
| 1 X 2.5                                |

### Dimensions(mm)

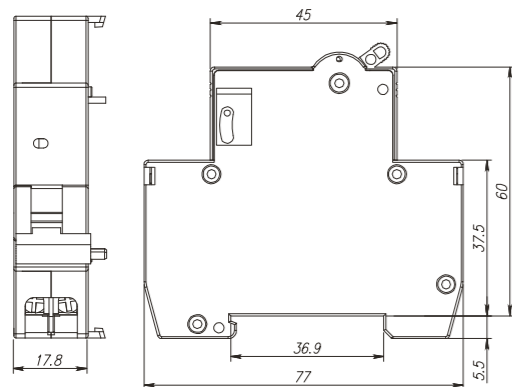

### Ordering Specification

Please specify the following when ordering:

- Product Model: CQAU2
- Quantity: [e.g.: 100 pcs]

Ordering Example:

CQAU2 100 pcs

## CQAX2

Shunt Release + Auxiliary Switch Combination Unit



### Product Features

- Combines the functions of a Shunt Release and an Auxiliary Switch into a single module, saving installation space.
- Capable of both remote tripping operation (Shunt Release function) and providing breaker status signals (Auxiliary Switch function).
- The shunt release unit operates reliably within a wide voltage range of 160V - 260V.
- Dual Supply Signal Compatibility: The auxiliary switch part is suitable for both AC 230V and DC 110V control circuits.

### Type designation

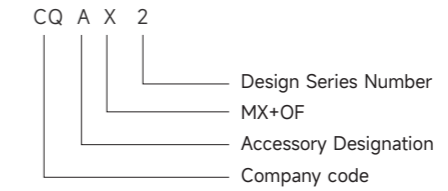

### Technical Specifications

| Parameter                 |   |              |
|---------------------------|---|--------------|
| AC-15                     | Rated Operational Voltage   | AC 230V 50Hz |
|                           | Rated Insulation Voltage  | 415V         |
| DC-13                     | Rated Operational Voltage   | DC110V       |
|                           | Rated operating current   | 1A           |
| Operating Characteristics | When the voltage is between 160-260V, the trip unit can reliably operate. |              |
| Mechanical Life           | Not less than 4,000 operations.   |              |
| Standards                 | GB/T 14048.5, IEC 60947-5-1   |              |

### Conductor requirements and cross section

| Copper cross-section(mm <sup>2</sup> ) |
|--|
| 1 X 2.5                                |

### Dimensions(mm)

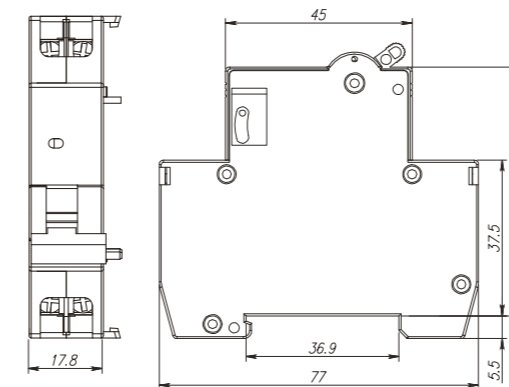

### Ordering Specification

Please specify the following when ordering:

- Product Model: CQAX2
- Quantity: [e.g.: 100 pcs]

Ordering Example:

CQAX2 100 pcs

# CQB2H-63

## Miniature Circuit Breaker



### Product Features

- Overload & short circuit protection
- Positive isolation
- High breaking capacity up to 10KA
- Comprehensive range of accessories suitable for subsequent installation
- Suitable for industrial, commercial, high-rise and civil residences circuit protection

### Type designation

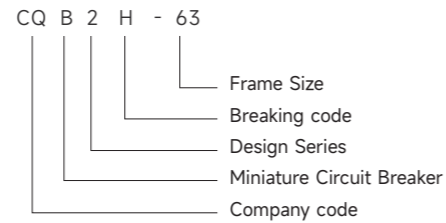

### Tripping curves

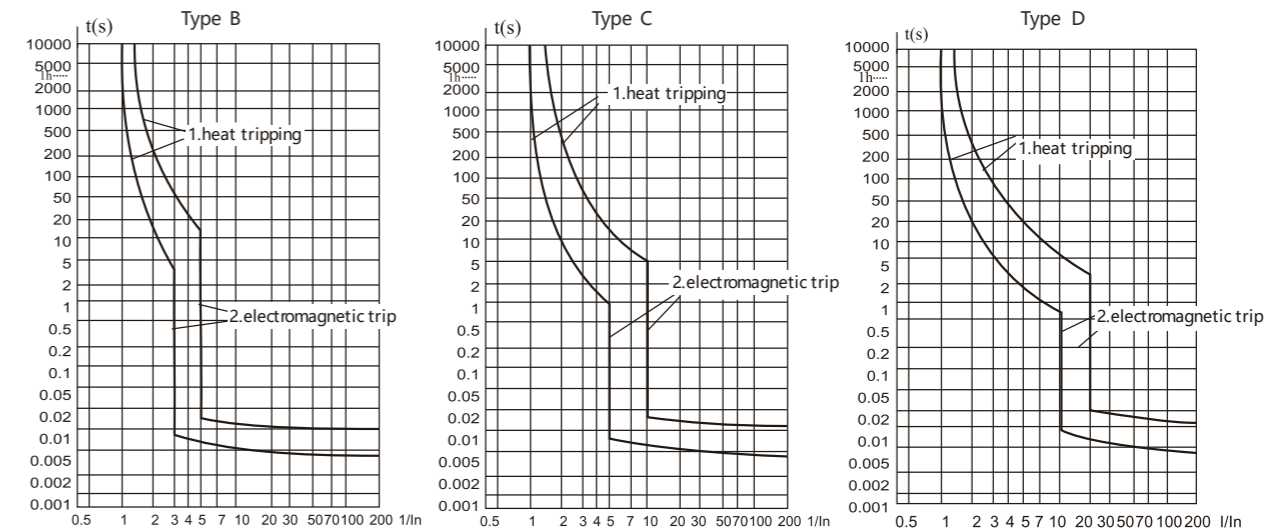

### Conductor requirements and cross section

| Copper cross-section(mm <sup>2</sup> ) | Rated current In(A) |
|--|---------------------|
| 1.5                                    | 6 < In ≤ 13         |
| 2.5                                    | 13 < In ≤ 20        |
| 4                                      | 20 < In ≤ 25        |
| 6                                      | 25 < In ≤ 32        |
| 10                                     | 32 < In ≤ 50        |
| 16                                     | 50 < In ≤ 63        |

### Dimensions(mm)

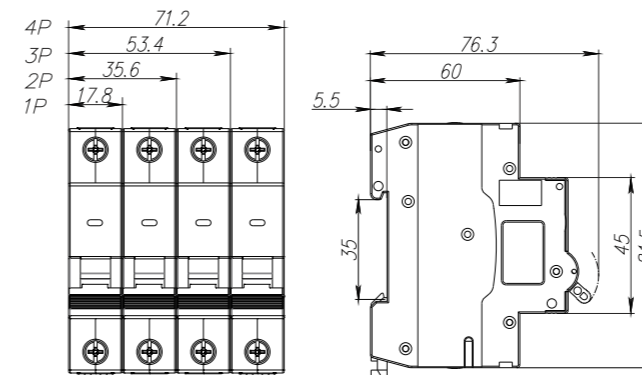

### Ordering Specification

- Please specify the following when ordering:
- Product Model: CQB2H-63
  - Number of Poles: 1P, 2P, 3P, 4P
  - Tripping Curve & Rated Current: [e.g.: C/32A]
    - Tripping Curve: B, C, D
    - Rated Current (In): 6A, 10A, 16A, 20A, 25A, 32A, 40A, 50A, 63A
  - Quantity: [e.g.: 100 pcs]
- Ordering Example:  
CQB2H-63 2P C/32A 100 pcs

### Technical Specifications

| Parameter                                 |  |
|---|--|
| Rated voltage                             | 230V/400V (1P), 400V~ (2P/3P/4P)           |
| Rated current                             | 6A, 10A, 16A, 20A, 25A, 32A, 40A, 50A, 63A |
| Number of poles                           | 1P, 2P, 3P, 4P                             |
| Rated short circuit breaking capacity Icn | 10000 A                                    |
| Mechanical & Electrical life              | Mechanical ≥ 20000, Electrical ≥ 6000      |
| Tripping characteristics                  | B, C, D                                    |
| Tightening torque (N·m)                   | 3.5  |
| Pollution degree                          | 2  |
| Degree of protection                      | IP20                                       |
| Overvoltage category                      | II, III                                    |
| Standards                                 | IEC 60898-1, GB/T 10963.1                  |

### Tripping characteristics (Reference temperature 30°C)

| Item | Tripping Curve | Test current In(A) | Initial Status        | Time limit for tripping or non-tripping             | Expected result | Remarks  |
|------|----------------|--------------------|-----------------------|---|-----------------|--|
| a    | B, C, D        | 1.13In             | Cold                  | t ≤ 1h  | Non-tripping    | Current smoothly rises to specified value within 5s        |
| b    | B, C, D        | 1.45In             | Following item a test | t < 1h  | Tripping        |  |
| c    | B, C, D        | 2.55In             | Cold                  | 1s < t < 60s (In ≤ 32A)<br>1s < t < 120s (In > 32A) | Tripping        |  |
| d    | B              | 3In                | Cold                  | t ≤ 0.1s  | Non-tripping    | Switch on the power supply by closing the auxiliary switch |
|      | C              | 5In                |                       |   |                 |  |
| e    | D              | 10In               | Cold                  | t < 0.1s  | Tripping        | Switch on the power supply by closing the auxiliary switch |
|      | B              | 5In                |                       |   |                 |  |
|      | C              | 10In               |                       |   |                 |  |
|      | D              | 20In               |                       |   |                 |  |

Note: The term "cold" means that the test is carried out at a reference calibration temperature without load before the test.

# CQB2HL-63

Residual Current Circuit Breaker with Overcurrent Protection - Electronic Type



## Product Features

- High performance: 10kA breaking capacity for reliable protection
- Precise matching: B/C/D tripping curves for different loads
- Multiple options: 30-300mA five-level sensitivity selection
- Long lifespan: 20,000 mechanical operations ensure durability
- Full protection: IP20 rating for various environments

## Type designation

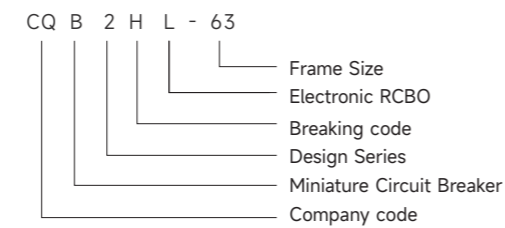

## Technical Specifications

| Parameter                    |  |
|------------------------------|--|
| Rated voltage                | 230V~ (1P+N, 2P), 400V~ (3P, 3P+N, 4P)     |
| Rated current                | 6A, 10A, 16A, 20A, 25A, 32A, 40A, 50A, 63A |
| Rated tripping current IΔn   | 30mA, 50mA, 75mA, 100mA, 300mA             |
| Number of poles              | 1P+N, 2P, 3P, 3P+N, 4P                     |
| Rated breaking capacity Icn  | 10000 A                                    |
| Mechanical & Electrical life | Mechanical ≥ 20000, Electrical ≥ 6000      |
| Tightening torque (N·m)      | 3.5  |
| Pollution degree             | 2  |
| Degree of protection         | IP20                                       |
| Overtoltage category         | II, III                                    |
| Tripping characteristics     | 2  |
| Standards                    | IEC 61009-1, GB/T 16917.1                  |
| Certification                | CCC  |

## Tripping characteristics (Reference temperature 30°C)

| Item | Tripping Curve | Test current I <sub>n</sub> (A) | Initial Status        | Time limit for tripping or non-tripping                                     | Expected result | Remarks  |
|------|----------------|---------------------------------|-----------------------|---|-----------------|--|
| a    | B, C, D        | 1.13I <sub>n</sub>              | Cold                  | t ≤ 1h  | Non-tripping    | Current smoothly rises to specified value within 5s        |
| b    | B, C, D        | 1.45I <sub>n</sub>              | Following item a test | t < 1h  | Tripping        |  |
| c    | B, C, D        | 2.55I <sub>n</sub>              | Cold                  | 1s < t < 60s (I <sub>n</sub> ≤ 32A)<br>1s < t < 120s (I <sub>n</sub> > 32A) | Tripping        |  |
| d    | B              | 3I <sub>n</sub>                 | Cold                  | t ≤ 0.1s  | Non-tripping    | Switch on the power supply by closing the auxiliary switch |
|      | C              | 5I <sub>n</sub>                 |                       |   |                 |  |
| e    | D              | 10I <sub>n</sub>                | Cold                  | t < 0.1s  | Tripping        | Switch on the power supply by closing the auxiliary switch |
|      | B              | 5I <sub>n</sub>                 |                       |   |                 |  |
|      | C              | 10I <sub>n</sub>                |                       |   |                 |  |

Note: The term "cold" means that the test is carried out at a reference calibration temperature without load before the test.

## Tripping curves

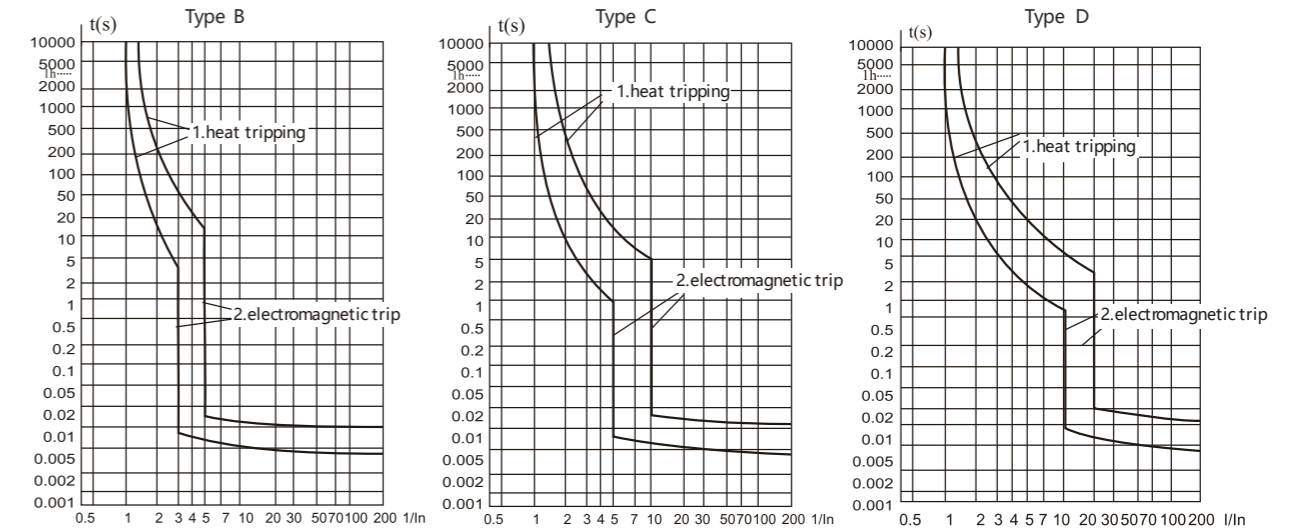

## Conductor requirements and cross section

| Copper cross-section(mm <sup>2</sup> ) | Rated current I <sub>n</sub> (A) |
|--|----------------------------------|
| 1                                      | I <sub>n</sub> ≤ 6               |
| 1.5                                    | 6 < I <sub>n</sub> ≤ 13          |
| 2.5                                    | 13 < I <sub>n</sub> ≤ 20         |
| 4                                      | 20 < I <sub>n</sub> ≤ 25         |
| 6                                      | 25 < I <sub>n</sub> ≤ 32         |
| 10                                     | 32 < I <sub>n</sub> ≤ 50         |
| 16                                     | 50 < I <sub>n</sub> ≤ 63         |

## Dimensions(mm)

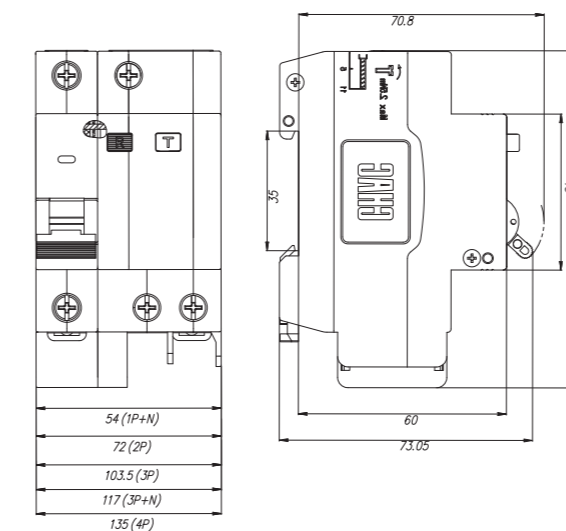

## Ordering Specification

Please specify the following when ordering:

- Product Model: CQB2HL-63
- Poles & Residual Operating Current: [e.g.: 2P / 30mA]
  - Number of Poles: 1P+N, 2P, 3P, 3P+N, 4P
  - Rated Residual Operating Current (I<sub>Δn</sub>): 30mA, 50mA, 100mA, 300mA
- Tripping Curve & Rated Current: [e.g.: C/32A]
  - Tripping Curve: B, C, D
  - Rated Current (I<sub>n</sub>): 6A, 10A, 16A, 20A, 25A, 32A, 40A, 50A, 63A
- Quantity: [e.g.: 100 pcs]

Ordering Example:

CQB2HL-63 2P C/32A 30mA 100 pcs