

# CHAC

## PXB9 Series Miniature Circuit Breaker

PRODUCT CATALOG



### ZHEJIANG CHUANGQI ELECTRIC CO.,LTD.

- WenzhouBase  
No.18,ShahongRoad,BeibaixiangTown,YueqingCity,Wenzhou,ZhejiangProvince,China
- JiaxingBase  
No.61,ZhengyangWestRoad,XiuzhouDistrict,Jiaxing,ZhejiangProvince,China
- 0577-27878806
- marketing@chac-en.com
- www.chac-electric.com



LINKEDIN



WEBSITE

V2026.03-CHAC-MKT

# PXB9-63

## Miniature Circuit Breaker



### Product Features

- High interruption rating capabilities
- Overload & short circuit protection
- Positive isolation
- Suitable for industrial, commercial, high-rise and civil residences circuit protection

### Type designation

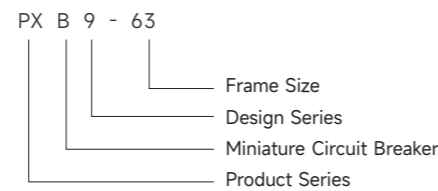

### Technical Specifications

Parameter	
Rated voltage	230V / 400V
Rated impulse withstand voltage (Uimp)	4000 V
Rated current	6A, 10A, 13A, 16A, 20A, 25A, 32A, 40A, 50A, 63A
Rated frequency	50 Hz / 60 Hz
Number of poles	1P, 2P, 3P, 4P
Rated breaking capacity (Icn/lcs)	6000 A
Mechanical life	10,000 operations
Electrical life	6,000 operations
Tripping characteristics	B, C, D
Pollution degree	2
Degree of protection	IP20
Standards	EN/IEC 60898-1, GB/T 10963.1
Tightening torque	3.5 N·m

### Tripping characteristics (Reference temp.30°C)

Item	Tripping Curve	Test current I <sub>n</sub> (A)	Initial Status	Time limit for tripping or non-tripping	Expected result	Remarks
a	B, C, D	1.13I <sub>n</sub>	Cold	t ≤ 1h	Non-tripping	Current smoothly rises to specified value within 5s
b	B, C, D	1.45I <sub>n</sub>	Following item a test	t < 1h	Tripping	
c	B, C, D	2.55I <sub>n</sub>	Cold	1s < t < 60s (I <sub>n</sub> ≤ 32A) 1s < t < 120s (I <sub>n</sub> > 32A)	Tripping	
d	B	3I <sub>n</sub>	Cold	t ≤ 0.1s	Non-tripping	Switch on the power supply by closing the auxiliary switch
	C	5I <sub>n</sub>				
e	B	5I <sub>n</sub>	Cold	t < 0.1s	Tripping	Switch on the power supply by closing the auxiliary switch
	C	10I <sub>n</sub>				
	D	20I <sub>n</sub>				

Note: The term "cold" means that the test is carried out at a reference calibration temperature without load before the test.

### Tripping Curve

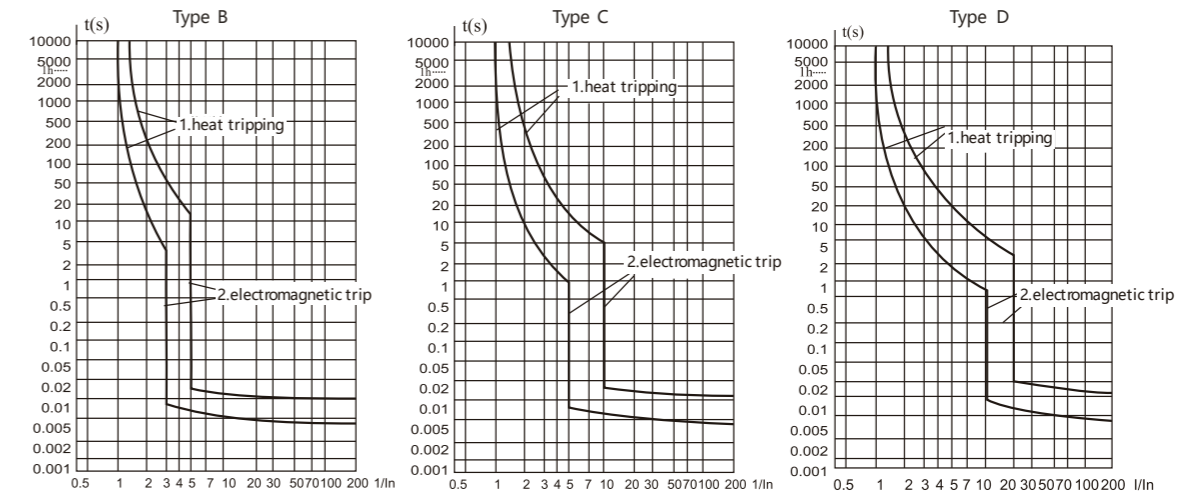

### Conductor requirements and cross section

Copper cross-section(mm <sup>2</sup> )	Rated current I <sub>n</sub> (A)
1	I <sub>n</sub> ≤ 6
1.5	6 < I <sub>n</sub> ≤ 13
2.5	13 < I <sub>n</sub> ≤ 20
4	20 < I <sub>n</sub> ≤ 25
6	25 < I <sub>n</sub> ≤ 32
10	32 < I <sub>n</sub> ≤ 50
16	50 < I <sub>n</sub> ≤ 63

### Dimensions(mm)

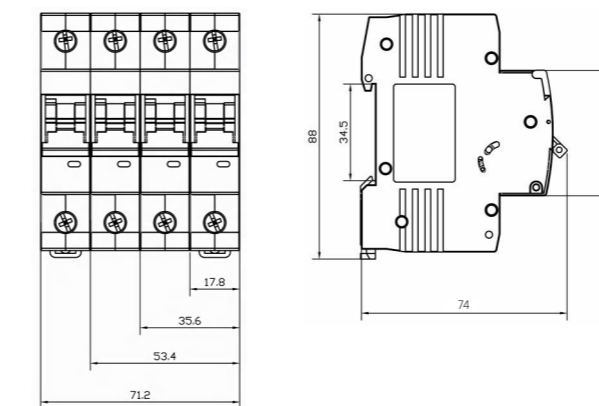

### Ordering Specification

Please specify the following when ordering:

- 1.Product Model: PXB9-63
  - 2.Number of Poles: 1P, 2P, 3P, 4P
  - 3.Rated Current & Tripping Curve: [e.g.: C/16A]
    - Tripping Curve: B, C, D
    - Rated Current (I<sub>n</sub>): 6A, 10A, 13A, 16A, 20A, 25A, 32A, 40A, 50A, 63A
  - 4.Quantity: [e.g.: 100 pcs]
- Ordering Example:  
PXB9-63 2P C/16A 100 pcs

# PXB9N-32

## Miniature Circuit Breaker



### Product Features

- Compact structure and robust design
- Low power consumption
- Easy DIN-Rail extraction
- Overload & short circuit protection
- Suitable for industrial, commercial, high-rise and civil residences circuit protection

### Type designation

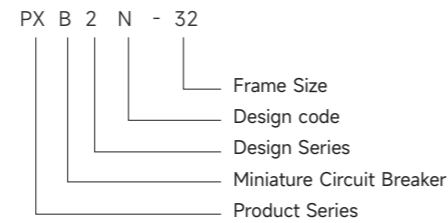

### Technical Specifications

Parameter	
Rated voltage	230V~
Rated impulse withstand voltage (Uimp)	4000 V
Rated current	6A, 10A, 13A, 16A, 20A, 25A, 32A
Rated frequency	50 Hz / 60 Hz
Number of poles	1P+N
Rated breaking capacity (Icn/Ics)	6000 A
Mechanical life	10,000 operations
Electrical life	4,000 operations
Tripping characteristics	B, C, D
Pollution degree	2
Degree of protection	IP20
Standards	EN/IEC 60898-1, GB/T 10963.1
Tightening torque	2 N·m

### Tripping characteristics (Reference temp.30°C)

Item	Tripping Curve	Test current I <sub>n</sub> (A)	Initial Status	Time limit for tripping or non-tripping	Expected result	Remarks
a	B, C, D	1.13I <sub>n</sub>	Cold	t ≤ 1h	Non-tripping	Current smoothly rises to specified value within 5s
b	B, C, D	1.45I <sub>n</sub>	Following item a test	t < 1h	Tripping	
c	B, C, D	2.55I <sub>n</sub>	Cold	1s < t < 60s (I <sub>n</sub> ≤ 32A) 1s < t < 120s (I <sub>n</sub> > 32A)	Tripping	
d	B	3I <sub>n</sub>	Cold	t ≤ 0.1s	Non-tripping	Switch on the power supply by closing the auxiliary switch
	C	5I <sub>n</sub>				
	D	10I <sub>n</sub>				
e	B	5I <sub>n</sub>	Cold	t < 0.1s	Tripping	Switch on the power supply by closing the auxiliary switch
	C	10I <sub>n</sub>				
	D	20I <sub>n</sub>				

Note: The term "cold" means that the test is carried out at a reference calibration temperature without load before the test.

### Tripping curves

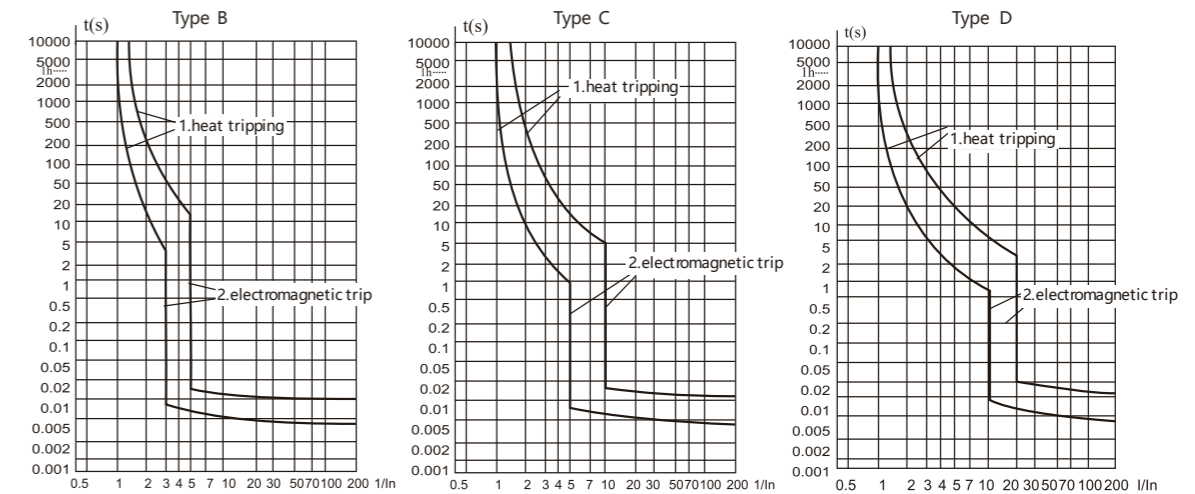

### Conductor requirements and cross section

Copper cross-section(mm <sup>2</sup> )	Rated current I <sub>n</sub> (A)
1	I <sub>n</sub> ≤ 6
1.5	6 < I <sub>n</sub> ≤ 13
2.5	13 < I <sub>n</sub> ≤ 20
4	20 < I <sub>n</sub> ≤ 25
6	25 < I <sub>n</sub> ≤ 32

### Dimensions(mm)

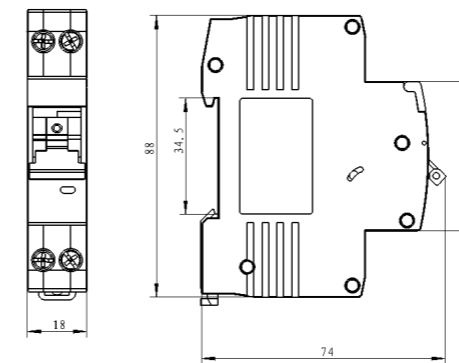

### Ordering Specification

Please specify the following when ordering:

- 1.Product Model: PXB9N-32
- 2.Number of Poles: 1P+N
- 3.Rated Current & Tripping Curve: [e.g.: C/16A]
  - Tripping Curve: B, C, D
  - Rated Current (I<sub>n</sub>): 6A, 10A, 13A, 16A, 20A, 25A, 32A

4.Quantity: [e.g.: 100 pcs]

Ordering Example:

PXB9N-32 1P+N C/16A 100 pcs

# PXB9L-40

## Residual Current Operated Circuit Breaker (Electromagnetic)

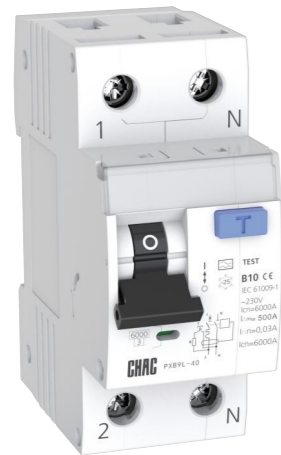

### Product Features

- Provides ground fault/leakage current, short circuit, overload protection and isolation.
- Provides additional protection against direct human contact.
- Effectively prevents electrical equipment insulation failure.
- Comprehensive protection for residential and commercial power distribution systems.

### Type designation

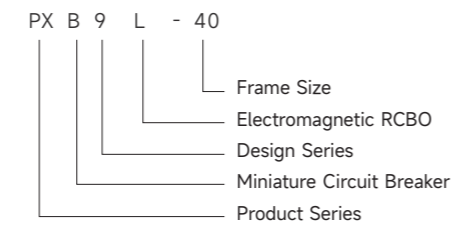

### Technical Specifications

Parameter	
Rated voltage	230 V
Rated current	6, 10, 13, 16, 20, 25, 32, 40 A
Rated frequency	50 Hz
Number of poles	1P+N
Rated breaking capacity (Icn/Ics)	6000 A
Mechanical life	10,000 operations
Electrical life	4,000 operations
Tripping characteristics	B, C, D
Type of residual current	AC, A
Rated residual operating current (IΔn)	30 mA
Rated residual making & breaking capacity (IΔm)	500 A
Pollution degree	2
Degree of protection	IP20
Standards	EN/IEC 61009-1, GB/T 16917.1
Tightening torque	3.5 N·m

### Tripping characteristics (Reference temp.30°C)

Item	Tripping Curve	Test current I <sub>n</sub> (A)	Initial Status	Time limit for tripping or non-tripping	Expected result	Remarks
a	B, C, D	1.13I <sub>n</sub>	Cold	t ≤ 1h	Non-tripping	Current smoothly rises to specified value within 5s
b	B, C, D	1.45I <sub>n</sub>	Following item a test	t < 1h	Tripping	
c	B, C, D	2.55I <sub>n</sub>	Cold	1s < t < 60s (I <sub>n</sub> ≤ 32A) 1s < t < 120s (I <sub>n</sub> > 32A)	Tripping	
d	B	3I <sub>n</sub>	Cold	t ≤ 0.1s	Non-tripping	Switch on the power supply by closing the auxiliary switch
	C	5I <sub>n</sub>				
e	D	10I <sub>n</sub>	Cold	t < 0.1s	Tripping	Switch on the power supply by closing the auxiliary switch
	B	5I <sub>n</sub>				
	C	10I <sub>n</sub>				
	D	20I <sub>n</sub>				

Note: The term "cold" means that the test is carried out at a reference calibration temperature without load before the test.

### Tripping curves

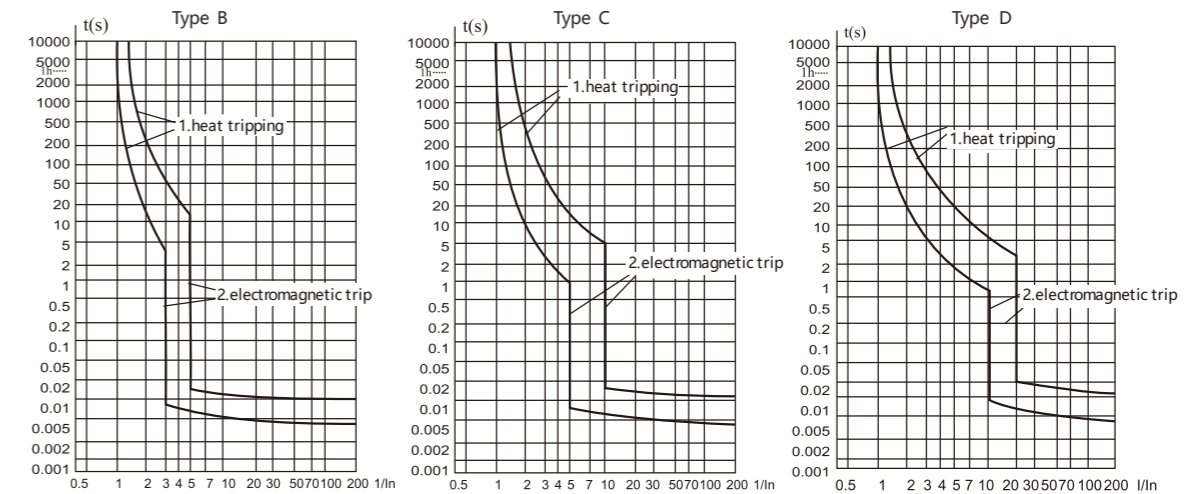

### Conductor requirements and cross section

Copper cross-section(mm <sup>2</sup> )	Rated current I <sub>n</sub> (A)
1	I <sub>n</sub> ≤ 6
1.5	6 < I <sub>n</sub> ≤ 13
2.5	13 < I <sub>n</sub> ≤ 20
4	20 < I <sub>n</sub> ≤ 25
6	25 < I <sub>n</sub> ≤ 32
10	32 < I <sub>n</sub> ≤ 40

### Dimensions(mm)

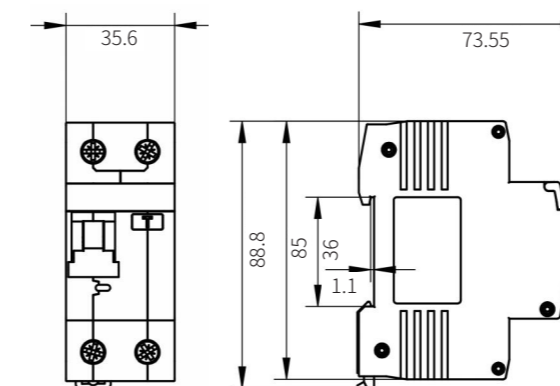

### Ordering Specification

Please specify the following when ordering:

- 1.Product Model: PXB9L-40
- 2.Number of Poles: 1P+N
- 3.Rated Current & Tripping Curve: [e.g.: C/16A]
  - Tripping Curve: B, C, D
  - Rated Current (I<sub>n</sub>): 6A, 10A, 13A, 16A, 20A, 25A, 32A, 40A
- 4.Type of Residual Current: AC, A
- 5.Rated Residual Operating Current (I<sub>Δn</sub>): [e.g.: 30mA]
  - Available Options: 30mA, 100mA, 300mA
- 6.Quantity: [e.g.: 100 pcs]

Ordering Example:

PXB9L-40 1P+N C/16A AC 30mA 100 pcs

# PXL9-63

## Residual Current Circuit Breaker (Electromagnetic)



### Product Features

- Used in housing, tertiary sector and industry.
- Control electric circuits.
- Protect people against indirect contacts and additional protection against direct contacts.
- Protect installations against fire hazard due to insulation faults.
- Wide variety of rated tripping currents.

### Type designation

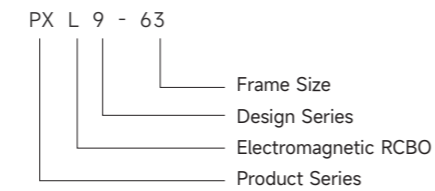

### Technical Specifications

Parameter	
Rated voltage $U_e$	230V/400V
Rated current(A)	6、10、16、20、25、32、40、50、63
Rated insulation voltage( $U_i$ )	500V
Rated frequency	50Hz/60Hz
Number of poles	2P、4P
Rated limited short-circuit current $I_{nc}(A)$	6000
Rated limited residual short-circuit current $I_{\Delta c}(A)$	6000
Mechanical&Electrical life	4000
Rated residual operating current $I_{\Delta n}(mA)$	30、100、300
Pollution degree	2
Protection degree	IP20
Standards	EN/IEC61008-1、GB/T16916.1
Tighten torque(Nm)	2.5
Rated impulse withstand voltage( $U_{imp}$ )	4000V
Type of residual current	AC、A、B、S、G
Rated making&breaking capacity $I_m(A)$	500A or $10I_n$ (Take the maximumvalue)
Rated residual making&breaking capacity $I_{\Delta m}(A)$	500A or $10I_n$ (Take the maximumvalue)

### Dimensions(mm)

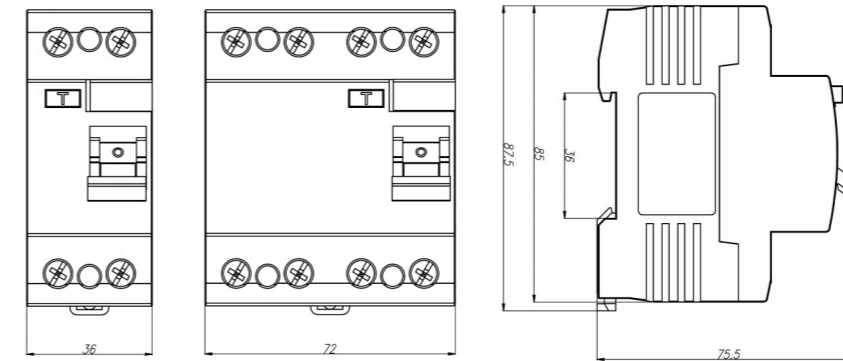

### Ordering Specification

Please specify the following when ordering:

- 1.Product Model: PXL9-63
- 2.Number of Poles: 2P, 4P
- 3.Rated Current ( $I_n$ ): [e.g.: 32A]
  - Available Currents: 6A, 10A, 16A, 20A, 25A, 32A, 40A, 50A, 63A
- 4.Type of Residual Current: AC, A, B, S, G
- 5.Rated Residual Operating Current ( $I_{\Delta n}$ ): [e.g.: 30mA]
  - Available Options: 30mA, 100mA, 300mA
- 6.Quantity: [e.g.: 100 pcs]

Ordering Example:

PXL9-63 2P 32A AC 30mA 100 pcs

# CQB7DC-63

## DC Miniature Circuit Breaker



### Product Features

- DC Specialized Design  
Specifically designed for DC circuits with rated working voltage up to 1000V, suitable for various DC power distribution systems
- High Breaking Capacity  
Rated short-circuit breaking capacity of 6kA, providing reliable overload and short-circuit protection
- Communication Industry Application  
Specially suitable for power distribution systems in communication industry main cabinets, power cabinets, distribution cabinets, and outdoor cabinets

### Type designation

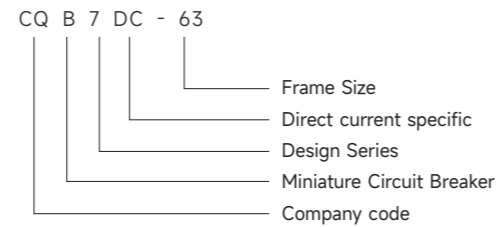

### Tripping curves

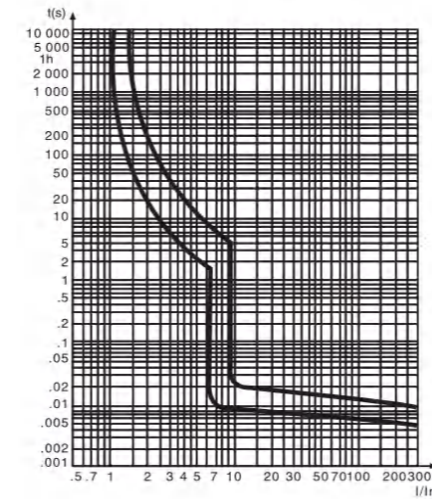

### Dimensions(mm)

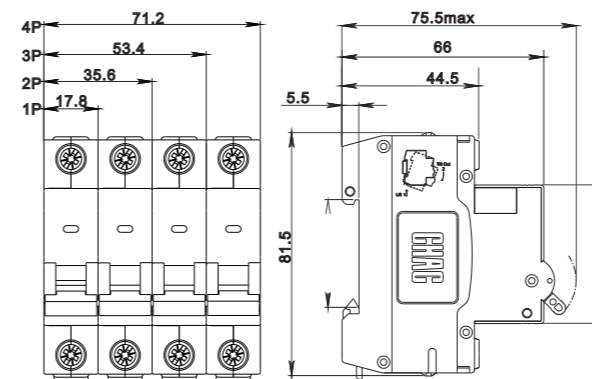

### Ordering Specification

Please specify the following when ordering:

- Product Model: CQB7DC-63
  - Number of Poles: 1P, 2P, 3P, 4P
  - Rated Current & Tripping Curve: [e.g.: C/32A]
    - Tripping Curve: B, C, D
    - Available Currents: 6A, 10A, 13A, 16A, 20A, 25A, 32A, 40A, 50A, 63A
  - Quantity: [e.g.: 100 pcs]
- Ordering Example:  
CQB7DC-63 2P C/32A 100 pcs

### Technical Specifications

Parameter	
Rated voltage	1P, 2P, 3P, 4P
Rated current	6A, 10A, 13A, 16A, 20A, 25A, 32A, 40A, 50A, 63A
Rated insulation voltage	DC 1000 V
Ultimate breaking capacity (Icu)	6 kA
Operational breaking capacity (Ics)	6 kA
Tripping curves	Type B (4In±20%), Type C (8In±20%)
Mechanical life	10,000 operations
Electrical life	1,500 operations
Wiring capacity	≤ 25 mm <sup>2</sup>
Tightening torque	3.0 N·m
Degree of protection	IP20
Standards	GB/T 14048.2
Certification	CCC

### Tripping characteristics (Reference temp.30°C)

Item	Tripping Curve	Test current In(A)	Initial Status	Time limit for tripping or non-tripping	Expected result	Remarks
a	C	1.05In	Cold	t ≤ 1h	Non-tripping	
b	C	1.3In	Following item a test	t < 1h	Tripping	Current smoothly rises to specified value within 5s
c	C	2.55In	Cold	1s < t < 60s (In ≤ 32A) 1s < t < 120s (In > 32A)	Tripping	
d	C	5In	Cold	t ≤ 0.1s	Non-tripping	Switch on the power supply by closing the auxiliary switch
e	C	10In	Cold	t < 0.1s	Tripping	Switch on the power supply by closing the auxiliary switch

Note: The term "cold" means that the test is carried out at a reference calibration temperature without load before the test.

# CQB7ZNM-80

## Miniature Circuit Breaker



### Product Features

- Smart Remote Control  
Mobile control via Smart Life/Tuya Smart App for remote circuit management
- Precision Power Monitoring  
0.5S class metering accuracy for real-time voltage, current, and power monitoring
- Multi-Protection Function  
8 safety protections including overload, short-circuit, leakage, over/under voltage, and over-temperature
- Intelligent Timing Setting  
Daily/weekly/monthly timer settings for automated power management

### Type designation

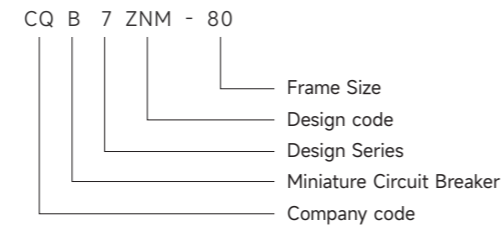

### Tripping curves

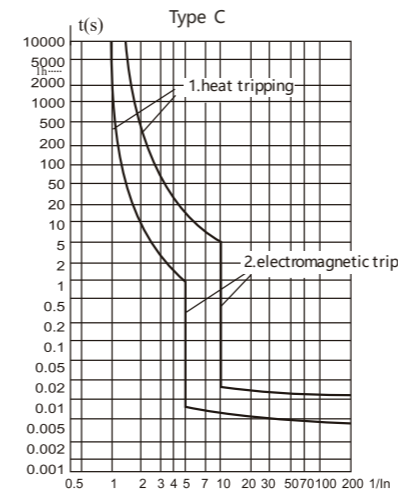

### Technical Specifications

Parameter	
Number of poles	1P+N
Communication mode	Wi-Fi
Degree of protection (IP)	IP20
Application for mobile devices	Smart Life/Tuya Smart
Rated current I <sub>n</sub>	32A/ 40A/63A/ 80A
Types of RCD	AC type
Tripping characteristic	C
Frequency	50 Hz
Rated voltage	1P+N: 230 /240V
Complies with standard	IEC 61009-1、 IEC 60898-1
Rated short circuit breaking capacity I <sub>cn</sub>	6 kA
Mechanical service life	10000 Times
Electrical service life	6000 Times
Dimension	1P+N (L*H*W:90*72*53 mm)

### Tripping characteristics (Reference temp.30°C)

Item	Test current I <sub>n</sub> (A)	Initial Status	Time limit for tripping or non-tripping	Expected result	Remarks
a	1.13I <sub>n</sub>	Cold	t ≤ 1h (I <sub>n</sub> ≤ 63A) t ≤ 2h (I <sub>n</sub> > 63A)	Non-tripping	
b	1.45I <sub>n</sub>	Following item a test	t < 1h (I <sub>n</sub> ≤ 63A) t < 2h (I <sub>n</sub> > 63A)	Tripping	Current smoothly rises to specified value within 5s
c	2.55I <sub>n</sub>	Cold	1s < t < 120s	Tripping	
d	5I <sub>n</sub>	Cold	t ≤ 0.1s	Non-tripping	Switch on the power supply by closing the auxiliary switch
e	10I <sub>n</sub>	Cold	t < 0.1s	Tripping	Switch on the power supply by closing the auxiliary switch

Note: The term "cold" means that the test is carried out at a reference calibration temperature without load before the test.

### Dimensions(mm)

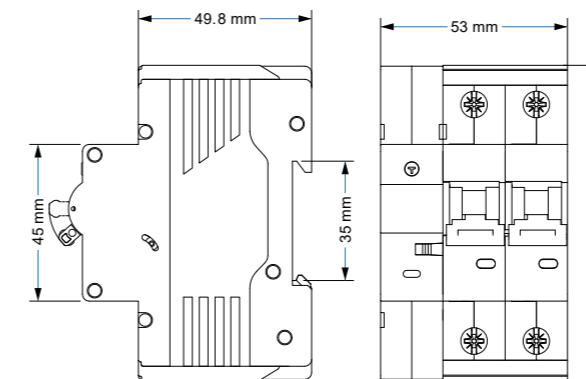

### Ordering Specification

Please specify the following when ordering:

- 1.Product Model: CQB7ZNM-80
- 2.Number of Poles: 1P+N
- 3.Rated Current: [e.g.: 32A]
  - Available Currents: 32A, 40A, 63A, 80A
- 4.Quantity: [e.g.: 100 pcs]

Ordering Example:

CQB7ZNM-80 1P+N Wi-Fi 32A AC type 100 pcs

# CQB71R-100

## External Circuit-Breaker For Electricity Meters



### Product Features

- Designed for electricity meters
- Enables remote automatic control
- High breaking capacity
- Overload & short circuit protection

### Type designation

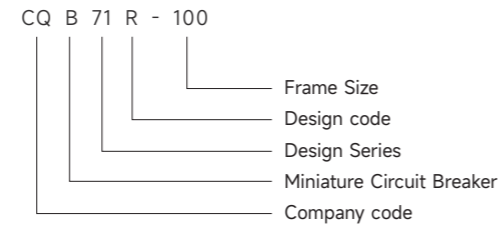

### Technical Specifications

Parameter	
Rated voltage (V)	230V
Rated current (A)	40, 63, 80, 100
Rated impulse withstand voltage Uimp(V)	6000V
Rated frequency	50Hz / 60Hz
Polar number	1P+N
Rated short-circuit capacity Icn(A)	6kA
Operating short-circuit capacity Ics(A)	6kA
Mechanical and electrical life (times)	Mechanical life ≥ 10,000, electrical life ≥ 6,000
Instantaneous tripping type	B, C, D
Tightening torque (N·m)	2.5
Automatic closing time (tc)	t ≤ 3s
Automatic opening time (td)	t ≤ 2s
Pollution level	Level 2
Protection grade	IP20
Installation category	III
Meet the standards	IEC60898-1, GB/T 10963-1
Certification	CCC

### Tripping characteristics (Reference temperature 30°C)

Item	Tripping Curve	Test current In(A)	Initial Status	Time limit for tripping or non-tripping	Expected result	Remarks
a	B, C, D	1.13In	Cold	t ≤ 1h	Non-tripping	Current smoothly rises to specified value within 5s
b	B, C, D	1.45In	Following item a test	t < 1h	Tripping	
c	B, C, D	2.55In	Cold	1s < t < 60s (In ≤ 32A) 1s < t < 120s (In > 32A)	Tripping	
d	B	3In	Cold	t ≤ 0.1s	Non-tripping	Switch on the power supply by closing the auxiliary switch
	C	5In				
	D	10In				
e	B	5In	Cold	t < 0.1s	Tripping	Switch on the power supply by closing the auxiliary switch
	C	10In				
	D	20In				

Note: The term "cold" means that the test is carried out at a reference calibration temperature without load before the test.

### Tripping curves

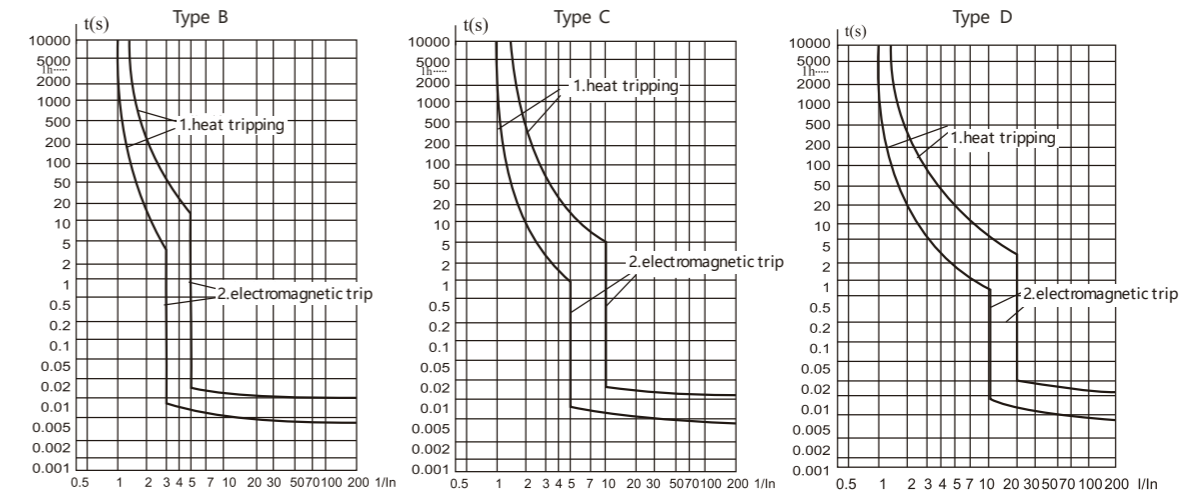

### Conductor requirements and cross section

Copper cross-section(mm <sup>2</sup> )	Rated current In(A)
10	32 < In ≤ 50
16	50 < In ≤ 63
25	63 < In ≤ 80
35	80 < In ≤ 100
50	100 < In ≤ 125

### Dimensions(mm)

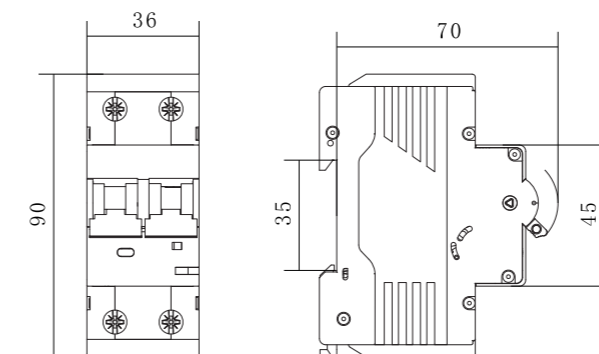

### Ordering Specification

Please specify the following when ordering:

- 1.Product Model: CQB71R-100
- 2.Number of Poles: 1P+N
- 3.Rated Current & Tripping Curve: [e.g.: C/63A]
  - Tripping Curve: B, C, D
  - Rated Current: 40A, 63A, 80A, 100A
- 4.Quantity: [e.g.: 100 pcs]

Ordering Example:

CQB71R-100 1P+N C/63A 100 pcs

# CQB7R-125

## Prepayment Meter External Circuit Breaker



### Product Features

- Intelligent automatic control
- Designed for prepayment meters
- Automatic tripping and closing
- Overload & short circuit protection

### Type designation

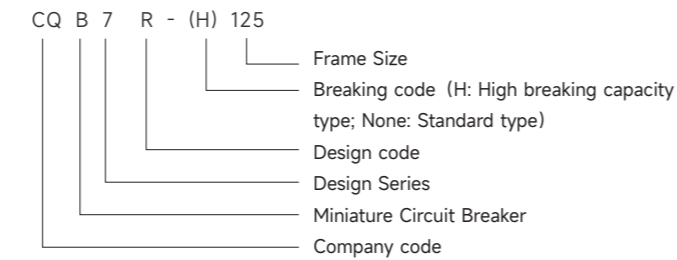

### Technical Specifications

Parameter	
Rated voltage (V)	30V~(2P), 400V~ (4P)
Rated current (A)	40, 50, 63, 80, 100, 125
Rated impulse withstand voltage Uimp(V)	6000V
Rated frequency	50Hz / 60Hz
Polar number	2P, 4P
Rated short-circuit capacity Icn(A)	6kA, 10kA (high breaking score)
Operating short-circuit capacity Ics(A)	6kA, 7.5kA (high break type)
Mechanical and electrical life (times)	Mechanical life ≥ 10,000, electrical life ≥ 6,000
Instantaneous tripping type	B, C, D
Tightening torque (N·m)	3.5
Automatic closing time (tc)	t ≤ 3s
Automatic opening time (td)	t ≤ 2s
Pollution level	Level 2
Protection grade	IP20
Installation category	III
Meet the standards	IEC60898-1, GB10963-1
Certification	CCC

### Tripping characteristics (Reference temperature 30°C)

Item	Tripping Curve	Test current In(A)	Initial Status	Time limit for tripping or non-tripping	Expected result	Remarks
a	B, C, D	1.13In	Cold	t ≤ 1h	Non-tripping	Current smoothly rises to specified value within 5s
b	B, C, D	1.45In	Following item a test	t < 1h	Tripping	
c	B, C, D	2.55In	Cold	1s < t < 60s (In ≤ 32A) 1s < t < 120s (In > 32A)	Tripping	
d	B	3In	Cold	t ≤ 0.1s	Non-tripping	Switch on the power supply by closing the auxiliary switch
	C	5In				
	D	10In				
e	B	5In	Cold	t < 0.1s	Tripping	Switch on the power supply by closing the auxiliary switch
	C	10In				
	D	20In				

Note: The term "cold" means that the test is carried out at a reference calibration temperature without load before the test.

### Tripping curves

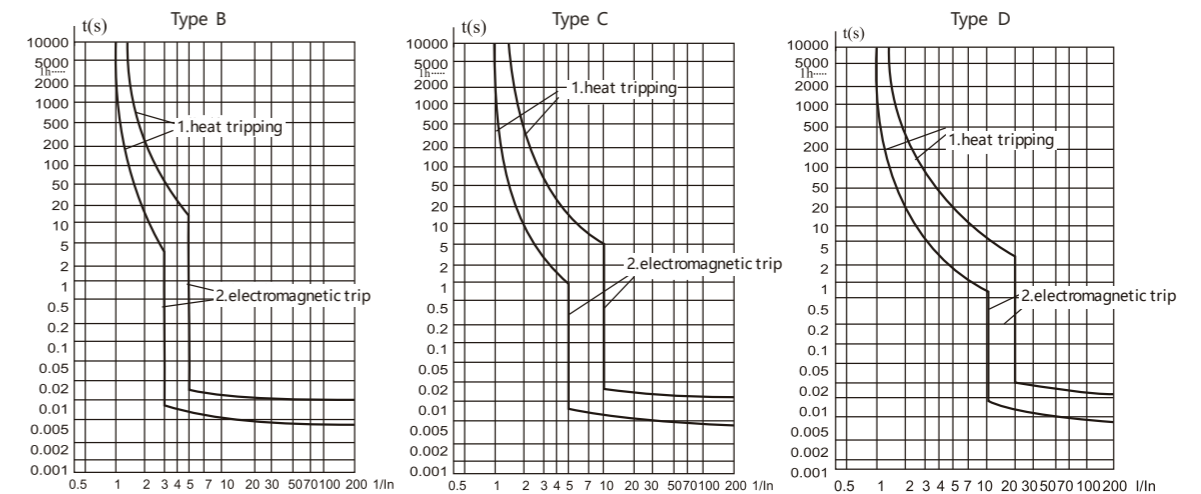

### Conductor requirements and cross section

Copper cross-section(mm <sup>2</sup> )	Rated current In(A)
10	32 < In ≤ 50
16	50 < In ≤ 63
25	63 < In ≤ 80
35	80 < In ≤ 100
50	100 < In ≤ 125

### Dimensions(mm)

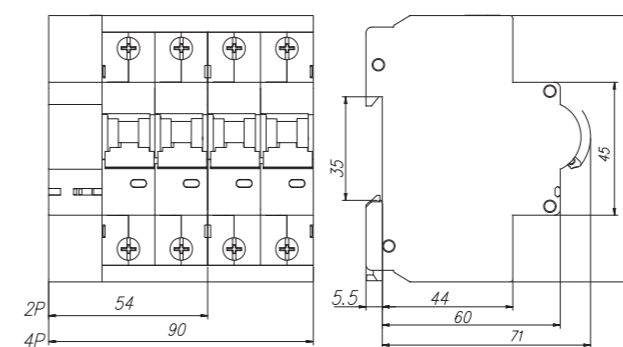

### Ordering Specification

Please specify the following when ordering:

- 1.Product Model: CQB7R-125
- 2.Number of Poles: 2P, 4P
- 3.Rated Current & Tripping Curve: [e.g.: C/100A]
  - Tripping Curve: B, C, D
  - Rated Current: 40A, 50A, 63A, 80A, 100A, 125A
- 4.Quantity: [e.g.: 100 pcs]

Ordering Example:

CQB7R-125 2P C/100A 100 pcs