

# CHAC

## CQC6 Series AC Contactor

PRODUCT CATALOG

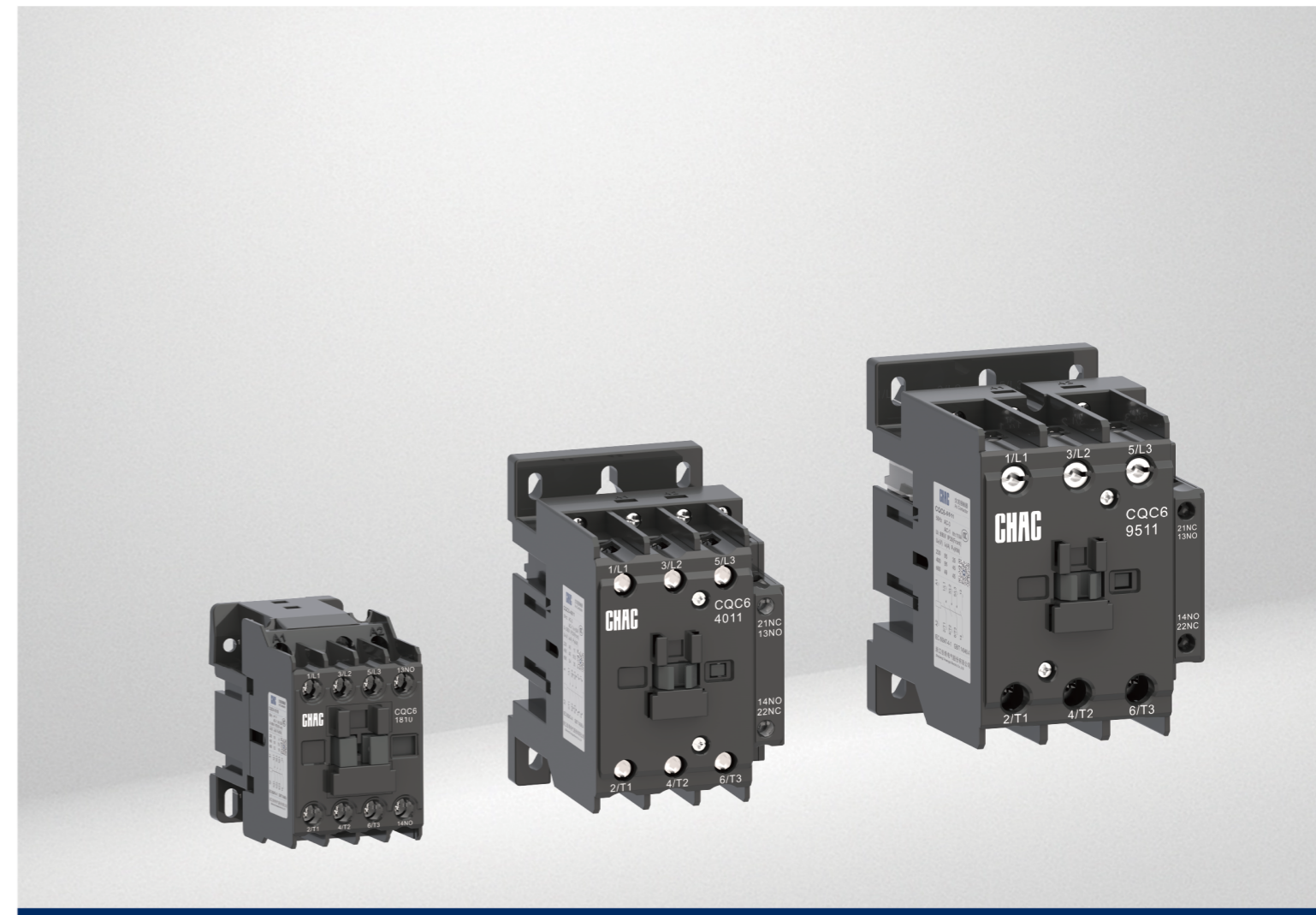

### ZHEJIANG CHUANGQI ELECTRIC CO.,LTD.

- 🏠 Wenzhou Base  
No. 18, Shahong Road, Beibaixiang Town, Yueqing City, Wenzhou, Zhejiang Province, China
- 🏠 Jiaxing Base  
No. 61, Zhengyang West Road, Xiuzhou District, Jiaxing, Zhejiang Province, China
- ☎ 0577-27878806
- ✉ marketing@chac-en.com
- 🌐 www.chac-electric.com



LINKEDIN



WEBSITE

V2026.04-CHAC-MKT

# CQC6 Series

## AC contactor



### Key Specifications & Applications

- For 50Hz systems up to 690V, 95A rated current (AC-3, 380V).
- Remote circuit switching for resistive, inductive, and capacitive loads.
- It can be combined with thermal relays to form electromagnetic starters, providing reliable protection for circuits susceptible to overloads.
- Its primary function is to make and break circuits remotely, and it is suitable for resistive, inductive, and capacitive loads.

### Main Technical Features

- Compact size, light weight, low power consumption, and long service life
- Easily expanded with auxiliary contacts, timers, or combined with thermal relays.
- Supports both screw and standard DIN rail mounting (Models 06-38: 35mm; Models 40-95: 35/75mm).
- Unibody cover for easy maintenance

### Standard Operating and Installation Conditions

- Ambient Temperature: -5°C to +40°C (Range: -35°C to +70°C)
- Altitude: ≤2000m
- Protection Rating: IP20
- Pollution Degree: 3
- Installation Category: III

### Technical Specifications

Model number	CQC6-06	CQC6-09	CQC6-12	CQC6-18	CQC6-25	CQC6-32	CQC6-38	CQC6-40	CQC6-50	CQC6-65	CQC6-80	CQC6-95	
Rated insulation voltage (Ui)	690V												
Rated impulse withstand voltage (Uimp)	8kV												
Rated frequency	50Hz,50/60Hz												
Number of poles (P)	3												
Rated Operational Current (A) - AC-3	220V/230V	6	9	12	18	25	32	38	40	50	65	80	95
	380V/400V	6	9	12	18	25	32	38	40	50	65	80	95
	660V/690V	4.8	6.6	8.9	12	18	20.2	20.2	34	39	42	49	49
Conventional Free-Air Thermal Current (A) (AC-1, θ ≤ 60°C)	20	25	25	32	40	50	50	60	80	80	110	110	
Short-Time Withstand Current (A)	10s	80	105	105	145	145	260	310	320	400	520	640	800
	1min	45	61	61	84	84	138	150	165	208	260	320	400
	10min	20	30	30	40	40	60	60	72	84	110	135	135
Controlled 3-Phase Squirrel Cage Motor Power (kW) - AC-3	220V/230V	1.5	2	3.5	4	6	7.5	9	11	15	18.5	22	25
	380V/400V	2.2	4	5.5	7.5	11	15	18.5	18.5	22	30	37	45
	660V/690V	3	5.5	7.5	10	15	18.5	18.5	30	33	37	45	45
Short-circuit protection by gG fuses (U ≤ 690V) for Type 2 coordination, without integral thermal overload relay	20	25	25	32	40	50	50	60	80	80	110	110	
Electrical Endurance (10 <sup>4</sup> operations)	120			100				80					
Rated Making Capacity (AC-3)	10 × Ie, in accordance with IEC 60947-4-1 and GB/T 14048.4.												
Rated Breaking Capacity (AC-3)	8 × Ie, in accordance with IEC 60947-4-1 and GB/T 14048.4.												
Characteristics of AC controlcircuits													
Operating Frequency (operations/h)	1200						600						
Mechanical Life (10 <sup>4</sup> operations, 3600 ops/h)	1200			1000			800			600			
	AC Coil Power (50/60Hz)	Pick-up (VA)	70	110	200	200	8	11	20	20			
Operate Time (ms)	Close	12-22			12-22			20-35			20-35		
	Open	4-19			4-19			6-15			6-15		
Operate Voltage Range (50/60Hz)	Pick-up Voltage: 80%Us ~ 110%Us; Drop-out Voltage: 20%Us ~ 75%Us												
Rated Control Supply Voltage Us	AC 24/36/48/110/220/230/380/400/415/440V, 50/60Hz												
Applicable accessories	Auxiliary contact block	●	●	●	●	●	●	●	●	●	●	●	●
	Coil surge absorber	●	●	●	●	●	●	●	●	●	●	●	●
	Main circuit conductor	●	●	●	●	●	●	●	●	●	●	●	●
	Mechanical interlock	●	●	●	●	●	●	●	●	●	●	●	●
	Mechano-electrical interlock	●	●	●	●	●	●	●	●	●	●	●	●
DIN rail mounting	●	●	●	●	●	●	●	●	●	●	●	●	
Certifications obtained	CCC CE CB												

### Type designation

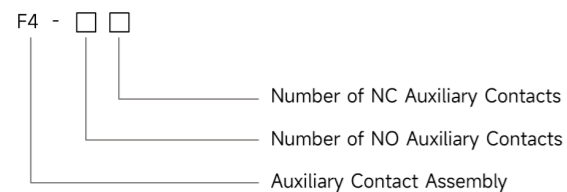
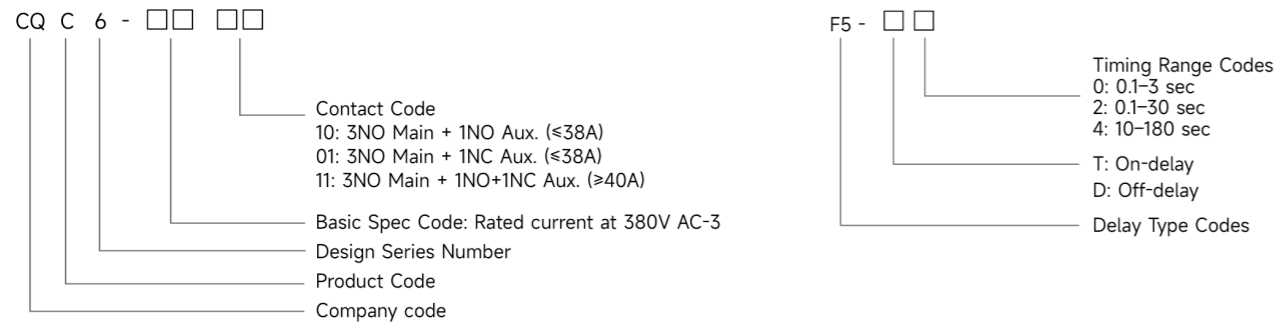

Dimensions (mm)

CQC6-06-25

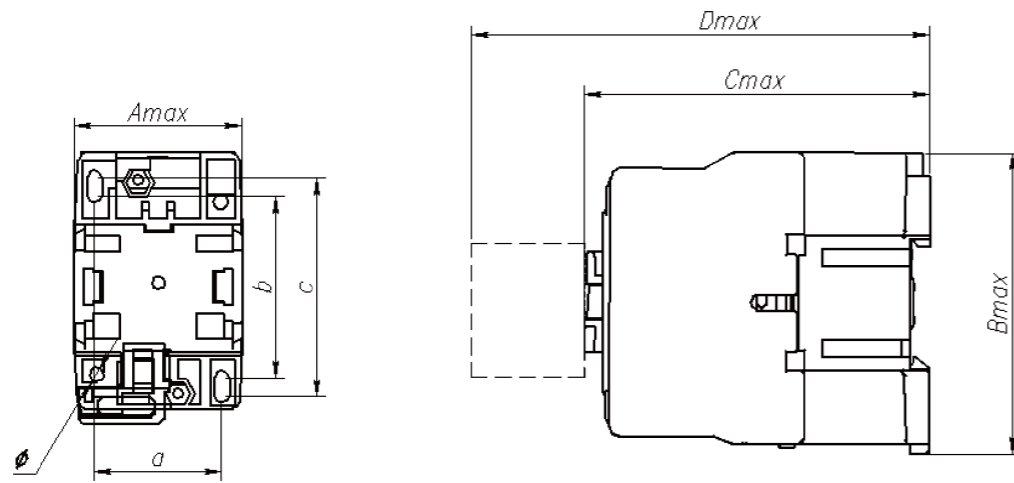

CQC6-40-95

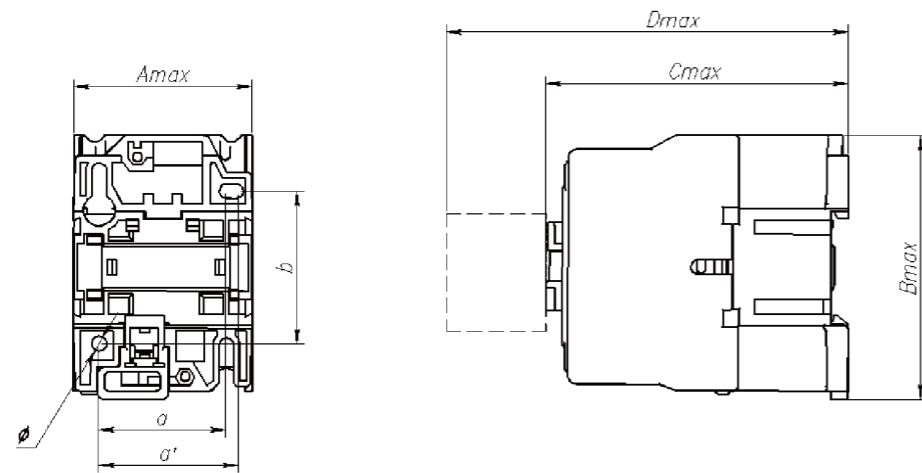
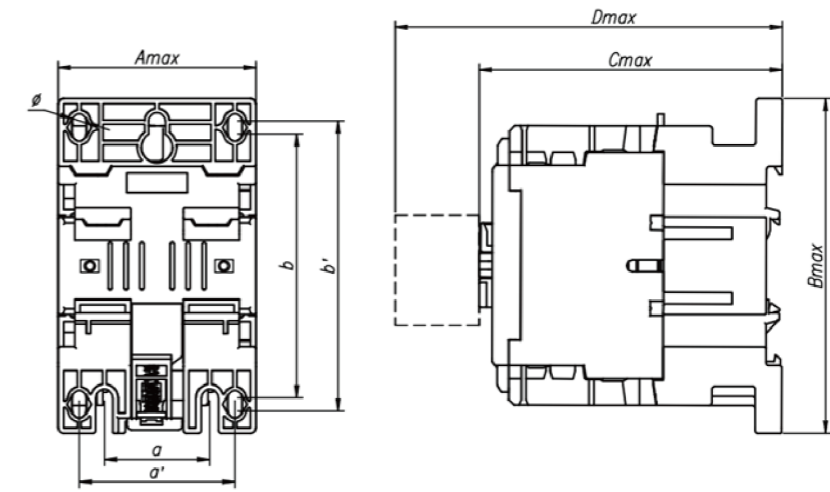

Model number	$A_{max}$	$B_{max}$	$C_{max}$	$D_{max}$	$a/a'$	$b$	$c$	$\phi$
CQC6-06-25	46	76	83	117	35	50	60	$\phi 4.5$
CQC6-32-38	57	85	96	130	40/43	48	/	$\phi 4.5$
CQC6-40-65	76	128	115	149	40/59	100	110	$\phi 5.5$
CQC6-80-95	85	128	124	158	40/67	100	110	$\phi 5.5$

Accessories Description

Contact Configuration

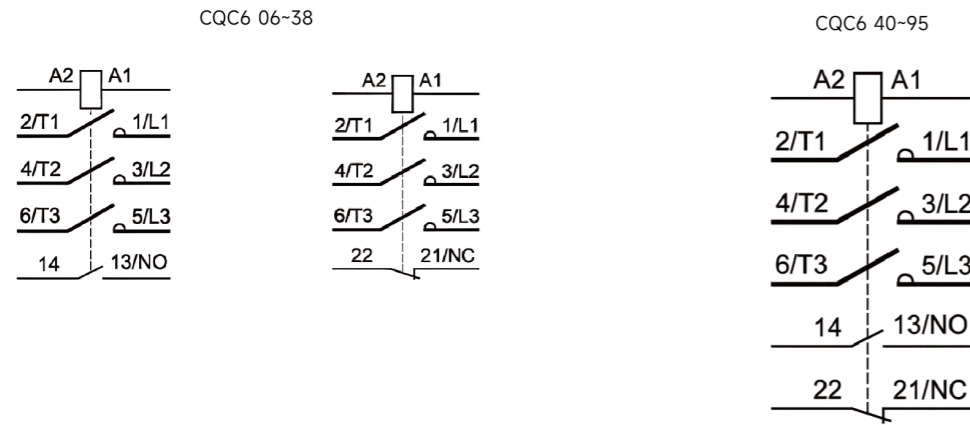

Main Circuit Conductor (Busbar)

Product Model	Upper Conductor			Lower Conductor			Conductor Dmax	Applicable Models
	Amax	Bmax	Cmax	Amax	Bmax	Cmax		
F1-H1	88	24	28	88	17	28	2.5mm <sup>2</sup>	CQC6-06/18
F1-H2	103	29	33	103	20	35	6mm <sup>2</sup>	CQC6-25/38
F1-H3	134	43	55	134	30	50	10mm <sup>2</sup>	CQC6-40/65
F1-H4	150	52	51	150	37	50	16mm <sup>2</sup>	CQC5-80/95

Installation Method & Dimension Diagram (Upper Conductor)

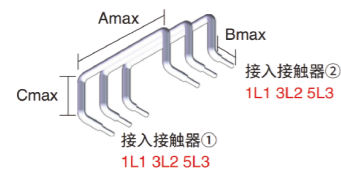

Installation Method & Dimension Diagram (Lower Conductor)

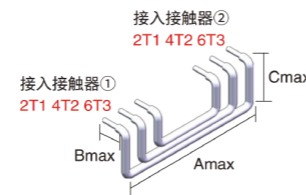

Electrical/Mechanical Interlock

Product Name	Content	Product Model	Applicable Models	Wiring Diagram (ME)
Electrical Interlock	Electrical Interlock Kit	F2-LS3	CQC6-06-38	
	Electrical Interlock Kit	F2-LS4	CQC6-40-95	
Mechanical Interlock	Mechanical Interlock Kit	F2-LS1	CQC6-06-38	
	Mechanical Interlock Kit	F2-LS2	CQC6-40-95	

Component size diagram (mm)

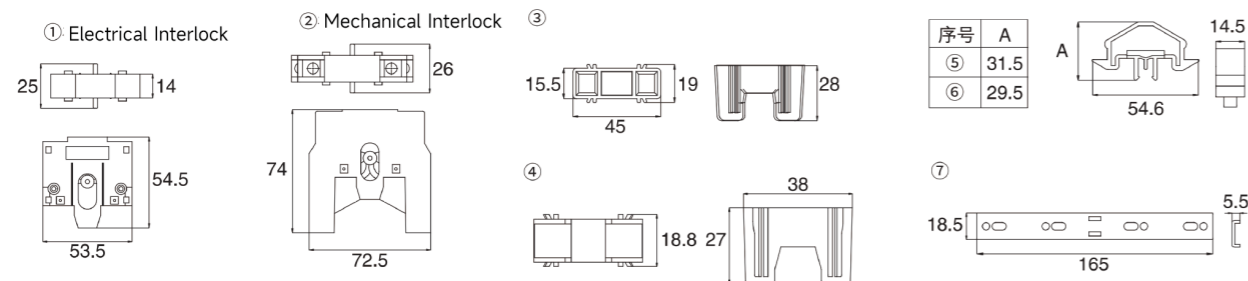

RC Snubber (Coil Surge Suppression)

Product Model	Content	Applicable Models	Dimensions (mm)
F3-LY2EA	AC 24...48V	CQC6-06-38	
F3-LY2GA	AC 50...127V		
F3-LY2UA	AC 110...240V		
F3-LY2NA	AC 380...415V	CQC6-40-95	
F3-LY2FC	AC 24...48V		
F3-LY2GC	AC 50...127V		
F3-LY2UC	AC 110...240V		
F3-LY2NC	AC 380...415V		

Auxiliary Contacts

Product Name	Product Model	Content	Applicable Models	Dimensions (mm)
Top-Mounted Auxiliary (2 Contacts)	F4-11	1NO + 1NC	CQC6-06-95	
	F4-20	2NO		
	F4-02	2NC		
Top-Mounted Auxiliary (4 Contacts)	F4-22	2NO + 2NC		
	F4-40	4NO		
	F4-04	4NC		
	F4-13	1NO + 3NC		
	F4-31	3NO + 1NC		

Electrical Parameters	Utilization Category	Rated Operational Voltage (V)	Rated Operational Current (A)
Conventional Thermal Current I <sub>th</sub>	AC-15	380	0.95
Rated Insulation Voltage U <sub>i</sub>		220	1.6
Rated Impulse Withstand Voltage U <sub>imp</sub>	DC-13	220	0.15
Minimum Switchable Load		6V 100mA	

On-Delay Timer (Timer Head)

Product Model	Content	Applicable Models
F5-T0	0.1...3s	CQC6-06-95
F5-T2	0.1...30s	
F5-T4	10...180s	
F5-S2	1...30s	
F5-D0	0.1...3s	
F5-D2	0.1...30s	
F5-D4	10...180s	

Side-Mounted Auxiliary

Product Model	Content	Applicable Models
F8-11	1NO + 1NC	CQC6-06-95
F8-20	2NO	
F8-02	2NC	