

CHAC

PXB9 Series Miniature Circuit Breaker

PRODUCT CATALOG



ZHEJIANG CHUANGQI ELECTRIC CO.,LTD.

- 🏠 Wenzhou Base
No. 18, Shahong Road, Beibaixiang Town, Yueqing City, Wenzhou, Zhejiang Province, China
- 🏠 Jiaxing Base
No. 61, Zhengyang West Road, Xiuzhou District, Jiaxing, Zhejiang Province, China
- ☎ 0577-27878806
- ✉ marketing@chac-en.com
- 🌐 www.chac-electric.com



LINKEDIN



WEBSITE

V2026.04-CHAC-MKT

PXB9-63

Miniature Circuit Breaker



Product Features

- High interruption rating capabilities
- Overload & short circuit protection
- Positive isolation
- Suitable for industrial, commercial, high-rise and civil residences circuit protection

Type designation

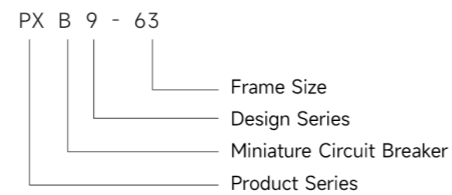

Technical Specifications

Parameter	
Rated voltage	230V / 400V
Rated impulse withstand voltage (Uimp)	4000 V
Rated current	6A, 10A, 13A, 16A, 20A, 25A, 32A, 40A, 50A, 63A
Rated frequency	50 Hz / 60 Hz
Number of poles	1P, 2P, 3P, 4P
Rated breaking capacity (Icn/Ics)	6000 A
Mechanical life	10,000 operations
Electrical life	6,000 operations
Tripping characteristics	B, C, D
Pollution degree	2
Degree of protection	IP20
Standards	EN/IEC 60898-1, GB/T 10963.1
Tightening torque	3.5 N·m

Tripping characteristics (Reference temp.30°C)

Item	Tripping Curve	Test current I _n (A)	Initial Status	Time limit for tripping or non-tripping	Expected result	Remarks
a	B, C, D	1.13I _n	Cold	t ≤ 1h	Non-tripping	Current smoothly rises to specified value within 5s
b	B, C, D	1.45I _n	Following item a test	t < 1h	Tripping	
c	B, C, D	2.55I _n	Cold	1s < t < 60s (I _n ≤ 32A) 1s < t < 120s (I _n > 32A)	Tripping	
d	B	3I _n	Cold	t ≤ 0.1s	Non-tripping	Switch on the power supply by closing the auxiliary switch
	C	5I _n				
	D	10I _n				
e	B	5I _n	Cold	t < 0.1s	Tripping	Switch on the power supply by closing the auxiliary switch
	C	10I _n				
	D	20I _n				

Note: The term "cold" means that the test is carried out at a reference calibration temperature without load before the test.

Tripping Curve

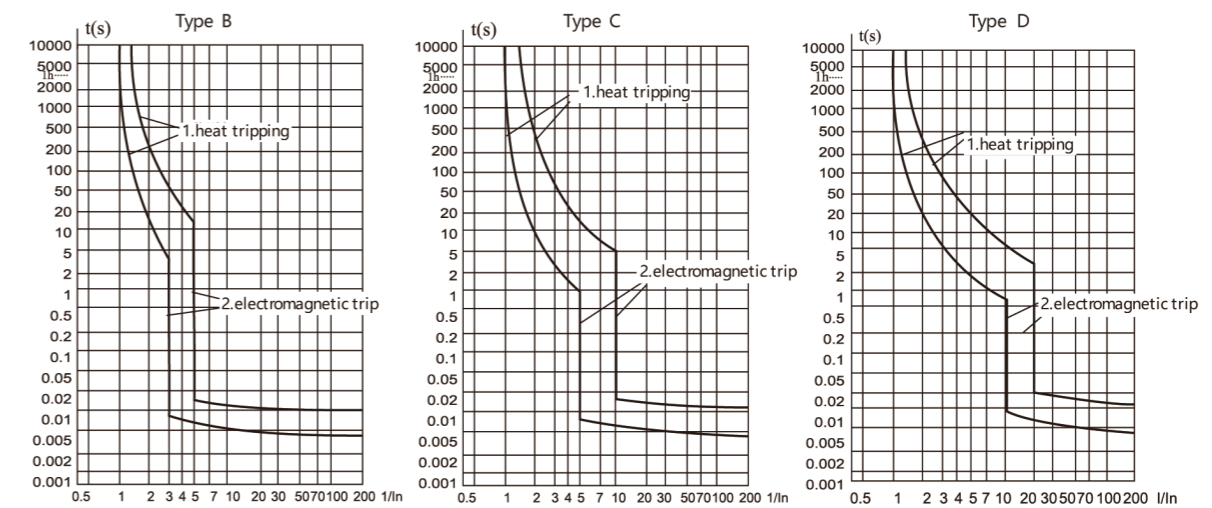

Conductor requirements and cross section

Copper cross-section(mm ²)	Rated current I _n (A)
1	I _n ≤ 6
1.5	6 < I _n ≤ 13
2.5	13 < I _n ≤ 20
4	20 < I _n ≤ 25
6	25 < I _n ≤ 32
10	32 < I _n ≤ 50
16	50 < I _n ≤ 63

Dimensions(mm)

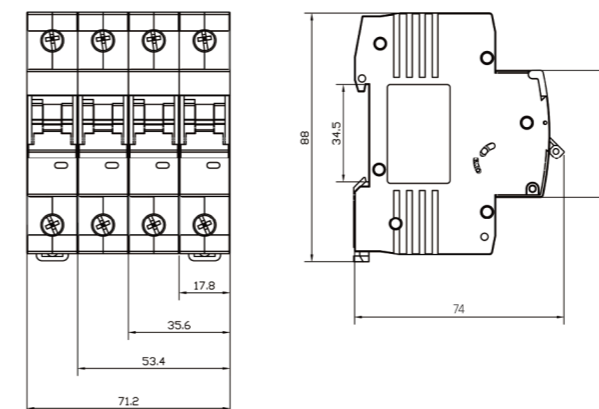

Ordering Specification

Please specify the following when ordering:

- 1.Product Model: PXB9-63
- 2.Number of Poles: 1P, 2P, 3P, 4P
- 3.Rated Current & Tripping Curve: [e.g.: C/16A]
 - Tripping Curve: B, C, D
 - Rated Current (I_n): 6A, 10A, 13A, 16A, 20A, 25A, 32A, 40A, 50A, 63A

4.Quantity: [e.g.: 100 pcs]

Ordering Example:

PXB9-63 2P C/16A 100 pcs

PXB9N-32

Miniature Circuit Breaker



Product Features

- Compact structure and robust design
- Low power consumption
- Easy DIN-Rail extraction
- Overload & short circuit protection
- Suitable for industrial, commercial, high-rise and civil residences circuit protection

Type designation

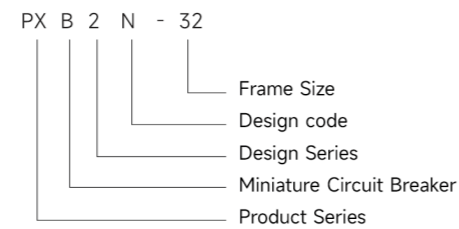

Technical Specifications

Parameter	
Rated voltage	230V~
Rated impulse withstand voltage (Uimp)	4000 V
Rated current	6A, 10A, 13A, 16A, 20A, 25A, 32A
Rated frequency	50 Hz / 60 Hz
Number of poles	1P+N
Rated breaking capacity (Icn/Ics)	6000 A
Mechanical life	10,000 operations
Electrical life	4,000 operations
Tripping characteristics	B, C, D
Pollution degree	2
Degree of protection	IP20
Standards	EN/IEC 60898-1, GB/T 10963.1
Tightening torque	2 N·m

Tripping characteristics (Reference temp.30°C)

Item	Tripping Curve	Test current I _n (A)	Initial Status	Time limit for tripping or non-tripping	Expected result	Remarks
a	B, C, D	1.13I _n	Cold	t ≤ 1h	Non-tripping	Current smoothly rises to specified value within 5s
b	B, C, D	1.45I _n	Following item a test	t < 1h	Tripping	
c	B, C, D	2.55I _n	Cold	1s < t < 60s (I _n ≤ 32A) 1s < t < 120s (I _n > 32A)	Tripping	
d	B	3I _n	Cold	t ≤ 0.1s	Non-tripping	Switch on the power supply by closing the auxiliary switch
	C	5I _n				
	D	10I _n				
e	B	5I _n	Cold	t < 0.1s	Tripping	Switch on the power supply by closing the auxiliary switch
	C	10I _n				
	D	20I _n				

Note: The term "cold" means that the test is carried out at a reference calibration temperature without load before the test.

Tripping curves

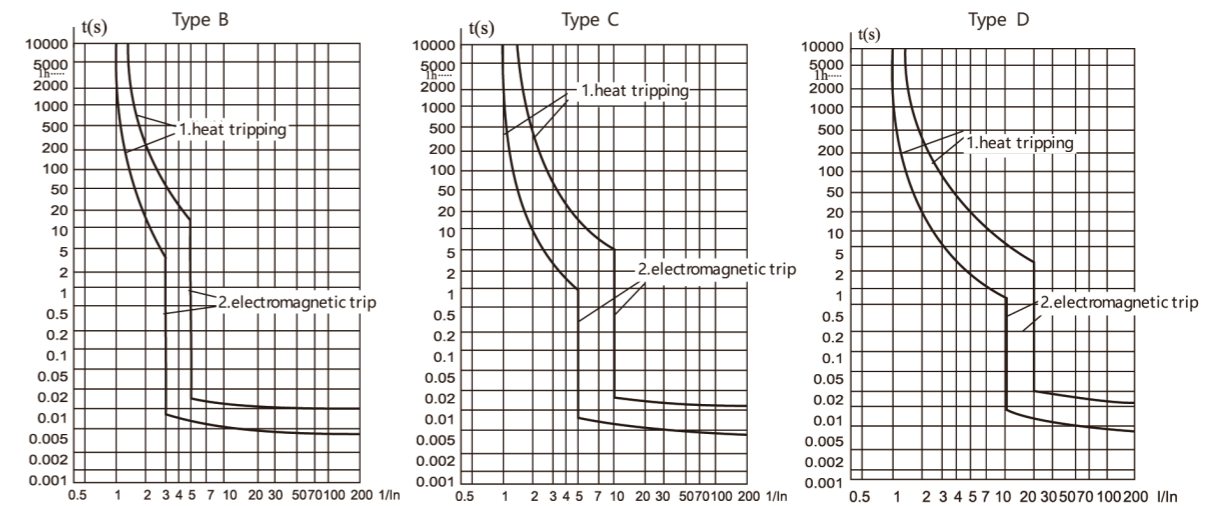

Conductor requirements and cross section

Copper cross-section(mm ²)	Rated current I _n (A)
1	I _n ≤ 6
1.5	6 < I _n ≤ 13
2.5	13 < I _n ≤ 20
4	20 < I _n ≤ 25
6	25 < I _n ≤ 32

Dimensions(mm)

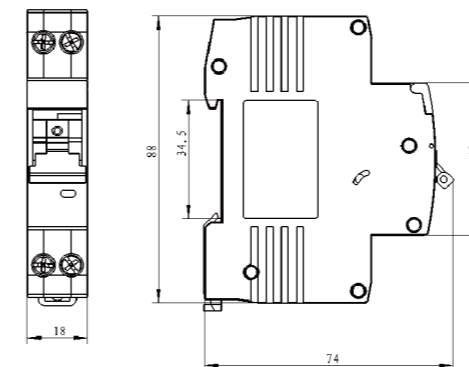

Ordering Specification

Please specify the following when ordering:

- 1.Product Model: PXB9N-32
- 2.Number of Poles: 1P+N
- 3.Rated Current & Tripping Curve: [e.g.: C/16A]
 - Tripping Curve: B, C, D
 - Rated Current (I_n): 6A, 10A, 13A, 16A, 20A, 25A, 32A
- 4.Quantity: [e.g.: 100 pcs]

Ordering Example:

PXB9N-32 1P+N C/16A 100 pcs

PXB9L-40

Residual Current Operated Circuit Breaker (Electromagnetic)

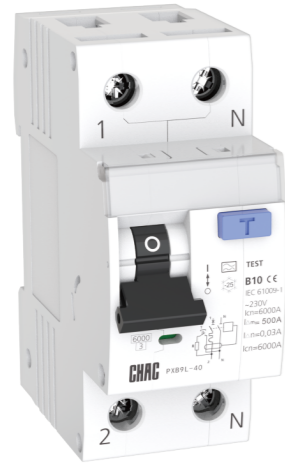

Product Features

- Provides ground fault/leakage current, short circuit, overload protection and isolation.
- Provides additional protection against direct human contact.
- Effectively prevents electrical equipment insulation failure.
- Comprehensive protection for residential and commercial power distribution systems.

Type designation

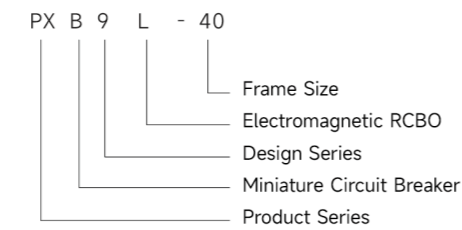

Technical Specifications

Parameter	
Rated voltage	230 V
Rated current	6, 10, 13, 16, 20, 25, 32, 40 A
Rated frequency	50 Hz
Number of poles	1P+N
Rated breaking capacity (Icn/Ics)	6000 A
Mechanical life	10,000 operations
Electrical life	4,000 operations
Tripping characteristics	B, C, D
Type of residual current	AC, A
Rated residual operating current (IΔn)	30 mA
Rated residual making & breaking capacity (IΔm)	500 A
Pollution degree	2
Degree of protection	IP20
Standards	EN/IEC 61009-1, GB/T 16917.1
Tightening torque	3.5 N·m

Tripping characteristics (Reference temp.30°C)

Item	Tripping Curve	Test current I _n (A)	Initial Status	Time limit for tripping or non-tripping	Expected result	Remarks
a	B, C, D	1.13I _n	Cold	t ≤ 1h	Non-tripping	Current smoothly rises to specified value within 5s
b	B, C, D	1.45I _n	Following item a test	t < 1h	Tripping	
c	B, C, D	2.55I _n	Cold	1s < t < 60s (I _n ≤ 32A) 1s < t < 120s (I _n > 32A)	Tripping	
d	B	3I _n	Cold	t ≤ 0.1s	Non-tripping	Switch on the power supply by closing the auxiliary switch
	C	5I _n				
	D	10I _n				
e	B	5I _n	Cold	t < 0.1s	Tripping	Switch on the power supply by closing the auxiliary switch
	C	10I _n				
	D	20I _n				

Note: The term "cold" means that the test is carried out at a reference calibration temperature without load before the test.

Tripping curves

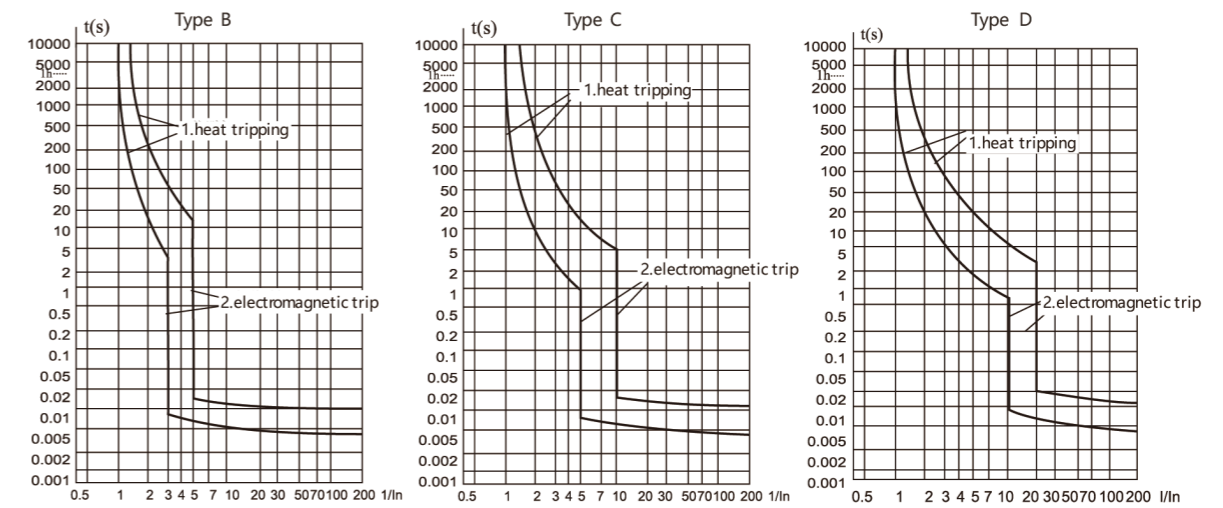

Conductor requirements and cross section

Copper cross-section(mm ²)	Rated current I _n (A)
1	I _n ≤ 6
1.5	6 < I _n ≤ 13
2.5	13 < I _n ≤ 20
4	20 < I _n ≤ 25
6	25 < I _n ≤ 32
10	32 < I _n ≤ 40

Dimensions(mm)

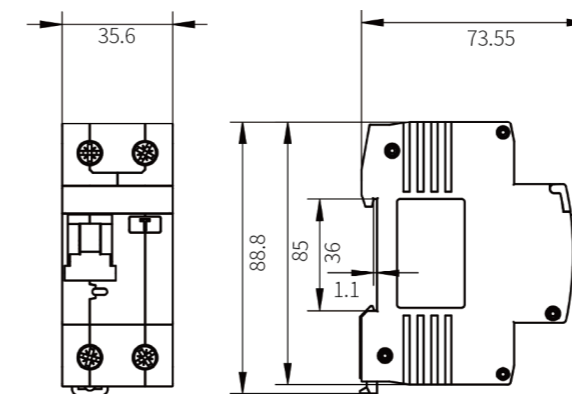

Ordering Specification

Please specify the following when ordering:

- 1.Product Model: PXB9L-40
- 2.Number of Poles: 1P+N
- 3.Rated Current & Tripping Curve: [e.g.: C/16A]
 - Tripping Curve: B, C, D
 - Rated Current (I_n): 6A, 10A, 13A, 16A, 20A, 25A, 32A, 40A
- 4.Type of Residual Current: AC, A
- 5.Rated Residual Operating Current (IΔn): [e.g.: 30mA]
 - Available Options: 30mA, 100mA, 300mA
- 6.Quantity: [e.g.: 100 pcs]

Ordering Example:

PXB9L-40 1P+N C/16A AC 30mA 100 pcs

PXL9-63

Residual Current Circuit Breaker (Electromagnetic)



Product Features

- Used in housing, tertiary sector and industry.
- Control electric circuits.
- Protect people against indirect contacts and additional protection against direct contacts.
- Protect installations against fire hazard due to insulation faults.
- Wide variety of rated tripping currents.

Type designation

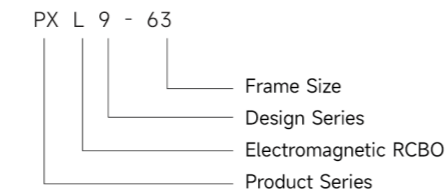

Technical Specifications

Parameter	
Rated voltage Ue	230V/400V
Rated current(A)	6、10、16、20、25、32、40、50、63
Rated insulation voltage(Ui)	500V
Rated frequency	50Hz/60Hz
Number of poles	2P、4P
Rated limited short-circuit current Inc(A)	6000
Rated limited residual short-circuit current IΔc(A)	6000
Mechanical&Electrical life	4000
Rated residual operating current IΔn(mA)	30、100、300
Pollution degree	2
Protection degree	IP20
Standards	EN/IEC61008-1、GB/T16916.1
Tighten torque(Nm)	2.5
Rated impulse withstand voltage(Uimp)	4000V
Type of residual current	AC、A、B、S、G
Rated making&breaking capacity Im(A)	500A or 10In(Take the maximumvalue)
Rated residual making&breaking capacity IΔm(A)	500A or 10In(Take the maximumvalue)

Dimensions(mm)

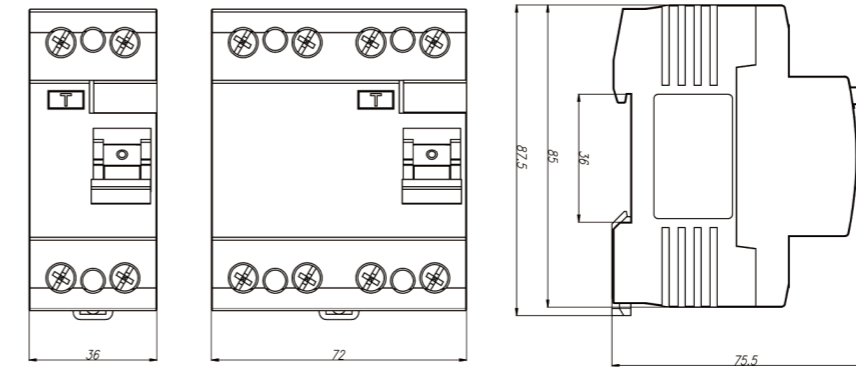

Ordering Specification

Please specify the following when ordering:

- 1.Product Model: PXL9-63
- 2.Number of Poles: 2P, 4P
- 3.Rated Current (In): [e.g.: 32A]
 - Available Currents: 6A, 10A, 16A, 20A, 25A, 32A, 40A, 50A, 63A
- 4.Type of Residual Current: AC, A, B, S, G
- 5.Rated Residual Operating Current (IΔn): [e.g.: 30mA]
 - Available Options: 30mA, 100mA, 300mA
- 6.Quantity: [e.g.: 100 pcs]

Ordering Example:

PXL9-63 2P 32A AC 30mA 100 pcs

CQB7DC-63

DC Miniature Circuit Breaker



Product Features

- DC Specialized Design
Specifically designed for DC circuits with rated working voltage up to 1000V, suitable for various DC power distribution systems
- High Breaking Capacity
Rated short-circuit breaking capacity of 6kA, providing reliable overload and short-circuit protection
- Communication Industry Application
Specially suitable for power distribution systems in communication industry main cabinets, power cabinets, distribution cabinets, and outdoor cabinets

Type designation

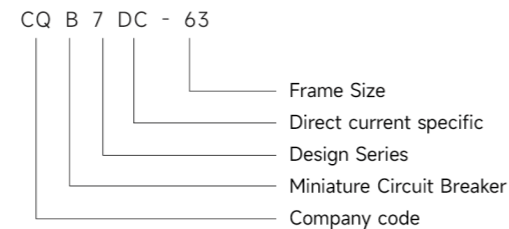

Technical Specifications

Parameter	
Rated voltage	1P, 2P, 3P, 4P
Rated current	6A, 10A, 13A, 16A, 20A, 25A, 32A, 40A, 50A, 63A
Rated insulation voltage	DC 1000 V
Ultimate breaking capacity (Icu)	6 kA
Operational breaking capacity (Ics)	6 kA
Tripping curves	Type B (4In±20%), Type C (8In±20%)
Mechanical life	10,000 operations
Electrical life	1,500 operations
Wiring capacity	≤ 25 mm ²
Tightening torque	3.0 N·m
Degree of protection	IP20
Standards	GB/T 14048.2
Certification	CCC

Tripping characteristics (Reference temp.30°C)

Item	Tripping Curve	Test current In(A)	Initial Status	Time limit for tripping or non-tripping	Expected result	Remarks
a	C	1.05In	Cold	t ≤ 1h	Non-tripping	
b	C	1.3In	Following item a test	t < 1h	Tripping	Current smoothly rises to specified value within 5s
c	C	2.55In	Cold	1s < t < 60s (In ≤ 32A) 1s < t < 120s (In > 32A)	Tripping	
d	C	5In	Cold	t ≤ 0.1s	Non-tripping	Switch on the power supply by closing the auxiliary switch
e	C	10In	Cold	t < 0.1s	Tripping	Switch on the power supply by closing the auxiliary switch

Note: The term "cold" means that the test is carried out at a reference calibration temperature without load before the test.

Tripping curves

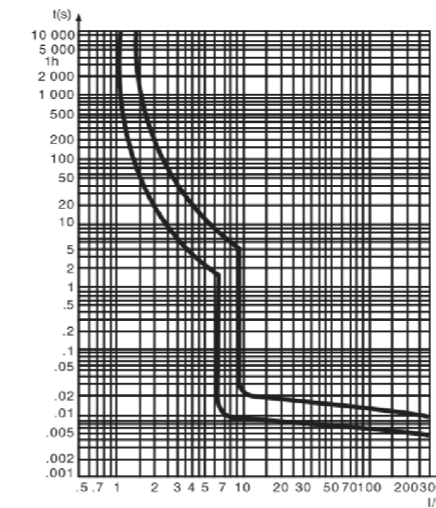

Dimensions(mm)

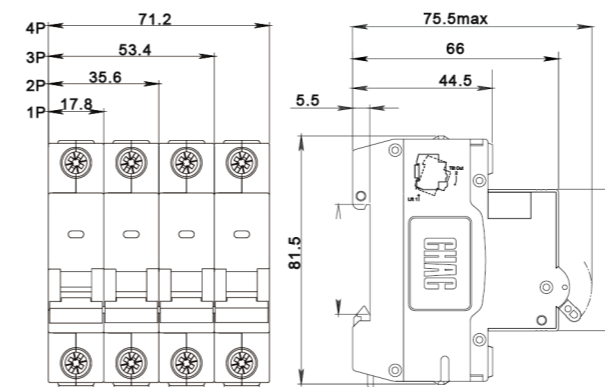

Ordering Specification

Please specify the following when ordering:

- 1.Product Model: CQB7DC-63
 - 2.Number of Poles: 1P, 2P, 3P, 4P
 - 3.Rated Current & Tripping Curve: [e.g.: C/32A]
 - Tripping Curve: B, C, D
 - Available Currents: 6A, 10A, 13A, 16A, 20A, 25A, 32A, 40A, 50A, 63A
 - 4.Quantity: [e.g.: 100 pcs]
- Ordering Example:
CQB7DC-63 2P C/32A 100 pcs