

FINGERPRINT DEADBOLT

FSDB USER'S MANUAL

WWW.ELEMAKELOCKS.COM
FOR CUSTOMER SERVICE PLEASE CALL:
(800) 315-9607

COPYRIGHT©2022 BY STEINBRUCKE PRODUCTS US LLC. ALL RIGHTS RESERVED

ELEMAKE IS DEDICATED TO PROVIDING CUSTOMERS WITH TOP-GRADE QUALITY AND INNOVATION LOCK PRODUCTS AT AN AFFORDABLE PRICE. OUR STYLISH DESIGNS AND HIGH QUALITY CRAFTSMAN-PRICE HAVE GRACED CUSTOMERS DOORS SINCE 1976.

SERIES-FSDB LOCKS ARE A FAMILY OF TOUCH SCREEN AND FINGERPRINT INTERNET DEADBOLTS. THEY ARE IDEAL FOR RESIDENTIAL HOMES, APARTMENT BUILDINGS, OFFICES, SCHOOLS, HOSPITALS, AND OTHER APPLICATIONS WHERE RESTRICTED ACCESS TO AN AREA IS NEEDED.

ALL OF ELEMAKE FSDB SERIES KEYLESS DEADBOLT PRODUCTS COME WITH A 5 YEAR WARRANTY.

NOTE TO INSTALLER

WE HIGHLY RECOMMEND WATCHING THE FOLLOWING VIDEOS PRIOR TO INSTALLATION.

Installation Video Link:
WWW.ELEMAKELOCKS.COM/pages/installation-video

Lock Use Video Link:
WWW.ELEMAKELOCKS.COM/pages/usersguide-video

FAILURE TO FOLLOW THESE INSTRUCTIONS COULD RESULT IN DAMAGE TO THE PRODUCT AND VOID THE FACTORY WARRANTY

QUICK SOLUTIONS TO COMMON PROBLEMS:

Item #	Problem	Cause	Solution
1	The outside escutcheon doesn't fit the spindle cannot go through the bolt hole.	The bolt is upside down.	Flip the bolt over 180 degrees - make sure the UP is facing upwards.
2	The thumb turn is not retracting or extending or is not working.	The bolt is not retracted when originally installed.	Reinstall the outside escutcheon making sure that the deadbolt is retracted.
3	The latch is not fully retracting or extending, or the latch is not moving freely or smoothly	The cord is not positioned correctly and is interfering with the deadbolt's functioning.	Reroute the cord to fit under the bolt and through the right side slot on the mounting bracket.
4	Cannot retract or extrude the deadbolt latch	The thumb turn was positioned incorrectly upon installation	Take off the inner escutcheon and turn the thumb turn in the correct position before reinstalling.
5	Cannot retract or extrude the deadbolt latch	The motor rotation direction was set incorrectly.	Log into the app and change the motor rotation direction. See Figure C-7

Preset Password:
123456

TABLE OF CONTENT

- 1.WARNINGS 4
- 2.INSTALLATION 4
- 2.1 STEP 1-----DEFINE THE RIGHT HANDED OR LEFT HANDED DOOR 4
- 2.2 STEP 2----PREPARE DEADBOLT FOR INSTALLATION 8
- 2.3 STEP 3----INSTALL DEADBOLT & DOOR POSITION SENSOR 9
- 2.4 STEP 4----CHOOSE MOTOR ROTATION DIRECTION 14
- 2.5 STEP 5----INSTALL WIFI COMPONENT 15
- 3. RESET DEADBOLT TO FACTORY DEFAULT 15
- 3.1 RESET METHOD 1 15
- 3.2 RESET METHOD 2 16
- 4. SETTING UP WITH SMART LIFE APP 16
- 4.1 STEPS TO SET UP WITH SMART LIFE APP 16
- 4.2 ADD MEMBERS 20
- 4.3 CONNECT WIFI (OPTIONAL) 23
- 5. HOW TO USE THE DEADBOLT 27
- 5.1 BASIC FUNCTIONS 27
- 5.2 INTERNET FUNCTIONS 31
- 6. QUALITY POLICY 35

1.WARNINGS

FCC: Class B Equipment
The Series FSDB deadbolt has been tested and found to comply with the limits for a Class B digital device--Part 15 of the FCC Rules. These limits are intended to provide protection against harmful interference in a residential environment. The deadbolt generates, uses, and can radiate RF energy and, if not installed and used according to the instructions in the users manual, may have harmful interference to radio communications. However, if this deadbolt does cause interference to radio or television reception, which can be tested by turning the deadbolt off and on, the user is encouraged to try to correct the interference by one or more of the following measures:

- Relocate the radio communication device's receiving antenna.
- Make a separation between the deadbolt and the receiver.
- Consult a customer service or professional radio/ technician for help.

Industry Canada:
This Class A digital apparatus has been tested and meet all standard of the Canadian Interference Causing Equipment Regulations.

Warning:
Changes or modifications to this device, not expressly approved by the company could void the user's authority to operate this equipment.

2.INSTALLATION

IMPORTANT:READ BEFORE INSTALLATION

- A. Components included and tools needed**
- Components in the box(see Figure A)
User's manual
Outside Escutcheon
Bolt
Strike Plate
Screw Pack (see below)
Keys
Door Position Sensor(For automatic locking--optional)
- Tools Needed**
2-1/8" (56mm) hole saw
1" (26mm) boringbit
Wood screw drillbit
Chisel & hammer

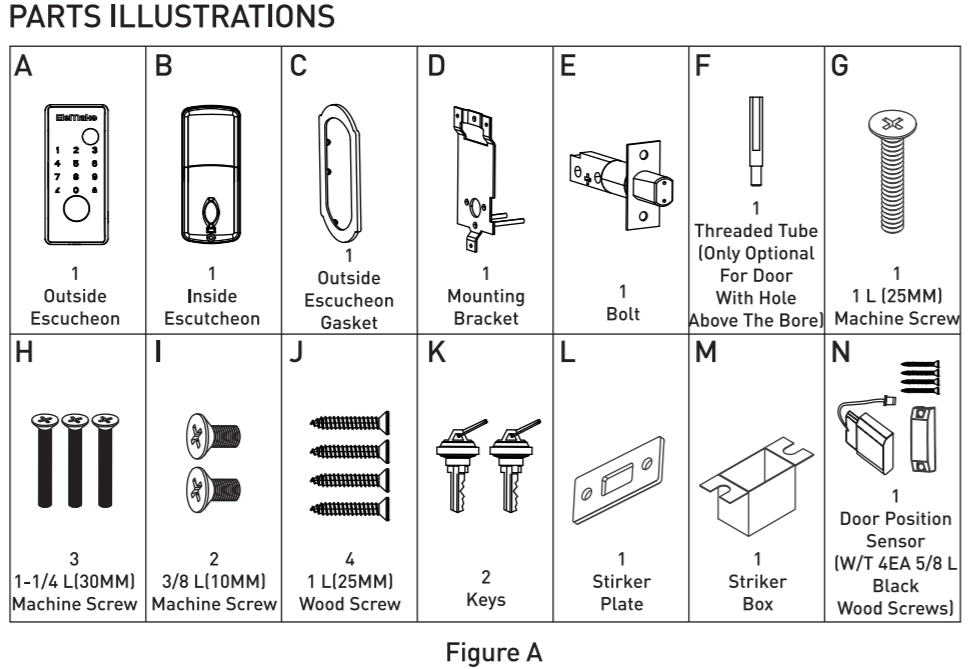

B. Assembly Drawing(Figure B)

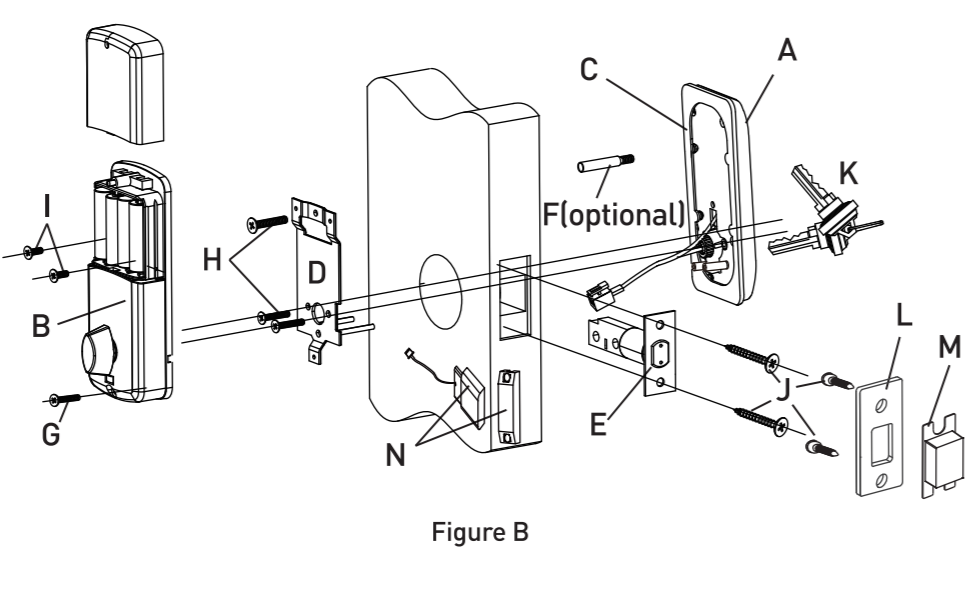

C.Preset password

The factory preset password is "123456"

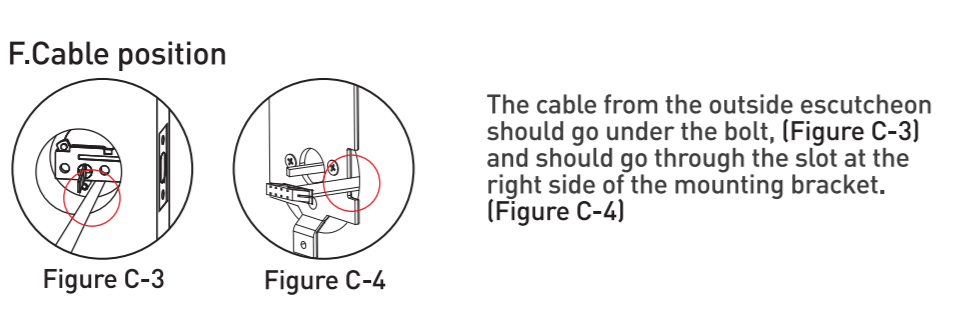
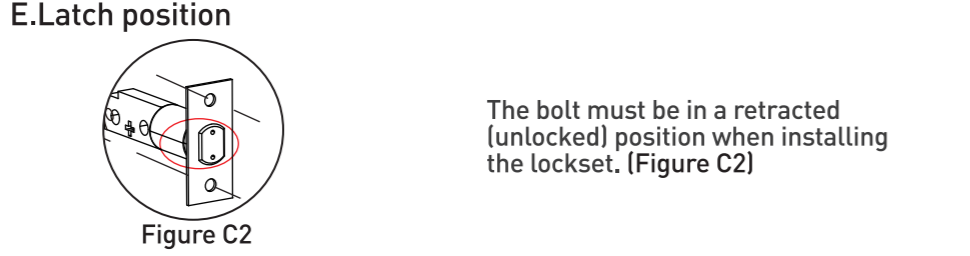
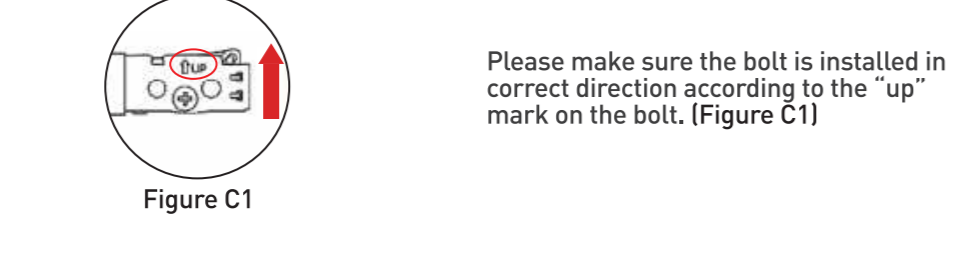

G.Thumb turn position

Depending on the placement of the door, the thumb turn position upon installation will differ for right or left handed doors. Pay close attention to figure C-5 to turn the thumb turn to the appropriate position.(Figure C-5)

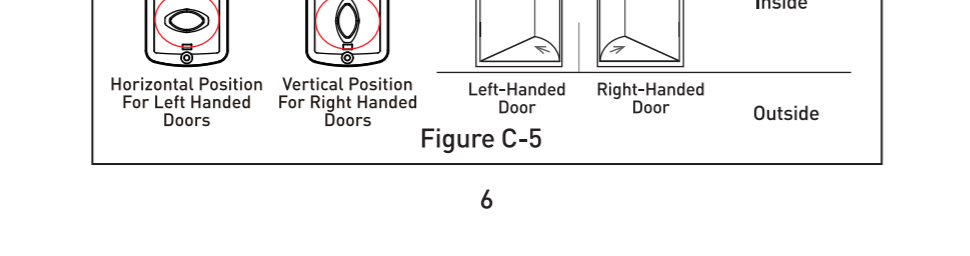

H.Mechanical validation

Before installing the batteries, test the mechanical operation of the lock by using both the thumb turn and the key. The movement of the bolt should be smooth and unobstructed. If the operation is not smooth, review the previous steps to ensure proper installation. (Figure C-4)

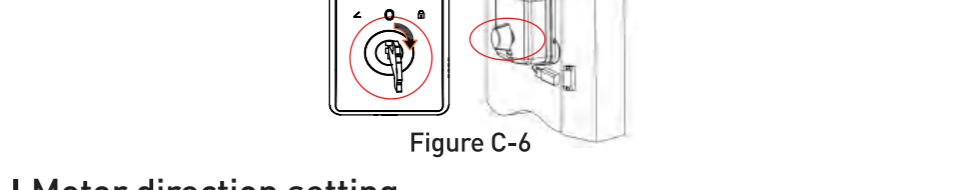

I.Motor direction setting

After installing, connect the deadbolt to the SmartLife APP, choose the correct setting according to the direction of the door (Settings->motor rotation direction->clockwise unlock/counter-clockwise unlock) (Figure C-7)

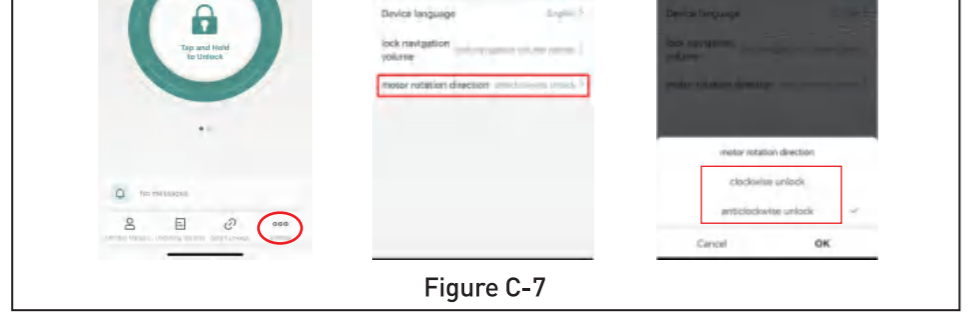

Choose ANTICLOCKWISE for RIGHT HANDED DOOR
Choose CLOCKWISE for LEFT HANDED DOOR

J: This lock is with 4 AA alkaline batteries(Rechargeable batteries are not recommended)

2.1 STEP 1-----DEFINE THE RIGHT HANDED OR LEFT HANDED DOOR.
To Ensure Proper Lock Handing and for an explanation of how to determine your lock handing, please read this important note.(Figure D-1)

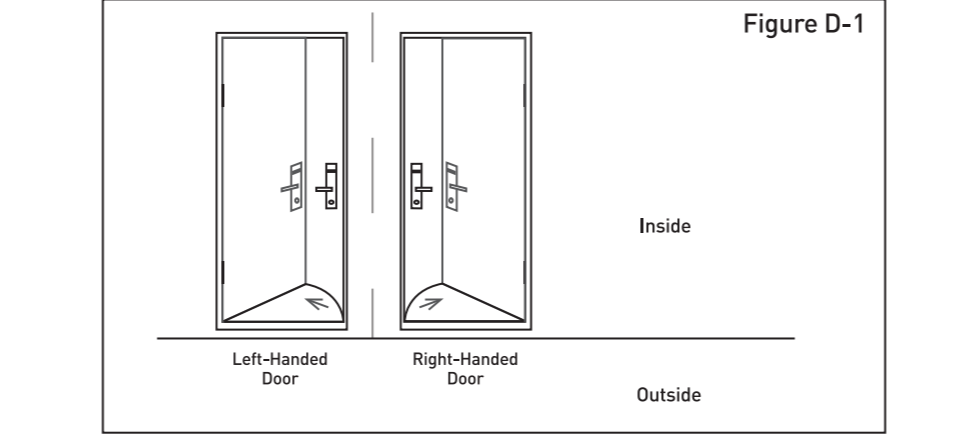

2.2 STEP 2----PREPARE DEADBOLT FOR INSTALLATION

(1)Inside Escutcheon and back cover(Figure F-1)

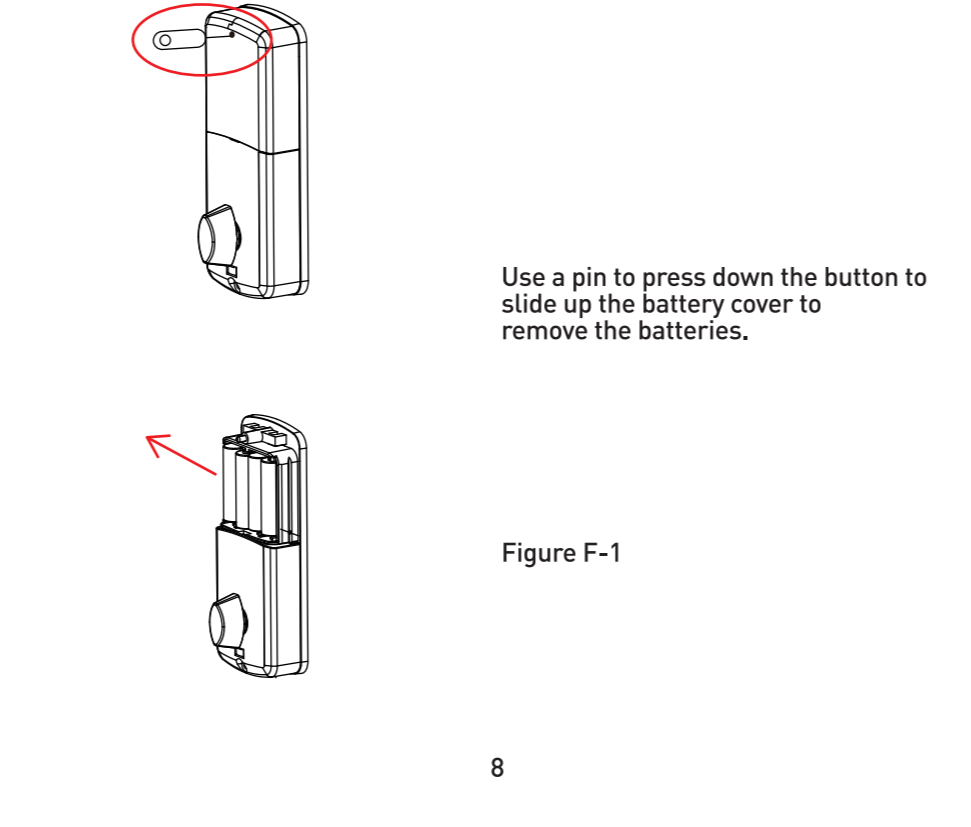

(2)Bolt(Figure F-3)

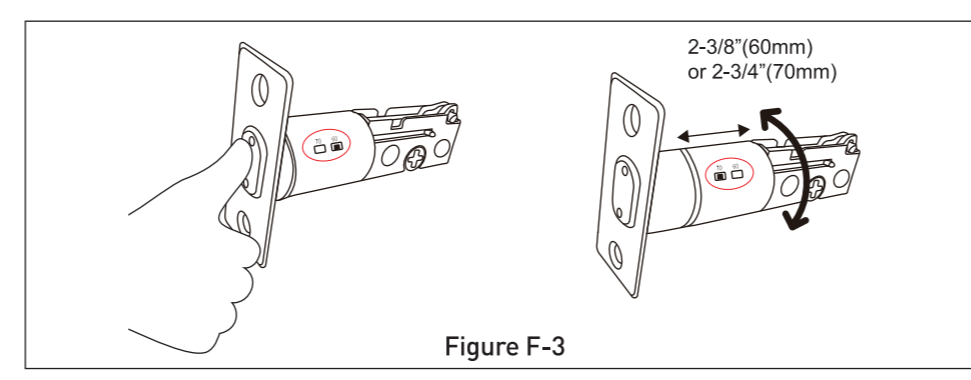

(3) Outside escutcheon

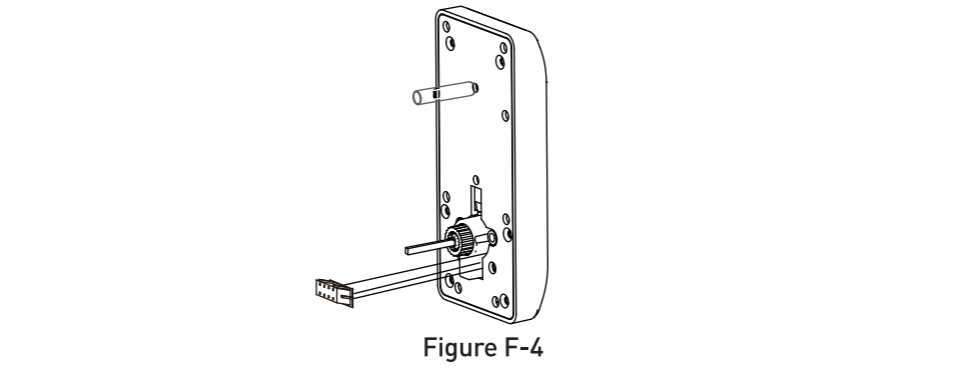

2.3 STEP 3----INSTALL DEADBOLT & DOOR POSITION SENSOR

(1) Install bolt & stiker/box plate on door.(Figure G-4, Figure G-5, Figure G-6)

NOTE: THE BOLT MUST BE IN A RETRACTED (UNLOCKED) POSITION PRIOR TO INSTALLING THE LOCKSET.(Figure G-5)

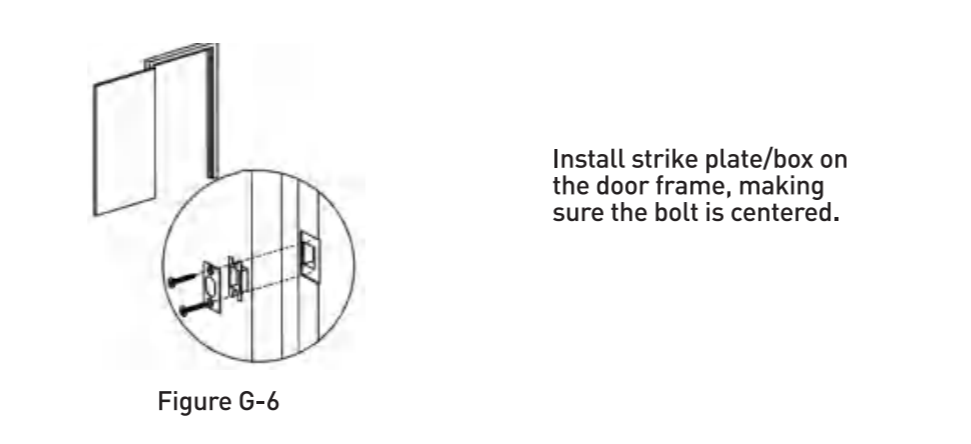
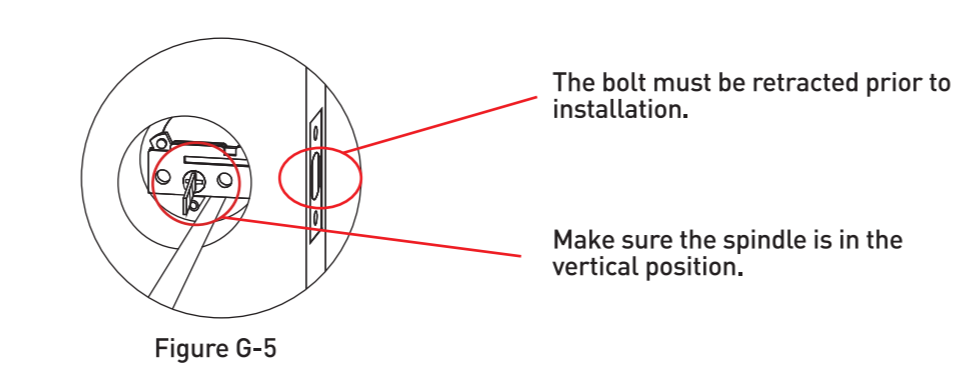
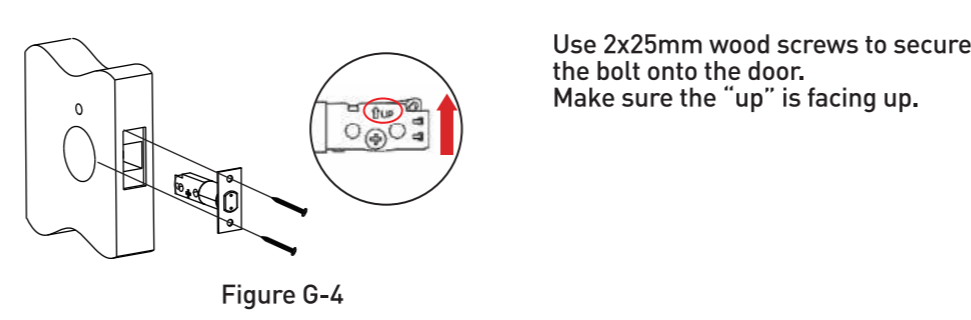

(2)Install outside escutcheon&mounting bracket(Figure H-1, Figure H-2, Figure H-3, Figure H-4)

NOTE:The cord goes UNDER the bolt (Figure H-2)

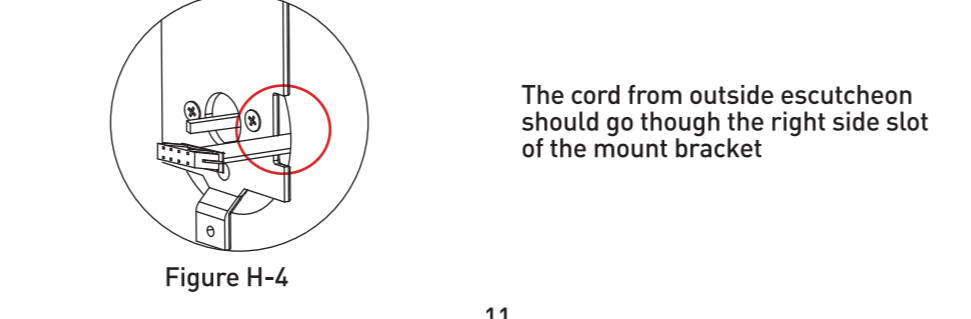
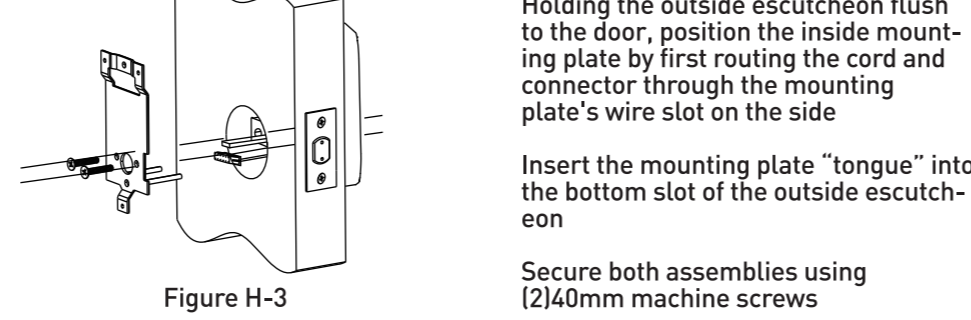
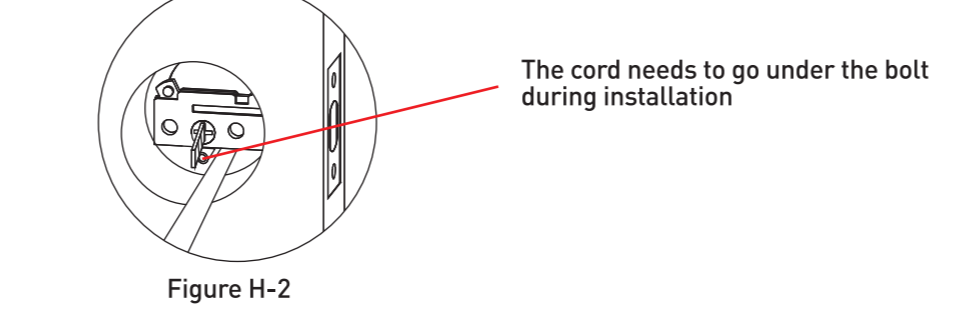
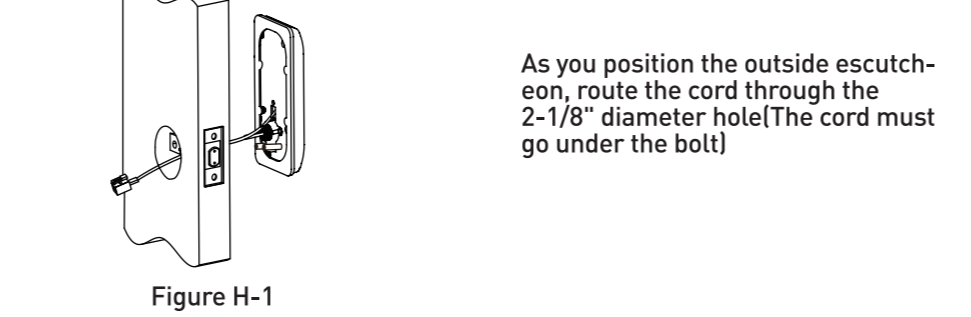

(3) Route cord(Figures I-1 and Figure I-2, Figure I-3)

Attach cord assembly to the inside escutcheon printed circuit board (PCB) by lining up notches on top of cord connector to slots on PCB connector (Figure 3K). Press connector in firmly using thumbs until completely seated (proper position indicated by arrows on PCB)(Figures I-1 and Figure I-2, Figure I-3).

(b) If you desire for this lock to automatically lock when closed, you need to install the door position sensor (included in box). Attach the sensor cord to the inside escutcheon printed circuit board (PCB), and route the cord through the slot on the rubber gasket(Figures I-1 and Figure I-2).

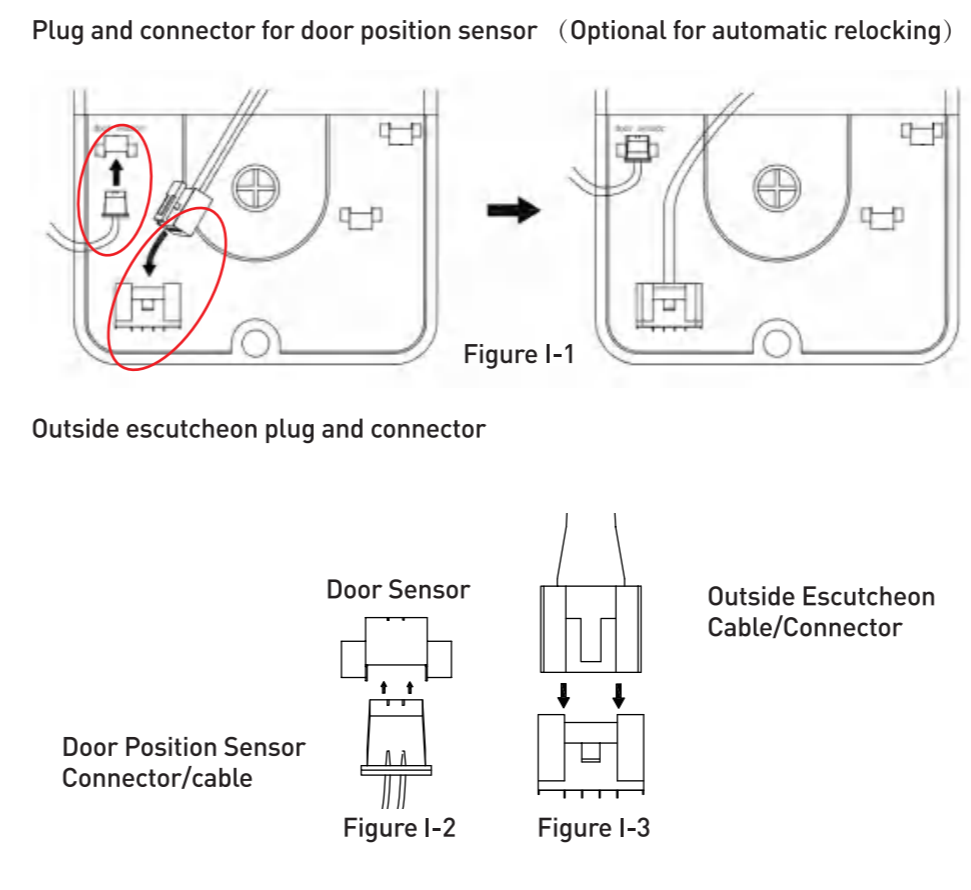

(4) Install inside escutcheon and door position sensor(If automatic locking is desired) (Figure J-1, Figure J-2, Figure J-3, Figure J-4 Figure J-5, Figure J-6, Figure J-7)

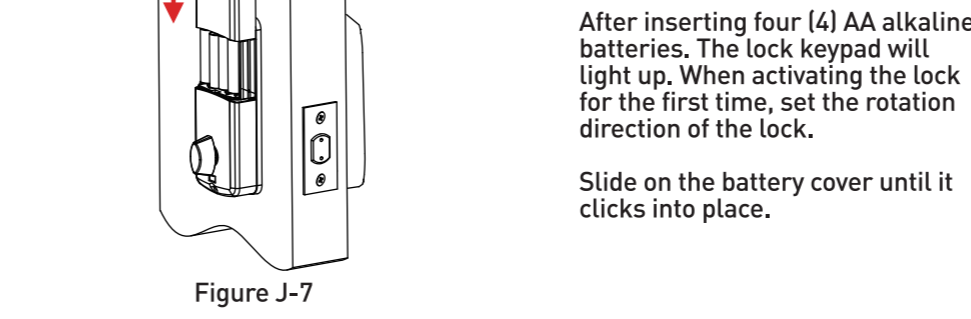
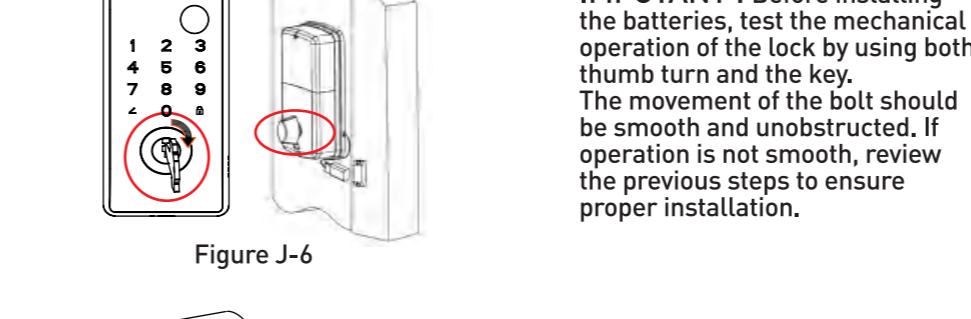
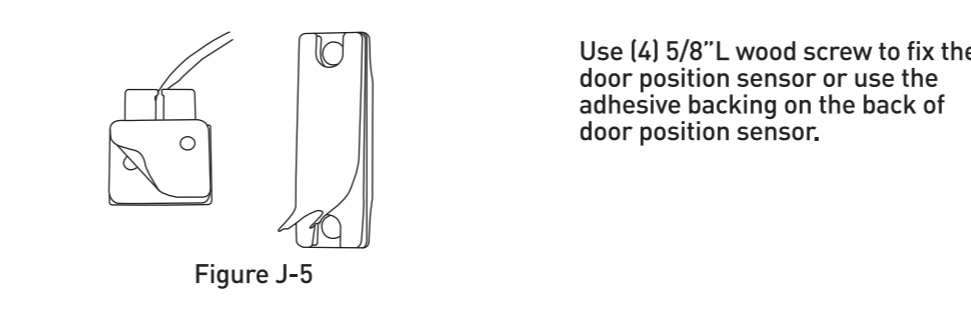
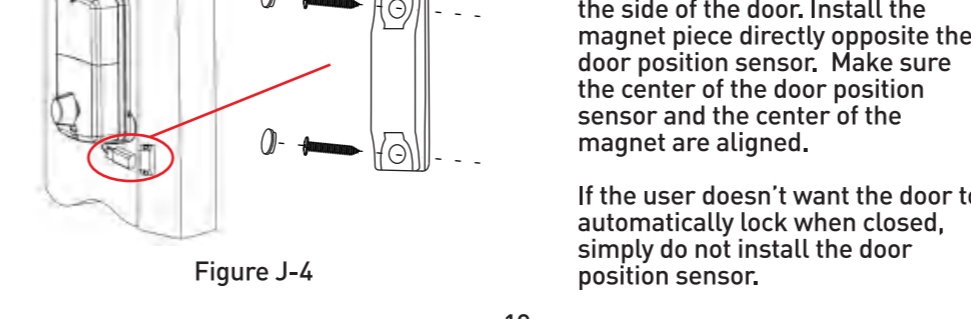
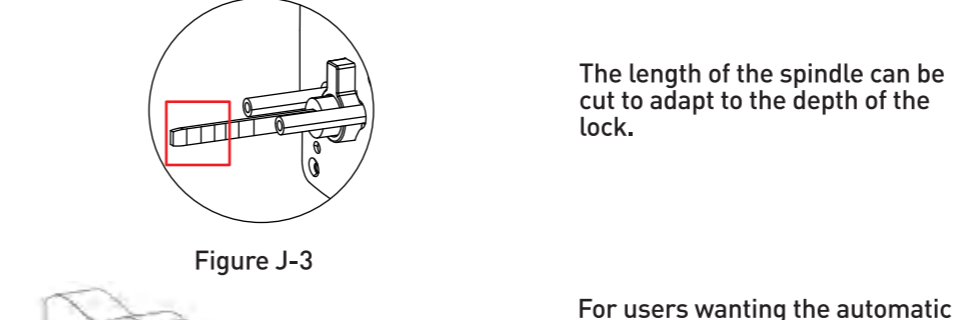
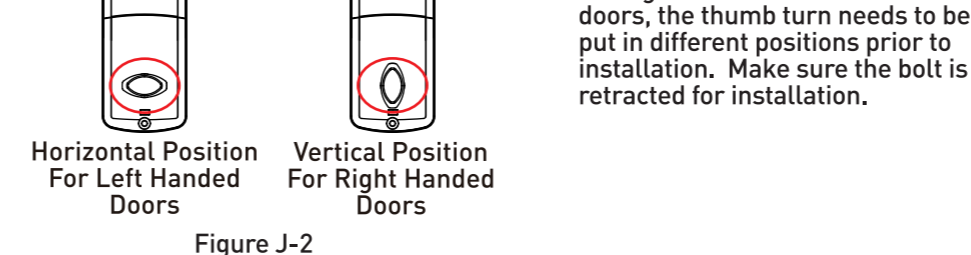
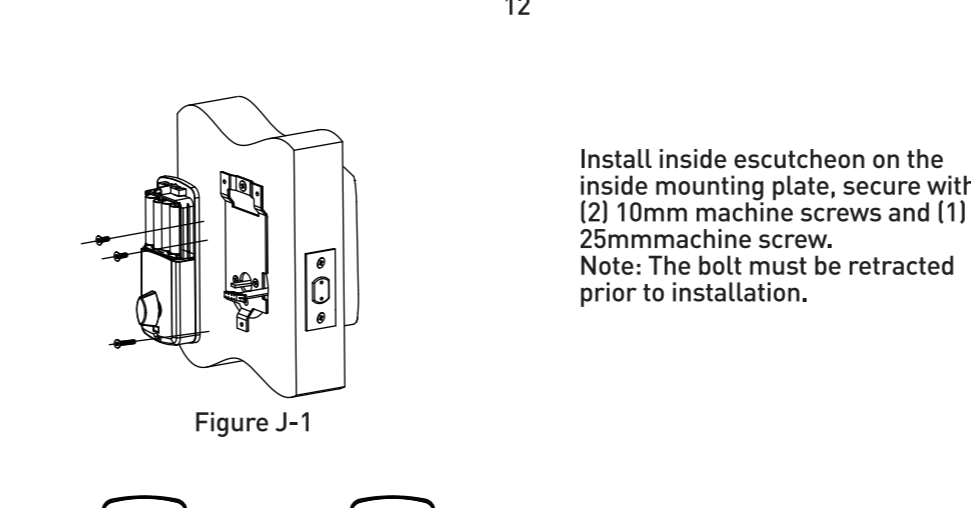

2.4 STEP 4----CHOOSE MOTOR ROTATION DIRECTION

After the above installation steps, connect the deadbolt to the SmartLife APP (Please refer to 4.1---(1) and 4.1---(2)) and choose the correct setting for a right handed or left handed door (Figure J-8)

Choose ANTICLOCKWISE for RIGHT HANDED DOORS
Choose CLOCKWISE for LEFT HANDED DOORS

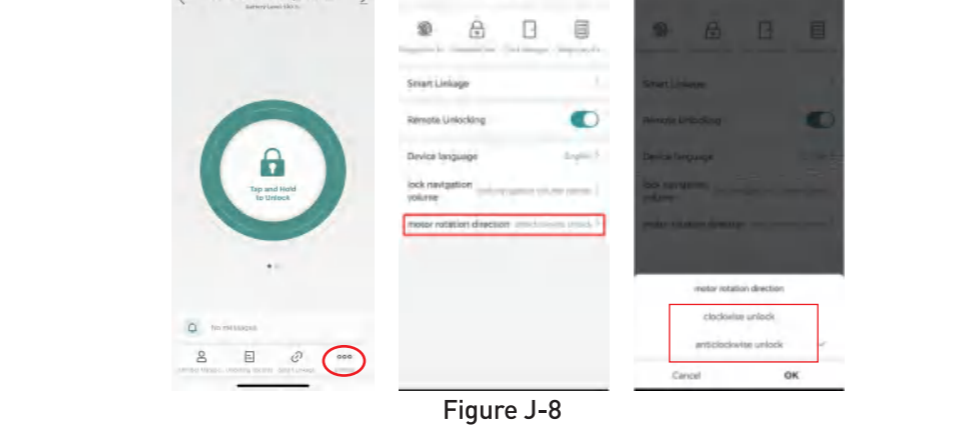

2.5 STEP 5 Install wifi component(Optional for long distance operation is desired)

When the basic installation is finished, the only hardware setting up for Wifi connection is to power on the Tuya WiFi gateway properly in working range. To use the internet functions(WIFI), still need to set up the Smart Life APP, please refer to 4.3(Connect WIFI) (IMPORTANT--Please make sure the Wifi gateway location is in deadbolt's bluetooth working range and good WIFI SIGNAL STRENGTH)



3. RESET DEADBOLT TO FACTORY DEFAULT

Factory setting (factory pre-set password:123456, and no password/ card recorded) It should be noted that this is also the procedure to clear the memory entirely for future reference. Following these steps will delete all user password, entry card , WIFI connection and all other settings.

3.1 RESET METHOD 1(Figure J-10 to Figure J-13)

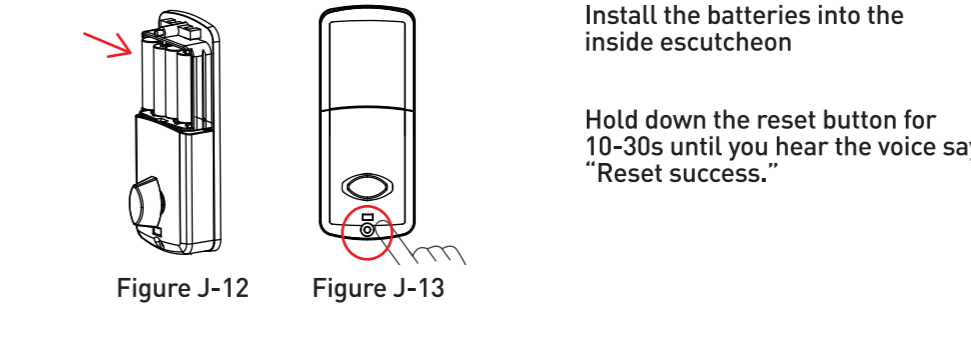

3.2 RESET METHOD 2(Figure J-14)

Open the door and keep open until the reset is completed. Note: This method can only be done by the person whose fingerprint or passcode has been previously entered into the system. Touch the screen with the back of hand to activate the deadbolt. Then press 2 888 8.

Follow the voice instructions to enter the previously enrolled password or touch the fingerprint to validate. After validation, the deadbolt will reset will be confirmed when the voice says, "Reset success."

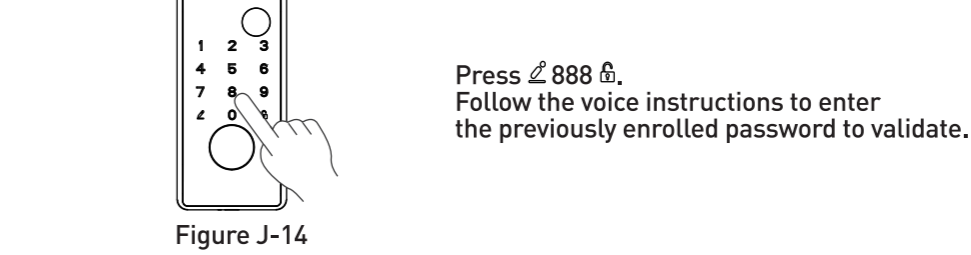

4. SETTING UP WITH SMART LIFE APP

4.1 STEPS TO SET UP WITH SMART LIFE APP.

(1) Step 1---Search "Smart life" APP, download, register, and log in.(Figure K-1)

(2) Step 2--Connect the deadbolt to the mobile phone SmartLife App with Bluetooth(Figure K-2 to Figure K-6)

- (a) Turn on the bluetooth setting on the administrator's cell phone.(Figure K-2)
- (b) Touch the screen with the back of your hand to activate the deadbolt.(Figure K-3)
- (c) Enter the Smartlife app. It should automatically locate the lock. You can also click "add the device" and choose the EleMake deadbolt. You should see the device with the EleMake logo.(Figure K-4)
- (d) Click the logo to connect the deadbolt. Name the deadbolt and save. (Figure K-5)
- (e) If connecting the Smartlife app with the deadbolt has been successful,the opening button on the screen will turn green. The user can then use the mobile phone to unlock the deadbolt via the Bluetooth. (Figure K-6)

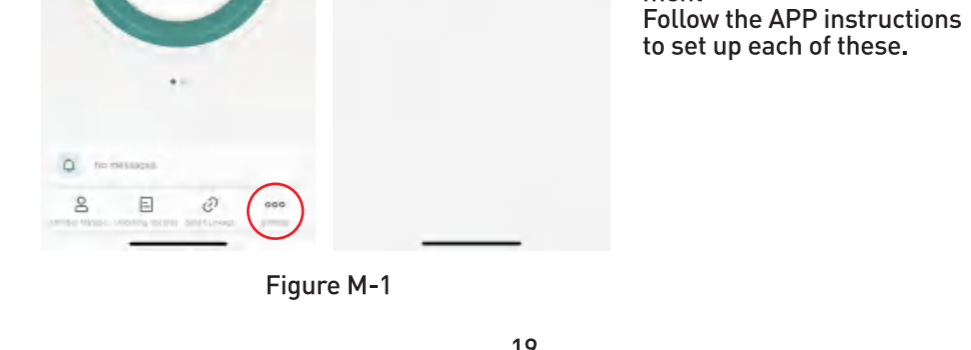
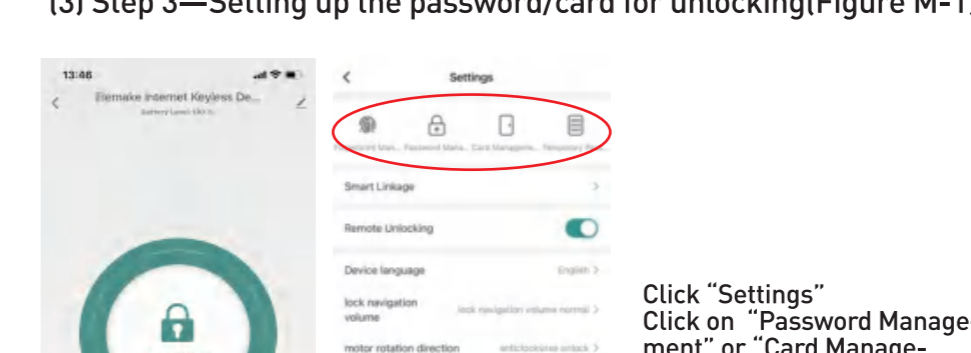
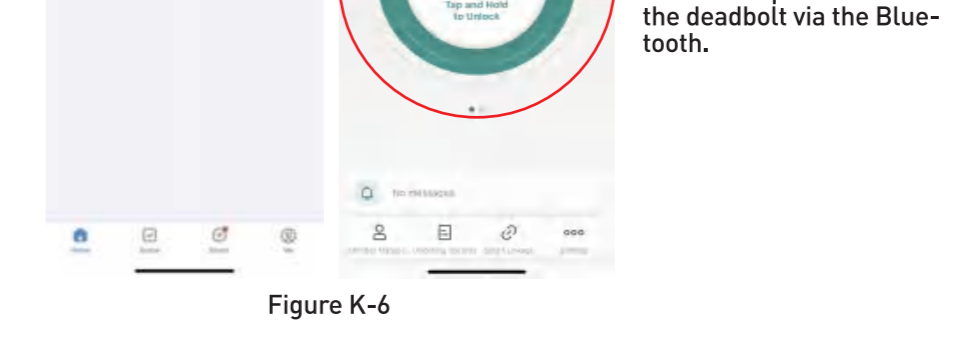
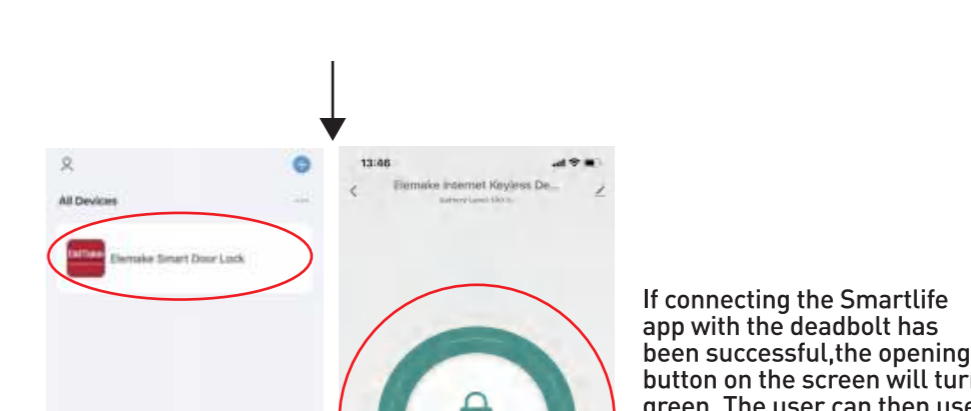
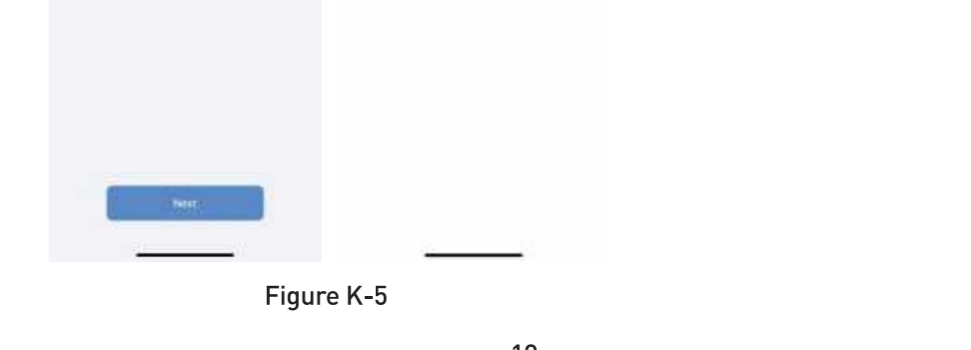
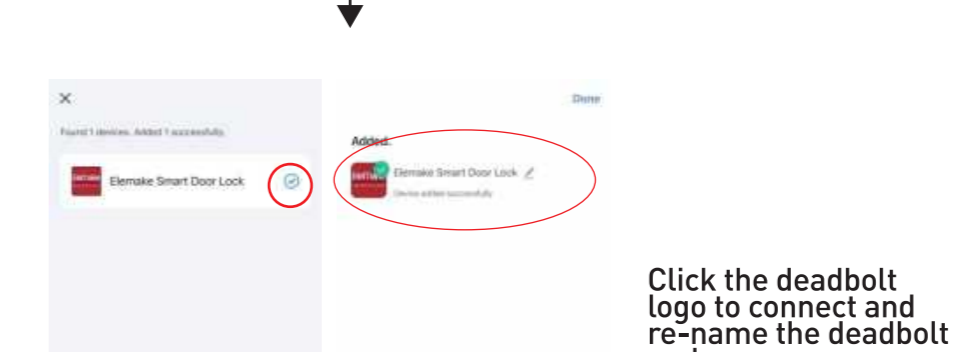
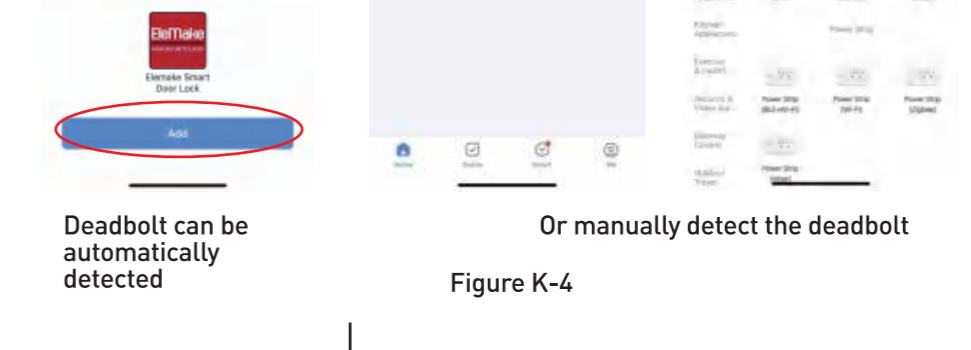
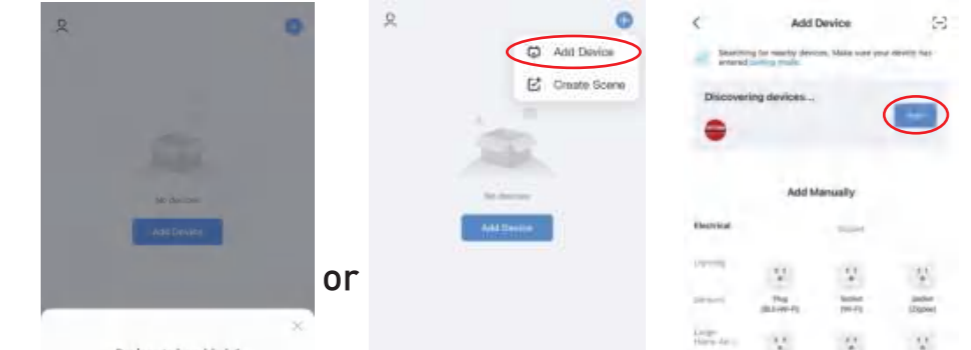
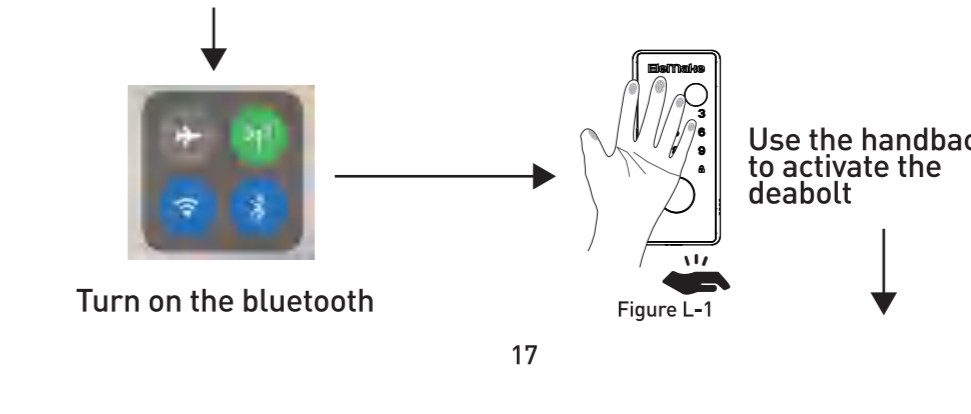
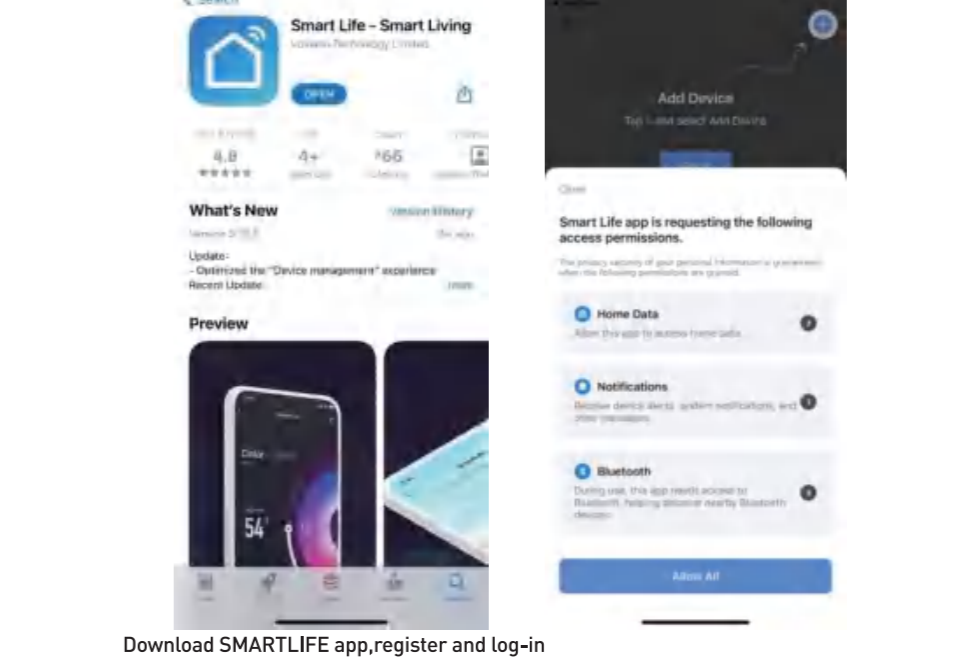

4.2 ADD MEMBERS

There are 2 kind of membership, "other member" and "family member" can be added as below. Family member is with all authorities of operating the specific deadbolt. Other member is with the limited authorities.

(1).Add "Other Member"(Figure N-1)



IMPORTANT: This way to add the "family member" is NOT RECOMMENDED FOR beginner of the SmartLife APP, mainly for user to add "other member".

(2).Add "Family Member"(Figure N-2)

Set up or choose the specific "home" in app firstly, then add member in specific "home" pages. Please follow below steps to add the family members.

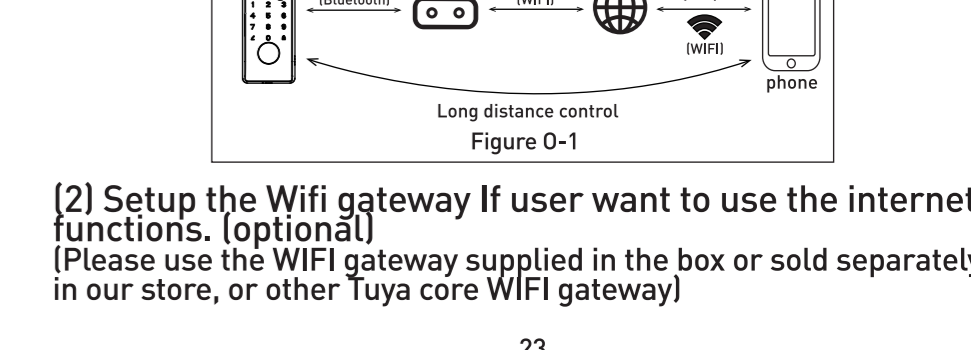
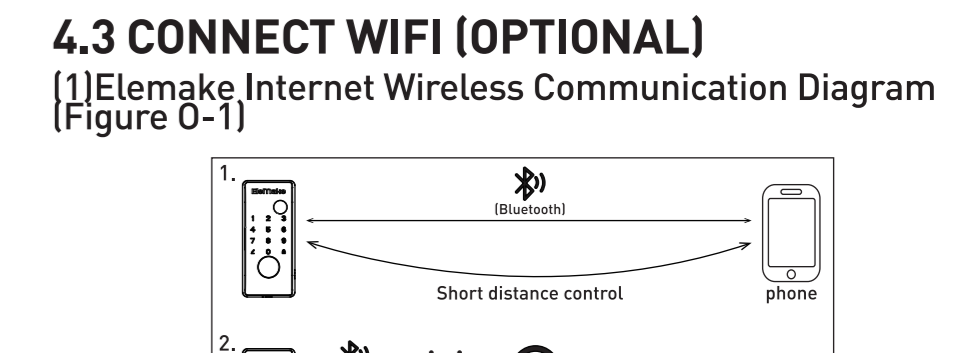
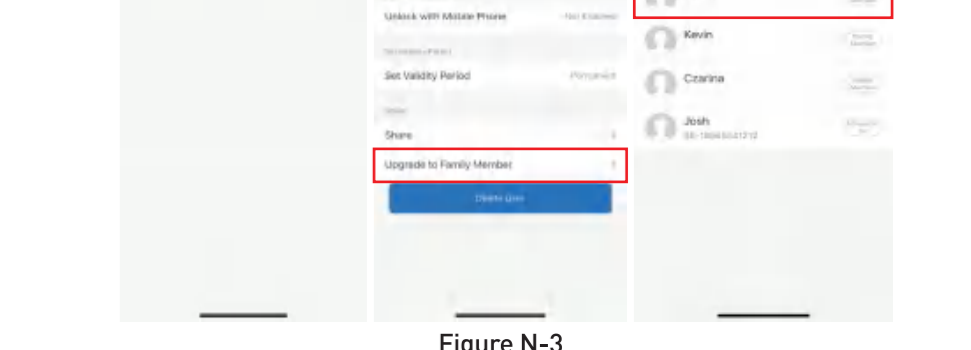
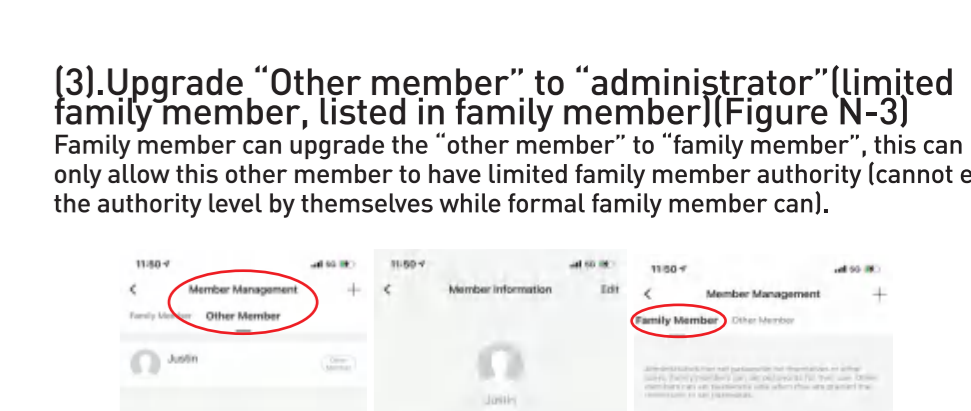
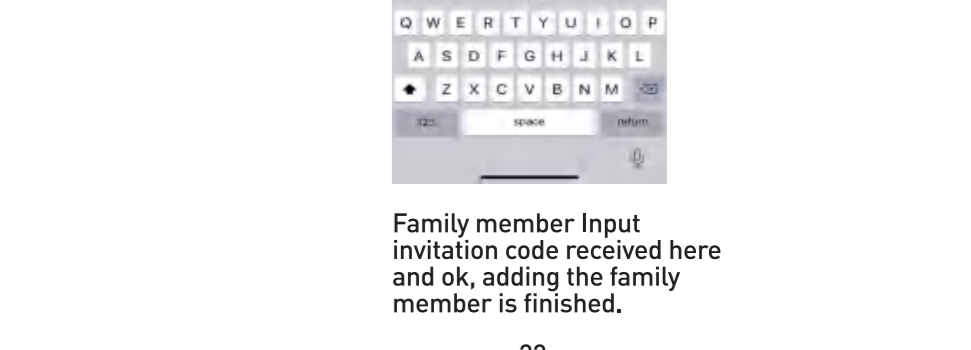
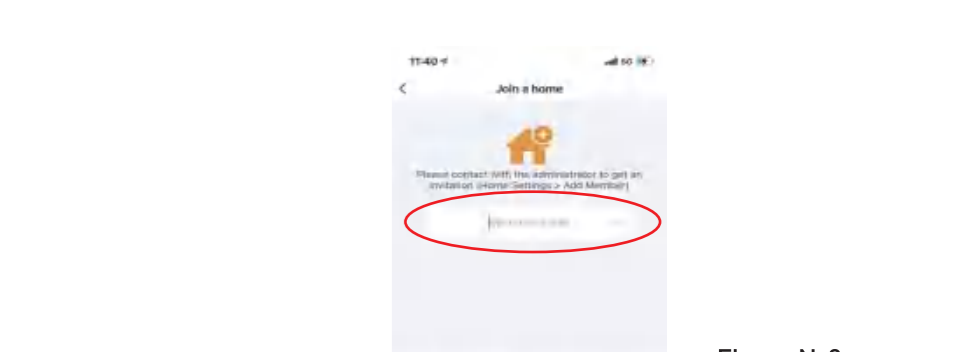
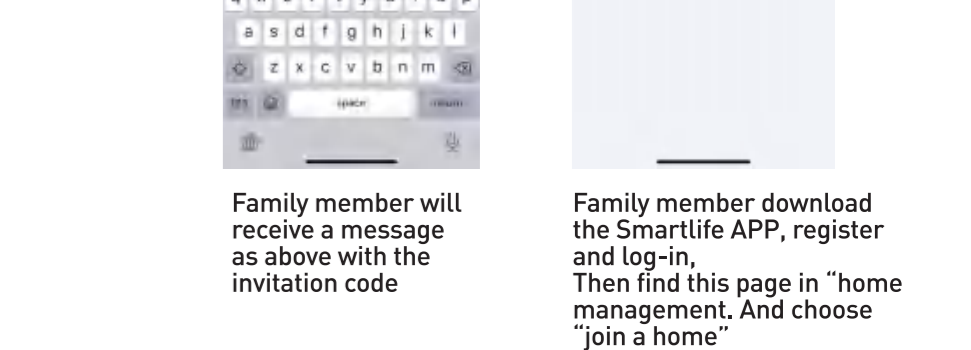
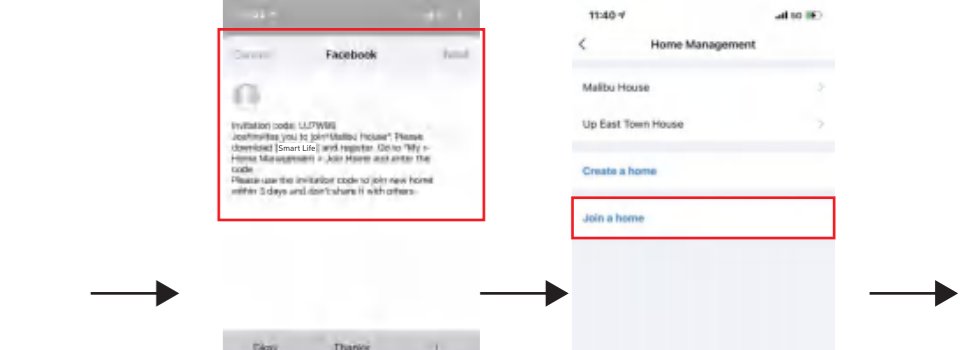
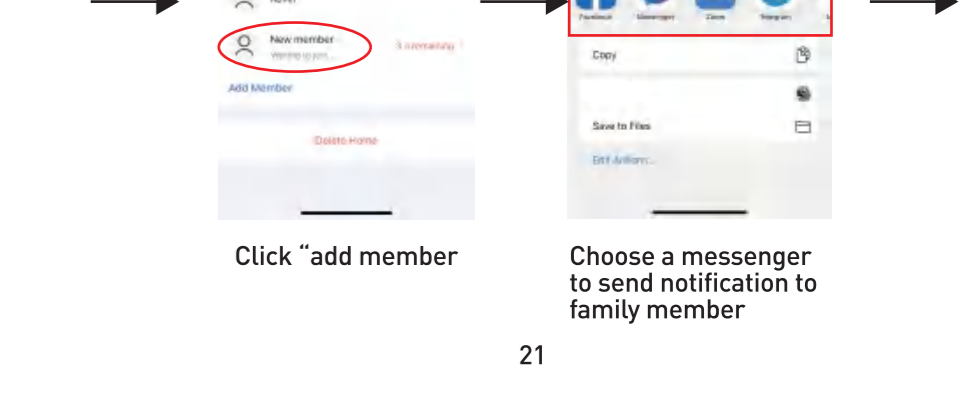
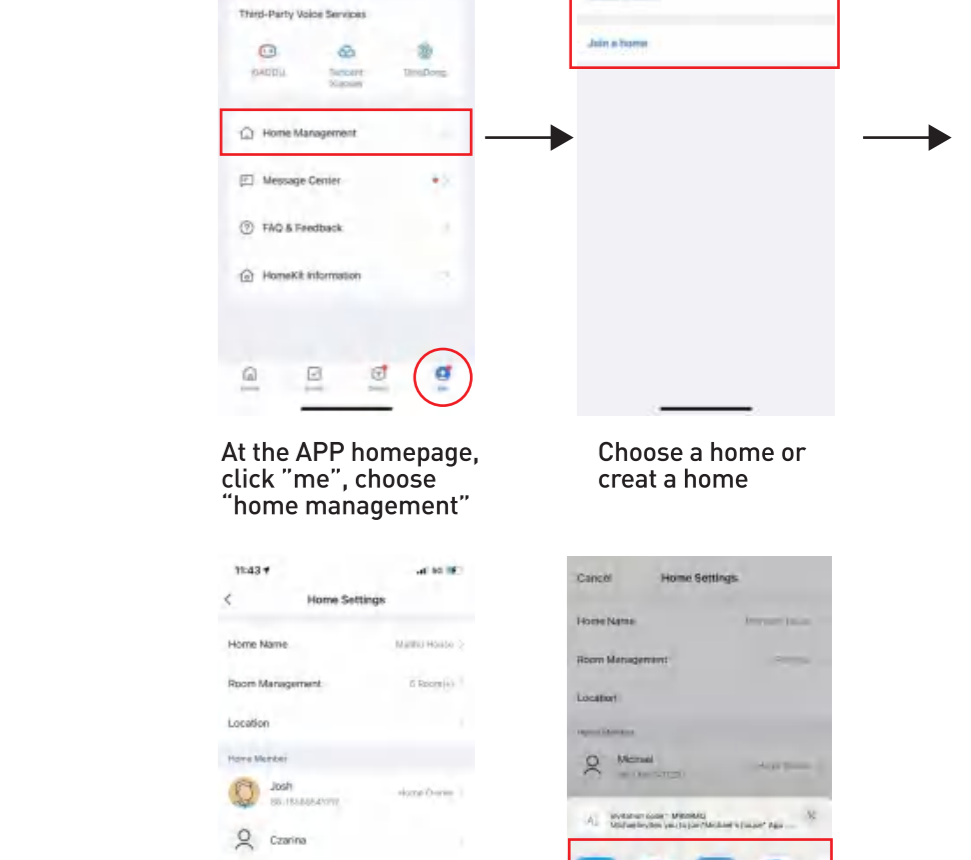

IMPORTANT: User need to turn on the Bluetooth and WIFI on mobile phone prior to below operations.

(a) Step 1
Turn on the WIFI and Blue tooth on mobile phone.(Figure 0-2)

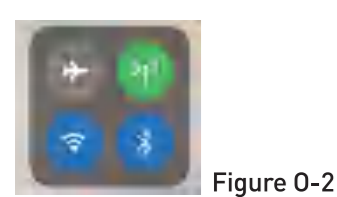

Figure 0-2

(b) Step 2
Activate the WIFI gateway(Figure 0-3)
Power on the WIFI gateway and hold the button on the back of it for 5 seconds, till the indicator light on gateway turn to blue and twinkle.

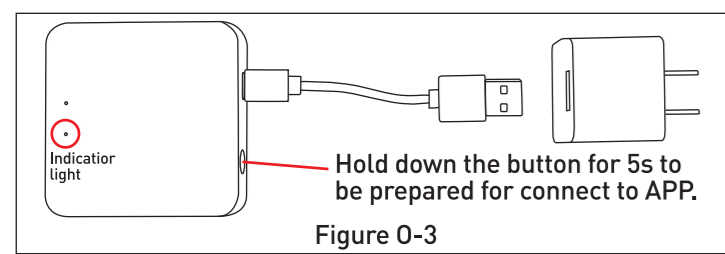

Figure 0-3

(c) Step 3
Add the WIFI gateway to APP, Connect the WIFI gateway and the deadbolt.(Figure 0-4)

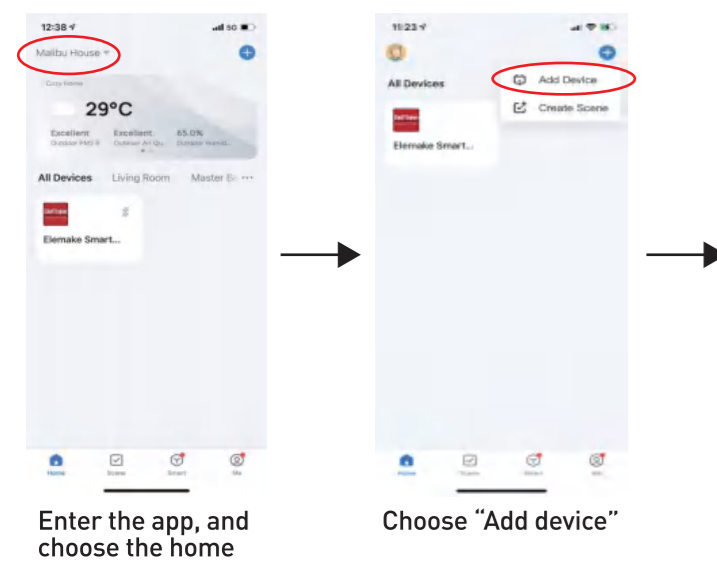

Figure 0-4

24

(3) Key unlocking (Figure P-2)

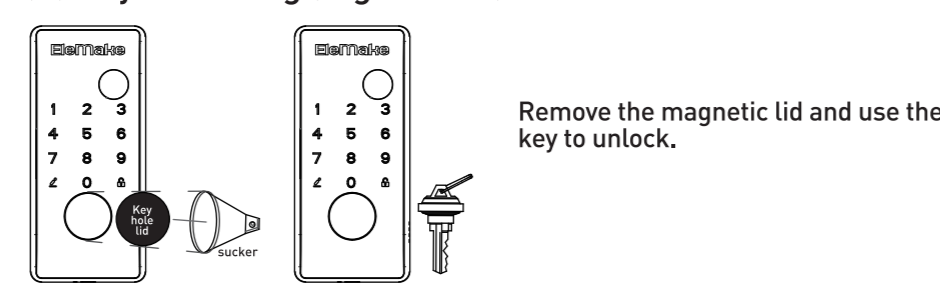

Figure P-2

Remove the magnetic lid and use the key to unlock.

(4) RF card unlocking (Figure P-3)

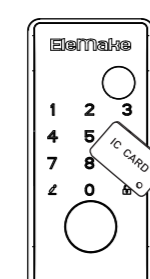

Figure P-3

Put the RF card in the center of the keypad until it beeps and unlocks

(5) Bluetooth remote unlocking with mobilephone APP.(Figure P-4)

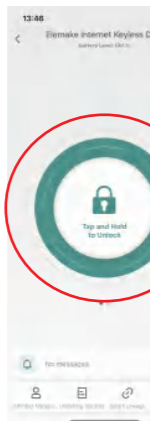

Figure P-4

Turn on the cell phone bluetooth. Open App and tap to unlock.

(6) Temporary Password (offline)(Figure P-5)

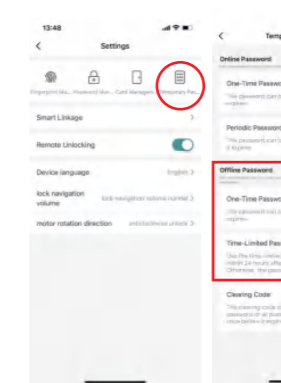

Figure P-5

Off-line one time temporary password unlocking and(time limited)
Off-line reusable temporary password unlocking(time limited).

(7) Temporary power to outside escutcheon(Figure P-6)

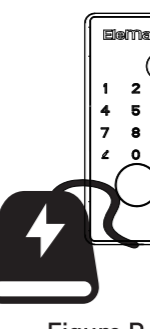

Figure P-6

If the batteries are drained, the user can use a temporary power supply to supply power to the lock with a power bank and Android Micro USB charging cable port located at the bottom of outside escutcheon.

(8) Locking the door(Figure P-7, Figure P-8)

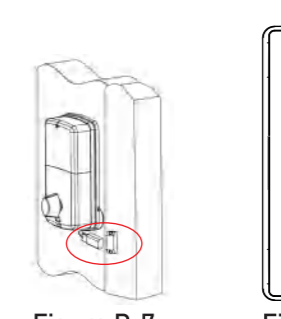

Figure P-7

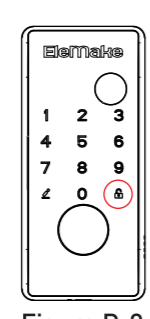

Figure P-8

A.If the user has set up the automatic locking function, the door will lock automatically when closed.

B.For manual locking when the automatic lock function has not been installed, simply touch the lock button "Ⓛ" on the keypad. (Figure P-6)

(9) Battery level monitoring(real time) (Figure P-9)



Figure P-9

A. The battery percentage level can be easily monitored through the Smart life App. Go to the Lock page. At the top you will see the percentage of battery remaining. This lock with 4 AA Alkaline batteries(we don't recommend using rechargeable batteries).

B. Voice reminder and message reminder when battery level<20%

(10) Choose Languages(Figure P-10)

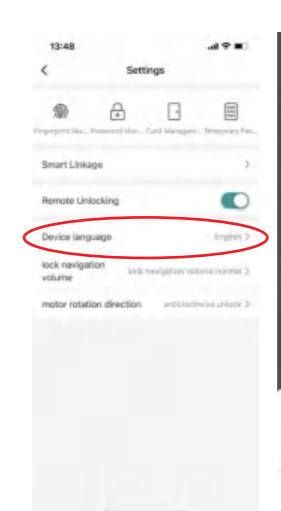

Figure P-10

There are 2 languages options. English and Spanish

(11) Record of deadbolt unlocking history(See Figure P-11)

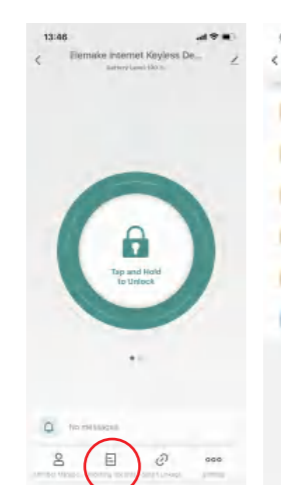

Figure P-11

To see the record of when the lock was opened and which user opened it, you can go to the Lock page and click on "Smart Listings" at the bottom of the page. All unlocking times and family member information is listed under

5.2 INTERNET FUNCTIONS

(1) Separated WIFI design, No Power consumption to battery for WIFI application. (Figure Q-1)

To use the Internet functions, we recommend purchasing the Tuya Wifi gateway (Sold Separately) with a separated WIFI bridge (110V wall plug) to avoid wasting battery while the lock connects to the WIFI.

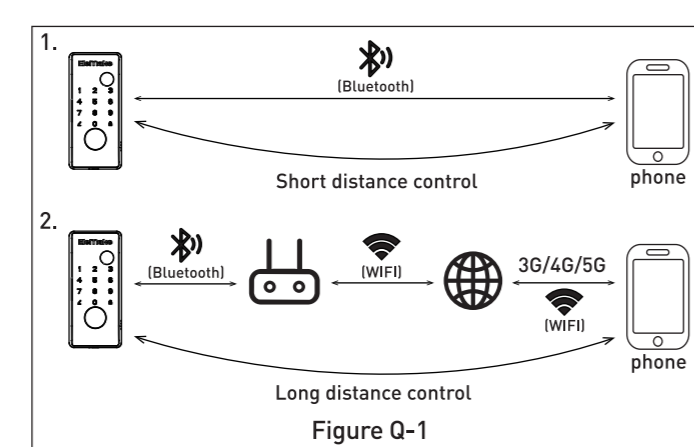

Figure Q-1

31

(2) Online password (Figure Q-2)

There are 2 types of online passwords: The online one time temporary password with a time limit and the online time-limited temporary password. Choose the type of the password you want, and follow the APP steps.

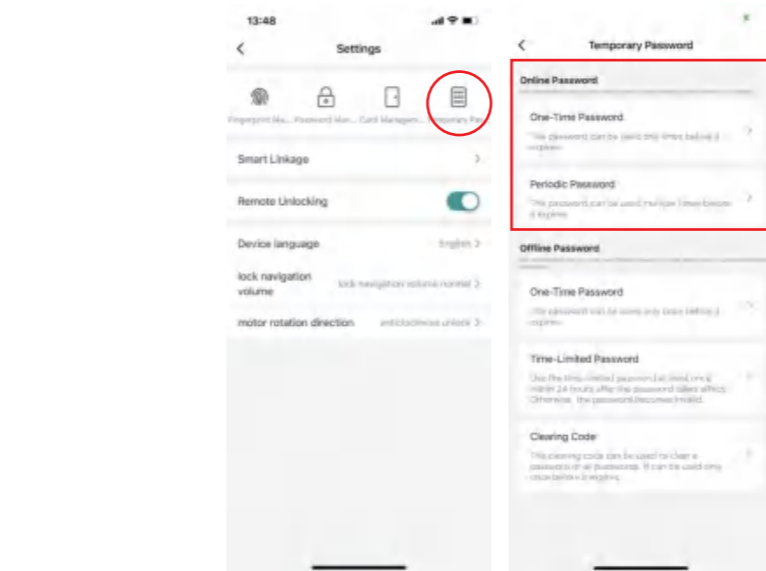

Figure Q-2

(3) Long distance unlocking (Figure Q-3)

If the user already connected the deadbolt to Tuya Wifi gateway, the long distance unlocking function will work where ever you are located as long as there is internet.

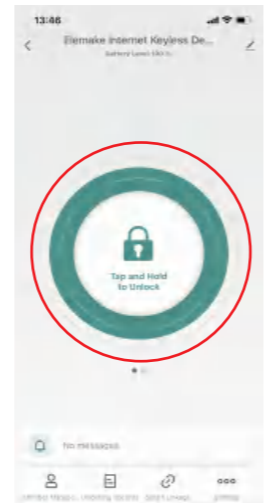

Figure Q-3

(4) Go home alert/door abnormal alert. (Figure Q-4)

Click "smart linkage" on the deadbolt's home page. Go to ->Scene->SceneEdit and set up the alert.
After this is set up, each time the door is opened, the user will receive a notification. If someone attempts to enter the code incorrectly, or deadbolt in a low battery level(<20%), user will receive an Abnormal alert.

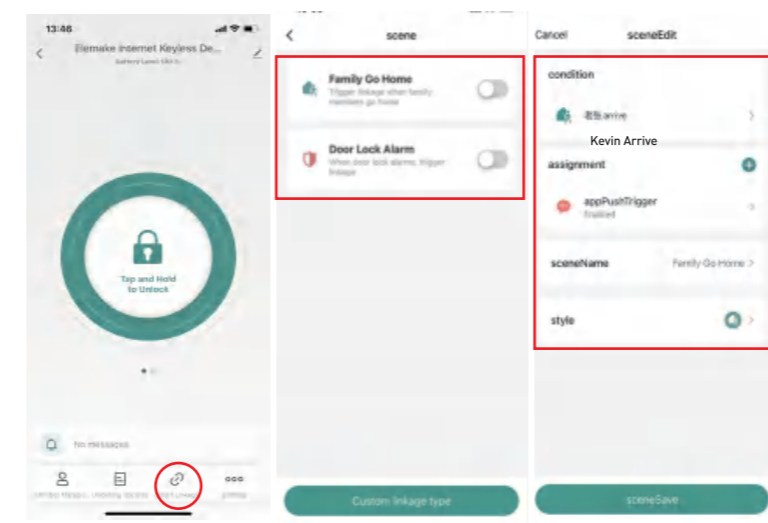

Figure Q-4

(5) Alexa/Google Assistant/Smart Things operations (Figure Q-5)

Turn to the home page->Click "me", then choose which assistant to use. Then follow APP steps to operate the deadbolt.

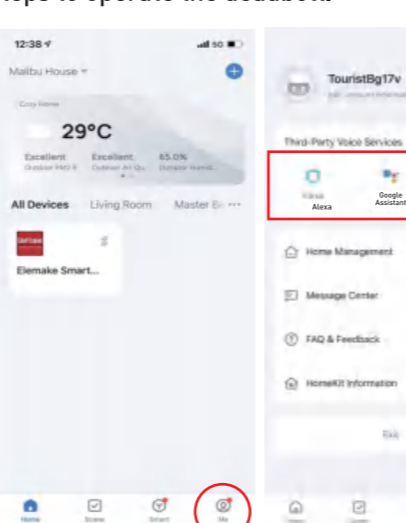

Figure Q-5

(6) Smart Home

This lock Can use a with SmartHome as a related items which can be a part of the smart home system. (Figure Q-6)

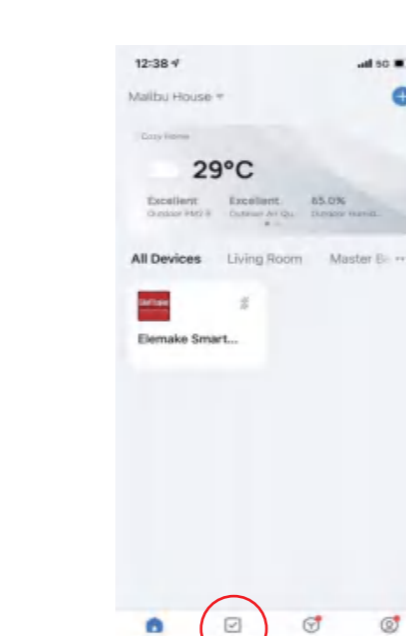

Figure Q-6

6. QUALITY POLICY

We provide a 5 year warranty for all of our Keyless door lock products from the day of purchase.
Return/Replacement Policy
If you want to return/replace you lock for any reason, please contact us directly for return/replacement. In this way, EleMake will be able to pay for the return shipping cost and avoid loss to customers.
What if the product is out of return/replacement window, and the warranty has expired? In most cases, we will provide return/replacement service or other support to customers even if the product is out of return/replacement window or the warranty has expired. Please contact us directly so we can better serve you.
For technical/quality questions, please refer to the contacts below. Our technical support team is dedicated to helping you.
Your time is important. We are committed to answering all questions within 1 business day.
LIMITED WARRANTY OF THE LOCK PRODUCTS
The seller warranty applies to the original purchaser only. The lock products will be free from defects in material or workmanship for a period of five (5) years from the date of purchase.
SELLER'S SOLE OBLIGATION AND YOUR EXCLUSIVE REMEDY under this Limited Warranty and, to the extent permitted by law, any warranty or condition implied by law, shall be the repair or replacement of parts, without charge, which are defective in material or workmanship and which have not been misused, carelessly handled, or mis-repaired by persons other than Seller or Authorized Service Center. To make a claim under this Limited Warranty, you must retain a copy of your proof of purchase that clearly defines the Date of Purchase (month and year) and the Place of Purchase. Third-party vendors such as garage sales, pawnshops, resale shops, or any other secondhand merchant void the warranty included with this product. Contact csservice168@163.com or (800)315-9607 to make arrangements for repair and transportation.
When returning a product for warranty service, the product must be shipped in its original container (or an equivalent), properly packed to withstand the hazards of shipment. The product must come with the proof of purchase enclosed.
There must also be a description of the problem in order to help our repairs department diagnose and fix the issue. Repairs will be made and the product will be returned and shipped back to the purchaser at no additional charge.
THIS LIMITED WARRANTY DOES NOT APPLY TO ACCESSORY ITEMS THAT WEAR OUT FROM REGULAR USAGE OVER TIME INCLUDING SANDING PADS, DISC PAPERS, BELTS, BRUSHES, BLADES, ETC.
ANY IMPLIED WARRANTIES SHALL BE LIMITED IN DURATION TO FIVE (5) YEARS FROM THE DATE OF PURCHASE. SOME STATES IN THE U.S., SOME CANADIAN PROVINCES DO NOT ALLOW LIMITATIONS ON HOW LONG AN IMPLIED WARRANTY LASTS, SO THE ABOVE LIMITATION MAY NOT APPLY TO YOU.
IN NO EVENT SHALL THE SELLER BE LIABLE FOR ANY INCIDENTAL OR CONSEQUENTIAL DAMAGES INCLUDING BUT NOT LIMITED TO LIABILITY FOR LOSS OF PROFITS ARISING FROM THE SALE OR USE OF THIS PRODUCT. SOME STATES IN THE U.S. AND SOME CANADIAN PROVINCES DO NOT ALLOW THE EXCLUSION OR LIMITATION OF INCIDENTAL OR CONSEQUENTIAL DAMAGES, SO THE ABOVE LIMITATION OR EXCLUSION MAY NOT APPLY TO YOU.
THIS LIMITED WARRANTY GIVES YOU SPECIFIC LEGAL RIGHTS, AND YOU MAY ALSO HAVE OTHER RIGHTS WHICH VARY FROM STATE TO STATE IN THE U.S., PROVINCE TO PROVINCE IN CANADA, AND FROM COUNTRY TO COUNTRY.
THIS LIMITED WARRANTY APPLIES ONLY TO PORTABLE ELECTRIC TOOLS, BENCH POWER TOOLS, OUTDOOR POWER EQUIPMENT, AND PNEUMATIC TOOLS SOLD WITHIN THE UNITED STATES OF AMERICA, AND CANADA. FOR WARRANTY COVERAGE WITHIN OTHER COUNTRIES, CONTACT US CUSTOMER SUPPORT LINE.

35

INFORMATION NEEDED WHEN REQUESTING A SERVICE:

Model: _____

Dealer: _____

Purchase Date: _____



www.elemakelocks.com

ONLINE CUSTOMER SERVICE

Facebook #: [csservice168@163.com](https://www.facebook.com/csservice168@163.com)

Skype #: [customerservice@products](https://www.skype.com/en/contacts/products/customerservice@products)

Email-address: csservice168@163.com

Customer service center address:

5448 Apex Peakway, 197 Apex, NC 27502

FOR CUSTOMER SERVICE PLEASE CALL:
(800) 315-9607



COPYRIGHT©2022 BY STEINBRUCKE PRODUCTS US LLC. ALL RIGHTS RESERVED

5. HOW TO USE THE DEADBOLT

▲NOTE: For lock operations, the user can follow the steps in the app to easily learn how to use the smart deadbolt. For specific operations, refer to the detailed instructions below.

5.1 BASIC FUNCTIONS

(1) Fingerprint unlocking (Figure P-0)

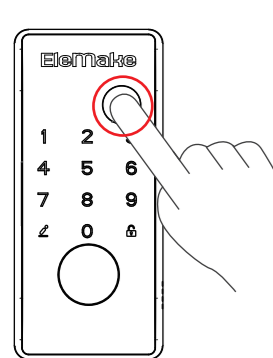

Figure P-0

Put the fingerprint onto the fingerprint reader, if the fingerprint matches the enrolled fingerprints, the deadbolt will be unlocked.

Blue light indicate that the deadbolt is ready to read the fingerprint, green light indicate the unlocking, red light indicate the fingerprint does not match.

(2) Password unlocking(Figure P-1)

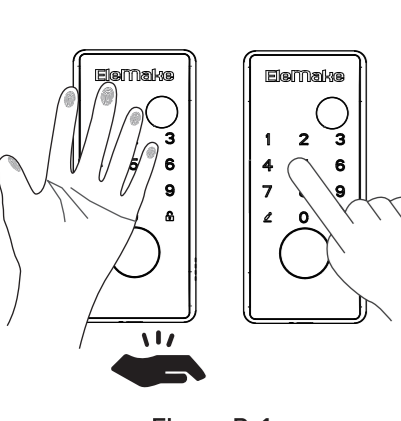

Figure P-1

(a) Touch the screen with the back of your hand or fingers to activate

(b) Start by entering the "2" write key, Enter you password, Then enter the "Ⓛ" key to unlock.

27